

NEW MEXICO OIL CONSERVATION COMMISSION  
WELL LOCATION AND ACREAGE DEDICATION PL.

Form C-102  
Supersedes C-128  
Effective 1-1-65

All distances must be from the outer boundaries of the Section.

Operator <b>CONTINENTAL OIL CO.</b>		Lease <b>W. R. MEANS</b>		Well No. <b>3</b>
Unit Letter <b>O</b>	Section <b>28</b>	Township <b>14 SOUTH</b>	Range <b>30 EAST</b>	County <b>CHAVES</b>
Actual Footage Location of Well: <b>940</b> feet from the <b>SOUTH</b> line and <b>2310</b> feet from the <b>EAST</b> line				
Ground Level Elev. <b>3908.6</b>	Producing Formation <b>Queen</b>	Pool <b>Vest Ranch Queen</b>	Dedicated Acreage: <b>40</b>	

1. Outline the acreage dedicated to the subject well by colored pencil or hatchure marks on the plat below.

2. If more than one lease is dedicated to the well, outline each and identify the ownership thereof (both as to working interest and royalty).

3. If more than one lease of different ownership is dedicated to the well, have the interests of all owners been consolidated by communitization, unitization, force-pooling, etc?

☐ Yes ☐ No If answer is "yes," type of consolidation \_\_\_\_\_

If answer is "no," list the owners and tract descriptions which have actually been consolidated. (Use reverse side of this form if necessary.) \_\_\_\_\_

No allowable will be assigned to the well until all interests have been consolidated (by communitization, unitization, forced-pooling, or otherwise) or until a non-standard unit, eliminating such interests, has been approved by the Commission.

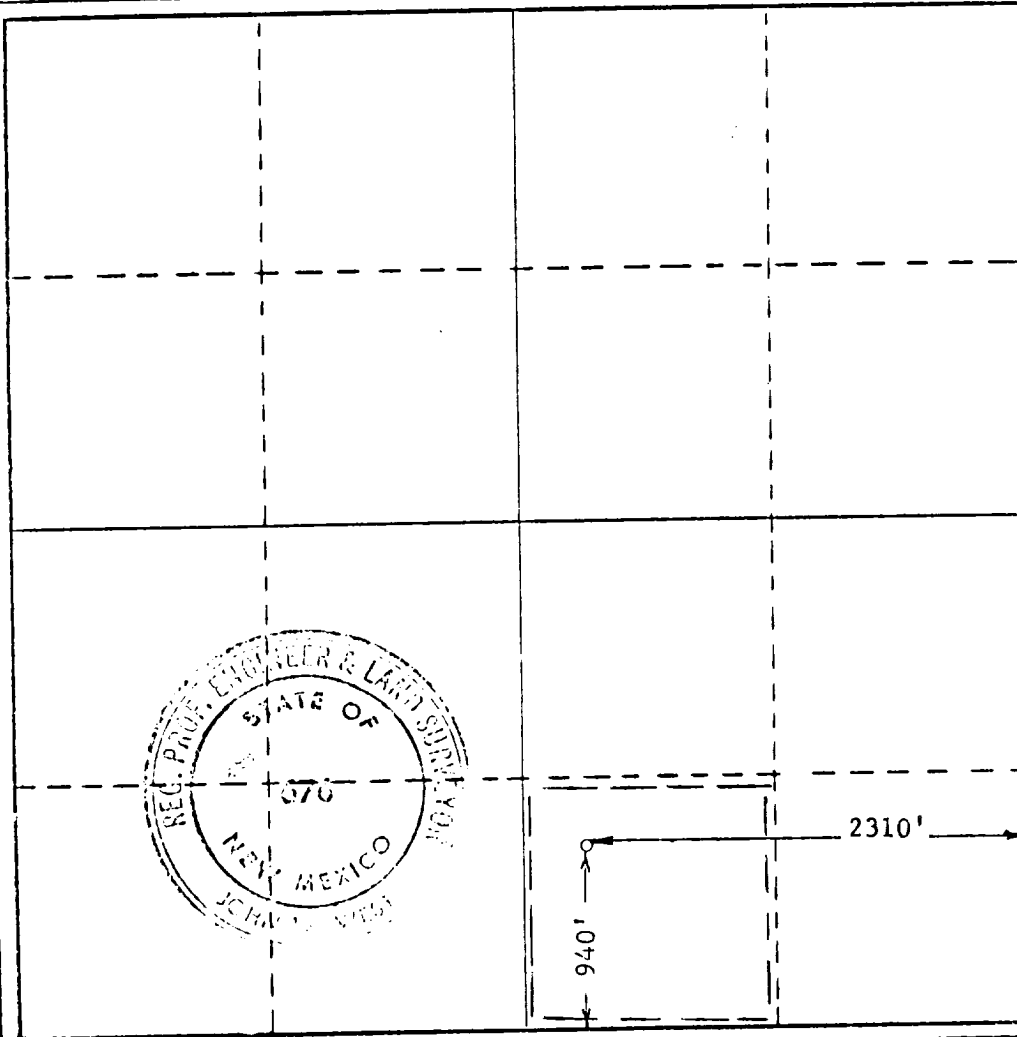

CERTIFICATION

I hereby certify that the information contained herein is true and complete to the best of my knowledge and belief.

Name  
*[Signature]*  
Position  
*Admin Supervisor*  
Company  
*Continental Oil Co*  
Date  
*December 13, 1971*

**RECEIVED**  
**DEC 14 1971**  
U.S. GEOLOGICAL SURVEY  
ARTESIA, NEW MEXICO  
I hereby certify that the well location shown on this plat was from field notes of surveys made by me or under my supervision and that the same is true and correct to the best of my knowledge and belief.

Date Surveyed  
**DECEMBER 2, 1971**  
Registered Professional Engineer and/or Land Surveyor

*John W. West*  
Certificate No. **676**

0 330 660 990 1320 1650 1980 2310 2640 2970 3300 3630 3960 4290 4620 4950 5280 5610 5940 6270 6600

RECEIVED  
DEC 15 1971

O.C.C.  
ARTESIA OFFICE

UNITED STATES  
DEPARTMENT OF THE INTERIOR  
GEOLOGICAL SURVEY

APPLICATION FOR PERMIT TO DRILL, DEEPEN, OR PLUG BACK

1a. TYPE OF WORK

DRILL ☒ AMENDED DEEPEN ☐ PLUG BACK ☐

b. TYPE OF WELL

OIL WELL ☒ GAS WELL ☐ OTHER ☐ SINGLE ZONE ☐ MULTIPLE ZONE ☐

2. NAME OF OPERATOR

Continental Oil Company

3. ADDRESS OF OPERATOR

Box 460 Hobbs, New Mexico

4. LOCATION OF WELL (Report location clearly and in accordance with any State requirements.\*)

At surface  
990' FSL and 2310' FEL of Sec 28  
at proposed prod. zone  
Same

14. DISTANCE IN MILES AND DIRECTION FROM NEAREST TOWN OR POST OFFICE\*

10. DISTANCE FROM PROPOSED\*

LOCATION TO NEAREST  
PROPERTY OR LEASE LINE, FT.  
(Also to nearest drlg. unit line, if any)

18. DISTANCE FROM PROPOSED LOCATION\*

TO NEAREST WELL, DRILLING, COMPLETED,  
OR APPLIED FOR, ON THIS LEASE, FT.

21. ELEVATIONS (Show whether DF, RT, GR, etc.)

3908.6' gr

16. NO. OF ACRES IN LEASE

1120

19. PROPOSED DEPTH

2170'

17. NO. OF ACRES ASSIGNED  
TO THIS WELL

40

20. ROTARY OR CABLE TOOLS

Rotary

22. APPROX. DATE WORK WILL START\*

12-10-71

23. PROPOSED CASING AND CEMENTING PROGRAM

SIZE OF HOLE	SIZE OF CASING	WEIGHT PER FOOT	SETTING DEPTH	QUANTITY OF CEMENT
12 1/4"	8 3/8"	20 #	500'	Circ
7 7/8"	4 1/2"	9.5 #	2170'	200 SKS

It is proposed to drill a straight hole to 2170' and complete as a Vest Ranch Queen producer.

RECEIVED

DEC 6 1971

U. S. GEOLOGICAL SURVEY

Note: This permit to drill replaces the one approved on 8-27-71 due to a location change.

IN ABOVE SPACE DESCRIBE PROPOSED PROGRAM: If proposal is to deepen or plug back, give data on present productive zone and proposed new productive zone. If proposal is to drill or deepen directionally, give pertinent data on subsurface locations and measured and true vertical depths. Give blowout preventer program, if any.

24.

SIGNED

[Signature]

TITLE

Admin Supervisor

DATE

12-3-71

(This space for Federal or State office use)

APPROVED

PERMIT NO.

DEC 6 - 1971

APPROVED BY

H. L. BECKMAN

ACTING DISTRICT ENGINEER

THIS APPROVAL IS RECOMMENDED IF OPERATIONS ARE NOT COMMENCED WITHIN 3 MONTHS. EXPIRES MAR 6 - 1972

DATE

USGS-Artesia (5) File See Instructions On Reverse Side

RECEIVED

SEP 7 1971

OIL CONSERVATION COMM.  
HOBBES, N. H.