

UNITED STATES
DEPARTMENT OF THE INTERIOR
GEOLOGICAL SURVEY(Other instructions
reverse side)

APPLICATION FOR PERMIT TO DRILL, DEEPEN, OR PLUG BACK

1a. TYPE OF WORK

DRILL ☒DEEPEN ☐PLUG BACK ☐

b. TYPE OF WELL

OIL
WELL ☒GAS
WELL ☐

OTHER

SINGLE
ZONE ☒MULTIPLE
ZONE ☐

2. NAME OF OPERATOR

Walter W. Krug, (DBA

Wallen Production Company)

3. ADDRESS OF OPERATOR

308 North Colorado, Suite # 4, Midland, Texas

4. LOCATION OF WELL (Report location clearly and in accordance with any State requirements.)*

At surface

At proposed prod. zone

Same

14. DISTANCE IN MILES AND DIRECTION FROM NEAREST TOWN OR POST OFFICE*

20 miles E of Hagerman, New Mexico

15. DISTANCE FROM PROPOSED*

LOCATION TO NEAREST

PROPERTY OR LEASE LINE, FT.

(Also to nearest drlg. unit line, if any)

330 FN

18. DISTANCE FROM PROPOSED LOCATION*

TO NEAREST WELL, DRILLING, COMPLETED,
OR APPLIED FOR, ON THIS LEASE, FT.

None

16. NO. OF ACRES IN LEASE

80

19. PROPOSED DEPTH

2200'

17. NO. OF ACRES ASSIGNED
TO THIS WELL

40

20. ROTARY OR CABLE TOOLS

Cable tool

21. ELEVATIONS (Show whether DF, RT, GR, etc.)

3868 GR

22. APPROX. DATE WORK WILL START*

immediate

23.

PROPOSED CASING AND CEMENTING PROGRAM

SIZE OF HOLE	SIZE OF CASING	WEIGHT PER FOOT	SETTING DEPTH	QUANTITY OF CEMENT
12 3/4"	10 3/4"	40#	35' I	15 sks
9"	7"	23#	600'	125 sks of Class C w/3% gel
6 1/4"	4 1/2"	11.6#	2200'	100 sks of Class C neat and 5 #Gilsonite/sk.

IN ABOVE SPACE DESCRIBE PROPOSED PROGRAM: If proposal is to deepen or plug back, give data on present productive zone and proposed new productive zone. If proposal is to drill or deepen directionally, give pertinent data on subsurface locations and measured and true vertical depths. Give blowout preventer program, if any.

24.

SIGNED

Walter W. Krug

TITLE partner

DATE 3-31-1973

(This space for Federal or State office use)

APR 4 1973

PERMIT NO.

APPROVAL DATE

APPROVED BY

James R. Kraft

TITLE

DISTRICT ENGINEER

DATE

APR 4 1973

THIS APPROVAL IS RESCINDED IF OPERATIONS
ARE NOT COMMENCED WITHIN 3 MONTHS.

*See Instructions On Reverse Side

NEW MEXICO OIL CONSERVATION COMMISSION
WELL LOCATION AND ACREAGE DEDICATION PLAT

Form C-102
Supersedes C-128
Effective 1-1-65

All distances must be from the outer boundaries of the Section.

Operator Walter W. Krug DBA WALLEN PRODUCTION CO.		Lease VEST		Well No. 1
Unit Letter "J"	Section 21	Township 14-S	Range 30-E	County CHAVES
Actual Footage Location of Well: 1650 feet from the SOUTH line and 2310 feet from the EAST line				
Ground Level Elev. 3869	Producing Formation QUEEN	Pool VEST RANCH	Dedicated Acreage: 40 Acres	

1. Outline the acreage dedicated to the subject well by colored pencil or hachure marks on the plat below.
2. If more than one lease is dedicated to the well, outline each and identify the ownership thereof (both as to working interest and royalty).
3. If more than one lease of different ownership is dedicated to the well, have the interests of all owners been consolidated by communitization, unitization, force-pooling, etc?

☐ Yes ☐ No If answer is "yes," type of consolidation _____

If answer is "no," list the owners and tract descriptions which have actually been consolidated. (Use reverse side of this form if necessary.) _____

No allowable will be assigned to the well until all interests have been consolidated (by communitization, unitization, forced-pooling, or otherwise) or until a non-standard unit, eliminating such interests, has been approved by the Commission.

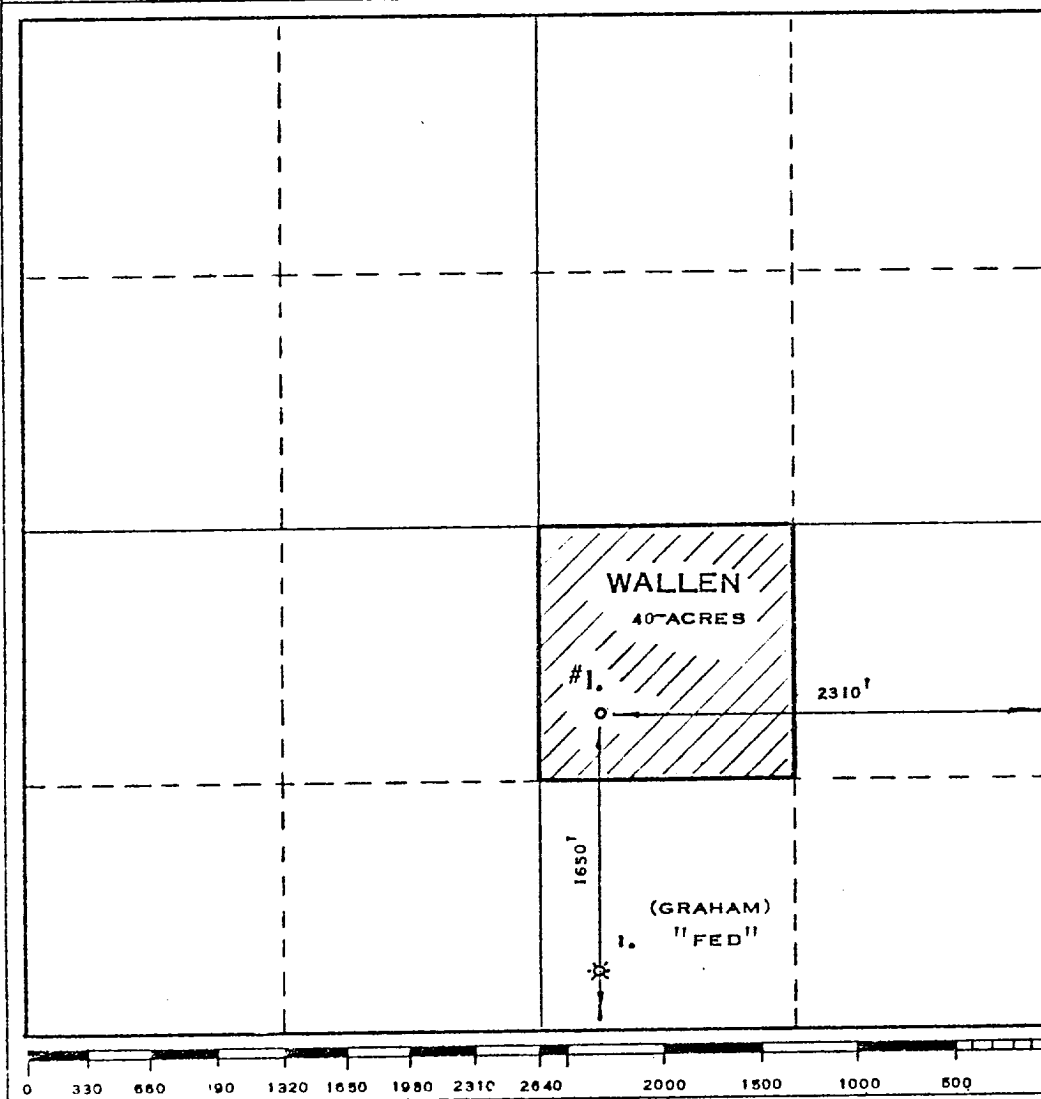

CERTIFICATION

I hereby certify that the information contained herein is true and complete to the best of my knowledge and belief.

Walter W. Krug
Name

partner
Position

Wallen Production Company
Company

Date

4-2-1973

Date

I hereby certify that the well location shown on this plat was plotted from field notes of actual surveys made by me or under my supervision, and that the same is true and correct to the best of my knowledge and belief.

Date Surveyed

MARCH 20, 1973

Registered Professional Engineer
and/or Land Surveyor

Max A. Schumann Jr.
MAX A. SCHUMANN JR.

Certificate No.

1510

RECEIVED

APR - 5 1973

U.S. AIR FORCE
AIRMAIL

PLAT 1

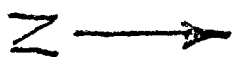

14-30

Proposed well #1 West

Road to Cockrell Corp.
#1 Occidental Fed.

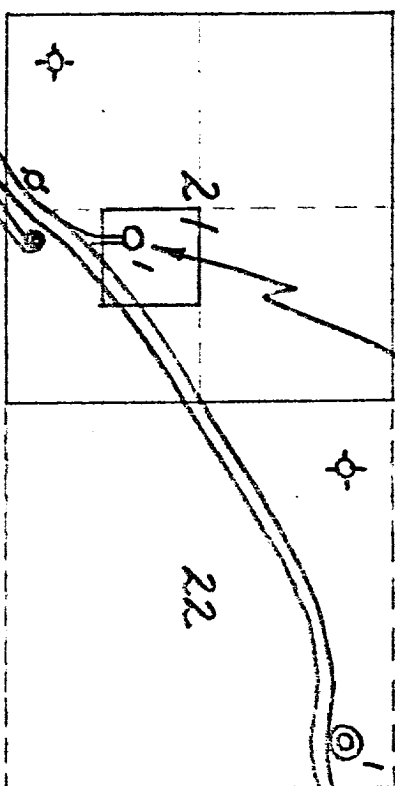

To New Mexico
Route 31 - 4.8 miles

WALLEN PRODUCTION COMPANY
Wallen #1 West
1650' FSL 42310' FEL Sec 21, T14S, R30E
Chaves Cty, New Mexico

PLAT 2

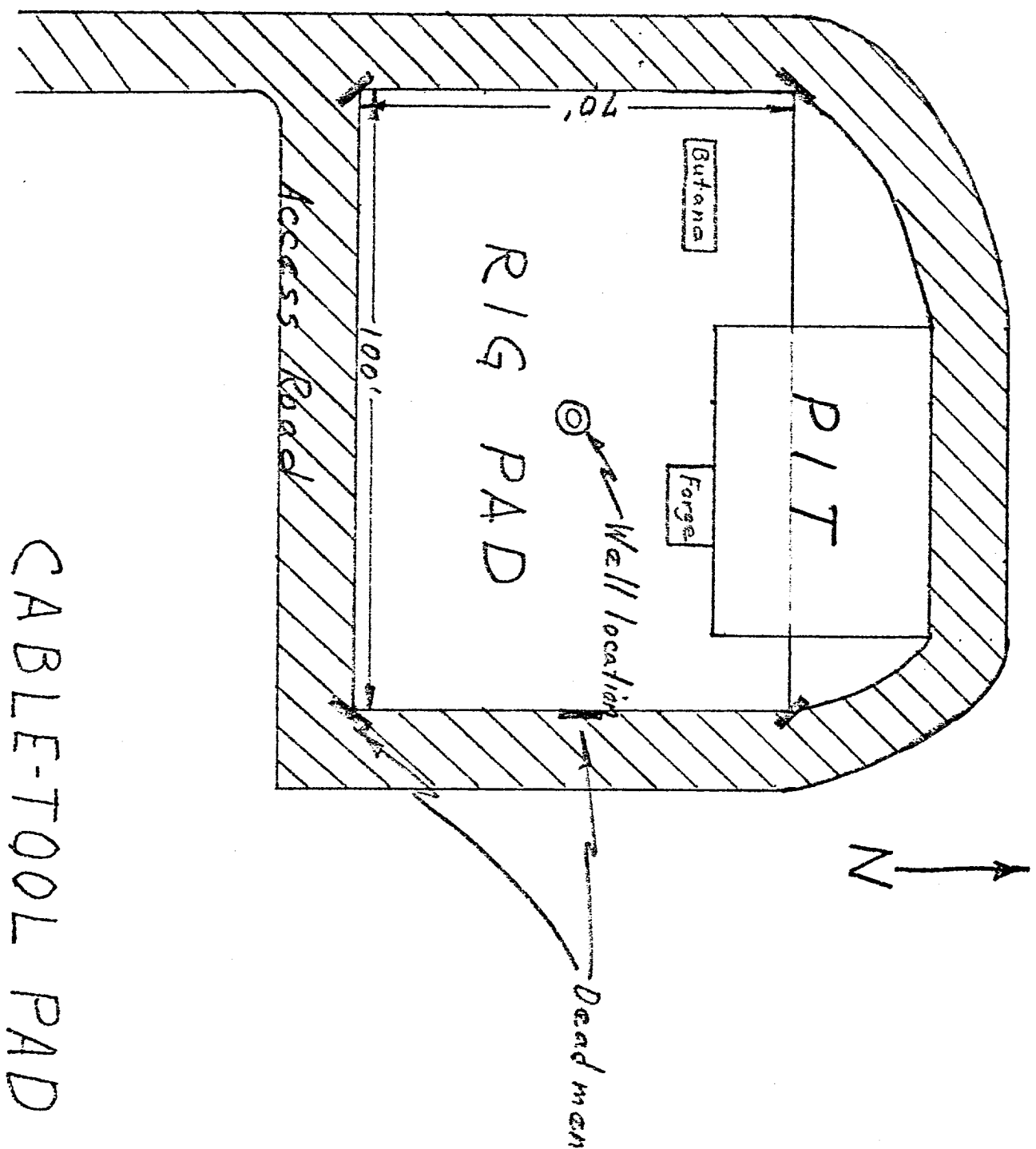

CABLE-TOOL PAD

Wallen Production Company

DEVELOPMENT PLAN FOR SURFACE USE

Wallen Vest # 1 Well
1650 FSL & 2310 FEL
Section 21, T 14 S,
R 30 E, Chaves County,
New Mexico

The following discussion answers the items 1 through 12 concerning the above subject well.

1. Attached to this discussion are Plats 1 and 2. Plat 1 shows all pertinent wells, the proposed location, flow lines, salt water line, tank battery and roads.
2. Plat 2 shows the cable tool rig location and pits. As you know the minimum of surface acreage is used.
3. We are about 500 feet from an existing caliche road, which we will utilize and will add a 10' wide, 8" thick caliche road to the rig location.
4. The oil and salt water are hauled by truck. The oil goes to a pipeline and the salt water goes to a salt water disposal well.
5. The drilling water will come from a commercial source; the local city water station.
6. The mud wastes from the mud pit will be rolled into a deep dozer ditch and covered (including old pit) with the new dirt from a deep ditch.
7. The wire, cable, sacks, containers, and waste barrels will be hauled off to an approved dump site, upon completion or plugging of the well.
8. The restoration of the surface will be done upon completion or plugging of the well and will be accomplished as item 6 above.