

NO. OF COPIES RECEIVED

DISTRIBUTION

SANTA FE

FILE

U.S.G.S.

LAND OFFICE

OPERATOR

NEW MEXICO OIL CONSERVATION COMMISSION

Form C-101
Revised 1-1-65

5A. Indicate Type of Lease
STATE ☒ FEE ☐

5. State Oil & Gas Lease No.
LG 0444

APPLICATION FOR PERMIT TO DRILL, DEEPEN, OR PLUG BACK

1a. Type of Work
b. Type of Well
DRILL ☒ DEEPEN ☐ PLUG BACK ☐
OIL WELL ☐ GAS WELL ☒ OTHER ☐ SINGLE ZONE ☒ MULTIPLE ZONE ☐

2. Name of Operator
Dalport Oil Corporation

3. Address of Operator
3471 First National Bank Bldg., Dallas, Texas

4. Location of Well
UNIT LETTER **H** LOCATED **1930** FEET FROM THE **North** LINE
AND **560** FEET FROM THE **east** LINE OF SEC. **30** TWP. **12S** RGE. **31E** NMPM

7. Unit Agreement Name

8. Farm or Lease Name
Vates State-Con.

9. Well No.
1

10. Field and Pool, or Wildcat
Undesignated

11. County
Chaves

19. Proposed Depth
2620

19A. Formation
Queen

20. Rotary or C.T.
Rotary

21. Elevations (Show whether DF, RT, etc.)
4047.5 gr

21A. Kind & Status Plug. Bond
Statowide

21B. Drilling Contractor
TM Drilling Corp.

22. Approx. Date Work will start
May 30, 1974

PROPOSED CASING AND CEMENT PROGRAM

SIZE OF HOLE	SIZE OF CASING	WEIGHT PER FOOT	SETTING DEPTH	SACKS OF CEMENT	EST. TOP
11"	5 5/8"	20	120	35 sx	circulate
7-7/8"	4-1/2"	9.5	2620	125 sx lite + 150 sx "C"	1100

Will evaluate Queen at approximately 2620'. If productive, will cement 4 1/2" casing at 2620, perforate Queen with 2 SPB, treat with 500 gallons 7 1/2% acid, and possibly frac with 20,000 gallons gelled 2% HCl water plus 25,000 sand.

APPROVAL VALID
FOR 90 DAYS UNLESS
DRILLING COMMENCED,
EXPIRES 7-19-74

IN ABOVE SPACE DESCRIBE PROPOSED PROGRAM: IF PROPOSAL IS TO DEEPEN OR PLUG BACK, GIVE DATA ON PRESENT PRODUCTIVE ZONE AND PROPOSED NEW PRODUCTIVE ZONE. GIVE BLOWOUT PREVENTER PROGRAM, IF ANY.

I hereby certify that the information above is true and complete to the best of my knowledge and belief.

Signed John M. Sampet Title Geologist Date 4-15-74

(This space for State Use)

APPROVED BY [Signature] TITLE Geologist DATE 4-15-74

CONDITIONS OF APPROVAL, IF ANY:

NEW MEXICO OIL CONSERVATION COMMISSION
WELL LOCATION AND ACREAGE DEDICATION PLAT

Form C-102
Supersedes C-128
Effective 1-1-65

All distances must be from the outer boundaries of the Section

Operator DALPORT OIL CORPORATION			Lease YATES STATE COM		Well No. 1
Grid Letter H	Section 30	Township 12 SOUTH	Range 31 EAST	County CHAVES	
Actual Well Location of Well: 1980 feet from the NORTH line and 660 feet from the EAST line					
Ground Level Elev 4047.5	Producing Formation Queen		Pool Undesignated		Dedicated Acreage: 320 Acres

- Outline the acreage dedicated to the subject well by colored pencil or hatchure marks on the plat below.
- If more than one lease is dedicated to the well, outline each and identify the ownership thereof (both as to working interest and royalty).
- If more than one lease of different ownership is dedicated to the well, have the interests of all owners been consolidated by communitization, unitization, force-pooling, etc?

☐ Yes ☒ No If answer is "yes," type of consolidation In process of communitizing now with Yates Drilling Co. and Martin Yates III
If answer is "no," list the owners and tract descriptions which have actually been consolidated. (Use reverse side of this form if necessary.)

No allowable will be assigned to the well until all interests have been consolidated (by communitization, unitization, forced-pooling, or otherwise) or until a non-standard unit, eliminating such interests, has been approved by the Commission.

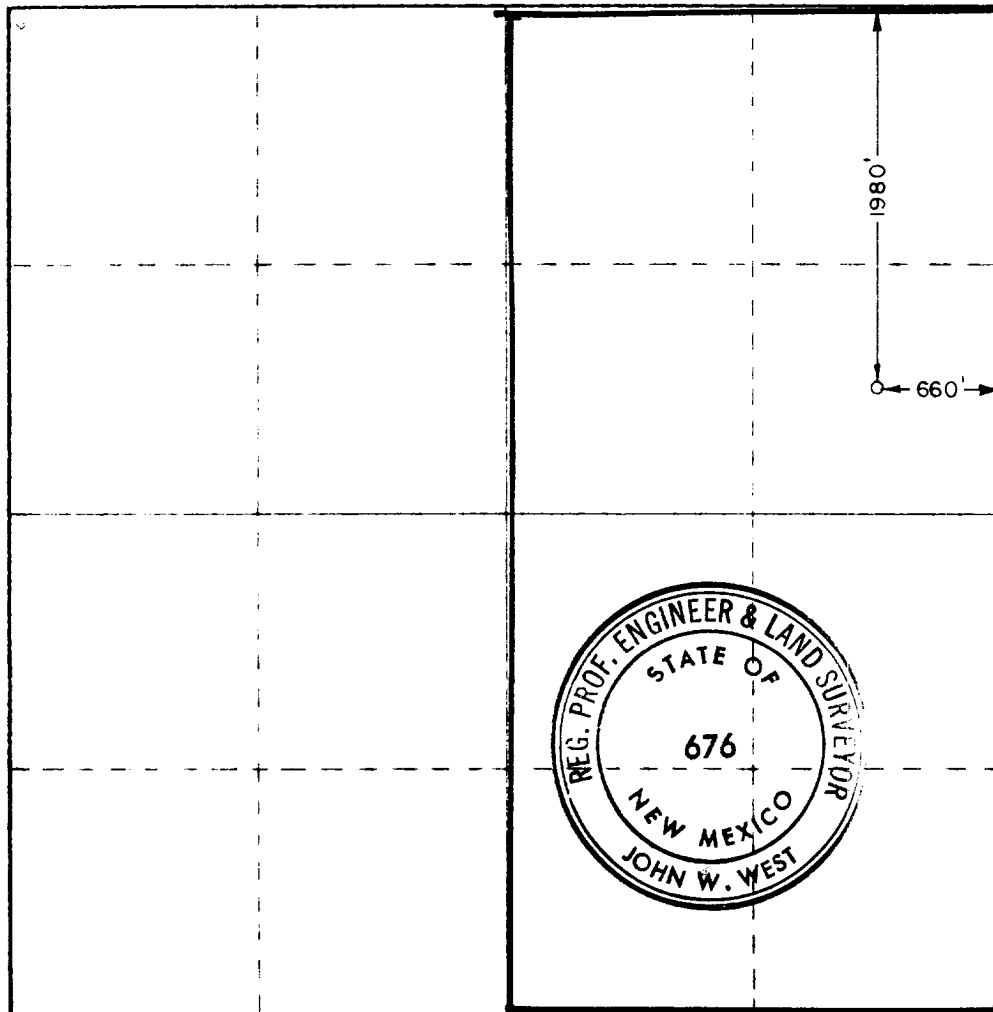

CERTIFICATION

I hereby certify that the information contained herein is true and complete to the best of my knowledge and belief.

Leon M. Larpert
Name

Leon M. Larpert

Position

Geologist

Company

Dalport Oil Corp.

Date

4-15-74

I hereby certify that the well location shown on this plat was plotted from field notes of actual surveys made by me or under my supervision, and that the same is true and correct to the best of my knowledge and belief.

Date Surveyed

APRIL 9, 1974

Registered Professional Engineer and/or Land Surveyor

John W. West
Certificate No. **676**