

NO. OF COPIES RECEIVED	
DISTRIBUTION	
SANTA FE	
FILE	
U.S.G.S.	
LAND OFFICE	
OPERATOR	

NEW MEXICO OIL CONSERVATION COMMISSION

Form C-101
Revised 1-1-65

5A. Indicate Type of Lease	
STATE <input checked="" type="checkbox"/>	FEE <input type="checkbox"/>
5. State Oil & Gas Lease No.	
L-245	

APPLICATION FOR PERMIT TO DRILL, DEEPEN, OR PLUG BACK

1a. Type of Work		7. Unit Agreement Name	
b. Type of Well OIL WELL <input type="checkbox"/> GAS WELL <input checked="" type="checkbox"/> OTHER <input type="checkbox"/>		8. Farm or Lease Name	
2. Name of Operator		9. Well No.	
3. Address of Operator		10. Field and Pool, or Wildcat	
4. Location of Well		12. County	
UNIT LETTER <u>D</u> LOCATED <u>660</u> FEET FROM THE <u>North</u> LINE		Chaves	
AND <u>660</u> FEET FROM THE <u>West</u> LINE OF SEC. <u>16</u> TWP. <u>15S</u> RGE. <u>30E</u> NMPM			
19. Proposed Depth		19A. Formation	
2400		Queen	
20. Rotary or C.T.		Rotary	
21. Elevations (Show whether DF, RT, etc.)		22. Approx. Date Work will start	
21A. Kind & Status Plug. Bond		May 15, 1975	
Statewide			
21B. Drilling Contractor			
W.E.K.			

PROPOSED CASING AND CEMENT PROGRAM

SIZE OF HOLE	SIZE OF CASING	WEIGHT PER FOOT	SETTING DEPTH	SACKS OF CEMENT	EST. TOP
11	8-5/8	20	300	175 "C"	circulate
7-7/8	4-1/2	9.5	2350	275	1100

Will evaluate Queen at approx. 2250'. If productive will set 4-1/2" casing, run radioactive logs, perforate w/ 2 shots/foot, acidize with 1000 gallons, and possibly fracture with 20,000 gallons 2% KCl water + 30,000# sand.

A Shaffer type B, series 900 BOP will be used during drilling. If well is dry, it will be plugged according to NMOCC regulations, pits to be leveled and 4' marker to be installed.

APPROVAL VALID
FOR 90 DAYS UNDER
DEVELOPMENT
EXPIRES 7/15/75

IN ABOVE SPACE DESCRIBE PROPOSED PROGRAM: IF PROPOSAL IS TO DEEPEN OR PLUG BACK, GIVE DATA ON PRESENT PRODUCTIVE ZONE AND PROPOSED NEW PRODUCTIVE ZONE, GIVE BLOWOUT PREVENTER PROGRAM, IF ANY.

I hereby certify that the information above is true and complete to the best of my knowledge and belief.

Signed Geologist Title Geologist Date April 9, 1975

(This space for State Use)

APPROVED BY Geologist TITLE Geologist DATE April 9, 1975

CONDITIONS OF APPROVAL, IF ANY:

RECEIVED

APR 1 1976

U.S. CONSERVATION COMM.
BUREAU, D. C.

**NEW MEXICO OIL CONSERVATION COMMISSION
WELL LOCATION AND ACREAGE DEDICATION PLAT**

Form C-102
Supersedes C-128
Effective 1-1-65

All distances must be from the outer boundaries of the Section

Operator Dalport Oil Corporation			Lease State - C		Well No. 1
Tract Letter D	Section 16	Township 15 South	Range 30 East	County Chaves	
Actual Location of Well: <div style="display: flex; justify-content: space-between;"> 660 feet from the North line and 660 feet from the West line </div>					
Ground Level Elev. 4041.9	Producing Formation Queen	Pool W111001 <i>North & Green</i>	Dedicated Acreage: 320 Acres		

1. Outline the acreage dedicated to the subject well by colored pencil or hatchure marks on the plat below.
2. If more than one lease is dedicated to the well, outline each and identify the ownership thereof (both as to working interest and royalty).
3. If more than one lease of different ownership is dedicated to the well, have the interests of all owners been consolidated by communitization, unitization, force-pooling, etc?

☐ Yes ☐ No If answer is "yes," type of consolidation _____

If answer is "no," list the owners and tract descriptions which have actually been consolidated. (Use reverse side of this form if necessary.) _____

No allowable will be assigned to the well until all interests have been consolidated (by communitization, unitization, forced-pooling, or otherwise) or until a non-standard unit, eliminating such interests, has been approved by the Commission.

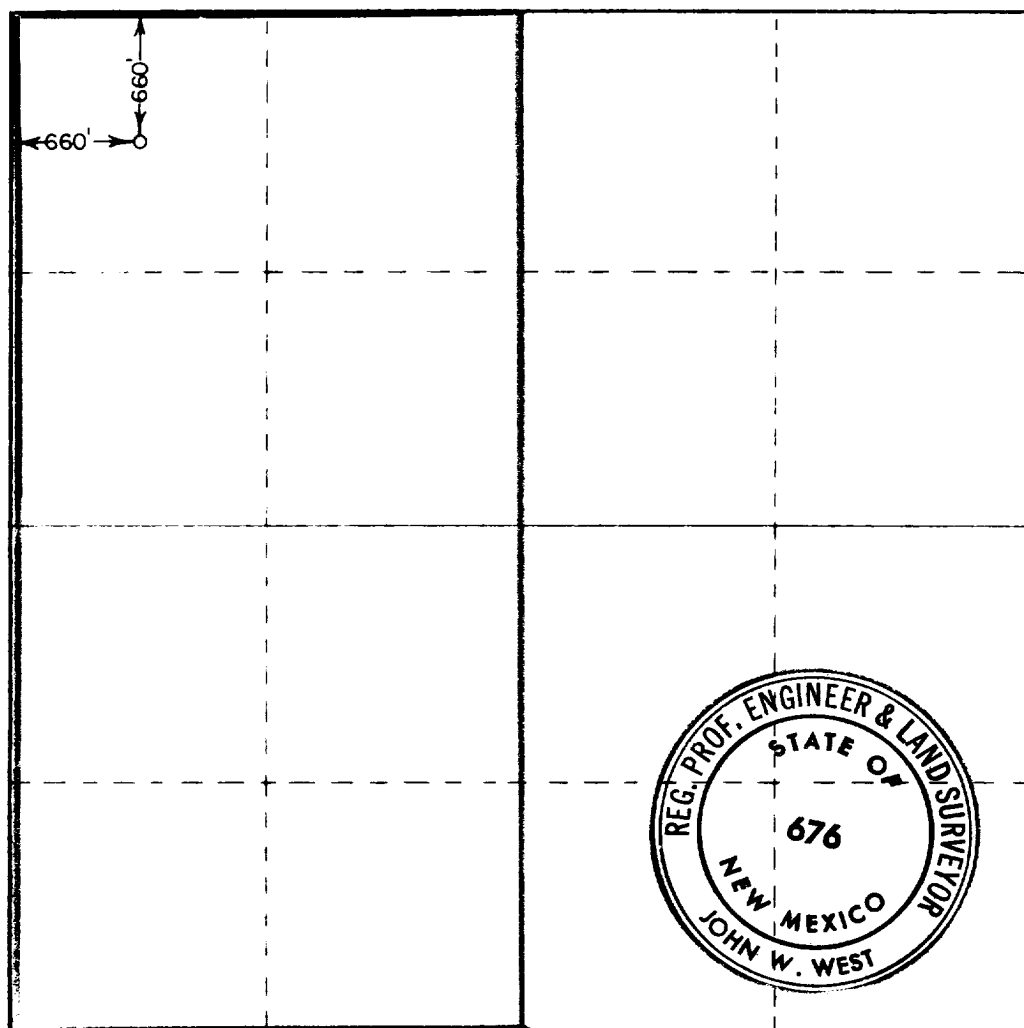

CERTIFICATION

I hereby certify that the information contained herein is true and complete to the best of my knowledge and belief.

Leon M. Lampert
Name

Leon M. Lampert

Position
Geologist

Company
Dalport Oil Corp.

Date
April 9, 1975

I hereby certify that the well location shown on this plat was plotted from field notes of actual surveys made by me or under my supervision, and that the same is true and correct to the best of my knowledge and belief.

Date Surveyed
April 2, 1975

Registered Professional Engineer and Land Surveyor

John W. West
Certificate No.

676

171

RECEIVED

APR 1 1973

U.S. CONSERVATION COMMISSION
WASHINGTON, D. C.