

NO. OF COPIES RECEIVED	
DISTRIBUTION	
SANTA FE	
FILE	
U.S.G.S.	
LAND OFFICE	
OPERATOR	

5A. Indicate Type of Lease
STATE ☒ REC ☐
5. State Oil & Gas Lease No.
K-6795

APPLICATION FOR PERMIT TO DRILL, DEEPEN, OR PLUG BACK

1a. Type of Work DRILL <input type="checkbox"/> DEEPEN <input type="checkbox"/> RE-ENTRY <input type="checkbox"/> PLUG BACK <input type="checkbox"/>		7. Unit Agreement Name	
b. Type of Well OIL WELL <input checked="" type="checkbox"/> GAS WELL <input type="checkbox"/> OTHER <input type="checkbox"/>		8. Farm or Lease Name Lovelady "ADN" State	
2. Name of Operator Yates Petroleum Corporation		9. Well No. 1	
3. Address of Operator 207 South Fourth Street - Artesia, NM 88210		10. Field and Pool, or Wildcat Wildcat	
4. Location of Well UNIT LETTER J LOCATED 1980 FEET FROM THE South LINE AND 1980 FEET FROM THE East LINE OF SEC. 31 TWP. 8S RGE. 33E NMPM		12. County Chaves	
19. Proposed Depth 5000'		19A. Formation San Andres	20. Rotary or C.T. Reverse Unit
21. Elevations (Show whether DF, RT, etc.) 4387.5' GR	21A. Kind & Status Plug. Bond Blanket	21B. Drilling Contractor Undesignated	22. Approx. Date Work will start ASAP

PROPOSED CASING AND CEMENT PROGRAM

SIZE OF HOLE	SIZE OF CASING	WEIGHT PER FOOT	SETTING DEPTH	SACKS OF CEMENT	EST. TOP
17"	13-3/8"	48#	410' - in place	400 sacks	Circulate
11"	8-5/8"	24 & 32#	3672' - in place	500 sacks	1800'
7-7/8"	5"	18#	9241' - in place	275 sacks	7900'

This well was originally drilled by Ike Lovelady, Inc. as the Lario State #1 in July, 1975. Completed on October 8, 1975. Current status of well is shut in. Yates Petroleum Corporation will be the operator of this well. We propose to plug back and complete in the San Andres formation. Will set a cement plug from 9200-9100'. Will attempt to pull tubing and perforate casing at approximately 5000' and cement to 3600'. Will perforate and stimulate the San Andres pay zone from 4430-4320' for production.

CHANGE OF OPERATOR WILL BECOME EFFECTIVE ON NOVEMBER 26, 1985.

IN ABOVE SPACE DESCRIBE PROPOSED PROGRAM; IF PROPOSAL IS TO DEEPEN OR PLUG BACK, GIVE DATA ON PRESENT PRODUCTIVE ZONE AND PROPOSED NEW PRODUCTIVE ZONE. GIVE BLOWOUT PREVENTER PROGRAM, IF ANY.

I hereby certify that the information above is true and complete to the best of my knowledge and belief.

Signed Chas R. May Title Regulatory Agent Date Nov. 20, 1985

(This space is for use by the operator)

APPROVED BY Edith W. Seay TITLE Oil & Gas Inspector DATE NOV 22 1985

CONDITIONS OF APPROVAL, IF ANY:

RECEIVED

NOV 21 1985

O.C.D.
HOSES OFFICE

All distances must be from the outer boundaries of the Section.

Operator YATES PETROLEUM CORPORATION			Lease LOVELADY "ADN" STATE		Well No. 1
Unit Letter J	Section 31	Township 8S	Range 33E	County Chaves	
Actual Footage Location of Well: 1980 feet from the South line and 1980 feet from the East line					
Ground Level Elev. 4387.5'	Producing Formation SAN ANDRES		Pool WILDCAT		Dedicated Acreage: 40 Acres

1. Outline the acreage dedicated to the subject well by colored pencil or hachure marks on the plat below.
2. If more than one lease is dedicated to the well, outline each and identify the ownership thereof (both as to working interest and royalty).
3. If more than one lease of different ownership is dedicated to the well, have the interests of all owners been consolidated by communitization, unitization, force-pooling, etc?

☐ Yes ☐ No If answer is "yes," type of consolidation _____

If answer is "no," list the owners and tract descriptions which have actually been consolidated. (Use reverse side of this form if necessary.) _____

No allowable will be assigned to the well until all interests have been consolidated (by communitization, unitization, forced-pooling, or otherwise) or until a non-standard unit, eliminating such interests, has been approved by the Division.

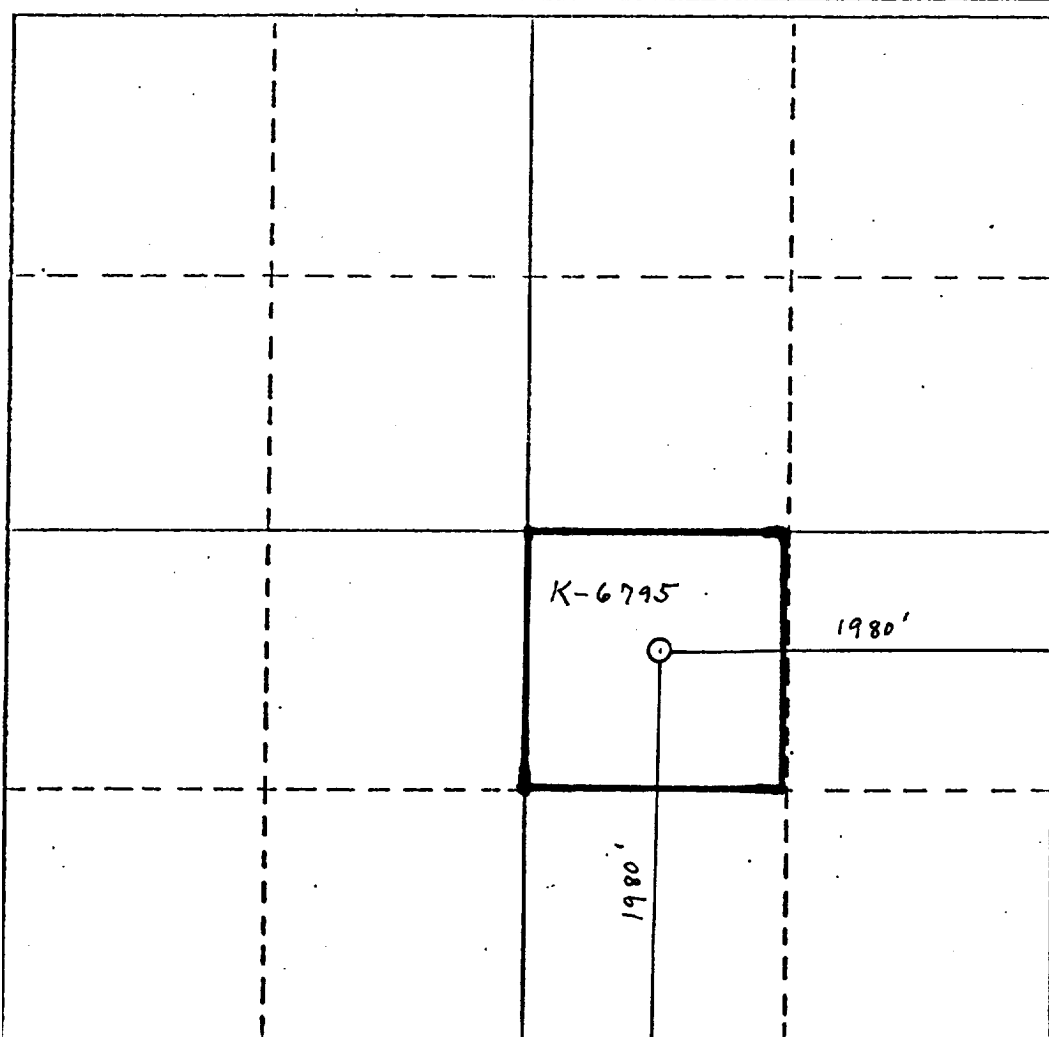

CERTIFICATION

I hereby certify that the information contained herein is true and complete to the best of my knowledge and belief.

Clifton May

Name

Clifton May

Position

Regulatory Agent

Company

Yates Petroleum Corporation

Date

November 20, 1985

I hereby certify that the well location shown on this plat was plotted from field notes of actual surveys made by me or under my supervision, and that the same is true and correct to the best of my knowledge and belief.

REFER TO ORIGINAL PLAT

Date Surveyed

Registered Professional Engineer
and/or Land Surveyor

Certificate No.

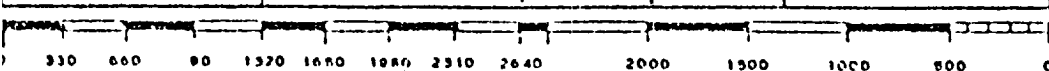

RECEIVED

NOV 21 1985

G.C.D.
HOBBS OFFICE