



## Instructions

**General:** This form is designed for submitting proposals to perform certain well operations, as indicated, on all types of lands and leases for appropriate action by either a Federal or a State agency, or both, pursuant to applicable Federal and/or State laws and regulations. Any necessary special instructions concerning the use of this form and the number of copies to be submitted, particularly with regard to local, area, or regional procedures and practices, either are shown below or will be issued by, or may be obtained from, the local Federal and/or State office.

**Item 1:** If the proposal is to redrill to the same reservoir at a different subsurface location or to a new reservoir, use this form with appropriate notations. Consult applicable State or Federal regulations concerning subsequent work proposals or reports on the well.

**Item 4:** If there are no applicable State requirements, locations on Federal or Indian land should be described in accordance with Federal requirements. Consult local State or Federal office for specific instructions.

**Item 14:** Needed only when location of well cannot readily be found by road from the land or lease description. A plat, or plats, separate or on this reverse side, showing the roads to, and the surveyed location of, the well, and any other required information, should be furnished when required by Federal or State agency offices.

**Items 15 and 18:** If well is to be, or has been directionally drilled, give distances for subsurface location of hole in any present or objective production zone.

**Item 22:** Consult applicable Federal or State regulations, or appropriate officials, concerning approval of the proposal before operations are started.

U.S. GOVERNMENT PRINTING OFFICE : 1963-O-711-396  
839•171

RECEIVED

DEC 8 1975

O. C. C.  
ARTESIA, OFFICE

RECEIVED  
DEC 9 1975  
OIL CONSERVATION COUNCIL  
ARTESIA, CALIF.

**NEW MEXICO OIL CONSERVATION COMMISSION  
WELL LOCATION AND ACREAGE DEDICATION PLAT**

Form C-102  
Supersedes C-128  
Effective 1-1-65

All distances must be from the outer boundaries of the Section.

Operator <b>Sundance Oil Company</b>			Lease <b>Amoco Federal</b>		Well No. <b>1</b>
Unit Letter <b>D</b>	Section <b>17</b>	Township <b>12 South</b>	Range <b>30 East</b>	County <b>Chaves</b>	
Actual Footage Location of Well: <div style="display: flex; justify-content: space-between; align-items: center;"> <span><b>660</b> feet from the <b>North</b> line and</span> <span><b>660</b> feet from the <b>West</b> line</span> </div>					
Ground Level Elev. <b>3879.1</b>	Producing Formation <b>Winn.</b>		Pool <b>Wildcat</b>	Dedicated Acreage: <b>40</b> Acres	

1. Outline the acreage dedicated to the subject well by colored pencil or hatchure marks on the plat below.
2. If more than one lease is dedicated to the well, outline each and identify the ownership thereof (both as to working interest and royalty).
3. If more than one lease of different ownership is dedicated to the well, have the interests of all owners been consolidated by communitization, unitization, force-pooling, etc?

☐ Yes    ☐ No    If answer is "yes," type of consolidation \_\_\_\_\_

If answer is "no," list the owners and tract descriptions which have actually been consolidated. (Use reverse side of this form if necessary.) \_\_\_\_\_

No allowable will be assigned to the well until all interests have been consolidated (by communitization, unitization, forced-pooling, or otherwise) or until a non-standard unit, eliminating such interests, has been approved by the Commission.

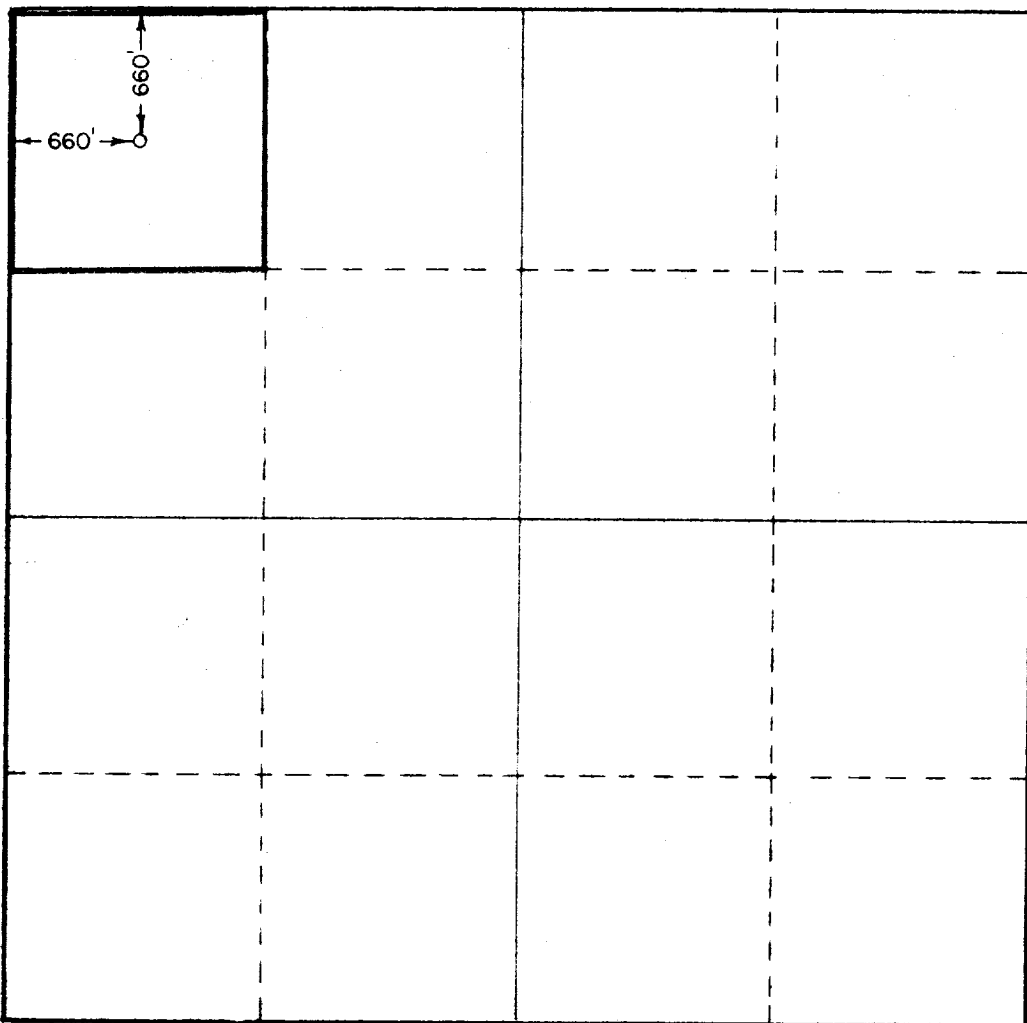

**CERTIFICATION**

I hereby certify that the information contained herein is true and complete to the best of my knowledge and belief.

*W. H. Morgan*  
 Name  
**William H. Morgan**  
 Position  
**Supt. Permian Basin Area**  
 Company  
**Sundance Oil Company**  
 Date  
**11/13/75**

**RECEIVED**  
**NOV 13 1975**  
 U.S. GEOLOGICAL SURVEY  
 ARTESIA, NEW MEXICO  
 I hereby certify that the well location shown on this plat was plotted from field notes of a survey made by me or under my supervision and that the same is true and correct to the best of my knowledge and belief.

**REGISTERED ENGINEER & LAND SURVEYOR**  
**STATE OF NEW MEXICO**  
 Date of Registration  
**October 23, 1975**  
 Registered Professional Engineer and Land Surveyor  
**676**  
*John W. West*  
 JOHN W. WEST

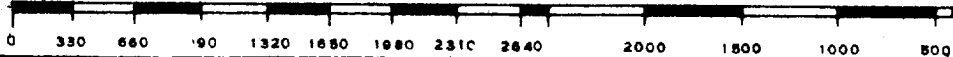

SUNDANCE OIL COMPANY  
Drawer I  
Artesia, New Mexico 88210

DEVELOPMENT PLAN FOR SURFACE USE  
UNITED STATES GEOLOGICAL SURVEY  
PERMIAN BASIN AREA

Date 11-10-75

Well Amoco Federal #1 Location Sec 17 Twn12S Rge30E

1. Existing roads including location of the exit from the main highway

Exhibit A

2. Planned access roads Exhibit B

3. Location of existing wells Sun Federal #1 1-13-29

Sohio Monterrey 27-12-30

Beveridge Federal 29-12-30

4. Lateral roads to well location No lateral roads will be built

unless production is encountered.

5. Location of tank batteries and flow lines

Battery will be on southeast corner of location

if production is found.

6. Location and type of water supply (rivers, creeks, lakes, ponds, well, etc.,)

There is no available water in this area. All water

will have to be hauled in.

7. Methods for handling waste disposal If waste water becomes a

factor, because of production, it will be hauled to a

disposal area.

8. Location of camps none

9. Location of airstrips none

10. Location of layout to include position of the rig, mud tanks, reserve pits, burn pits, pipe racks, etc., \_\_\_\_\_

Exhibit C

11. Plans for restoration of the surface \_\_\_\_\_

Should not be necessary.

12. Any other information that may be used in evaluating the impact on environment. Include general description of the topography, vegetation, and other aspects of the area.

The area of this well is sand dunes with scruboak,

beargrass, and very sparse vegetation.

Company Sundance Oil Company

Representative William D. Morgan

Phone: Ofc. 748-1266 Home 748-2325

Address Drawer I

Artesia, New Mexico 88210



# SUNDANCE OIL COMPANY

Amoco Federal #1  
Unit D  
Sec 17 Twn12S Rge30E

We would like to build a road 1 1/8 miles north west on an existing ranch road, at that point, go north 1 5/8 miles and angle north east 3/8 mile to location.

The reason for this angle to the north west, is to acquire caliche at about that point. This would allow us to haul both ways on this long length of road.

There will be a cattle guard to set, approximately 400' south of location in the fence line running east and west.

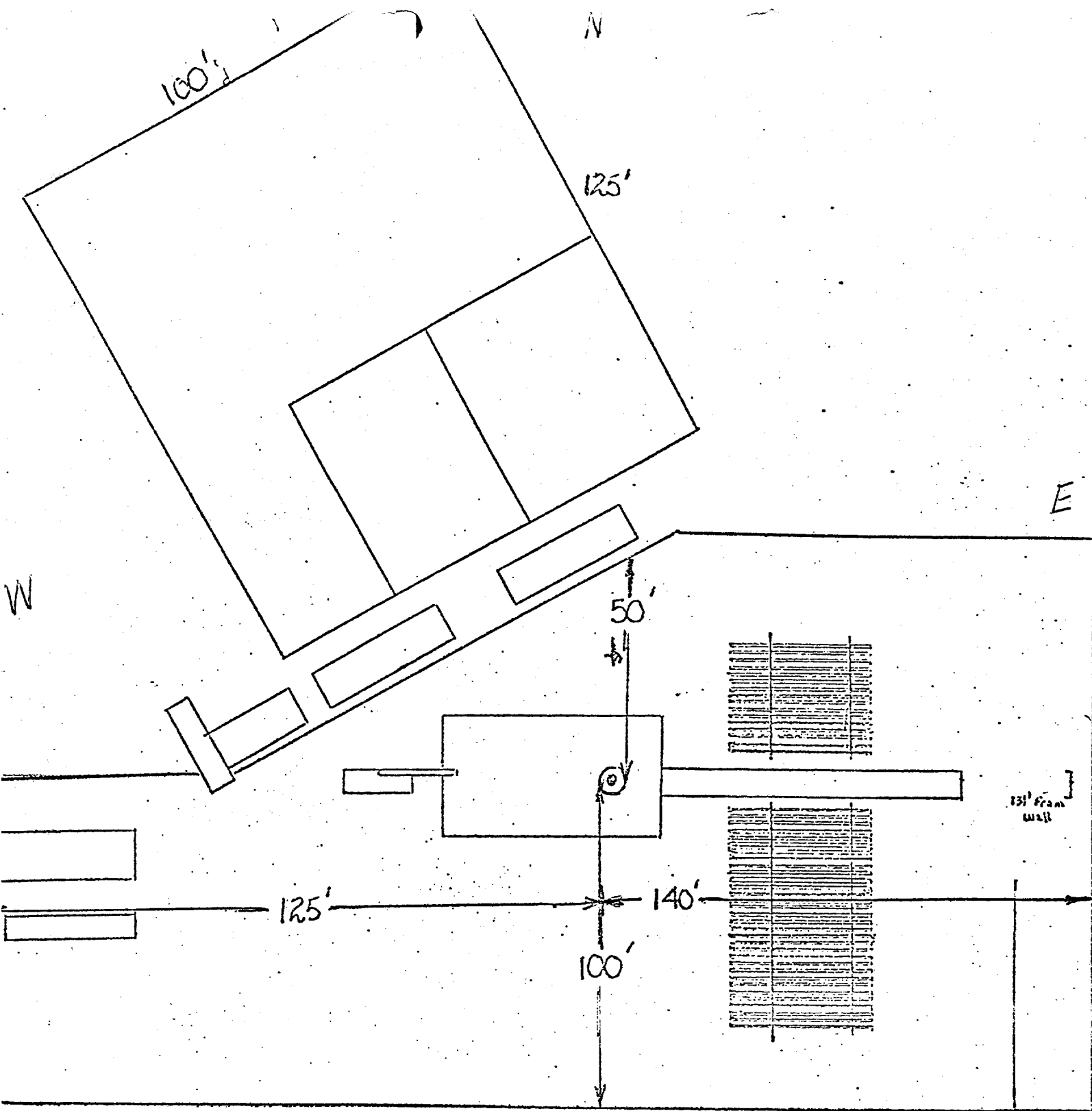

S  
MORANCO #9 & #5  
LOCATION PLAT.

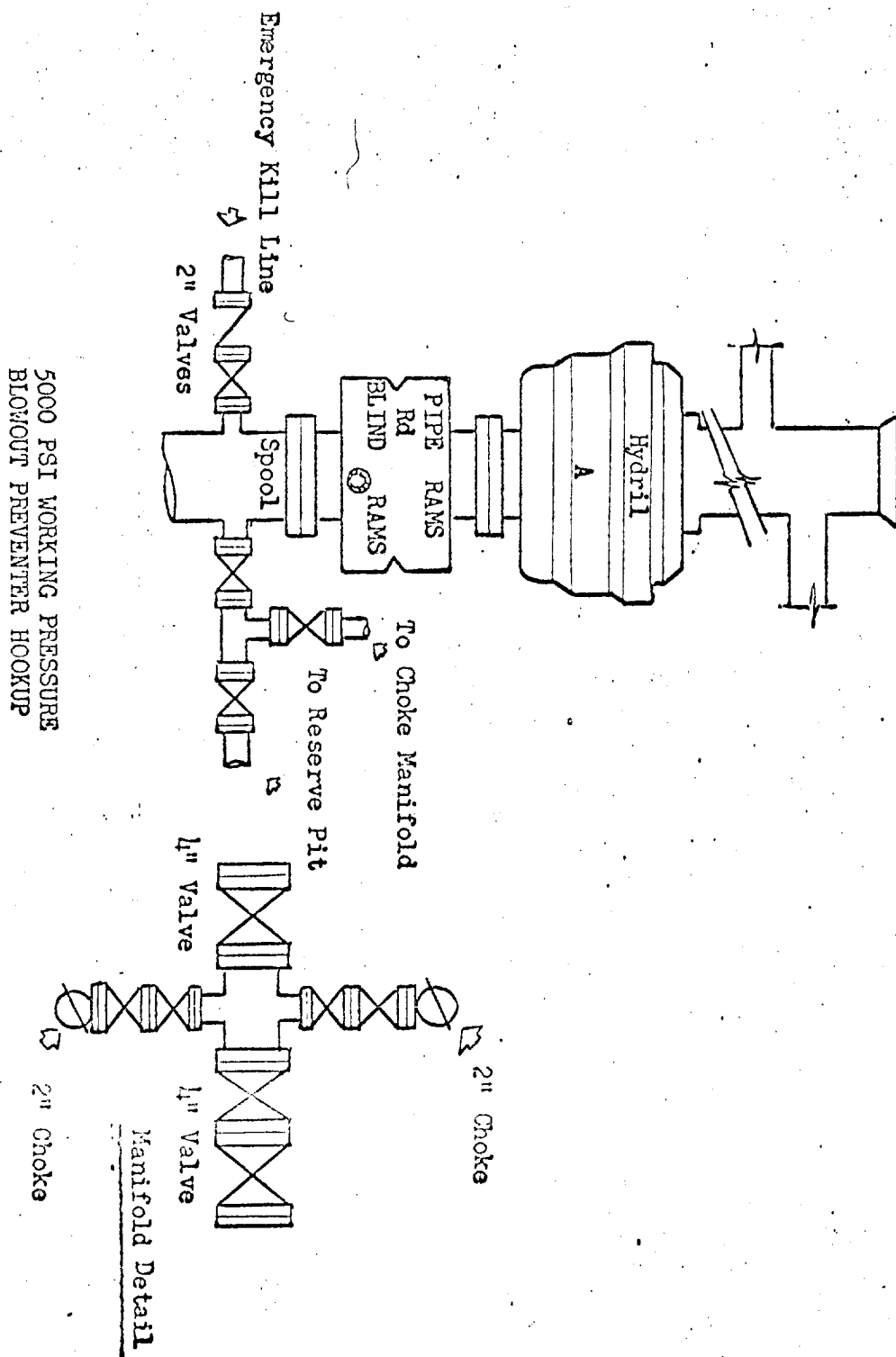



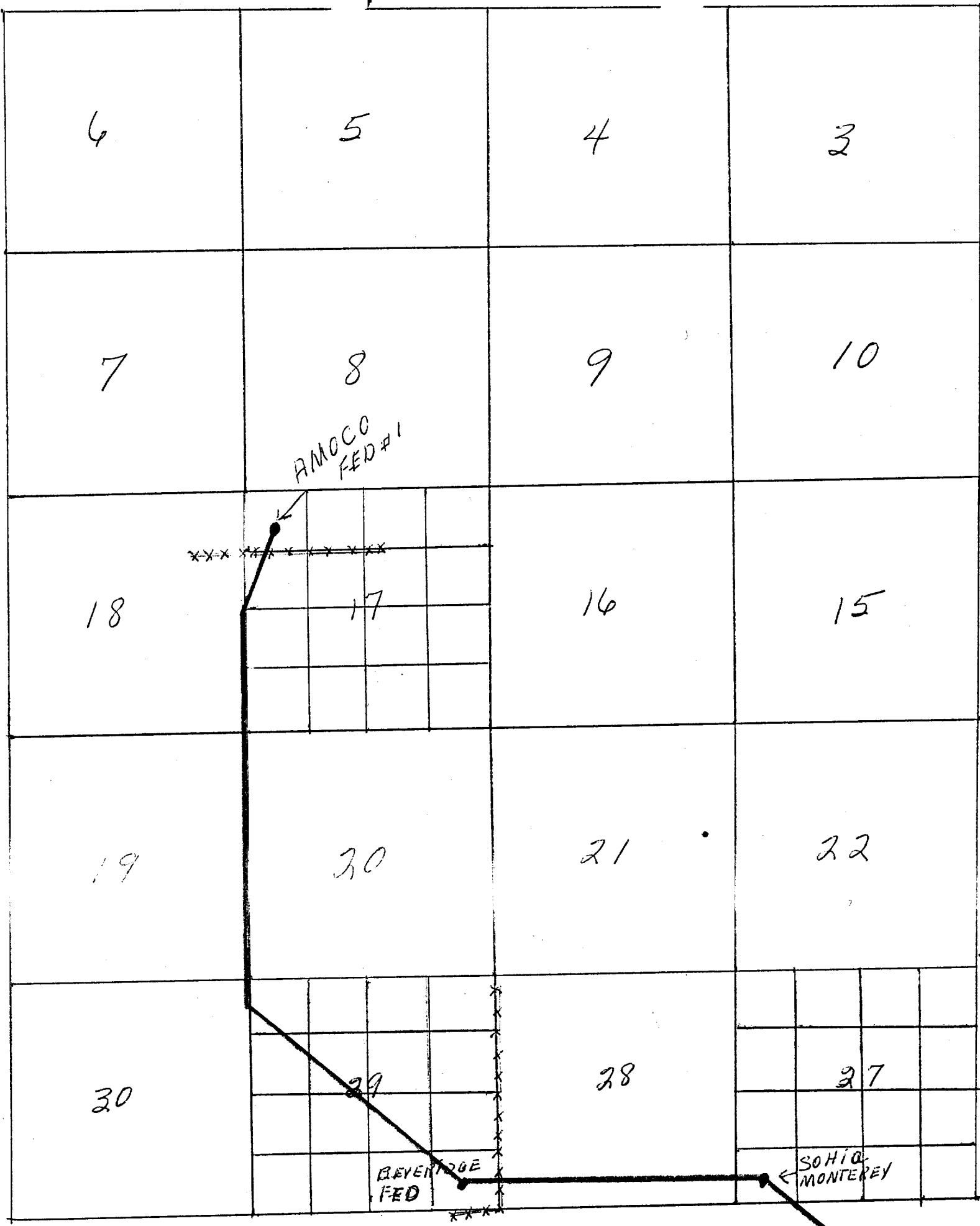

Sundance Oil Co.  
Amoco Federal #1  
10,000' Miss. Test

Chaves County, New Mexico  
Unit D - Section 17- 12S.-  
30E.

### Casing Program

- A. Surface Casing  
Set 13 3/8" at 300 feet
- B. Intermediate  
Set 8 5/8" or 9 5/8" at 2400 feet
- C. Production Casing  
Set 4 1/2" or 5 1/2" at 10,000 feet

### Remarks

- A. Drill 17 1/2" hole
- B. Drill 11" hole
- C. Drill 7 7/8" hole

### Recommended Mud Program

0 - 300' Drill with fresh water, spud mud of DMI Drilling Gel.  
A viscosity of 32-38 sec/1000 c.c. for proper hole  
cleaning in the surface interval.

If lost circulation is encountered mix pits full of mud  
and lost circulation materials, then if there are no  
returns, suggest dry drill to casing point.

300'-2400' Continue drilling with water. Add Salt Gel as required  
for additional viscosity to clean hole. Treat lost  
circulation as above.

Viscosity 32-34 sec/1000 c.c.  
Weight 9.8-10#/gal.  
Filtrate N.C.

2400'-5900' Drill with water and Lime for pH control.

Weight 8.6-9.0#/gal.

At this interval if lost circulation is experienced,  
mix fibrous materials so as to be suspended in viscous  
mud for effectively restoring circulation.

5900'-7200' Have 4 ppb Soltex in system and lower water loss to 10 c.c. or less to drill Abo section at 5960'.

At 7200 feet mud up with a low solids system of DMI Gel and Drispac. For mud up, these properties are suggested:

Viscosity 34-36 sec/1000 c.c.  
Weight 8.9-9.0#/gal.  
Filtrate 15.20 c.c.

For the Mississippi (approx. 8700') interval the following properties are suggested:

Viscosity 36-40 sec/1000 c.c.  
Weight 9.3#/gal.-9.8#/gal.  
Filtrate 5-6 c.c.'s

## REFERENCE WELL DATA

LOCATION:

OPERATOR Franklin, Aston & Fair, Inc.  
WELL NAME North King Camp Unit #11  
COUNTY Chaves DEPTH 10,268  
CONTRACTOR Moranco RIO 6  
LEGAL DISC. Sec. 35, T-13-S, R-29-E  
660' FSL, 660' FEL of Sec.

## FORMATION TOPS

Anhydrite @ 165 "	Abo @ 6000 "
Yates @ 1080 "	Wolfcamp @ 7050 "
Queen @ 1860 "	Strawn @ 8330 "
San Andres @ 2425 "	Atoka @ 9020 "
Glorieta @ 3750 "	Chester @ 9380 "
Tubb @ 5190 "	Miss. @ 9560 "

Devonian @ 10,075 ft.

# CASING PROGRAM

COND. 13-3/8 @ 285'  
SURFACE 8-5/8 @ 2450'  
1<sup>st</sup> INT. \_\_\_\_\_ @ \_\_\_\_\_  
2<sup>nd</sup> INT. \_\_\_\_\_ @ \_\_\_\_\_  
LINER \_\_\_\_\_ @ \_\_\_\_\_  
PROD. 4 1/2 @ 9764

BITS USED

17-3/4	1	RAN	Mr.
11	2	RAN	Mr.
7-7/8	10	RAN	Mr.

# TIME

SPUD DATE	9-21-74
DATE T.D.	11-5-74
TOTAL DAYS	51
DRILLING DAYS	
CASING DAYS	
TROUBLE DAYS	

## PROBLEMS

LOSS CIRC. @ \_\_\_\_\_  
WATER FLOW @ \_\_\_\_\_  
GAS KICK @ \_\_\_\_\_  
STUCK @ \_\_\_\_\_  
FISHING @ \_\_\_\_\_  
OTHER @ \_\_\_\_\_

Vert. Dev.  $\frac{1}{4}^{\circ}$  to  $1\frac{1}{4}^{\circ}$

## FLUID DATA AND REMARKS

[illegible]

# REFERENCE WELL DAT.

## LOCATION

OPERATOR	Union Oil Co. of California		
WELL NAME	Waller - /33 #1		
COUNTY	Chaves	DEPTH	8235
CONTRACTOR	Ard Drlg. Co.	RIO	6
LEGAL DISC.	Sec. 33 - 12S - 28E		

## FORMATION TOPS

@	@
@	@
@	@
@	@
@	@
@	@

## CASING PROGRAM

COND.	@
SURFACE	8-5/8 @ 1900
1 <sup>st</sup> INT.	@
2 <sup>nd</sup> INT.	@
LINER	@
PROD.	@

## BITS USED

12 1/4 inch	1	RAN	18-3/4	Hr.
11 inch	2	RAN	21 1/2	Hr.
7-7/8 inch	23	RAN	424-3/4	Hr.
inch		RAN		Hr.
inch		RAN		Hr.
inch		RAN		Hr.

## TIME

SPUD DATE	5-30-68
DATE T.D.	6-27-68
TOTAL DAYS	28
DRILLING DAYS	
CASING DAYS	
TROUBLE DAYS	

## PROBLEMS

LOSS CIRC.	@
WATER FLOW	@
GAS KICK	@
STUCK	@
FISHING	@
OTHER	@

Vert. Dev. 3/4°-3°

## FLUID DATA AND REMARKS

DATE	DEPTH	WEIGHT	VISCOSITY	WATER LOSS	FLUID TYPE
	1695	10.2	32	N/C	
	Set 8-5/8" csg @ 1900 6/2/68				
	4738				H <sub>2</sub> O
	5196	9.0	33	N/C	Mud up ABO
	5943	9.2	39	N/C	
	6931	9.3	36	N/C	
	7342	9.1	34	N/C	
	7846	9.3	38	8.0	
	7951	9.3	38	8.0	
	8220	9.2	38	8.0	
	8235	9.2	39	8.4	

# REFERENCE WELL DATA

## LOCATION

OPERATOR	Rodman Corp.		
WELL NAME	5 North King Camp Unit		
COUNTY	Chaves	DEPTH	
CONTRACTOR	Moran Oil Prod.	R/O	6
LEGAL DISC.	Sec. 17, T-13-S, R-29-E		
	1980' FSL, 1980' FWL of Sec.		

## FORMATION TOPS

Yates @ 750 "	Wolfcamp @ 6770 "
Queen @ 1470 "	Morrow @ 8310 "
San Andres @ 2045 "	Miss. @ 8720 "
Glorieta @ 3430 "	@ "
Tubb @ 4885 "	@ "
Abo @ 5690 "	@ "

## CASING PROGRAM

COND.	@	
12-3/4	@	294'
SURFACE	@	
8-5/8	@	2223'
1st INT.	@	
2nd INT.	@	
LINER	@	
PROD.	@	

## BITS USED

15	Inch	1	RAN	4	Hr
11	Inch	2	RAN	36-3/4	Hr
7-7/8	Inch	19	RAN	423 1/2	Hr
	Inch		RAN		Hr
	Inch		RAN		Hr
	Inch		RAN		Hr

## TIME

SPUD DATE	7-29-71
DATE T.O.	8-27-71
TOTAL DAYS	29
DRILLING DAYS	
CASING DAYS	
TROUBLE DAYS	

## PROBLEMS

LOSS CIRC.	@	
WATER FLOW	@	
GAS KICK	@	
STUCK	@	
FISHING	@	
OTHER	@	

Vert. Dev. 1/4° to 3/4°

## FLUID DATA AND REMARKS

DATE	DEPTH	WEIGHT	VISCOSITY	WATER LOSS	FLUID TYPE
	Set 12-3/4" csg @ 294'				
	Set 8-5/8" csg @ 2223'				
	4863				H <sub>2</sub> O
	5200				Mud up
	5370	9.1	34	N/C	
	5925	9.3	34	N/C	
	7796	9.5	37	N/C	
	8019	9.0	32	46.0	
	8122	9.3	37	36.0	
	8482	9.3	39	12.0	
8-24-71	8778	9.2	37		

## REFERENCE WELL DATA

LOCATION

OPERATOR	Pan American Pet. Co.		
WELL NAME	#1 North King Camp Fed. Unit		
COUNTY	Chaves	DEPTH	9311
CONTRACTOR	Noble Drllg. Co.	RIG	N-6
LEGAL DISC.	Sec. 22, T-13-S, R-29-E		
1980' FNL, 1980' FWL of Sec.			

FORMATION TOPS

Yates @ 946 "	Wolfcamp @ 7054 "
Queen @ 1661 "	Canyon @ 8125 "
San Andres @ 2275 "	Strawn @ 8460 "
Glorieta @ 3642 "	Atoka @ 8838 "
Drinkard @ 5085 "	Lower Missa 9242 "
Abo @ 5880 "	@ "

# CASING PROGRAM

COND. \_\_\_\_\_ (a) \_\_\_\_\_  
SURFACE 13-3/8" 274'  
9-5/8" 2327'  
1<sup>st</sup> INT. \_\_\_\_\_ (a) \_\_\_\_\_  
2<sup>nd</sup> INT. \_\_\_\_\_ (a) \_\_\_\_\_  
LINER \_\_\_\_\_ (a) \_\_\_\_\_  
PROD. \_\_\_\_\_ (a) \_\_\_\_\_

BITS USED

17 $\frac{1}{2}$ inch	1	RAN	9 $\frac{1}{2}$ Hr.
12 $\frac{3}{4}$ inch	2	RAN	16 Hr.
8-3/4 inch	17	RAN	534 $\frac{1}{4}$ Hr.
inch		RAN	Hr.
inch		RAN	Hr.
inch		RAN	Hr.
inch		RAN	Hr.

## TIME

SPUD DATE	8-25-68
DATE T.D.	10-21-68
TOTAL DAYS	56
DRILLING DAYS	51
CASING DAYS	2
TROUBLE DAYS	

## PROBLEMS

LOSS CIRC. @ \_\_\_\_\_  
WATER FLOW @ \_\_\_\_\_  
GAS KICK @ \_\_\_\_\_  
STUCK @ \_\_\_\_\_  
FISHING @ \_\_\_\_\_  
OTHER @ 3 DST'S

Vert. Dev.  $\frac{1}{4}^{\circ}-1^{\circ}$

## FLUID DATA AND REMARKS

DATE	DEPTH	WEIGHT	VISCOSITY	WATER LOSS	FLUID TYPE
Set 13-3/8" csg @ 274'					
Set 9-5/8" csg @ 2327'					
	2634	8.6	48		Mud up to test
	2800	8.9	38		
9-15-68	6673	8.9	35	N/C	
	6849	8.9	38		
	9311	TD	Plugged & Abandoned		

## REFERENCE WELL DATA

LOCATION'

OPERATOR Franklin Aston & Fair  
WELL NAME #12 North King Camp Unit  
COUNTY Chaves DEPTH 10,060  
CONTRACTOR Moranco RIG 6  
LEGAL DISC. Sec. 36, T-13-S, R-29-E  
1980' FNL, 660' FWL of Sec.  
2 N. & 19 E./Hagerman

## FORMATION TOPS

San Andres	@ 2450	"	Chester	@ 9,340	"
Glorieta	@ 3760	"	Devonian	@ 10,020	"
Tubb	@ 5200	"		@	"
Abo	@ 6020	"		@	"
Wolfcamp	@ 7040	"		@	"
Strawn	@ 8300	"		@	"

# CASING PROGRAM

COND. 13-3/8 @ 318'  
SURFACE 8-5/8 @ 2450'  
1<sup>st</sup> INT. \_\_\_\_\_ @ \_\_\_\_\_  
2<sup>nd</sup> INT. \_\_\_\_\_ @ \_\_\_\_\_  
LINER \_\_\_\_\_ @ \_\_\_\_\_  
PROD. \_\_\_\_\_ @ \_\_\_\_\_

BITS USED

17 $\frac{1}{2}$	Inch	1	RAN	9	Hr.
11	Inch	2	RAN	26 $\frac{1}{4}$	Hr
7-7/8		13		742 $\frac{1}{2}$	
	Inch		RAN		Hr.
	Inch		RAN		Hr.
	Inch		RAN		Hr.
	inch		RAN		Hr.

## TIME

SPUD DATE	5-13-75
DATE T.D.	6-25-75
TOTAL DAYS	45
DRILLING DAYS	41
CASING DAYS	2
TROUBLE DAYS	

## PROBLEMS

LOSS CIRC. @ \_\_\_\_\_  
WATER FLOW @ \_\_\_\_\_  
GAS KICK @ \_\_\_\_\_  
STUCK @ \_\_\_\_\_  
FISHING @ \_\_\_\_\_  
OTHER @ 2 DST's

Vert. Dev.  $\frac{1}{4}^{\circ}$  to  $2^{\circ}$

## FLUID DATA AND REMARKS

DATE	DEPTH	WEIGHT	VISCOSITY	WATER LOSS	FLUID TYPE
Set 13-3/8" csg @ 318'					
Set 8-5/8" csg @ 2450'					
					H <sub>2</sub> O
3167					H <sub>2</sub> O
6-18-75	7800	9.2	36	9	Mud Up
	9255	9.1	40	12.2	
	9775	9.2	55	15	
	10,024	9.3	40	14	
Plugged & Abandoned					