

UNITED STATES
DEPARTMENT OF THE INTERIOR
GEOLOGICAL SURVEY

APPLICATION FOR PERMIT TO DRILL, DEEPEN, OR PLUG BACK

1a. TYPE OF WORK

DRILL ☒DEEPEN ☐PLUG BACK ☐

b. TYPE OF WELL

OIL
WELL ☒GAS
WELL ☐

OTHER

SINGLE
ZONE ☒MULTIPLE
ZONE ☐

2. NAME OF OPERATOR

UNION TEXAS PETROLEUM CORPORATION

3. ADDRESS OF OPERATOR

1300 Wilco Building, Midland, Texas 79701

4. LOCATION OF WELL (Report location clearly and in accordance with any State requirements.*)

At surface

660' FSL & 660' FEL, (Unit Letter "P")

At proposed prod. zone

Same

14. DISTANCE IN MILES AND DIRECTION FROM NEAREST TOWN OR POST OFFICE*

13 miles south of Kenna

15. DISTANCE FROM PROPOSED*

LOCATION TO NEAREST
PROPERTY OR LEASE LINE, FT.
(Also to nearest drlg. unit line, if any)

16. NO. OF ACRES IN LEASE

320

17. NO. OF ACRES ASSIGNED
TO THIS WELL

40

18. DISTANCE FROM PROPOSED LOCATION*
TO NEAREST WELL, DRILLING, COMPLETED,
OR APPLIED FOR, ON THIS LEASE, FT.

19. PROPOSED DEPTH

4000'

20. ROTARY OR CABLE TOOLS

Rotary

21. ELEVATIONS (Show whether DF, RT, GR, etc.)

4288.7' GR

22. APPROX. DATE WORK WILL START*

December 15, 1975

23.

PROPOSED CASING AND CEMENTING PROGRAM

SIZE OF HOLE	SIZE OF CASING	WEIGHT PER FOOT	SETTING DEPTH	QUANTITY OF CEMENT
11"	8 5/8"	24#	400'	200 Sx.
7 7/8"	4 1/2"	10.79#	4000'	200 Sx.

Proposed to drill and equip an oil well to depth of approximately 4000' into the San Andres Zone.

Well control equipment will comply with API 3M Rds. Specifications.

RECEIVED
NOV 14 1975
U.S. GEOLOGICAL SURVEY
ARTESIAN NEW MEXICO

IN ABOVE SPACE DESCRIBE PROPOSED PROGRAM: If proposal is to deepen or plug back, give data on present productive zone and proposed new productive zone. If proposal is to drill or deepen directionally, give pertinent data on subsurface locations and measured and vertical depths. Give blowout preventer program, if any.

24.

SIGNED

Stanley A. Dost

TITLE Gas Measurement Analyst

DATE 11-11-75

(This space for Federal or State office use)

PERMIT NO.

APPROVED BY

CONDITIONS OF APPROVAL

DEC 9 1975
H. L. BECKING
ACTING DISTRICT ENGINEER

THIS APPROVAL

ARE NOT

EXPIRES

MAR 9 - 1976

DATE

*See Instructions On Reverse Side

RECEIVED

DEC 10 1975
WIL CONSERVATION
BUREAU

RECEIVED

DEC 10 1975

O. C. C.
ARTESIA, OFFICE

NEW MEXICO OIL CONSERVATION COMMISSION
WELL LOCATION AND ACREAGE DEDICATION PLAT

Form 7-75
Supersedes 6-1-74
Effective 1-1-75

All distances must be from the outer boundaries of the Section

Union Texas Petroleum Corporation			Federal 33		1
Section	Township	Range	County		
P	33	7 South	31 East Chaves		
Acres Dedicated to Well					
660	feet from the	South	660	feet from the	East
4288.7	San Andres		Tom-Tom (San Andres)		40

1. Outline the acreage dedicated to the subject well by colored pencil or hachure marks on the plot below.
2. If more than one lease is dedicated to the well, outline each and identify the ownership thereof (both as to working interest and royalty).
3. If more than one lease of different ownership is dedicated to the well, have the interests of all owners been consolidated by communitization, unitization, force-pooling, etc?

Yes No If answer is "yes," type of consolidation _____

If answer is "no," list the owners and tract descriptions which have actually been consolidated (on reverse side of this form if necessary.) _____

No allowable will be assigned to the well until all interests have been consolidated (by communitization, unitization, forced-pooling, or otherwise) or until a non-standard unit, eliminating such interests, has been approved by the Commission.

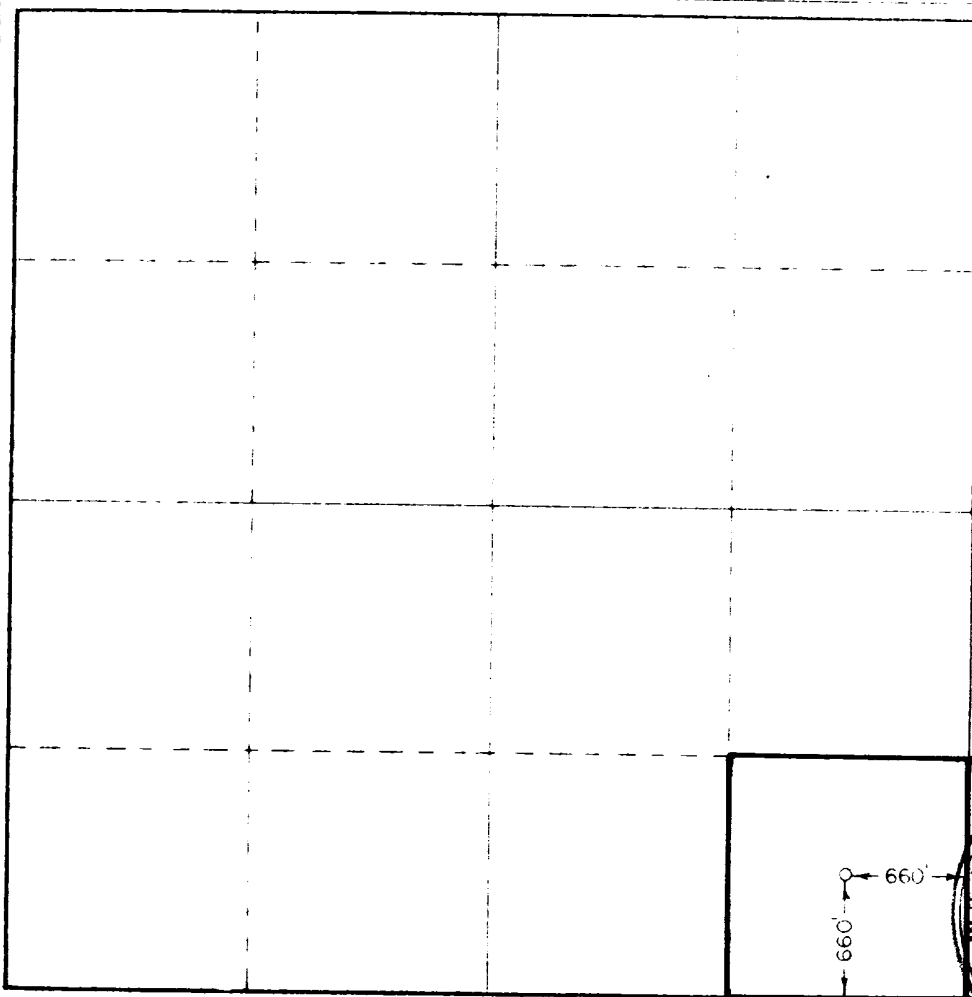

CERTIFICATION

I hereby certify that the information contained herein is true and complete to the best of my knowledge and belief.

Stanley A. Post

Stanley A. Post

Gas Measurement Analyst

UNION TEXAS PETROLEUM CORP.

November 11, 1975

I hereby certify that the well location shown on this plat was plotted from field notes of actual surveys made by me or under my supervision and that the same is true and correct to the best of my knowledge and belief.

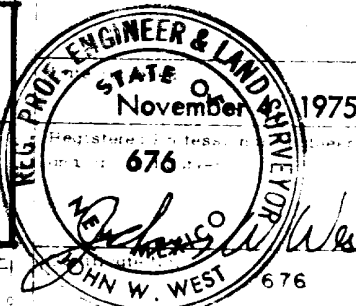

330 660 990 1320 1650 1980 2310 2640 2970 3300

RECEIVED

SEP 13 1975

OIL CONSERVATION COMM.
ROCKS, N. M.

DEVELOPMENT PLAN FOR SURFACE USE

1. Existing roads including location of the exit from the main highway.
See Attached Map. Main access from highway 70 is marked with a red X.
2. Planned access roads.
See attached Map. The proposed access road to this location is marked in red.
This will be a compacted road. The road will be approximately 12' wide and 1320' long.
3. Location of existing wells.
See Attached Map. All existing wells in the area are marked with a dot.
4. Lateral roads to well locations.
See Attached Map.
5. Location of tank batteries and flow lines.
Union Texas Petroleum Corporation has no tank batteries or flow lines in the area.
Tank batteries and wells are marked on the attached Map.
6. Location and type of water supply (rivers, creeks, lakes, ponds, well, etc.)
There is no water supply in this area for drilling this well. The water used to drill this well will be hauled in by trucks.
7. Methods for handling waste disposal.
Waste will be disposed of in a earth dug pit which will be covered with approximately 2' of soil upon completion of this well.
8. Location of camps.
None
9. Location of airstrips.
None
10. Location of layout to include position of the rig, mud tanks, reserve pits, burn pits, pipe racks, etc.
See Attached Plat of rig layout.
Drilling pad will be compacted.
11. Plans for restoration of the surface.
Upon completion of this well, all pits will be covered and the area will be levelled and restored to its' natural state. A fence located approximately 100' east of this location which will have to be moved approximately 50' east for 100' while drilling this well, will be returned to its' original location upon completion of the well.
12. Any other information that may be used in evaluating the impact on environment.
Include general description of the topography, vegetation, and other aspects of the area.
The topography of the area is generally flat with sand dunes. The vegetation is mainly shage brush and shinnery with very little grass. The soil is sandy.
13. Dick Younie - AC505/396-5128 is our Field Representative responsible for compliance of The Development Plan for Surface Use.

RECEIVED

FEB 12 1975

OIL CONSERVATION COMM.
HOBBS, N. M.

APPROXIMATE LOCATION SIZE &
 APPROXIMATE RIG LAYOUT

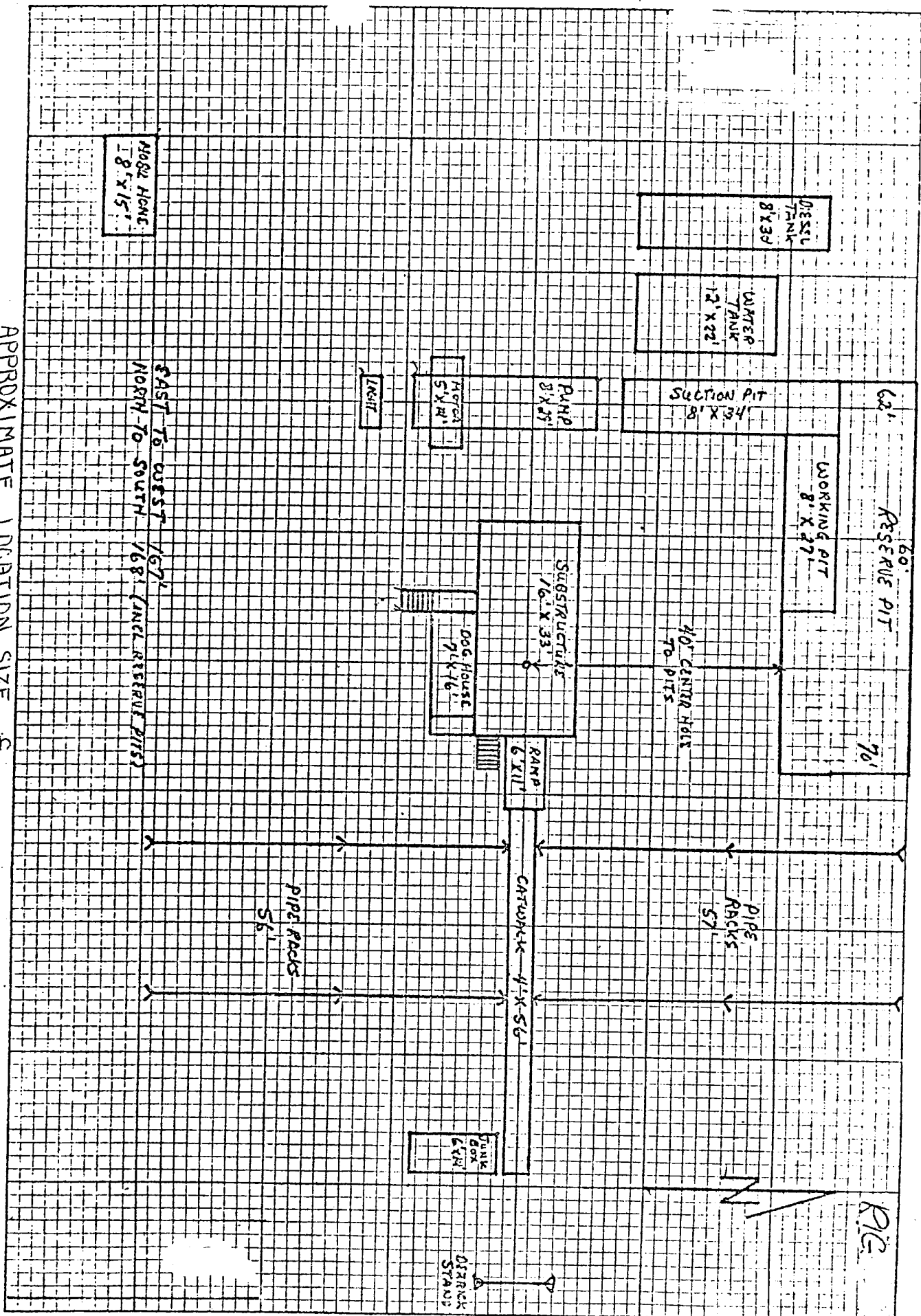

RECEIVED

SEP 18 1975
OIL CONSERVATION COMM.
HOBBS, N. M.

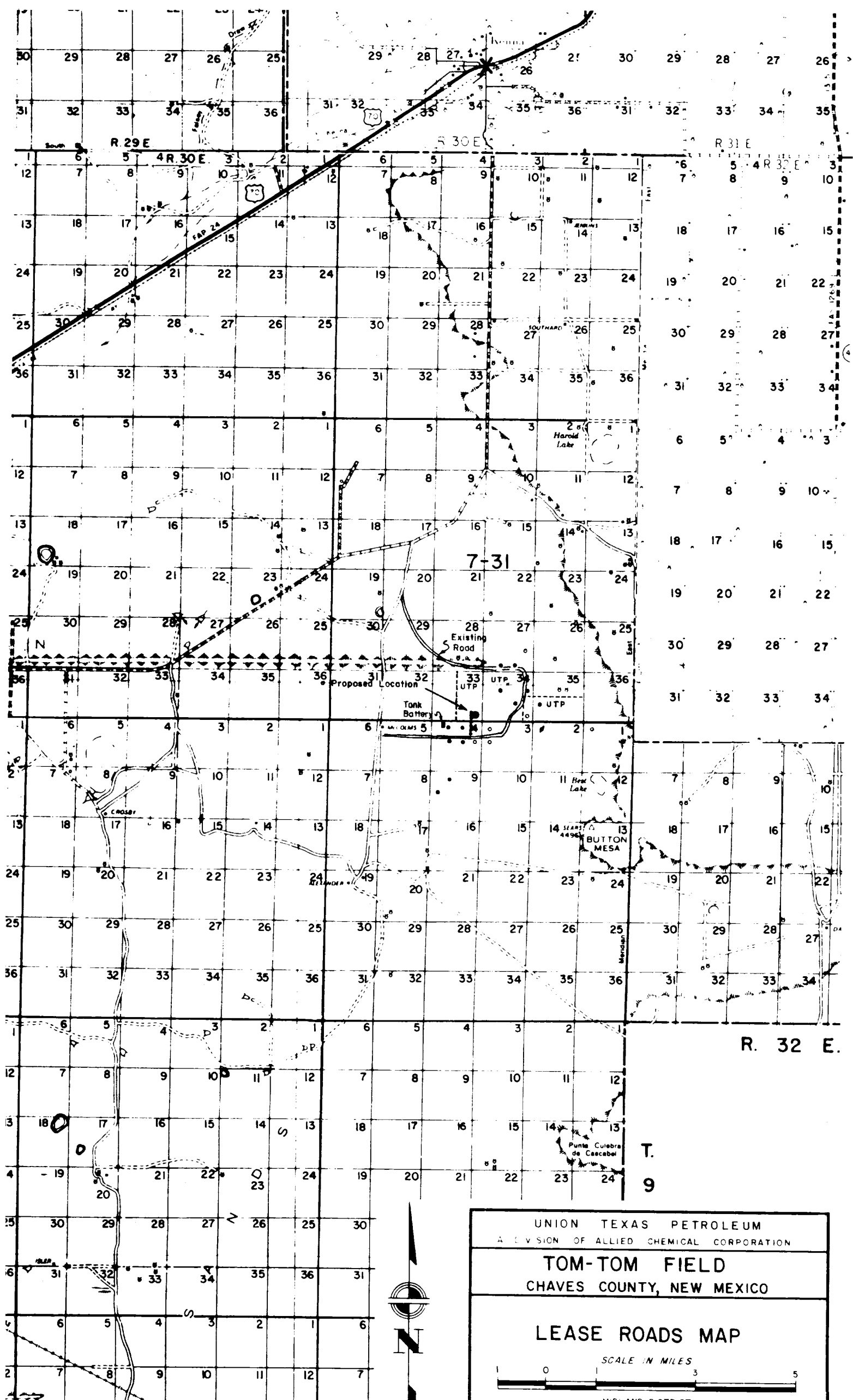

UNION TEXAS PETROLEUM	
A DIVISION OF ALLIED CHEMICAL CORPORATION	
TOM-TOM FIELD	
CHAVES COUNTY, NEW MEXICO	
LEASE ROADS MAP	
SCALE IN MILES	

RECEIVED

SEP 12 1975

OIL CONSERVATION COMM.
HOBBS, N. M.