

NO. OF COPIES RECEIVED	
DISTRIBUTION	
SANTA FE	
FILE	
U.S.G.S.	
LAND OFFICE	
OPERATOR	

# NEW MEXICO OIL CONSERVATION COMMISSION

Form C-101  
Revised 1-1-65

5A. Indicate Type of Lease  
STATE ☐ FEE ☒

5. State Oil & Gas Lease No.

## APPLICATION FOR PERMIT TO DRILL, DEEPEN, OR PLUG BACK

1a. Type of Work b. Type of Well OIL WELL <input checked="" type="checkbox"/> GAS WELL <input type="checkbox"/> OTHER <input type="checkbox"/> SINGLE ZONE <input checked="" type="checkbox"/> MULTIPLE ZONE <input type="checkbox"/>		7. Unit Agreement Name
2. Name of Operator Wolfson Oil Company		8. Farm or Lease Name Marshall
3. Address of Operator 3206 Republic Bank Tower Dallas, Texas		9. Well No. 1
4. Location of Well UNIT LETTER T LOCATED 2310 FEET FROM THE North LINE AND 330 FEET FROM THE East LINE OF SEC. 6 TWP. 9-S RGE. 30-E NMPM		10. Field and Pool, or Whichever Cato
12. County Chaves		
19. Proposed Depth 3400		19A. Formation San Andres
20. Rotary or C.T. Rotary		
21. Elevations (Show whether DF, RT, etc.) 4150 GR	21A. Kind & Status Plug. Bond 552-612 Travelers	21B. Drilling Contractor MGF Drlg
22. Approx. Date Work will start 2-1-76		

## PROPOSED CASING AND CEMENT PROGRAM

SIZE OF HOLE	SIZE OF CASING	WEIGHT PER FOOT	SETTING DEPTH	SACKS OF CEMENT	EST. TOP
11	8 5/8	24	300	175	Surface
7 7/8	4 1/2	9.5	3400	175	2700

IN ABOVE SPACE DESCRIBE PROPOSED PROGRAM: IF PROPOSAL IS TO DEEPEN OR PLUG BACK, GIVE DATA ON PRESENT PRODUCTIVE ZONE AND PROPOSED NEW PRODUCTIVE ZONE. GIVE BLOWOUT PREVENTER PROGRAM, IF ANY.

I hereby certify that the information above is true and complete to the best of my knowledge and belief.

Signed J. J. Freedman Title Prod. Engr. Date 1-15-76

(This space for State Use)

APPROVED BY Jerry Selter TITLE DATE

CONDITIONS OF APPROVAL, IF ANY:

NEW MEXICO OIL CONSERVATION COMMISSION  
WELL LOCATION AND ACREAGE DEDICATION PLAT

Form C-102  
Supersedes C-128  
Effective 1-1-65

All distances must be from the outer boundaries of the Section.

Operator <b>Wolfson Oil Company</b>			Lease <b>Marshall</b>		Well No. <b>1</b>
Unit Letter <b>H</b>	Section <b>6</b>	Township <b>9 S</b>	Range <b>30 E</b>	County <b>Chaves</b>	
Actual Footage Location of Well: <b>2310</b> feet from the <b>north</b> line and <b>330</b> feet from the <b>east</b> line					
Ground Level Elev. <b>4150</b>	Producing Formation <b>San Andres</b>		Pool <b>Cato</b>		Dedicated Acreage: <b>40</b> Acres

1. Outline the acreage dedicated to the subject well by colored pencil or hatchure marks on the plat below.
2. If more than one lease is dedicated to the well, outline each and identify the ownership thereof (both as to working interest and royalty).
3. If more than one lease of different ownership is dedicated to the well, have the interests of all owners been consolidated by communitization, unitization, force-pooling, etc?

☐ Yes ☐ No If answer is "yes," type of consolidation \_\_\_\_\_

If answer is "no," list the owners and tract descriptions which have actually been consolidated. (Use reverse side of this form if necessary.) \_\_\_\_\_

No allowable will be assigned to the well until all interests have been consolidated (by communitization, unitization, forced-pooling, or otherwise) or until a non-standard unit, eliminating such interests, has been approved by the Commission.

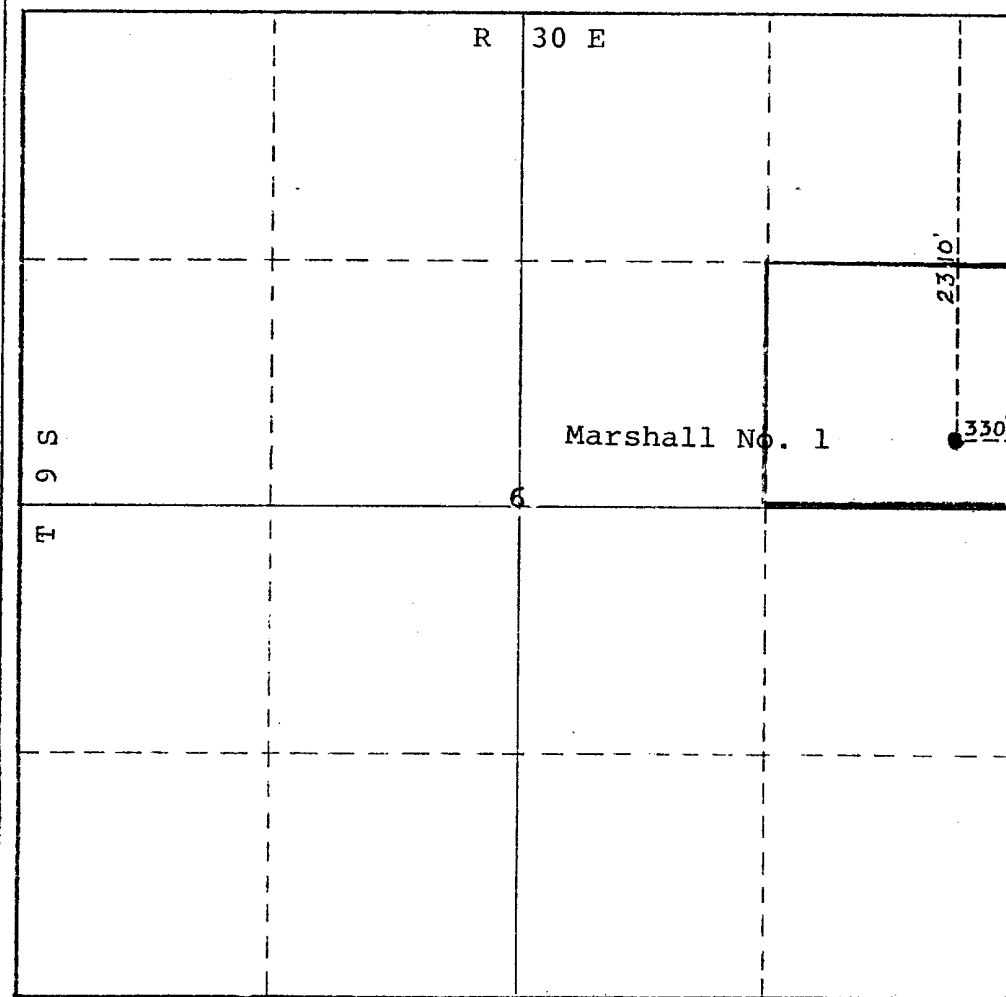

CERTIFICATION

I hereby certify that the information contained herein is true and complete to the best of my knowledge and belief.

*A.G. Freedman*  
Name

Prod. Engr.  
Position

**Wolfson Oil Company**  
Company

**1-16-76**  
Date

I hereby certify that the well location shown on this plat was plotted from field notes of actual surveys made by me or under my supervision, and that the same is true and correct to the best of my knowledge and belief.

Date Surveyed  
**January 12, 1976**

Registered Professional Engineer  
and/or Land Surveyor

*Thomas J. Mann*  
Certificate No.

**277 N.M.**

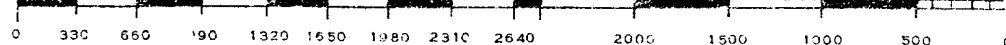

COPIES RECEIVED	
DISTRIBUTION	
SANTA FE	
FILE	
U.S.G.S.	
LAND OFFICE	
OPERATOR	

# NEW MEXICO OIL CONSERVATION COMMISSION

Form C-103  
Supersedes Old  
C-102 and C-103  
Effective 1-1-65

5a. Indicate Type of Lease	
State <input type="checkbox"/>	Fee <input checked="" type="checkbox"/>
5. State Oil & Gas Lease No.	

## SUNDRY NOTICES AND REPORTS ON WELLS (DO NOT USE THIS FORM FOR PROPOSALS TO DRILL OR TO DEEPEN OR PLUG BACK TO A DIFFERENT RESERVOIR. USE "APPLICATION FOR PERMIT -" (FORM C-101) FOR SUCH PROPOSALS.)

1. OIL WELL <input checked="" type="checkbox"/> GAS WELL <input type="checkbox"/> OTHER <input type="checkbox"/>		7. Unit Agreement Name
2. Name of Operator <b>Wolfson Oil Company</b>		8. Farm or Lease Name <b>Marshall</b>
3. Address of Operator <b>3206 Republic Bank Tower Dallas, Texas</b>		9. Well No. <b>1</b>
4. Location of Well UNIT LETTER <b>W</b> <b>330</b> FEET FROM THE <b>East</b> LINE AND <b>2310</b> FEET FROM THE <b>North</b> LINE, SECTION <b>6</b> TOWNSHIP <b>2-S</b> RANGE <b>30E</b> NMPM.		10. Field and Pool, or Wildcat <b>Cato</b>
15. Elevation (Show whether DF, RT, GR, etc.) <b>4150 CE</b>		12. County <b>Chaves</b>

## Check Appropriate Box To Indicate Nature of Notice, Report or Other Data NOTICE OF INTENTION TO: SUBSEQUENT REPORT OF:

PERFORM REMEDIAL WORK <input type="checkbox"/>	PLUG AND ABANDON <input type="checkbox"/>	REMEDIAL WORK <input type="checkbox"/>	ALTERING CASING <input type="checkbox"/>
TEMPORARILY ABANDON <input type="checkbox"/>	CHANGE PLANS <input type="checkbox"/>	COMMENCE DRILLING OPNS. <input type="checkbox"/>	PLUG AND ABANDONMENT <input type="checkbox"/>
PULL OR ALTER CASING <input type="checkbox"/>	OTHER <input type="checkbox"/>	CASING TEST AND CEMENT JOBS <input type="checkbox"/>	
OTHER <b>Flowback prevention program</b> <input type="checkbox"/>			

17. Describe Proposed or Completed Operations (Clearly state all pertinent details, and give pertinent dates, including estimated date of starting any proposed work) SEE RULE 1103.

**Drilling contractor will use a 10" 900 Series Double Gate Cameron Space Saver  
Preventer**

18. I hereby certify that the information above is true and complete to the best of my knowledge and belief.

SIGNED <b>J. J. Freedman</b>	TITLE <b>Prod. Engr.</b>	DATE <b>1-21-76</b>
APPROVED BY <b>Jerry Sexton</b> <b>Dist. 1, Supv.</b>	TITLE	DATE <b>JAN 23 1976</b>
CONDITIONS OF APPROVAL, IF ANY:		