

NO. OF COPIES RECEIVED	
DISTRIBUTION	
SANTA FE	
FILE	
U.S.G.S.	
LAND OFFICE	
OPERATOR	

NEW MEXICO OIL CONSERVATION COMMISSION

Form C-101
Revised 1-1-65

5A. Indicate Type of Lease STATE <input checked="" type="checkbox"/> FEE <input type="checkbox"/>
5. State Oil & Gas Lease No. OG-528
7. Unit Agreement Name
8. Farm or Lease Name Signal-State
9. Well No. 6
10. Field and Pool, or Wildcat Chaveroo-San Andres
12. County Chaves
19. Proposed Depth 4600'
19A. Formation San Andres
20. Rotary or C.T. Rotary
21. Elevations (Show whether DT, RT, etc.) 4460 GR (est.)
21A. Kind & Status Plug. Bond Statewide Blanket Drilling Bond \$25,000
21B. Drilling Contractor Sitton & Norton
22. Approx. Date Work will start May 15, 1976

APPLICATION FOR PERMIT TO DRILL, DEEPEN, OR PLUG BACK

1a. Type of Work DRILL <input checked="" type="checkbox"/> DEEPEN <input type="checkbox"/> PLUG BACK <input type="checkbox"/>	b. Type of Well OIL WELL <input checked="" type="checkbox"/> GAS WELL <input type="checkbox"/> OTHER <input type="checkbox"/>	SINGLE ZONE <input checked="" type="checkbox"/> MULTIPLE ZONE <input type="checkbox"/>
2. Name of Operator Champlin Petroleum Company		
3. Address of Operator 701 Wilco Building Midland, Texas 79701		
4. Location of Well UNIT LETTER J LOCATED 1980 FEET FROM THE South LINE AND 1980 FEET FROM THE East LINE OF SEC. 1 TWP. 8-S RGE. 32-E NMPM		
21. Elevations (Show whether DT, RT, etc.) 4460 GR (est.)		
21A. Kind & Status Plug. Bond Statewide Blanket Drilling Bond \$25,000		
21B. Drilling Contractor Sitton & Norton		
22. Approx. Date Work will start May 15, 1976		

23.

PROPOSED CASING AND CEMENT PROGRAM

SIZE OF HOLE	SIZE OF CASING	WEIGHT PER FOOT	SETTING DEPTH	SACKS OF CEMENT	EST. TOP
11"	8-5/8"	24#	375'	250	Surface
7-7/8"	4-1/2"	10.5#	4600'	200	

Drill 11" hole to 375'. Run 8-5/8" and cement w/250 sacks or enough to circulate cement to surface. WOC 18 hrs. Install BOP stack and test casing to 600 psi for 30 minutes. Drill 7-7/8" hole to 4600' (TD). Run 4-1/2" casing to 4600' and cement w/200 sacks 50-50 pozmix. Casing will be centralized and Ruff-Coated throughout pay zones. Pressure test 4-1/2" casing to 1000# for 30 minutes. BOP stack to consist of a double hydraulic with blind and pipe rams

APPROVED FOR 90 DAYS UNLESS
DRILLING COMMENCED,
EXPIRES 8-15-76

BOVE SPACE DESCRIBE PROPOSED PROGRAM: IF PROPOSAL IS TO DEEPEN OR PLUG BACK, GIVE DATA ON PRESENT PRODUCTIVE ZONE AND PROPOSED NEW PRODUCTION ZONE. GIVE BLOWOUT PREVENTER PROGRAM, IF ANY.

by certify that the information above is true and complete to the best of my knowledge and belief.

by Walter M. Randall Title District Clerk Date May 3, 1976

(This space for State Use)

APPROVED BY George L. Lister TITLE _____ DATE _____

CONDITIONS OF APPROVAL, IF ANY: Either the surface casing must be set to the top of the anhydrite and cemented back to the surface, or the long string must be cemented back to the surface from top of the anhydrite.

NEW KICO OIL CONSERVATION COMMISSION
WELL LOCATION AND ACREAGE DEDICATION PLAT

Form C-102
Supersedes C-128
Effective 1-1-65

All distances must be from the outer boundaries of the Section.

Operator Champlin Petroleum Company			Lease Signal-State		Well No. 6
Unit Letter J	Section 1	Township 8-S	Range 32-E	County Chaves	
Actual Footage Location of Well: 1980 feet from the South line and 1980 feet from the East line					
Ground Level Elev: 4460 (est.)	Producing Formation San-Andres		Pool Chaveroo-San Andres		Dedicated Acreage: 40 Acres

1. Outline the acreage dedicated to the subject well by colored pencil or hachure marks on the plat below.
2. If more than one lease is dedicated to the well, outline each and identify the ownership thereof (both as to working interest and royalty).
3. If more than one lease of different ownership is dedicated to the well, have the interests of all owners been consolidated by communitization, unitization, force-pooling, etc?

☐ Yes ☐ No If answer is "yes," type of consolidation _____

If answer is "no," list the owners and tract descriptions which have actually been consolidated. (Use reverse side of this form if necessary.) _____

No allowable will be assigned to the well until all interests have been consolidated (by communitization, unitization, forced-pooling, or otherwise) or until a non-standard unit, eliminating such interests, has been approved by the Commission.

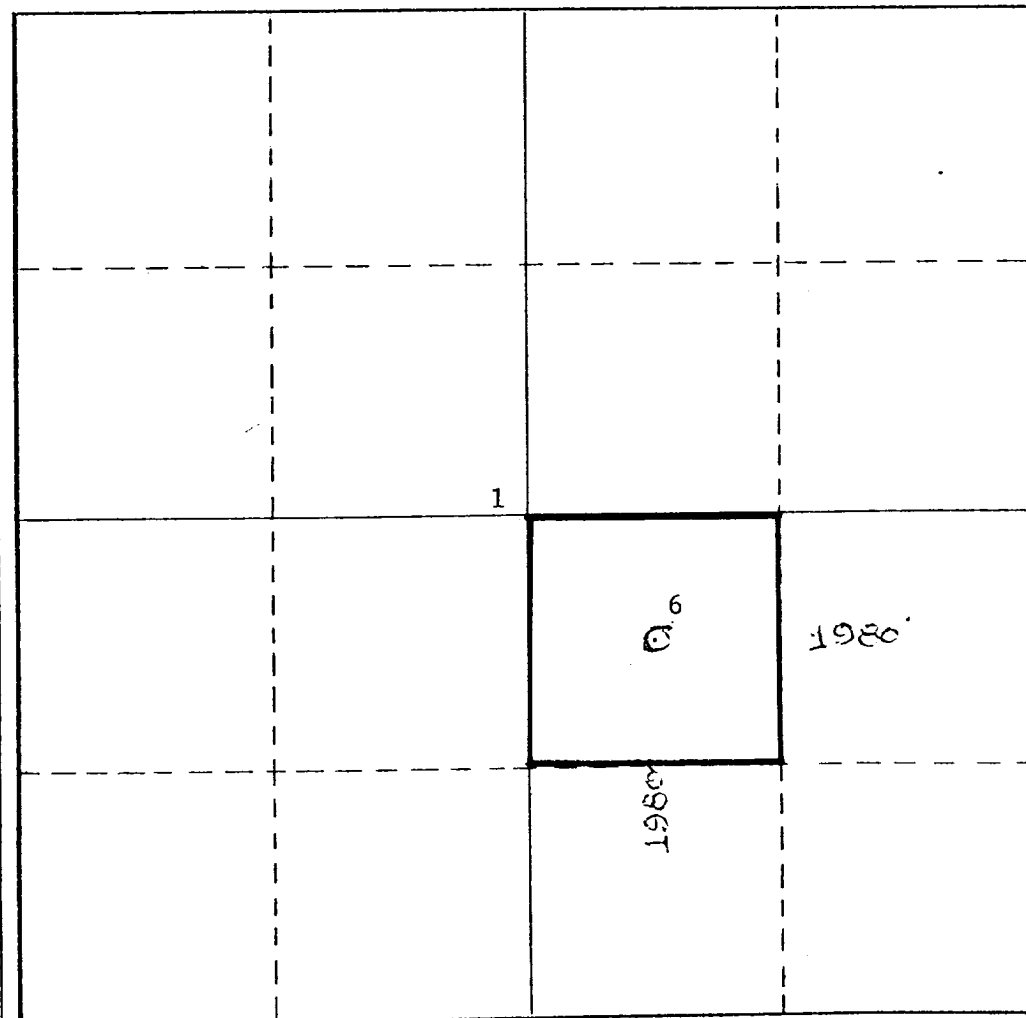

CERTIFICATION

I hereby certify that the information contained herein is true and complete to the best of my knowledge and belief.

Walter M. Randolph

Name

Walter M. Randolph

Position

District Clerk

Company

Champlin Petroleum Company

Date

May 3, 1976

I hereby certify that the well location shown on this plat was plotted from field notes of actual surveys made by me, or under my supervision, and that the same is true and correct to the best of my knowledge and belief.

Date Surveyed

4-28-76

Registered Professional Engineer
and/or Land Surveyor

Certificate No.

1652