

NO. OF COPIES RECEIVED		
DISTRIBUTION		
SANTA FE		
FILE		
U.S.G.S.		
LAND OFFICE		
OPERATOR		

NEW MEXICO OIL CONSERVATION COMMISSION

Form C-101
Revised 1-1-65

5A. Indicate Type of Lease

STATE ☐

FEE ☒

5. State Oil & Gas Lease No.

APPLICATION FOR PERMIT TO DRILL, DEEPEN, OR PLUG BACK

1a. Type of Work		7. Unit Agreement Name	
b. Type of Well OIL WELL <input checked="" type="checkbox"/> GAS WELL <input type="checkbox"/> OTHER <input type="checkbox"/>		8. Farm or Lease Name Hannifin	
2. Name of Operator Penford, Inc.		9. Well No. 2	
3. Address of Operator 3470 Two Allen Center		10. Field and Pool, or Willcat Many Gates Abo	
4. Location of Well UNIT LETTER F LOCATED 1980 FEET FROM THE North LINE AND 1980 FEET FROM THE West LINE OF SEC. 31 TWP. 9S RGE. 30E NMPM		12. County Chaves	
19. Proposed Depth 7200'		19A. Formation Abo	20. Rotary or C.T. Rot.
21. Elevations (Show whether DE, RT, etc.) 4000.5 GL	21A. Kind & Status Plug, Bond Blanket (Current)	21B. Drilling Contractor	22. Approx. Date Work will start 12-15-81

23.

PROPOSED CASING AND CEMENT PROGRAM

SIZE OF HOLE	SIZE OF CASING	WEIGHT PER FOOT	SETTING DEPTH	SACKS OF CEMENT	EST. TOP
17 1/2	13 3/8	48	416	450	Surface
11	8 5/8	24-28	2695	868	1000'
7 7/8	5 1/2	15.5-17	9350	1375	5000'

Morrow gas zone no longer commercial to produce.

Install 6" X 900 BOP

Pull tubing and packer, set bridge plug above Morrow perfs 9262'-9294' and cap with 35' cement plug.

Re-perf Abo 7190'-7200', acidize as necessary, and complete in Abo.

IN ABOVE SPACE DESCRIBE PROPOSED PROGRAM; IF PROPOSAL IS TO DEEPEN OR PLUG BACK, GIVE DATA ON PRESENT PRODUCTION ZONE AND PROPOSED NEW PRODUCTION ZONE. GIVE BLOWOUT PREVENTER PROGRAM, IF ANY.

I hereby certify that the information above is true and complete to the best of my knowledge and belief.

Signed *Jerry Sexton* Title President Date 11-17-81

(This space for State Use)
Orig. Signed By

Jerry Sexton

APPROVED BY *Don L. Smith* TITLE DATE

CONDITIONS OF APPROVAL, IF ANY:

NEW MEXICO OIL CONSERVATION COMMISSION
WELL LOCATION AND ACREAGE DEDICATION PLAT

Form C-100
Supersedes C-120
Effective 1-1-65

All distances must be from the outer boundaries of the Section.

Operator Penford, Inc.			Lease Hannifin		Well No. 2
Unit Letter F	Section 31	Township 9S	Range 3DE	County Chaves	
Actual Footage Location of Well:					
1980 feet from the North line and		1980 feet from the West line			
Ground Level Elev. 4000.5	Producing Formation Abo	Pool Many Gates		Dedicated Acreage: 80	Acre

1. Outline the acreage dedicated to the subject well by colored pencil or hachure marks on the plat below.
2. If more than one lease is dedicated to the well, outline each and identify the ownership thereof (both as to working interest and royalty).
3. If more than one lease of different ownership is dedicated to the well, have the interests of all owners been consolidated by communitization, unitization, force-pooling, etc?

☐ Yes ☐ No If answer is "yes," type of consolidation _____

If answer is "no," list the owners and tract descriptions which have actually been consolidated. (Use reverse side of this form if necessary.) _____

No allowable will be assigned to the well until all interests have been consolidated (by communitization, unitization, forced-pooling, or otherwise) or until a non-standard unit, eliminating such interests, has been approved by the Commission.

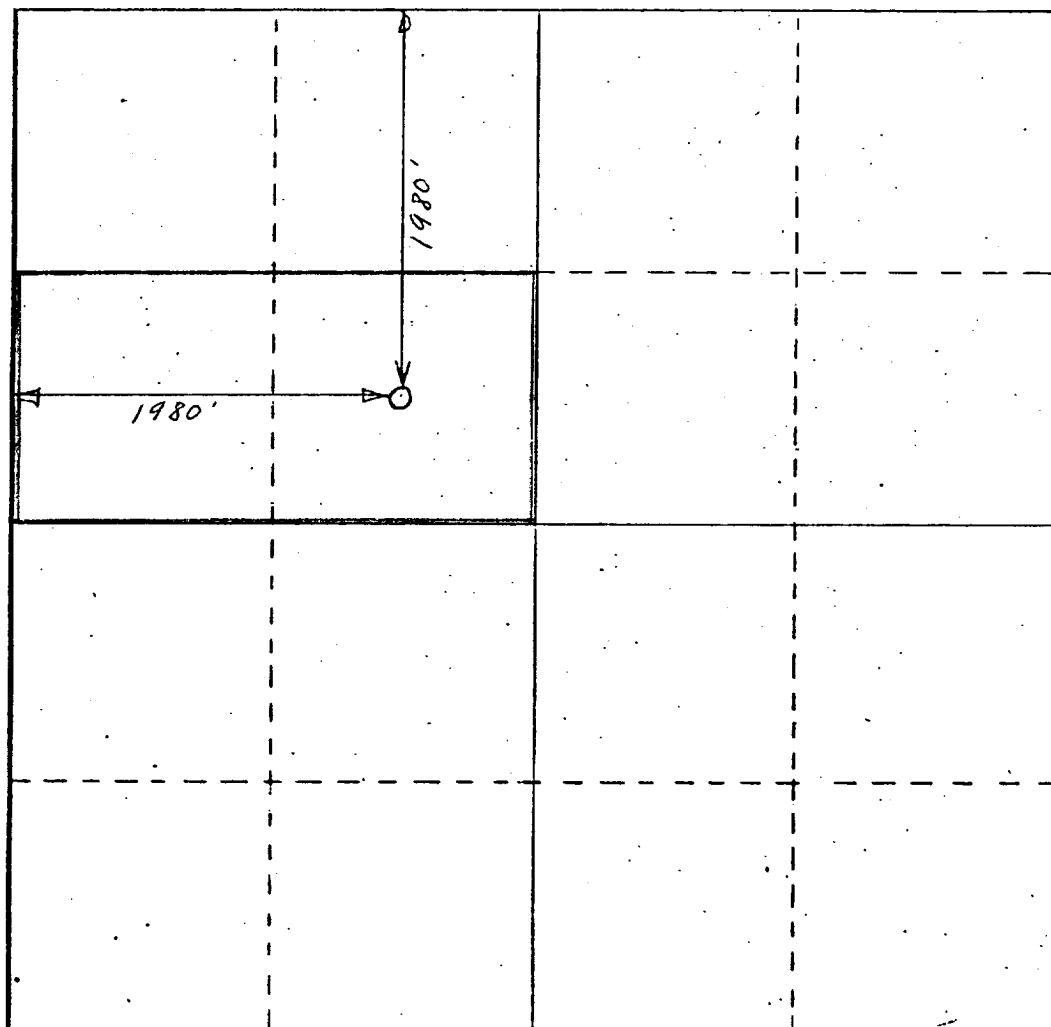

CERTIFICATION

I hereby certify that the information contained herein is true and complete to the best of my knowledge and belief.

Patrick E. Hosford

Name
Patrick E. Hosford

Position
President

Company
Penford, Inc.

Date
11-17-81

I hereby certify that the well location shown on this plat was plotted from field notes of actual surveys made by me or under my supervision, and that the same is true and correct to the best of my knowledge and belief.

Date Surveyed
5-1-76

Registered Professional Engineer and/or Land Surveyor

John West

Certificate No.
676

