

NO. OF COPIES RECEIVED		
DISTRIBUTION		
SANTA FE		
FILE		
U.S.G.S.		
LAND OFFICE		
OPERATOR		

# NEW MEXICO OIL CONSERVATION COMMISSION

Form C-101  
Revised 1-1-65

5A. Indicate Type of Lease	
STATE <input type="checkbox"/>	FEE <input checked="" type="checkbox"/>
5. State Oil & Gas Lease No.	

## APPLICATION FOR PERMIT TO DRILL, DEEPEN, OR PLUG BACK

1a. Type of Work		7. Unit Agreement Name	
b. Type of Well DRILL <input checked="" type="checkbox"/> DEEPEN <input type="checkbox"/> PLUG BACK <input type="checkbox"/> OIL WELL <input checked="" type="checkbox"/> GAS WELL <input type="checkbox"/> OTHER <input type="checkbox"/> SINGLE ZONE <input type="checkbox"/> MULTIPLE ZONE <input type="checkbox"/>		8. Farm or Lease Name Marshall	
2. Name of Operator Wolfsen Oil Company		9. Well No. 2	
3. Address of Operator 3206 Republic Lane Tower Dallas, Texas 75201		10. Field and Pool, or Wildcat Gato (San Andres)	
4. Location of Well UNIT LETTER G LOCATED 1650 FEET FROM THE East LINE AND 2310 FEET FROM THE North LINE OF SEC. 6 TWP. 9-S RGE. 30-E NMPM		12. County Chaves	
19. Proposed Depth 3100		19A. Formation San Andres	20. Rotary or C.T. Rotary
21. Elevations (Show whether DF, RT, etc.) 4104 GR	21A. Kind & Status Plug. Bond 552-612 Travelers	21B. Drilling Contractor 107	22. Approx. Date Work will start 6-12-76

## 23. PROPOSED CASING AND CEMENT PROGRAM

SIZE OF HOLE	SIZE OF CASING	WEIGHT PER FOOT	SETTING DEPTH	SACKS OF CEMENT	EST. TOP
11	8 5/8	24	980	600	Surface
7 7/8	1 1/2	10.5	3100	175	2700

Gas is not dedicated from this property

A 10" 900 Series Common Space Saver Blow Out Preventer will be utilized.

APPROVAL VALID  
FOR 90 DAYS UNLESS  
DRILLING COMMENCED

EXPIRES

9-1-76

IN ABOVE SPACE DESCRIBE PROPOSED PROGRAM: IF PROPOSAL IS TO DEEPEN OR PLUG BACK, GIVE DATA ON PRESENT PRODUCTIVE ZONE AND PROPOSED NEW PRODUCTIVE ZONE. GIVE BLOWOUT PREVENTER PROGRAM, IF ANY.

I hereby certify that the information above is true and complete to the best of my knowledge and belief.

Signed J. J. Freedman Title Prod. Mgr. Date 6-1-76

(This space for State Use)

APPROVED BY Garry Sexton TITLE PRODUCER DATE 6-1-76

CONDITIONS OF APPROVAL, IF ANY:

RECEIVED

JUL 11 1979

WILSON CONSERVATION CLUB  
HOBBS, N. M.

NEW MEXICO OIL CONSERVATION COMMISSION  
WELL LOCATION AND ACREAGE DEDICATION PLAT

Form C-122  
Supersedes C-128  
Effective 1-1-65

All distances must be from the outer boundaries of the Section.

Operator <b>Wolfson Oil Company</b>		Lease <b>Marshall</b>		Well No. <b>2</b>
Unit Letter	Section <b>6</b>	Township <b>9 S</b>	Range <b>30 E</b>	County <b>Chaves</b>
Actual Footage Location of Well: <b>1650</b> feet from the <b>east</b> line and <b>2310</b> feet from the <b>north</b> line				
Ground Level Elev. <b>4104</b>	Producing Formation <b>San Andres</b>		Pool <b>Cato</b>	Dedicated Acreage: <b>10</b> Acres

1. Outline the acreage dedicated to the subject well by colored pencil or hachure marks on the plat below.
2. If more than one lease is dedicated to the well, outline each and identify the ownership thereof (both as to working interest and royalty).
3. If more than one lease of different ownership is dedicated to the well, have the interests of all owners been consolidated by communitization, unitization, force-pooling, etc?  
☐ Yes ☐ No If answer is "yes," type of consolidation \_\_\_\_\_

If answer is "no," list the owners and tract descriptions which have actually been consolidated. (Use reverse side of this form if necessary.) \_\_\_\_\_

No allowable will be assigned to the well until all interests have been consolidated (by communitization, unitization, forced-pooling, or otherwise) or until a non-standard unit, eliminating such interests, has been approved by the Commission.

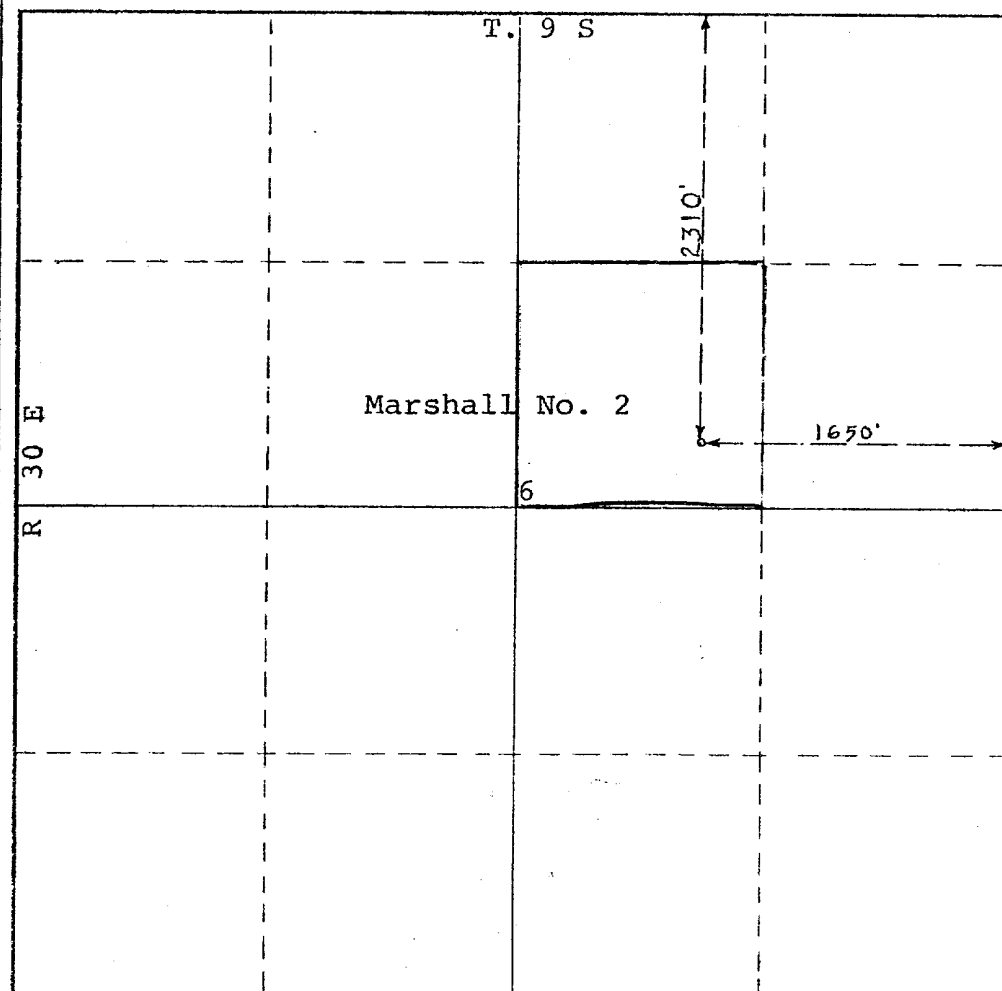

CERTIFICATION

I hereby certify that the information contained herein is true and complete to the best of my knowledge and belief.

*[Signature]*  
**W.C. Freedman**

Name  
**Prod. Engr.**  
Position  
**Wolfson Oil Company**  
Company

Date  
**5-28-76**

I hereby certify that the well location shown on this plat was plotted from field notes of actual surveys made by me or under my supervision, and that the same is true and correct to the best of my knowledge and belief.

Date Surveyed  
**May 27, 1976**  
Registered Professional Engineer and/or Land Surveyor

*[Signature]*

Certificate No.  
**277 N.M.**

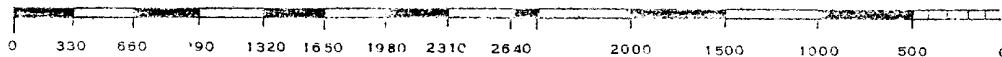

473

RECEIVED

JUN 1 1978

OIL CONSERVATION COMM.  
HOBBS, N. M.