

| | |
|---------------------|--|
| NO. COPIES RECEIVED | |
| DISTRIBUTION | |
| SANTA FE | |
| FILE | |
| U.S.G.S. | |
| LAND OFFICE | |
| OPERATOR | |

NEW MEXICO OIL CONSERVATION COMMISSION

Form C-101
Revised 1-1-65

| | |
|---|------------------------------|
| 5A. Indicate Type of Lease | |
| STATE <input checked="" type="checkbox"/> | FEE <input type="checkbox"/> |
| 5. State Oil & Gas Lease No. | |
| K-3351 | |

APPLICATION FOR PERMIT TO DRILL, DEEPEN, OR PLUG BACK

| | | | |
|---|--|---|--|
| 1a. Type of Work | | 7. Unit Agreement Name | |
| b. Type of Well OIL WELL <input checked="" type="checkbox"/> GAS WELL <input type="checkbox"/> OTHER <input type="checkbox"/> | | 8. Farm or Lease Name State "5" | |
| 2. Name of Operator Champlin Petroleum Company | | 9. Well No. 13 | |
| 3. Address of Operator 300 Wilco Building Midland, Texas 79701 | | 10. Field and Pool, or Wildcat Chaveroo-San Andres | |
| 4. Location of Well UNIT LETTER N LOCATED 660 FEET FROM THE South LINE AND 1980 FEET FROM THE West LINE OF SEC. 5 TWP. 8-S RGE. 33-E NMPM | | 12. County Chaves | |
| 19. Proposed Depth 4600 | | 19A. Formation San Andres | |
| 20. Rotary or C.T. Rotary | | 21. Elevations (Show whether DF, RT, etc.) 4438.7 | |
| 21A. Kind & Status Plug. Bond Statewide Blanket Drilling Bond \$25,000 | | 21B. Drilling Contractor Sitton Drilling Co. | |
| 22. Approx. Date Work will start Nov. 1, 1976 | | | |

23.

PROPOSED CASING AND CEMENT PROGRAM

| SIZE OF HOLE | SIZE OF CASING | WEIGHT PER FOOT | SETTING DEPTH | SACKS OF CEMENT | EST. TOP |
|--------------|----------------|-----------------|---------------|-----------------|----------|
| 12-1/4" | 8-5/8" | 24# | 1900* | 850 | Surface |
| 7-7/8" | 4-1/2" | 10.5# | 4600' | 285 | |

* Top of Anhydrite Section.

Drill 12-1/4" hole to top of the Anhydrite, run 8-5/8" and cement w/850 sacks or enough to circulate cement to surface. WOC 18 hrs. Install BOP stack and test casing to 800# for 30 minutes. Drill 7-7/8" hole to 4600' (TD). Run 4-1/2" casing to 4600' and cement w/285 sacks Class "H". Casing will be centralized and ruff-coated throughout pay zone. Pressure test 4-1/2" casing to 1000# for 30 minutes. BOP stack to consist of a double hydraulic with blind & pipe rams.

IN ABOVE SPACE DESCRIBE PROPOSED PROGRAM: IF PROPOSAL IS TO DEEPEN OR PLUG BACK, GIVE DATA ON PRESENT PRODUCTIVE ZONE AND PROPOSED NEW PRODUCTIVE ZONE. GIVE BLOWOUT PREVENTER PROGRAM, IF ANY.

I hereby certify that the information above is true and complete to the best of my knowledge and belief.

Signed Walter M. Randolph Title District Clerk Date October 18, 1976

(This space for State Use)

APPROVED BY [Signature] TITLE DATE 10/20/76
CONDITIONS OF APPROVAL, IF ANY:

NEW MEXICO OIL CONSERVATION COMMISSION
WELL LOCATION AND ACREAGE DEDICATION PLAT

Form O-171
Supersedes O-128
Effective 4-65

All distances must be from the outer boundaries of the Section

| | | | | | |
|---|-------------------|----------------------------|-------------------------|-------------------------|-------------------|
| Lessee Champlin Petroleum Company | | | State 5-8-33 | | Area 13 |
| Section N | Range 5 | Township 8 South | Range 33 East | County Chaves | |
| Actual Location of Well: Section 660 Direction South Distance 1980 Direction West Distance Section 11, 3.7 Township Son Andres Range Choveroo Township 40 | | | | | |

- Outline the acreage dedicated to the subject well by colored pencil or hatchure marks on the plat below
- If more than one lease is dedicated to the well, outline each and identify the ownership thereof (both as to working interest and royalty).
- If more than one lease of different ownership is dedicated to the well, have the interests of all owners been consolidated by communitization, unitization, force-pooling, etc?

☐ Yes ☐ No If answer is "yes," type of consolidation _____

If answer is "no," list the owners and tract descriptions which have actually been consolidated (Use reverse side of this form if necessary.) _____

No allowable will be assigned to the well until all interests have been consolidated (by communitization, unitization, forced-pooling, or otherwise) or until a non-standard unit, eliminating such interests, has been approved by the Commission.

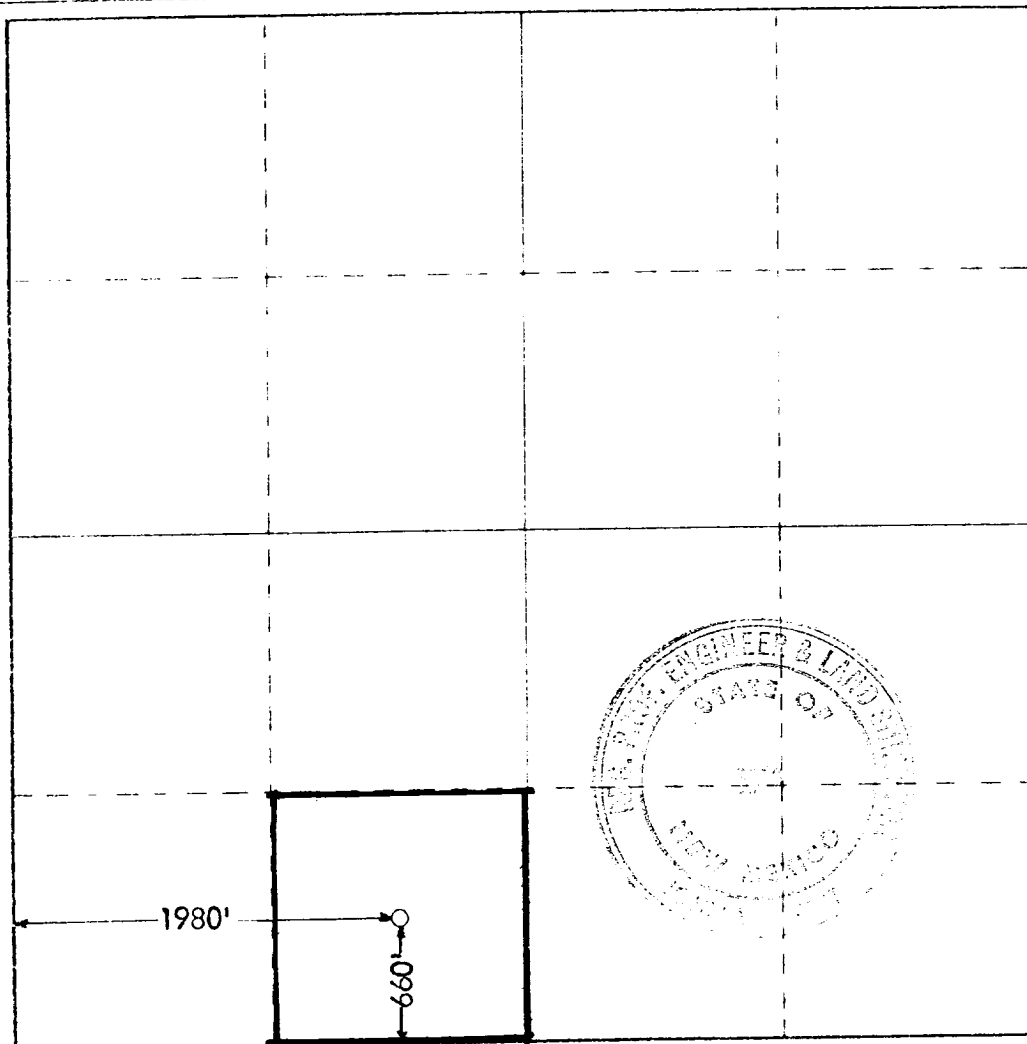

CERTIFICATION

I hereby certify that the information contained herein is true and complete to the best of my knowledge and belief

Name
Walter Mandel

Position
Agent

Company
Champlin Petroleum Company

Date
10-15-1976

I hereby certify that the well location shown on this plat was plotted from field notes of actual surveys made by me or under my supervision, and that the same is true and correct to the best of my knowledge and belief.

Date Surveyed
10-14-1976

Registered Professional Engineer and/or Land Surveyor

Certificate No. **676**