

NMOCC COPY SUBMIT IN TR ATE*
UNITED STATES
DEPARTMENT OF THE INTERIOR
GEOLOGICAL SURVEY
(Other instructions on reverse side)Form approved.
Budget Bureau No. 42-R1425.

APPLICATION FOR PERMIT TO DRILL, DEEPEN, OR PLUG BACK			
1a. TYPE OF WORK DRILL <input checked="" type="checkbox"/> DEEPEN <input type="checkbox"/> PLUG BACK <input type="checkbox"/>			
b. TYPE OF WELL OIL WELL <input checked="" type="checkbox"/> GAS WELL <input type="checkbox"/> OTHER <input type="checkbox"/> SINGLE ZONE <input type="checkbox"/> MULTIPLE ZONE <input type="checkbox"/>			
2. NAME OF OPERATOR SUNDANCE OIL COMPANY			
3. ADDRESS OF OPERATOR Suite 510, 1776 Lincoln St., Denver, CO 80203			
4. LOCATION OF WELL (Report location clearly and in accordance with any State requirements.*) At surface 1980' FNL, 660' FWL At proposed prod. zone Same			
14. DISTANCE IN MILES AND DIRECTION FROM NEAREST TOWN OR POST OFFICE* 15 miles east of Elkins			
15. DISTANCE FROM PROPOSED* LOCATION TO NEAREST PROPERTY OR LEASE LINE, FT. (Also to nearest drlg. unit line, if any)		16. NO. OF ACRES IN LEASE	
660'		1360	
18. DISTANCE FROM PROPOSED LOCATION* TO NEAREST WELL, DRILLING, COMPLETED, OR APPLIED FOR, ON THIS LEASE, FT.		19. PROPOSED DEPTH	
2660'		4100	
21. ELEVATIONS (Show whether DF, RT, GR, etc.) 4230' GR		17. NO. OF ACRES ASSIGNED TO THIS WELL 40	
22. APPROX. DATE WORK WILL START* July 25, 1977		20. ROTARY OR CABLE TOOLS Rotary	
23. PROPOSED CASING AND CEMENTING PROGRAM			
SIZE OF HOLE	SIZE OF CASING	WEIGHT PER FOOT	SETTING DEPTH
12 1/4"	8 5/8"	28#	1350'
7 7/8"	4 1/2"	11.6#	4100'
QUANTITY OF CEMENT			
550 sx			
300 sx			

The well will be drilled, logged and evaluated by drill stem tests for full evaluation of the San Andres formation. If warranted, completion will be made in same formation.

RECEIVED

JUN 06 1977

U. S. GEOLOGICAL SURVEY
ARTESIA, NEW MEXICO

RECEIVED

JUL 5 1977

O. C. C.

ARTESIA OFFICE

IN ABOVE SPACE DESCRIBE PROPOSED PROGRAM: If proposal is to deepen or plug back, give data on present productive zone and proposed new productive zone. If proposal is to drill or deepen directionally, give pertinent data on subsurface locations and measured and true vertical depths. Give blowout preventer program, if any.

24. SIGNED Olin L. Isham TITLE Chief Geologist DATE June 1, 1977
(This space for Federal or State office use)

PERMIT NO. _____ APPROVAL DATE JUL 1 - 1977
APPROVED BY Joe M. Lara TITLE ACTING DISTRICT ENGINEER DATE JUL 1 - 1977
CONDITIONS OF APPROVAL, IF ANY:

Subject to attached stipulations!

*See Instructions On Reverse Side

EXPIRES _____ COMMENCED IF OPERATIONS
OCT 1 - 1977 WITHIN 3 MONTHS.

RECEIVED

JUL 6 1977

OIL CONSERVATION COMM.
HOBBS, N. M.

NEW MEXICO OIL CONSERVATION COMMISSION
WELL LOCATION AND ACREAGE DEDICATION PLAT

Form O-122
Supersedes O-128
Effective 1-1-65

All distances must be from the outer boundaries of the Section

Operator SUNDANCE OIL COMPANY		Lease INGRAM		Acreage 6	
Unit Letter E	Section 5	Township 8 South	Range 31 East	County Chaves	
Actual Well Location of Well:					
1980 feet from the North		660 feet from the West			
Ground Level Elev. 4230.1	Producing Formation <i>San Andres</i>		Crate <i>Cato</i>		Section 40

1. Outline the acreage dedicated to the subject well by colored pencil or hatchure marks on the plat below.
2. If more than one lease is dedicated to the well, outline each and identify the ownership thereof (both as to working interest and royalty).
3. If more than one lease of different ownership is dedicated to the well, have the interests of all owners been consolidated by communitization, unitization, force-pooling, etc?

☐ Yes ☐ No If answer is "yes," type of consolidation _____

If answer is "no," list the owners and tract descriptions which have actually been consolidated (Use reverse side of this form if necessary.) _____

No allowable will be assigned to the well until all interests have been consolidated (by communitization, unitization, forced-pooling, or otherwise) or until a non-standard unit, eliminating such interests, has been approved by the Commission.

RECEIVED

JUN 06 1977

**U.S. GEOLOGICAL SURVEY
ARTESIA, NEW MEXICO**

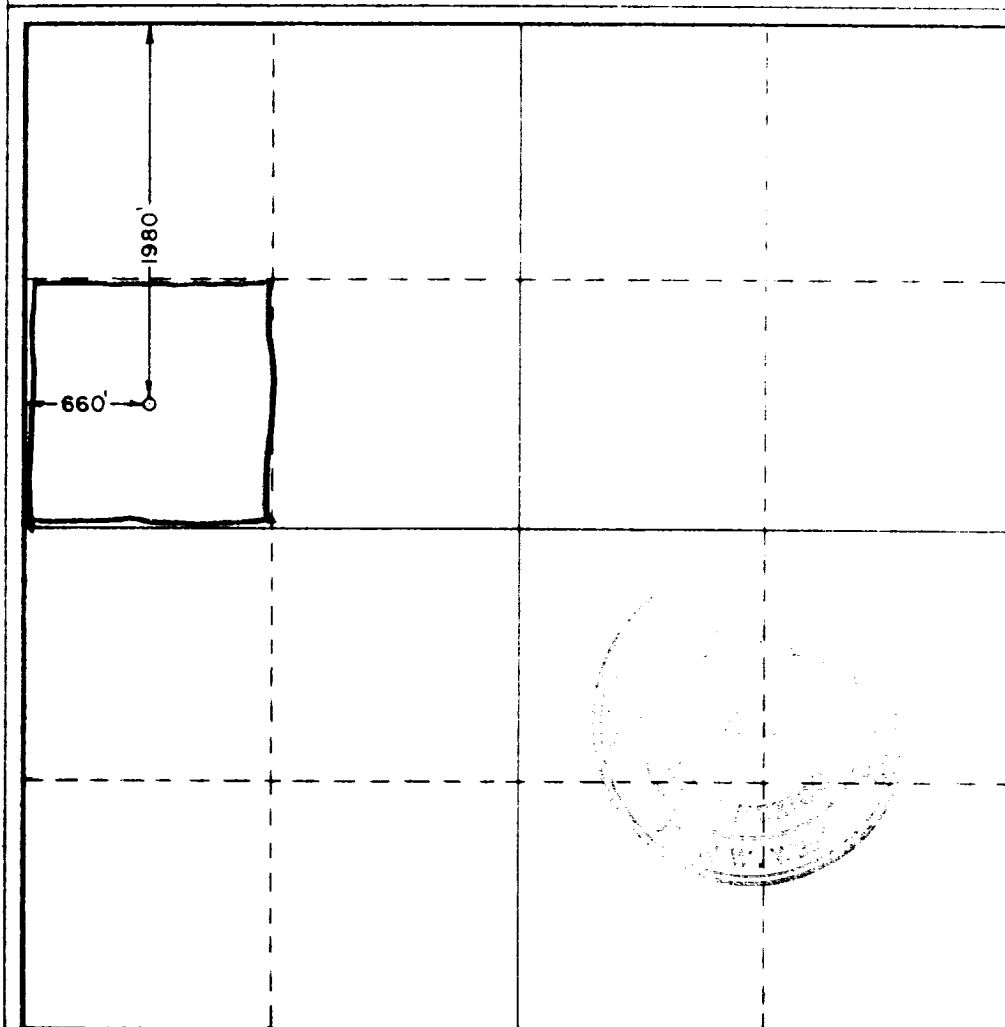

CERTIFICATION

I hereby certify that the information contained herein is true and complete to the best of my knowledge and belief.

C. L. Schum
Chief Geologist
Sundance Oil Co.
6-20-77

I hereby certify that the well location shown on this plat was plotted from field notes of actual surveys made by me or under my supervision and that the same is true and correct to the best of my knowledge and belief.

Date Surveyed
April 30, 1977

Registered Professional Engineer and/or Land Surveyor

John W. West
Certificate No. **676**

0 320 640 960 1280 1600 1920 2240 2560 2880 3200 3520 3840 4160 4480 4800 5120 5440 5760 6080 6400

RECEIVED

JUL 8 1977

OIL CONSERVATION COMM.
HOBBS, N. M.

Attachment to Form 9-331 C
Application for Permit to Drill

Sundance Oil Company, #6 Ingram Federal
1980' FNL and 660' FWL of Section 5, T. 8S., R. 31E.
Chaves County, New Mexico

1. The geologic name of the surface information is Triassic red beds overlain by wind blown sands.
2. The estimated tops of important geologic markers are as follows:

Rustler	1540'
Salado	1600'
Yates	2030'
San Andres	3200'
P-1	3900'
P-2	4000'
T.D.	4100'

3. The estimated depths at which anticipated water, oil, gas or other mineral bearing formations will be encountered are as follows:

Ogalala	150' water
Salado	1600' salt
San Andres	3200' oil and gas
P-1	3900' oil and gas
P-2	4000' oil and gas

4. The proposed casing program is as follows:

Surface - New 8 5/8", 28 lb/ft., ST&C, Secondary 45 (J&L).
Production - New 4½", 10.5 lb/ft., ST&C, K-55 and 11.6 lb/ft.,
ST&C, JCM-36 (J&L).

5. A sketch of an API Series 900 Blowout Preventer is attached. Pipe rams and blinds will be checked to 1,000 PSI for 30 minutes when BOP is installed. BOP will be checked when casing is set and operated daily for checks.

6. The proposed mud program is as follows:

0-350' spud mud	8.5 - 9.0 lbs./gal.
350-3800' native mud	9.0 - 9.5 lbs./gal.
3800'-to TD salt gel	9.0 - 10.0 lbs./gal.

7. The auxilliary equipment to be used is:

- (1) Kelly cocks.
- (2) Floats at the bit.
- (3) Stabbing valve on rig floor with sub to fit drill pipe.

RECEIVED

JUL 8 1977

GIL CONSERVATION COMM.
HOBBS, N. M.

3. It is proposed to run 2" and 5" GR, CNL, FDC, DLL/MLL Logs from TD to 1350'.
9. No abnormal pressures or temperatures are expected to be encountered in this well.
10. The anticipated starting date for this well is July 25, 1977. Estimated duration of drilling operations is 10 to 12 days.

RECEIVED

JUL 6 1977

OIL CONSERVATION COMM.
HOBBS, N. M.

B. O. P. HOOK-UP

Schaeffer Type E 10" Series 900 Hydraulic BOP. (3,000 PSI W.P.)

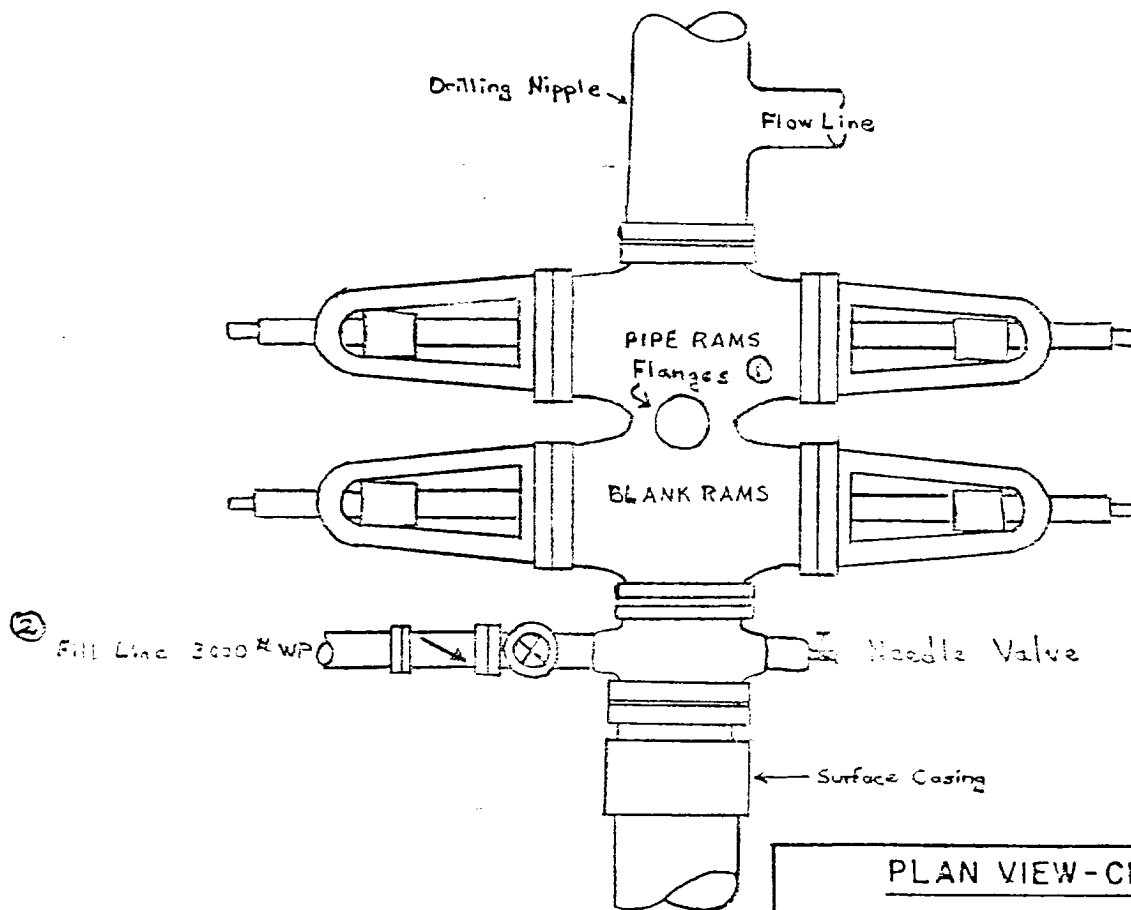

NOTES:

① 1 Flange on each side of BOP Stack. Choke Manifold connects To one side. Other side has full opening pipe and valves connected To ii. KILL LINES.

② Fill line also has valve in it at rig floor level.

BOP Stack will be equipped To operate with both hydraulic and manual controls.

All equipment, piping and valves in BOP arrangement is 900 Series, i.e. 3,000 psi working pressure.

PLAN VIEW-CHOKE MANIFOLD

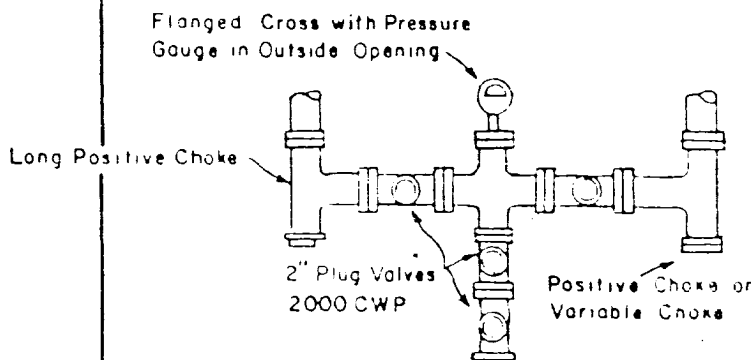

100-100000
JUL 8 1977
GIL CONSERVATION COMM.
HOBBS, N. M.

RECEIVED

JUN 06 1977

SURFACE USE PLAN

Sundance Oil Company: Ingram Federal #6
1980' FNL and 660' FWL of Section 5, T. 8S., R. 31E.
Chaves County, New Mexico

U.S. GEOLOGICAL SURVEY
ARTESIA, NEW MEXICO

This plan is to accompany "Application for Permit to Drill" the subject well which is located approximately 15 miles south of Kenna, New Mexico. The following is a discussion of pertinent information concerning possible effect which the proposed drilling of the well may have on the environment of the well and road sites and surrounding acreage.

1. Existing Roads

- A. The proposed well site is 1980' FNL and 660' FWL of Section 5, T. 8S., R. 31E., Chaves County, New Mexico.
- B. Exhibit "A" is a portion of a map showing existing roads with directions to the location from Kenna, New Mexico. The route to the location is marked in red along side of roads to be used. The well location is approximately 15 miles south of Kenna, New Mexico.
- C., D., & E. Access roads are shown on Exhibit "A".
- F. No improvement or maintenance is anticipated for the existing roads.

2. Planned Access Roads

- A. Width and Length: New road required will be 12 feet wide and 3960' long. This new road is labeled on Exhibits "B" and "C".
- B. Turnouts: None.
- C. Drainage Design: New road will have a drop of 6 inches from center line on each side.
- D. Culverts, Cuts and Fills: Culverts - None. The location and pits will be constructed as shown on Exhibit "D".
- E. Surfacing Material: Six inches of caliche, bladed, watered and compacted.
- F. Gates, Cattleguards, Fences: One cattleguard will be required at the location shown on Exhibit "C". Existing fence is shown on Exhibit "C".
- G. None

3. Location of Existing Wells

See Exhibit "C".



JUL 6 1977

CIL CONSERVATION COMM.
HOBBS, N. M.

4. Location of Existing and/or Proposed Facilities

- A. Existing facilities consist of a salt water disposal well located in the NE SE of Section 5.
- B. If commercial production is established, facilities and lines will be constructed as shown on Exhibit "D". Pads for equipment will be made with caliche. Facilities will be fenced and/or covered to protect livestock and wildlife.
- C. All unused areas disturbed by construction will be restored to natural terrain profile after construction is completed.

5. Location and Type of Water Supply

- A. Water will be obtained from wells at Kenna and/or Crossroads.
- B. Water will be transported by truck.

6. Source of Construction Materials

Caliche will be obtained from existing pit located in the NW NW Section 4, T. 8S., R. 31E.

7. Methods for Handling Waste Disposal

Well cuttings will be disposed in reserve pit. Barrel trash containers to be in accessible locations within drill site area during drilling and completion procedures. All detrimental waste will be hauled away, burned or buried with a minimum cover of 24" of dirt. See Exhibit "D" for location of pits. If well is productive, maintenance waste will be placed in special trash cans and hauled away periodically. Any produced water will be collected in tanks until hauled to an approved disposal system, or separate disposal applications will be submitted to the survey for appropriate approval.

8. Auxillary Facilities

None.

9. Well Site Layout

Exhibit "D" shows the relative location and dimensions of the well pad, mud pit, reserve pit, trash barrel, etc. The reserve pit will be lined with plastic.

10. Plans for Restoration of Surface:

Pits will be backfilled and leveled as soon as practical to original condition. Commencement of rehabilitation operations will immediately follow removal of drilling and completion equipment from location and rehabilitation of the surface is planned to be completed within 45 days from commencement.

JUL 6 1977

OIL CONSERVATION COMM.
HOBBS, N. M.

11. Other Information

- A. Terrain: Low rolling sand hills.
- B. Soil: Sandy.
- C. Vegetation: Scrub oak, bear grass and very sparse vegetation.
- D. Surface Use: Grazing.
- E. Ponds and Streams: None
- F. Water Wells: One-half mile northwest of location.
- G. Residences and Buildings: One-half mile north of location.
- H. Arroyos, Canyons, etc.: Caprock escarpment approximately 1½ miles north of location.
- I. Well Sign: Sign identifying and locating well will be maintained at drill site with the spudding of the well.
- J. Open Pits: All pits containing mud or other liquids will be fenced.
- K. Archaeological Resources: None observed.

12. Lessee's or Operator's Representative

Olin L. Isham
Sundance Oil Company
Suite 510, 1776 Lincoln St.
Denver, Colorado 80203

Business Phone: (303) 825-7657
Home Phone: (303) 798-9217

13. Certification

I hereby certify that I, or persons under my direct supervision, have inspected the proposed drillsite and access route; that I am familiar with the conditions which presently exist; that the statements made in this plan are, to the best of my knowledge, true and correct; and, that the work associated with the operations proposed herein will be performed by SUNDANCE OIL COMPANY and its contractors and sub-contractors in conformity with this plan and the terms and conditions under which it is approved.

6-1-77
Date

Olin L. Isham
Olin L. Isham
Chief Geologist

RECEIVED

JUL 8 1977

GIL CONSERVATION COMM.
HOBBS, N. M.

Supplement to Surface Use & Operations Plan
Sundance Oil Company Ingram Federal No. 6
1930' FWL and 660' FWL of Section 5, T. 3S., R. 31E.
Chaves County, New Mexico

Agreement has been reached with the surface owner as follows for routing of road and restoration of surface for the subject well:

1. Road will be routed as shown on Exhibits "B" and "C".
2. Road will remain after completion of drilling operations or be ripped up at land owners discretion.
3. Pad will either remain or be ripped up. To be at the land owners discretion.
4. All pits will be back-filled and leveled.

Agreement has been reached with the surface owner as to settlement costs for surface damages. A copy of the agreement is attached.

6-1-77
Date

Olin L. Isnam
Olin L. Isnam
Chief Geologist

RECEIVED

JUL 6 1977

GIL CONSERVATION COMM.
HOBBS, N. M.

August 8, 1975

AGREEMENT

Sundance Oil Co. agrees to pay \$100.00 each time they cut and set a cattle guard in the fence line.

Sundance Oil Co. agrees to pay \$4.00 a rod for roads and \$500.00 for each well site location, \$250.00 for a tank battery pad built between locations and \$1.00 a rod for pipeline not laid beside road right-of-ways. \$3.00 a rod for pipeline right-of-way that have to be built or made by a tractor or motor grader.

This agreement is payable only to Sec 5 Twn 8S Rge 31E.

William N. Morgan

William N. Morgan
Representative of
Sundance Oil Co.

Emmet McCombs

Emmet McCombs
Land Owner

FILED
JUL 6 1977
OIL CONSERVATION COMM.
HOBBS, N. M.

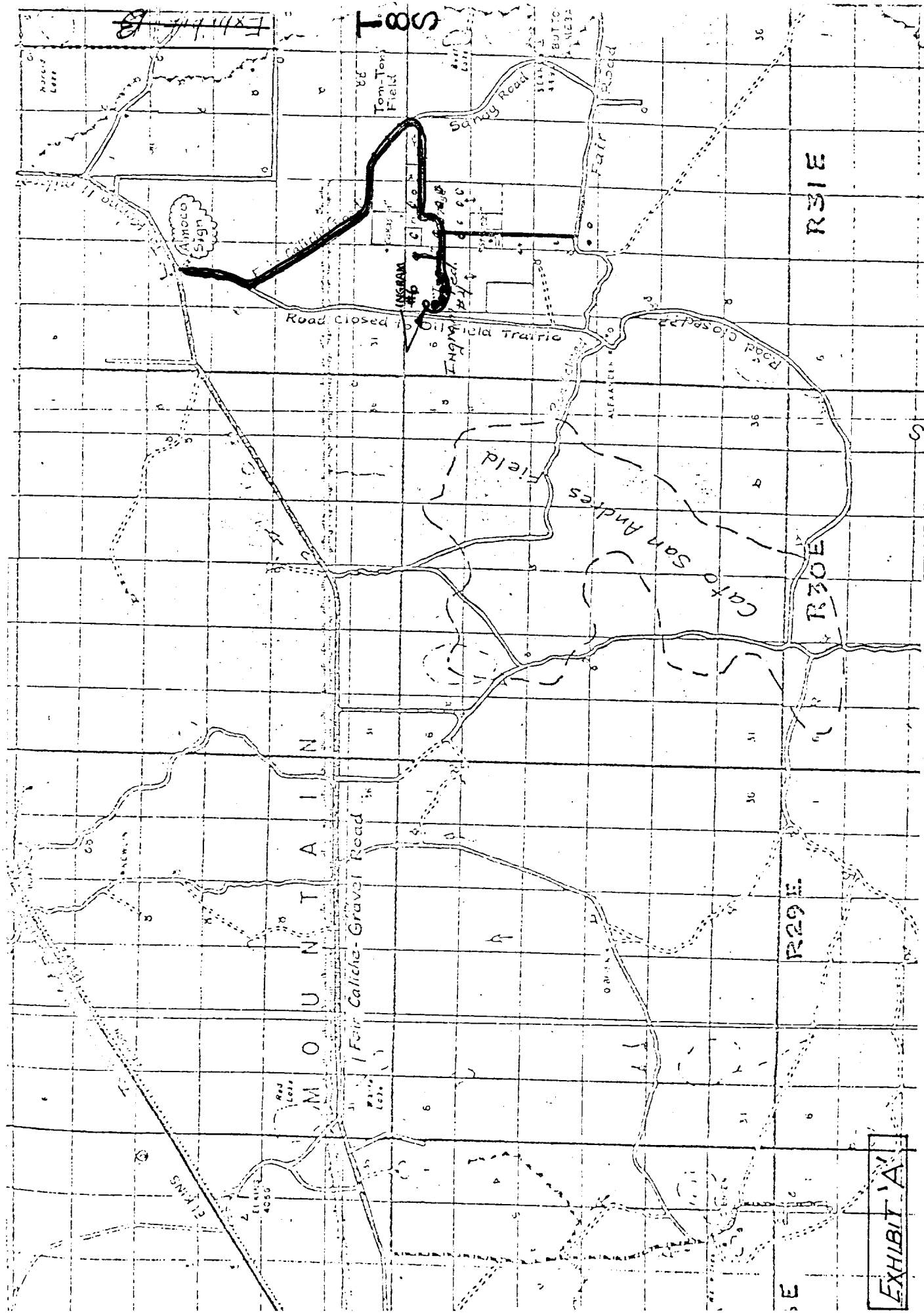

RECEIVED

JUL 6 1977

OIL CONSERVATION COMM.
HOBBS, N. M.

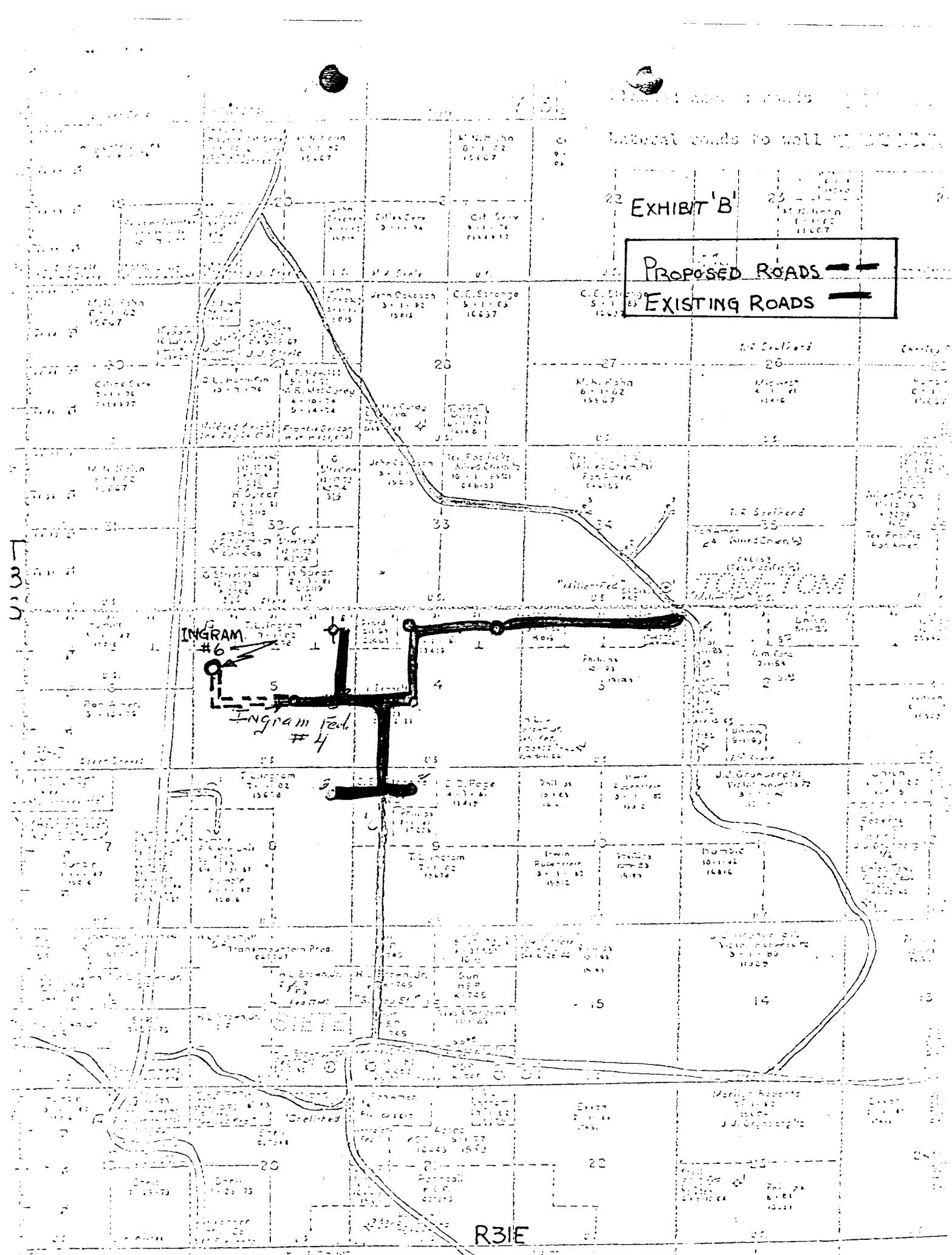

RECEIVED

JUL 6 1977

OIL CONSERVATION COMM.
HOBBS, N. M.

R31E

HEYCO

6

EXHIBIT 'C'

PROPOSED ROAD ===
EXISTING ROAD ==

7

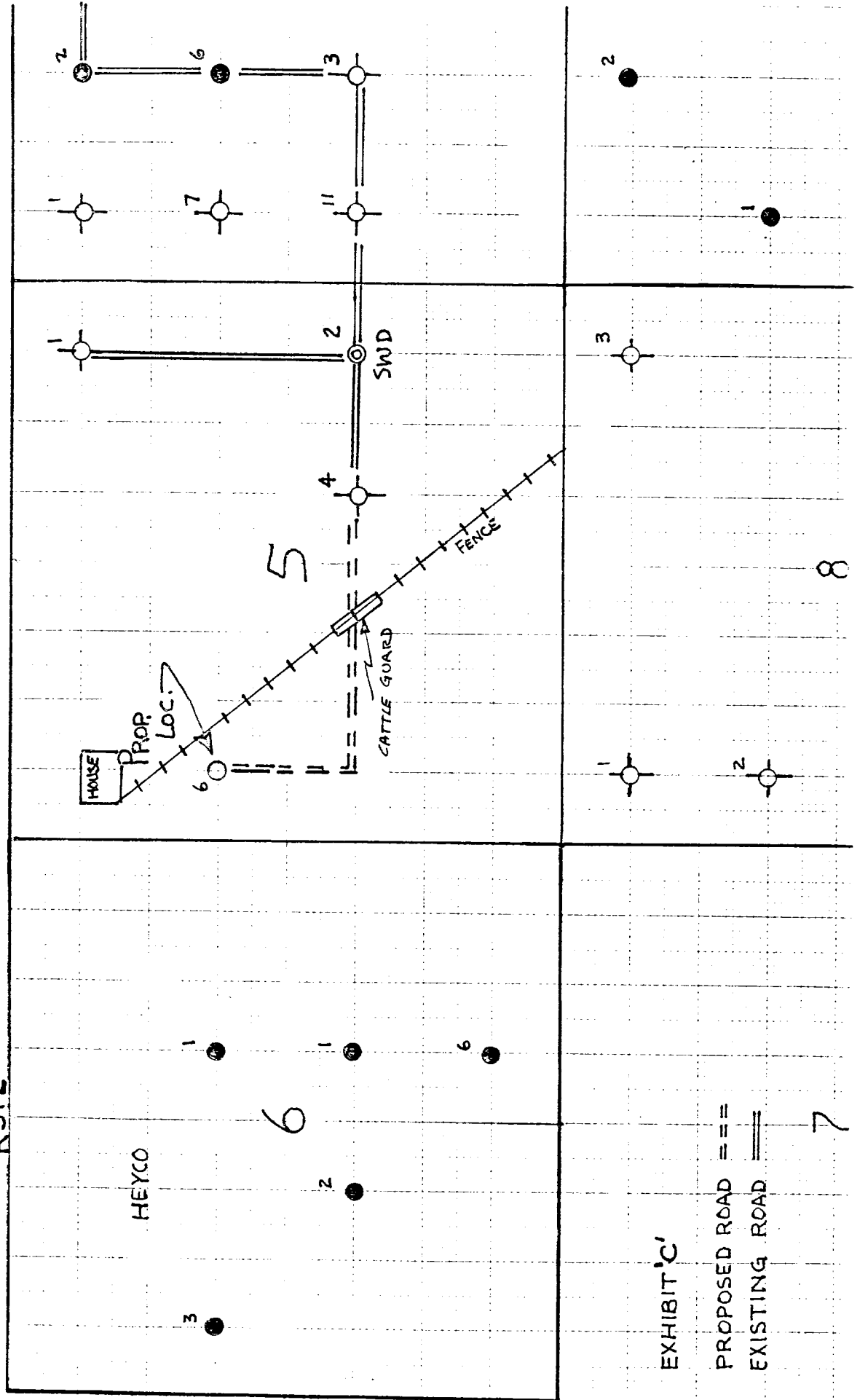

FILED

JUL 6 1977

OIL CONSERVATION COMM.
HOBBS, N. M.

LOCATION, MUD PIT AND
PROPOSED TANK BATTERY
AREA SPECIFICATIONS

- ① Shale PIT 30' x 8'
- ② Mud PIT 20' x 8'
- ③ Suction PIT 30' x 8'
- ④ Reserve PIT 100' x 50'
- ⑤ Pump
- ⑥ Water Tank
- ⑦ Fuel Tank
- ⑧ Rig Pipe Racks
- ⑨ Dog House
- ⑩ Cat Walk 60'
- ⑪ Stinger
- ⑫ Trailer
- ⑬ Burn PIT

NOTE Lines from well to
battery facilities will
lay directly south
from well head.

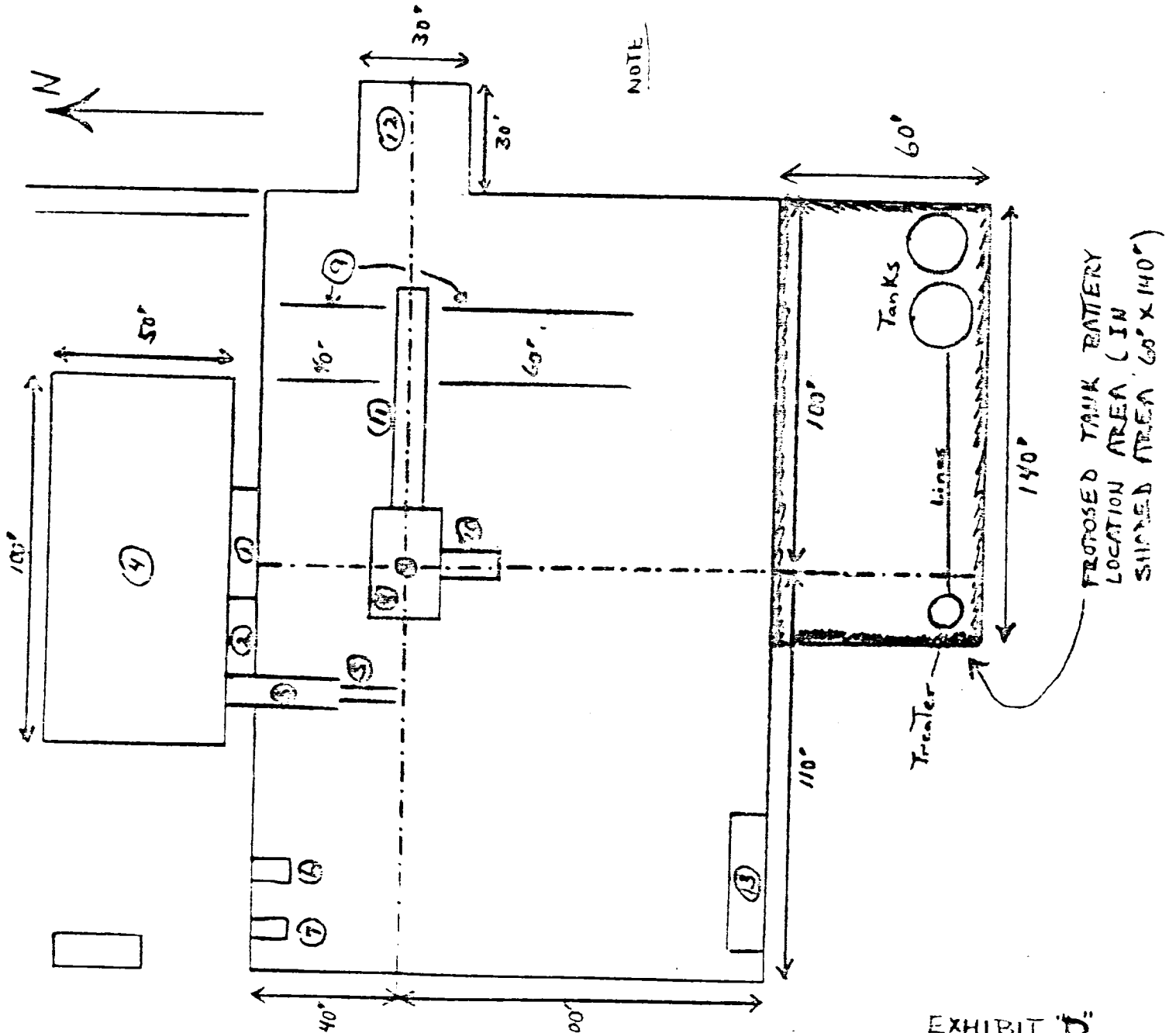

RECEIVED

JUL 1 1977

OIL CONSERVATION COMM.
HOBBS, N. M.