

NO. OF COPIES RECEIVED	
DISTRIBUTION	
SANTA FE	
FILE	
U.S.G.S.	
AND OFFICE	
OPERATOR	

# NEW MEXICO OIL CONSERVATION COMMISSION

Form C-101  
Revised 1-1-61

5A. Indicate Type of Lease	
STATE <input type="checkbox"/>	FEE <input checked="" type="checkbox"/>

5. State Oil & Gas Lease No.

## APPLICATION FOR PERMIT TO DRILL, DEEPEN, OR PLUG BACK

Type of Work

Type of Well	DRILL <input checked="" type="checkbox"/>	DEEPEN <input type="checkbox"/>	PLUG BACK <input type="checkbox"/>
Oil Well <input checked="" type="checkbox"/>	Gas Well <input type="checkbox"/>	Other <input type="checkbox"/>	
	SINGLE ZONE <input type="checkbox"/>	MULTIPLE ZONE <input type="checkbox"/>	

Name of Operator

Harvey E. Yates Company

Address of Operator

P. O. Box 1933, Roswell, New Mexico 88201

Location of Well

UNIT LETTER P LOCATED 660 FEET FROM THE South LINE

660 FEET FROM THE East LINE OF SEC. 6 TWP. 8S RGE. 31E NMPM

7. Unit Agreement Name

8. Firm or Lease Name

Graves

9. Well No.

8

10. Field and Pool, or Wildcat

Cato-San Andres

12. County

Chaves

18. Proposed Depth

3850'

19A. Formation

San Andres

20. Rotary or C.T.

Rotary

11. Deviations (Show whether DF, RL, etc.)

4215. GL

12A. Fund & Status (Plug, Bond)

\$50,000 Blanket

13. Drilling Contractor

WEK Drilling Co., Inc.

22. Approx. Date Work will start

March 1, 1978

## PROPOSED CASING AND CEMENT PROGRAM

SIZE OF HOLE	SIZE OF CASING	WEIGHT PER FOOT	SETTING DEPTH	SACKS OF CEMENT	EST. TOP
11"	8 5/8"	23#	1350'	275 Sx	<i>circulate</i>
7 7/8"	4 1/2"	9.5#	3850'	275 Sx	<i>base of salt</i>

900 Series 10" Schaffer Type E Blowout Preventer will be used.

**APPROVAL VALID**  
FOR 90 DAYS  
DRILLING CONTRACT

**EXPIRES** March 21, 1978

ABOVE SPACE DESCRIBE PROPOSED PROGRAM: IF PROPOSAL IS TO DEEPEN OR PLUG BACK, GIVE DATA ON PRESENT PRODUCTIVE ZONE AND PROPOSED NEW PRODUCTION ZONE. GIVE BLOWOUT PREVENTER PROGRAM, IF ANY.

I hereby certify that the information above is true and complete to the best of my knowledge and belief.

by Harvey E. Yates Title Vice President Date February 17, 1978

(This space for State Use)

**Geologist**

APPROVED BY John H. Remyan TITLE Geologist DATE February 17, 1978

CONDITIONS OF APPROVAL, IF ANY:

RECEIVED  
JUL 10 1966  
U.S. DEPARTMENT OF AGRICULTURE  
WASHINGTON, D.C.

NEW MEXICO OIL CONSERVATION COMMISSION  
WELL LOCATION AND ACREAGE DEDICATION PLAT

Form C-102  
Supersedes C-128  
Effective 1-4-65

All distances must be from the outer boundaries of the Section.

Operator <b>Harvey E. Yates Company</b>			Lease <b>Graves</b>		Well No. <b>8</b>
Tract Letter <b>P</b>	Section <b>6</b>	Township <b>8S</b>	Range <b>31E</b>	County <b>Chaves</b>	
Actual Footage Location of Well: <b>660.0</b> feet from the <b>South</b> line and <b>660.0</b> feet from the <b>East</b> line					
Ground Level Elev. <b>4215.0</b>	Producing Formation <b>San Andres</b>		Pool <b>Cato-San Andres</b>		Dedicated Acreage: <b>40</b> Acres

1. Outline the acreage dedicated to the subject well by colored pencil or hachure marks on the plat below.
2. If more than one lease is dedicated to the well, outline each and identify the ownership thereof (both as to working interest and royalty).
3. If more than one lease of different ownership is dedicated to the well, have the interests of all owners been consolidated by communitization, unitization, force-pooling, etc?

☐ Yes ☐ No If answer is "yes," type of consolidation \_\_\_\_\_

If answer is "no," list the owners and tract descriptions which have actually been consolidated. (Use reverse side of this form if necessary.) \_\_\_\_\_

No allowable will be assigned to the well until all interests have been consolidated (by communitization, unitization, forced-pooling, or otherwise) or until a non-standard unit, eliminating such interests, has been approved by the Commission.

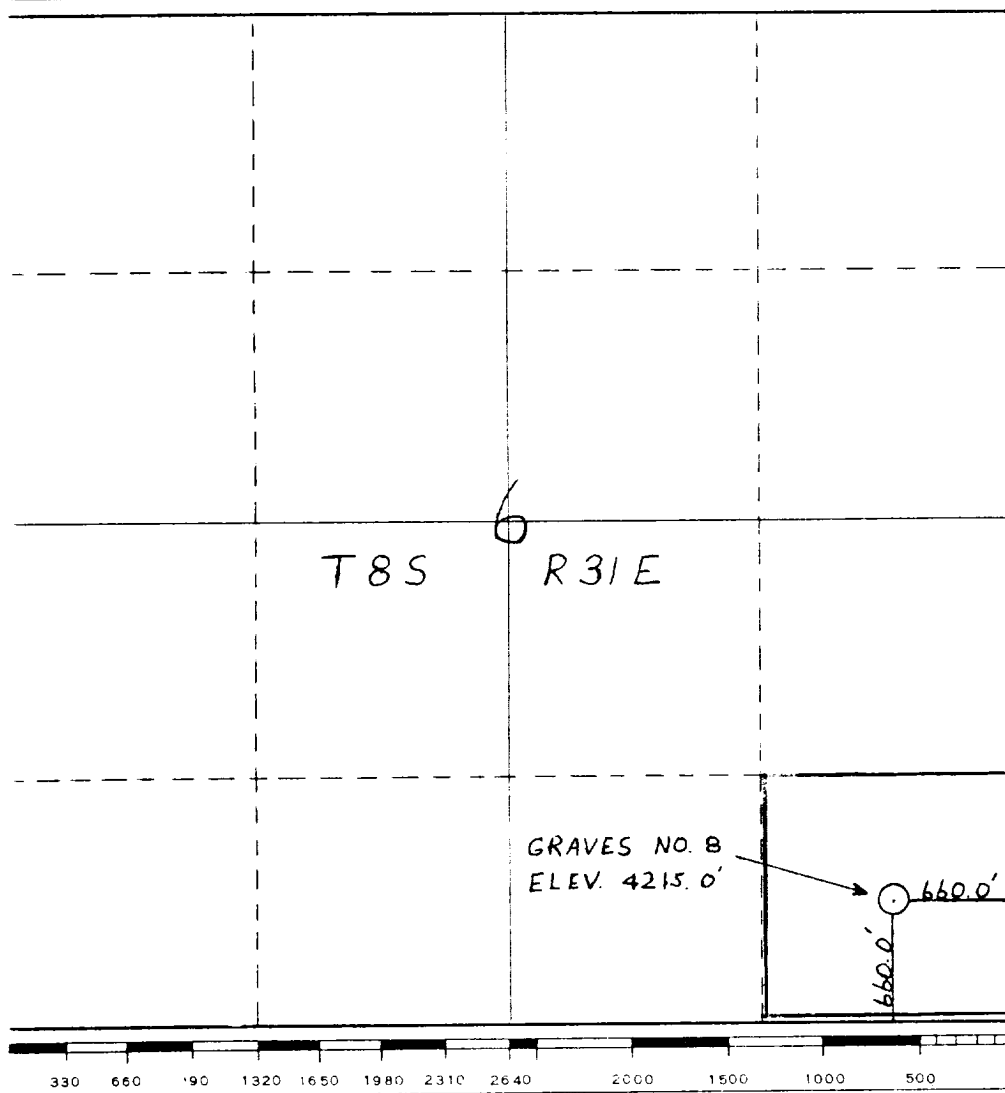

CERTIFICATION

I hereby certify that the information contained herein is true and complete to the best of my knowledge and belief.

Name *Richard L. G. Yates*  
Position **Vice President**  
Company **Harvey E. Yates Co., Inc.**  
Date **February 17, 1978**

I hereby certify that the well location shown on this plat was plotted from field notes of actual surveys made by me or under my supervision, and that the same is true and correct to the best of my knowledge and belief.

Date Surveyed **8-17-77**  
Registered Professional Engineer No. **277**  
Certificate No. **#277**

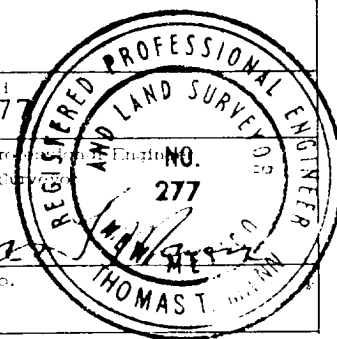

100-100000

FEB 20 1978  
OIL CONSERVATION COMM.  
HOBBS, N. M.

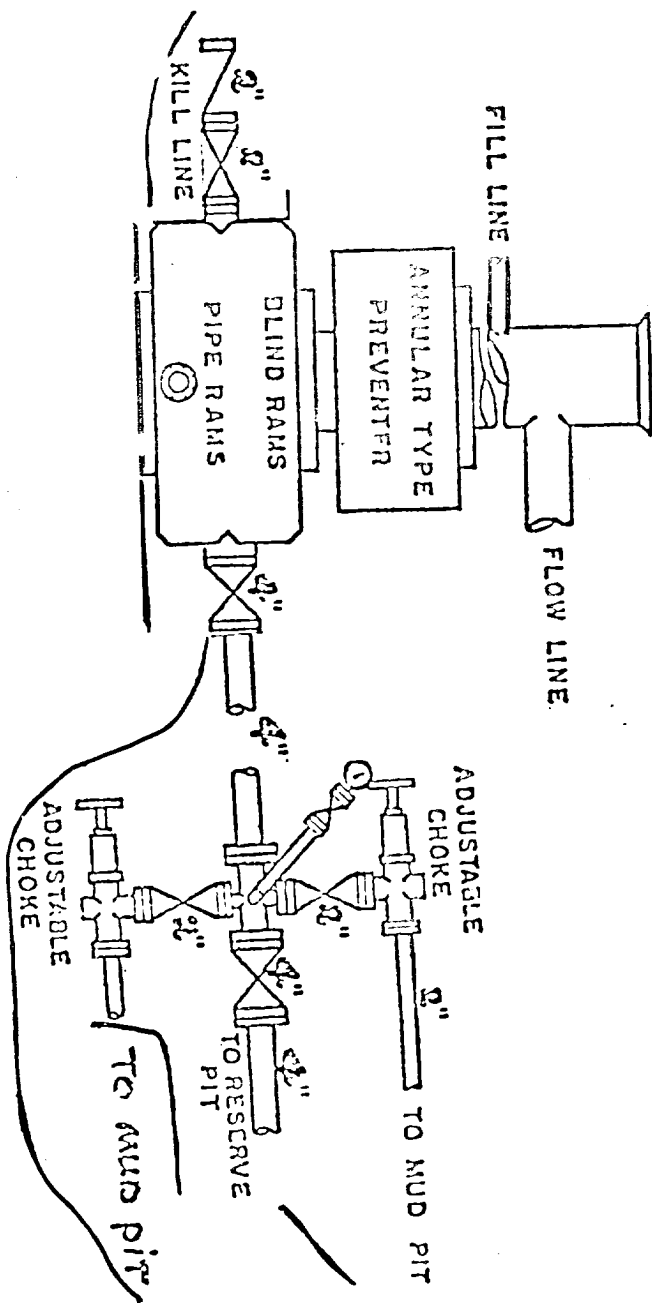

900 Series

