

NO. OF COPIES RECEIVED	
DISTRIBUTION	
SANTA FE	
FILE	
U.S.G.S.	
LAND OFFICE	
OPERATOR	

# NEW MEXICO OIL CONSERVATION COMMISSION

Form C-101  
Revised 1-1-65

5A. Indicate Type of Lease	
STATE <input checked="" type="checkbox"/>	FEE <input type="checkbox"/>
5. State Oil & Gas Lease No.	
L-4410	

## APPLICATION FOR PERMIT TO DRILL, DEEPEN, OR PLUG BACK

1a. Type of Work		7. Unit Agreement Name	
b. Type of Well DRILL <input checked="" type="checkbox"/> DEEPEN <input type="checkbox"/> PLUG BACK <input type="checkbox"/> OIL WELL <input checked="" type="checkbox"/> GAS WELL <input type="checkbox"/> OTHER <input type="checkbox"/> SINGLE ZONE <input type="checkbox"/> MULTIPLE ZONE <input type="checkbox"/>		8. Farm or Lease Name Miller - State	
2. Name of Operator Miller Oil Company		9. Well No. 1	
3. Address of Operator 3612 West Wall Street, Midland, Texas 79701		10. Field and Pool, or Wildcat Wildcat	
4. Location of Well UNIT LETTER C LOCATED 990 FEET FROM THE North LINE AND 1800 FEET FROM THE West LINE OF SEC. 34 TWP. 8-S RGE. 32-E NMPM		12. County Chaves	
18. Proposed Depth 11,200'		19A. Formation Devonian	
20. Rotary or C.T. Rotary		21. Elevations (Show whether DF, RT, etc.) 4366.8 GL	
21A. Kind & Status Plug, Bond \$50,000.00 Blanket Plug Bond, United States		21B. Drilling Contractor Forester Drilling Co.	
22. Approx. Date Work will start May 8, 1978		23. Fidelity & Guaranty Bond No. 18-0130-1774-77 PROPOSED CASING AND CEMENT PROGRAM	

SIZE OF HOLE	SIZE OF CASING	WEIGHT PER FOOT	SETTING DEPTH	SACKS OF CEMENT	EST. TOP
17 1/2"	12 3/4"	40#	400'	475	Circulated
11 "	8 5/8"	24# & 32#	3,600'	1150	Circulated
7 7/8"	5 1/2"	17# & 20#	11,220'	550	9,700'

The proposed program is to drill a wildcat to the Devonian Formation.

IN ABOVE SPACE DESCRIBE PROPOSED PROGRAM: IF PROPOSAL IS TO DEEPEN OR PLUG BACK, GIVE DATA ON PRESENT PRODUCTIVE ZONE AND PROPOSED NEW PRODUCTIVE ZONE. GIVE BLOWOUT PREVENTER PROGRAM, IF ANY.

I hereby certify that the information above is true and complete to the best of my knowledge and belief.

Signed A.S. Barker Title Geophysicist Date 4/19/78  
(This space for State Use)

APPROVED BY [Signature] TITLE SUPERVISOR DISTRICT 1 DATE APR 21 1978  
CONDITIONS OF APPROVAL, IF ANY:

**NEW MEXICO OIL CONSERVATION COMMISSION  
WELL LOCATION AND ACREAGE DEDICATION PLAT**

Form C-102  
Supersedes C-128  
Effective 1-1-65

All distances must be from the outer boundaries of the Section

Operator <b>Miller Exploration Co.</b>			Lease <b>Miller State</b>		Well No. <b>1</b>
Unit Letter <b>C</b>	Section <b>34</b>	Township <b>8 South</b>	Range <b>32 East</b>	County <b>Chaves</b>	
Actual Footage Location of Well: <b>990</b> feet from the <b>North</b> line and <b>1800</b> feet from the <b>West</b> line					
Ground Level Elev. <b>4366.8</b>	Producing Formation <i>Permian</i>	Pool <i>Miller</i>	Dedicated Acreage: <b>40</b> Acres		

1. Outline the acreage dedicated to the subject well by colored pencil or hatchure marks on the plat below.
2. If more than one lease is dedicated to the well, outline each and identify the ownership thereof (both as to working interest and royalty).
3. If more than one lease of different ownership is dedicated to the well, have the interests of all owners been consolidated by communitization, unitization, force-pooling, etc?

☐ Yes    ☐ No    If answer is "yes," type of consolidation \_\_\_\_\_

If answer is "no," list the owners and tract descriptions which have actually been consolidated. (Use reverse side of this form if necessary.) \_\_\_\_\_

No allowable will be assigned to the well until all interests have been consolidated (by communitization, unitization, forced-pooling, or otherwise) or until a non-standard unit, eliminating such interests, has been approved by the Commission.

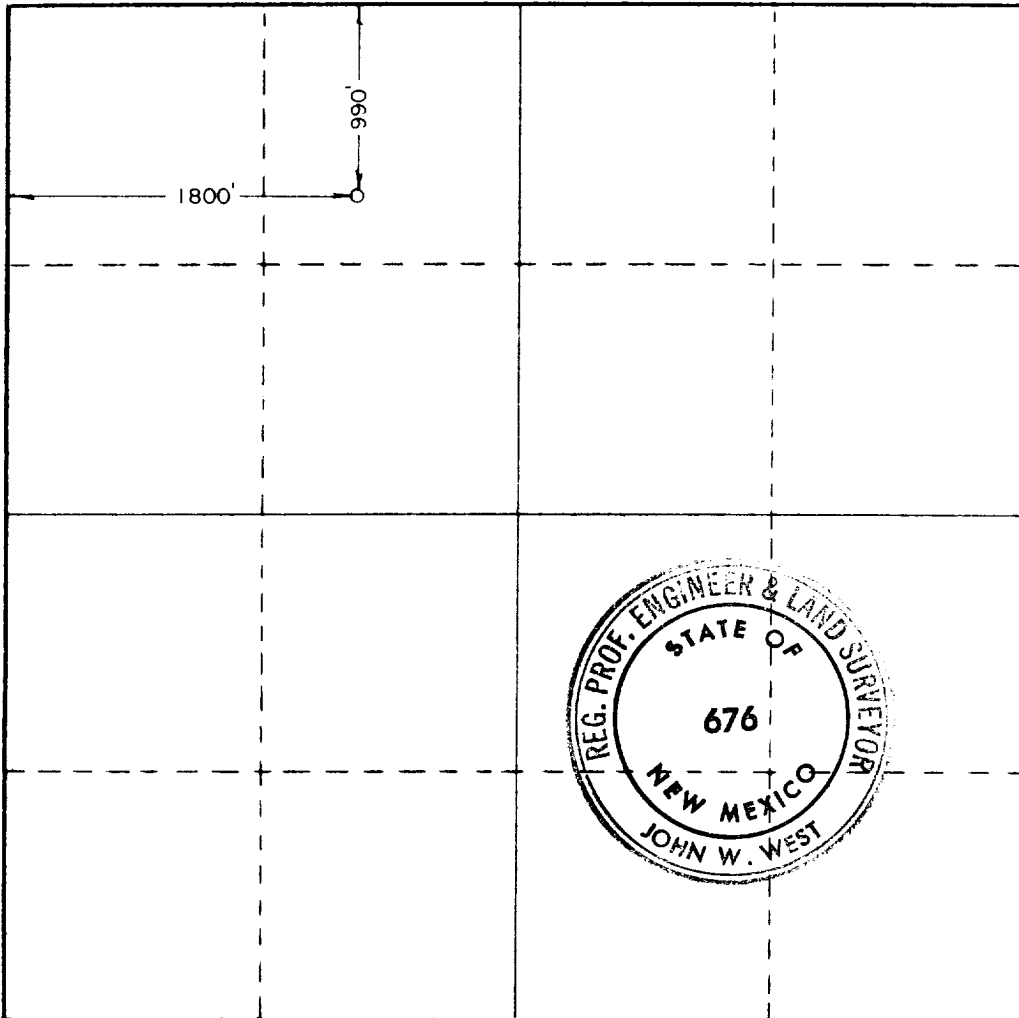

**CERTIFICATION**

I hereby certify that the information contained herein is true and complete to the best of my knowledge and belief.

Name *A.S. Barker*

Position  
**Geophysicist**

Company  
**Miller Oil Company**

Date  
**April 18, 1978**

I hereby certify that the well location shown on this plat was plotted from field notes of actual surveys made by me or under my supervision, and that the same is true and correct to the best of my knowledge and belief.

Date Surveyed  
**4/13/78**

Registered Professional Engineer and/or Land Surveyor

*John W. West*  
Certificate No. **John W. West**

**676**  
**Ronald J. Eidson 3239**

0 330 660 990 1320 1650 1980 2310 2640 2970 3300 3630 3960 4290 4620 4950 5280 5610 5940 6270 6600