

MOCC COPY

SUBMIT IN TRIPLICATE\*

(Other instructions on  
reverse side)Form approved  
Budget Bureau No. 42 RI425UNITED STATES  
DEPARTMENT OF THE INTERIOR  
GEOLOGICAL SURVEY

5. LEASE DESIGNATION AND SERIAL NO.

USA NM 13418

6. IF INDIAN ALLOTTEE OR TRIBE NAME

7. UNIT AGREEMENT NAME

8. FARM OR LEASE NAME

Amoco-Federal

9. WELL NO.

3

10. FIELD AND POOL, OR WILDCAT

Tom Tom San Andres

11. SEC., T., R., M., OR BLK.  
AND SURVEY OR AREA

Sec. 26, T-7-S, R-31-E

12. COUNTY OR PARISH 13. STATE

Chaves

New Mexico

1a. TYPE OF WORK

DRILL ☒DEEPEN ☐PLUG BACK ☐

b. TYPE OF WELL

OIL  
WELL ☒GAS  
WELL ☐

OTHER

SINGLE  
ZONE ☒MULTIPLE  
ZONE ☐

2. NAME OF OPERATOR

Flag-Redfern Oil Company

3. ADDRESS OF OPERATOR

P.O. Box 23, Midland, Texas 79702

4. LOCATION OF WELL (Report location clearly and in accordance with any State requirements)

At surface

660' FWL &amp; 660' FSL

At proposed prod. zone

14. DISTANCE IN MILES AND DIRECTION FROM NEAREST TOWN OR POST OFFICE

17 miles east of Elkins, New Mexico

15. DISTANCE FROM PROPOSED\*  
LOCATION TO NEAREST  
PROPERTY OR LEASE LINE, FT.  
(Also to nearest drig. unit line, if any)

660'

16. NO. OF ACRES IN LEASE

320

17. NO. OF ACRES ASSIGNED  
TO THIS WELL

40

18. DISTANCE FROM PROPOSED LOCATION\*  
TO NEAREST WELL, DRILLING, COMPLETED,  
OR APPLIED FOR, ON THIS LEASE, FT.

5,442'

19. PROPOSED DEPTH

4100'

20. ROTARY OR CABLE TOOLS

Rotary

21. ELEVATIONS (Show whether DF, RT, GR, etc.)

4364' G.L.

22. APPROX. DATE WORK WILL START\*

May 1, 1978

## 23. PROPOSED CASING AND CEMENTING PROGRAM

SIZE OF HOLE	SIZE OF CASING	WEIGHT PER FOOT	SETTING DEPTH	QUANTITY OF CEMENT
12½"	8-5/8"	24 J	1650'	700 sx
7-7/8"	4½"	10.50 K	4100'	250 sx

Drill 12½" hole to 1650'. Run 8-5/8" casing and circulate cement using 700 sxs of Halliburton lite with 0.4% CFR-2, 2% cacl and 8 lb. salt per sx. Drill 7-7/8" hole to approximately 4100'. Run open hole logs. Run 4½" casing and cement with 250sxs of class "H" with 2% gel, 0.75% CFR-2, and 8 lb. salt per sx. Run correlation logs and perforate San Andres formation. Treat with acid. Swab to test, potential well. Blowout preventers: Cameron 10"-series 900. Installed on surface pipe

Mud program:

0-1650 Native mud  
1650-3800 Native mud and oil  
3800-T.D. Starch, oil emulsion

Estimated Formation Tops:

Rustler Anhydrite - 1643'  
Salt - 1689'  
Yates - 2044'  
San Andres - 3167'  
PI Zone - 3715'  
S. A. Porosity - 3949'

IN ABOVE SPACE DESCRIBE PROPOSED PROGRAM: If proposal is to deepen or plug back, give data on present productive zone and proposed new productive zone. If proposal is to drill or deepen directionally, give pertinent data on subsurface locations and measured and true vertical depths. Give blowout preventer program, if any.

24.

SIGNED

TITLE Petroleum Engineer

DATE 4-5-78

(This space for Federal or State office use)

PERMIT NO.

APPROVAL DATE

APR 20 1978

APPROVED BY

TITLE ACTING DISTRICT ENGINEER

DATE APR 20 1978

CONDITIONS OF APPROVAL, IF ANY:

THIS APPROVAL IS RESCINDED IF OPERATIONS  
ARE NOT COMMENCED WITHIN 3 MONTHS.

EXPIRES

JUL 20 1978

\*See Instructions On Reverse Side

100-100000

CONFIDENTIAL

CONFIDENTIAL

RECEIVED  
APR 21 1978  
O.C.C.  
ARTESIA, OFFICE

**NEW MEXICO OIL CONSERVATION COMMISSION  
WELL LOCATION AND ACREAGE DEDICATION PLAT**

Form C-102  
Supersedes C-128  
Effective 1-1-65

All distances must be from the outer boundaries of the Section.

Operator <b>Flag-Redfern Oil Company</b>			Lease <b>Amoco-Federal</b>		Well No. <b>3</b>
Unit Letter <b>M</b>	Section <b>26</b>	Township <b>7-S</b>	Range <b>31-E</b>	County <b>Chaves</b>	
Actual Footage Location of Well: <b>660</b> feet from the <b>west</b> line and <b>660</b> feet from the <b>south</b> line					
Ground Level Elev. <b>4364</b>	Producing Formation <b>San Andres</b>		Pool <b>Tom Tom</b>	Dedicated Acreage: <b>40</b> Acres	

- Outline the acreage dedicated to the subject well by colored pencil or hachure marks on the plat below.
- If more than one lease is dedicated to the well, outline each and identify the owners thereof both as to working interest and royalty).
- If more than one lease of different ownership is dedicated to the well, have the interests of all owners been consolidated by communitization, unitization, force-pooling, etc?

☐ Yes ☐ No If answer is "yes," type of consolidation \_\_\_\_\_

If answer is "no," list the owners and tract descriptions which have actually been consolidated. (Use reverse side of this form if necessary.) \_\_\_\_\_

No allowable will be assigned to the well until all interests have been consolidated (by communitization, unitization, forced-pooling, or otherwise) or until a non-standard unit, eliminating such interests, has been approved by the Commission.

**RECEIVED**

**APR 6 1978**

**U.S. GEOLOGICAL SURVEY  
ARTESIA, NEW MEXICO**

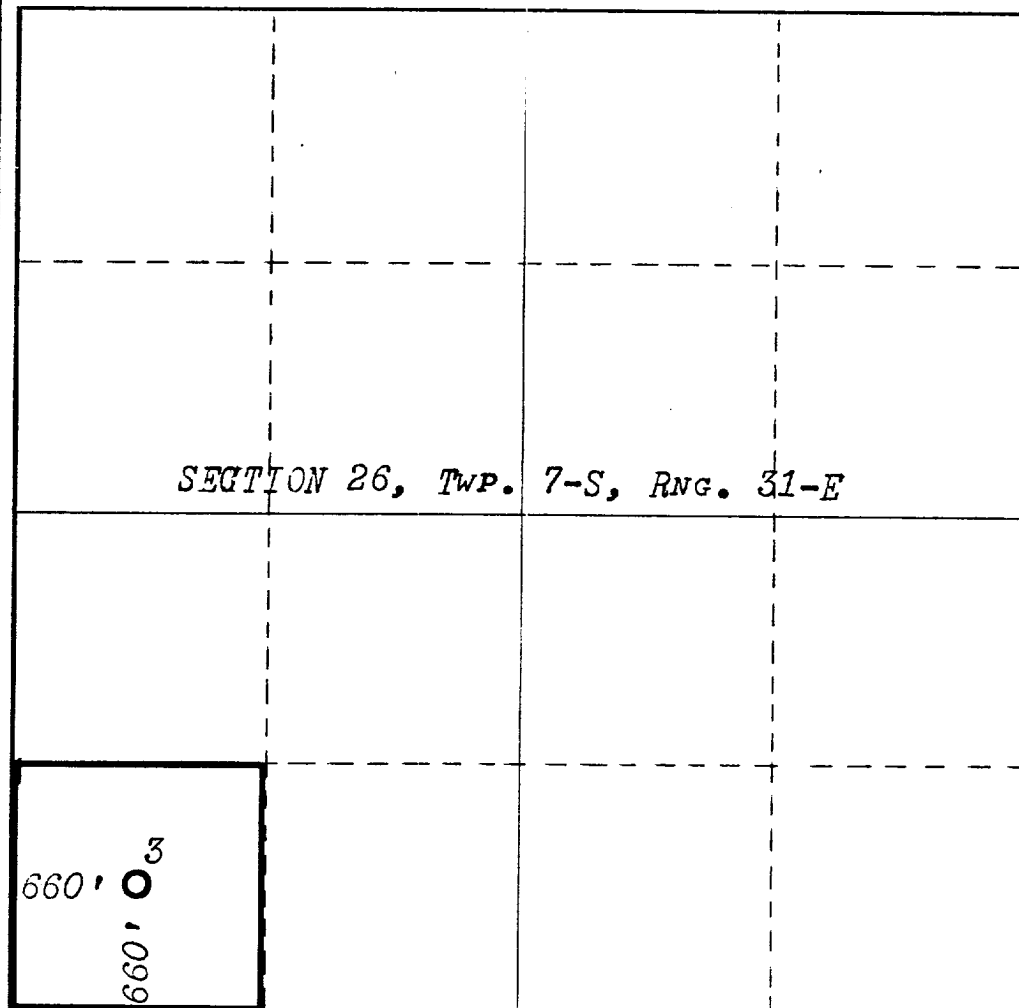

**CERTIFICATION**

I hereby certify that the information contained herein is true and complete to the best of my knowledge and belief.

*Steve W. Rossler*  
Name: **Steve W. Rossler**

Position

**Petroleum Engineer**

Company

**Flag-Redfern Oil Company**

Date

**April 4, 1978**

I hereby certify that the well location shown on this plat was plotted from field notes of actual surveys made by me or under my supervision, and that the same is true and correct to the best of my knowledge and belief.

Date Surveyed

**APR. 4, 1978**

Registered Professional Engineer and/or Land Surveyor

Certificate No.

**754**

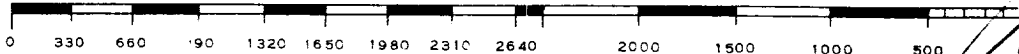

APPLICATION TO DRILL  
AMOCO-FEDERAL WELL #3

In response to questions asked under Section II B of Bulletin NTL-6, the following answers are provided for your consideration:

1. Location: 660' FWL & 660' FSL of Section 26, T-7-S, R-31-E, Chaves County, New Mexico.
2. Elevation Above Sea Level: 4364' G.L.
3. Geologic Name of Surface Formation: Mississippian
4. Drilling Tools and Associated Equipment: Conventional Rotary drilling rig using mud for the circulation medium.
5. Proposed Drilling Depth: 4100'
6. Estimated Geological Marker Tops: Rustler Anhydrite - 1643'  
Salt - 1689', Yates - 2044', San Andres - 3167', PI Zone - 3715',  
San Andres Porosity - 3949'.
7. Mineral Bearing Formations: Water Bearing - none, Gas Bearing - none, Oil Bearing - San Andres Porosity @ 3935'.
8. Casing Program: (a) Surface casing - 8-5/8" - 24 lb/ft. J-55 new casing; (b) Production casing - 4½" - 10.50 lb/ft. K-55 new casing.
9. Setting Depth of Casing and Cement for Same: (a) 8-5/8" casing set at 1650'. Cement will be circulated to the surface using 700 sxs of Halliburton Lite with 0.4% CFR-2, 2% cacl, and 8 lb/sx of salt. (b) 4½" casing set at 4100' and will be cemented with 250 sxs of Class "H" with 2% gel, 0.75% CFR-2, and 8 lb. salt per/sx
10. Pressure Control Equipment: Blowout preventers will be installed on the surface casing. They will be 10" API Series 900 dual preventers adapted for the drilling contractor's 4½" and 5½" drill pipe. They will be capable of closing off of all open areas. The blowout preventers will be hydraulically actuated by an 80 gal Payne accumulator. The blowout preventers will be tested to 2000 psig after they are installed on the surface casing, prior to drilling out, and each time they are removed or rearranged on the wellhead.
11. Proposed Circulating Medium: Mud will be used for the circulating medium for all depths in this well. The following mud properties will be maintained:  
0 - 1650' Fresh water based native mud, mud weight 8.6 to 10.0 lb/gal, viscosity 32 to 34 seconds.  
1650' - 3800' Fresh water based native mud with oil, mud weight 10.0 lb/gal. viscosity 32 to 33 seconds.  
3800' - 4100' (T.D.) Fresh water based mud with starch and oil. Mud weight 10.0 lb/gal, viscosity 38 to 42 seconds, fluid loss 10 to 15 milliliters.

12. Testing Logging and Coring Programs: (a) Testing - All Testing will be commenced after the well is drilled and casing has been set and cemented. (b) Logging - At total depth the following logs will be run:  
0-4100' Sidewall neutron porosity with gamma ray, caliper and "F" curve.  
3500'-4100' dual laterolog with Ro curve  
(c) Coring - none anticipated.
13. Potential Hazards: No abnormal pressure or temperature zones are anticipated. Hydrogen sulfide gas is not expected to be a problem; however, the drilling rig will be so situated as to allow all gas vapors to be expelled away from all personnel gathering sites and engine exhausts.
14. Anticipated Starting Date and Duration of Operations: May 1, 1978 Road and location to be constructed, May 15, 1978 Drilling rig to spud well, June 1, 1978 Pulling unit to complete well, July 1, 1978 Well to be potentialled.
15. Other Facets of Operation: After running 4½" casing, cased hole gamma-ray collar correlation logs will be run from 4050' to 2550'. The San Andres Porosity zone will be perforated and acidized with an estimated 5,000 gal. The well will then be swabbed tested and a pumping unit will be installed to potential and produce the well.

Surface Use and Operation Plan

Flag-Redfern Oil Company  
Amoco-Federal No. 3  
Section 26, T-7-S, R-31-E  
Chaves County, New Mexico

RECEIVED

APR 6 1978

U.S. GEOLOGICAL SURVEY  
ARTESIA, NEW MEXICO

1. Existing Roads

- A. Attached is a portion of a U.S.G.S. topographic map showing existing roads in the vicinity of the proposed location.
- B. Attached is a plat showing existing roads in the area of the proposed location.
- C. There are no plans for improving the existing roads.

2. Access Roads

- A. Planned access roads are shown on the attached plat.
- B. The road will be constructed of caliche and will be 10' wide.
- C. A cattleguard is installed where the road enters Section 23.

3. Location of Existing Wells

- A. Existing wells are shown on the attached plat.

4. Location of Tank Batteries, etc.

- A. A tank battery and production facility consisting of two 210 bbl. stock tanks and a heater treater will be located on this same lease directly south of the proposed location.
- B. In the event the proposed well is productive, a 2" flowline will be laid, alongside the access road, to the above mentioned production facility.
- C. The reserve pits will be back filled and leveled and the surface returned to its original contours.

5. Location and Type of Water Supply

- A. There is no known surface water in the area.
- B. A windmill is located approximately 4000' north of the proposed location.
- C. All water used in drilling operations will be trucked to the drillsite from commercial sources.

6. Source of Construction Materials

- A. Construction material will be caliche, which will be purchased by the dirt contractor.

7. Methods for Handling Waste Disposal

- A. Well cuttings will be disposed in the reserve pit. All waste and trash will be either burned or buried in a separate pit.
- B. After completion any produced water will be collected in tanks and trucked to an approved disposal system.
- C. During testing operations, all produced fluids will be collected in tanks and trucked from the well site.

8. Auxiliary Facilities

- A. None anticipated.

9. Well Site Layout

- A. Attached is a plat of the well site and rig layout.

10. Plans for Restoration of the Surface

- A. As soon as practical upon completion of the well, the pits will be back filled and leveled and the surface returned to its original contours.

11. Other Information

- A. See attached topographic map for terrain of the general area which consists of an undulating plain covered by sandy soils of alluvian and aeolian origin.
- B. Characteristic soils belong to the typic haplargids paleargids associations.
- C. Vegetation consists of yucca glauca, rhus trilobata, gutierrezia sarothrae, eurotia, lanata, and lycurus phleoides.
- D. Fauna consists of crotalus and sistrurus, canis latrans, lepus alleni, mephitis mephitis and antelope.
- E. The surface of this land is being utilized to a limited extent as grazing land for cattle.

- F. The surface is private owned.
- G. No cultural resources or archeological sites are present.
- H. There are no steep hillsides, no deep gullies, no streams and no occupied dwellings on this lease.

12. Operator's Representative

Steve W. Rossler  
P.O. Box 23  
Midland, Texas 79702

Office Phone: 915-683-5184  
Home Phone: 915-697-3808

13. Certification

I hereby certify that I, or persons under my direct supervision, have inspected the proposed drillsite and access route; that I am familiar with the conditions which presently exist, that the statements made in this plan are, to the best of my knowledge, true and correct; and, that the work associated with the operations proposed herein will be performed by Flag-Redfern Oil Company and its contractors and sub-contractors in conformity with this plan and the terms and conditions under which it is approved.

Date 4-5-78

  
Steve W. Rossler, Engineer



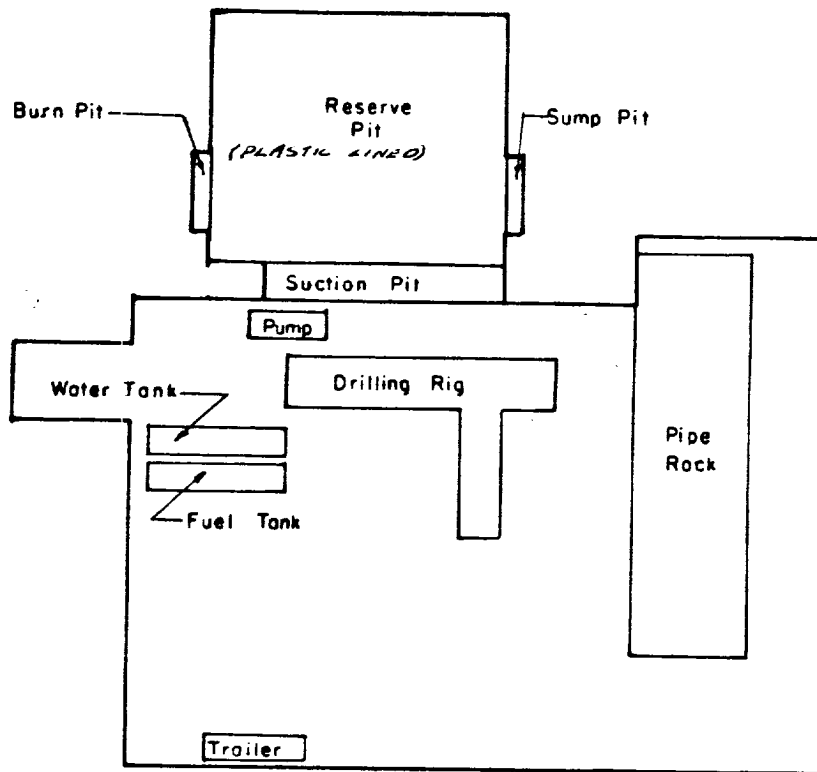

**Flag-Redfern Oil Company**

1200 WALL TOWERS WEST • MIDLAND TEXAS 79702

P. O. BOX 23 • PHONE (915) 6835184

## WELL SITE LAYOUT

Well No.3- Amoco Fed. Lse.  
660' FSL & 600' FWL, Sec. 26 T-7-S, R-31-E  
CHAVES County, New Mexico

Scale: 1" = 50'

4-3-78

R-31-E

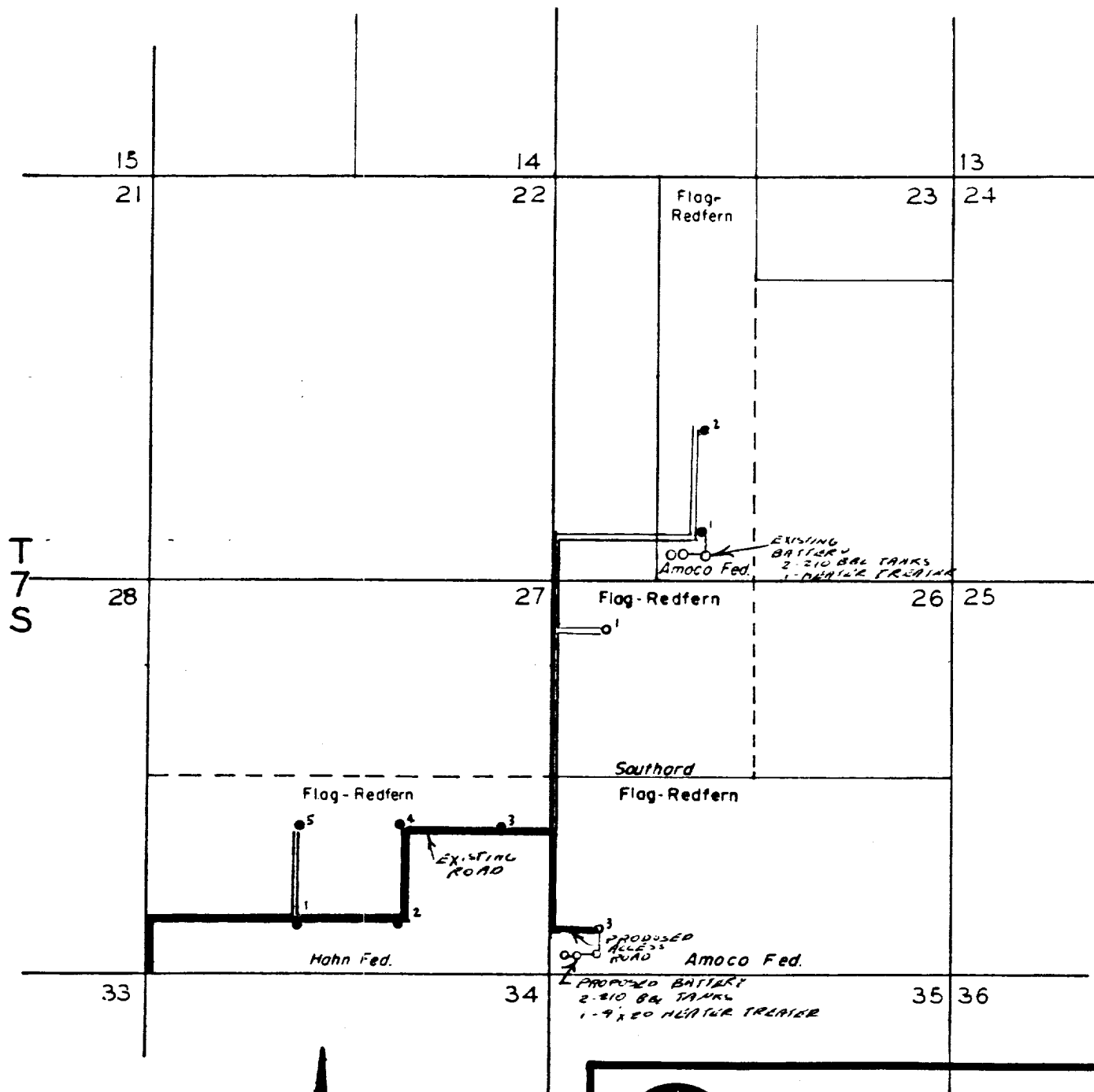

**Flag-Redfern Oil Company**

1200 WALL TOWERS WEST • MIDLAND, TEXAS 79702

P. O. BOX 23 • PHONE (815) 683-5184

**AREA PLAT**

**SOUTHARD AREA**

**Well No.3 Amoco Fed. Lse.**

660' FSL & 660' FWL

Sec. 26, T-7-S, R-31-E

CHAVES County, New Mexico

Scale: 1" = 2000' 4-3-78



# Flag-Redfern Oil Company

P. O. BOX 23•MIDLAND, TEXAS 79701•410 WALL TOWERS WEST•PHONE (915) 683-5184

April 4, 1978

FILE:

U. S. Department of Interior  
Geological Survey  
105 South 4th Street  
Artesia, New Mexico 88210

Dear Sir:

Flag-Redfern Oil Company is making application to drill the Amoco-Federal No. 3 in Section 26, T-7-S, R-31-E, Chaves County, New Mexico. This is a federal lease with private surface ownership. An agreement with the surface owner has been reached for drilling the well. No special restoration provisions were included in the agreement.

Yours very truly,

Steve W. Rossler  
Petroleum Engineer

SWR:bj

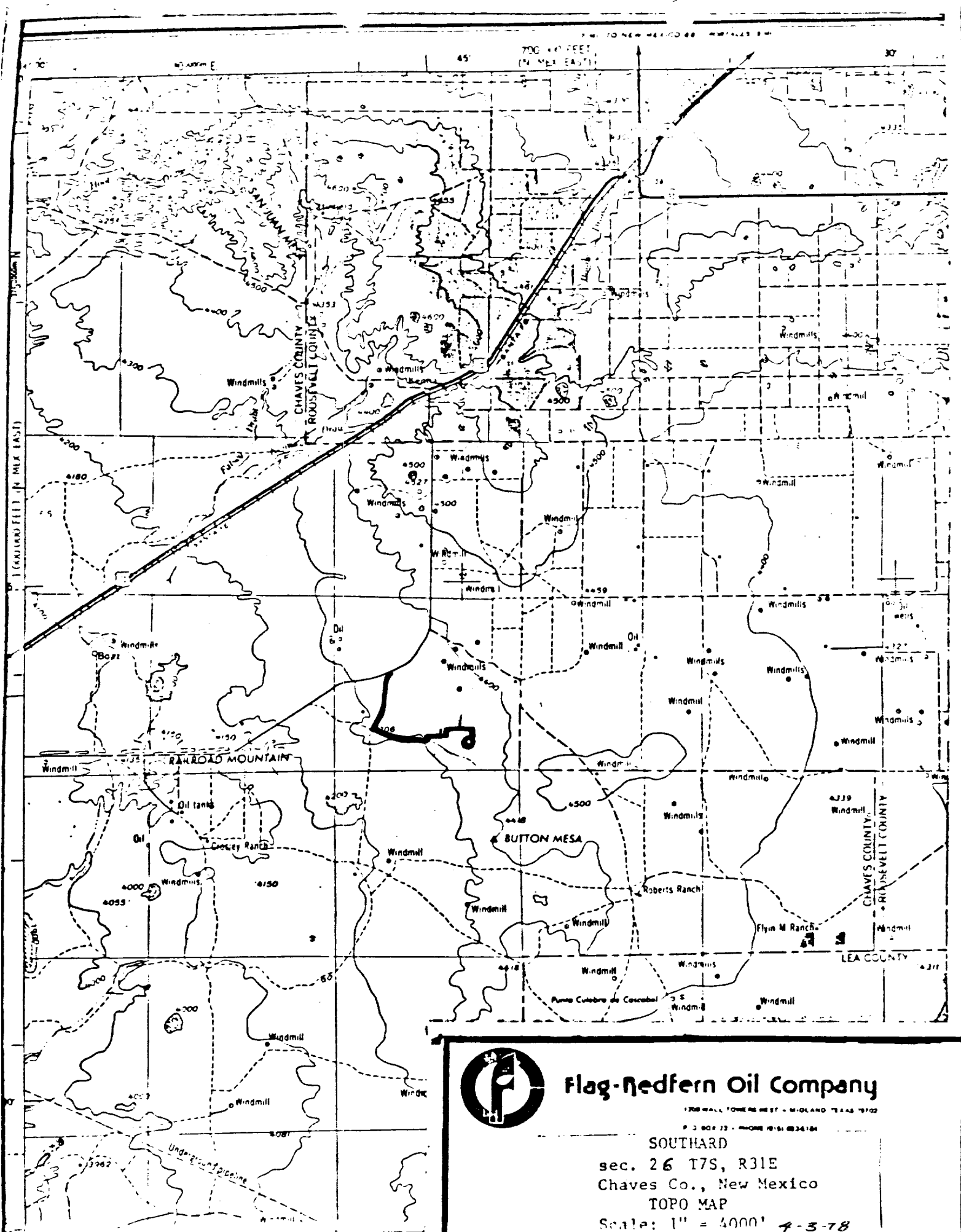

**Flag-Nedfern Oil Company**

1208 WALL TOWER RD. WEST - MIDLAND TEXAS 79702  
P. O. BOX 22 - PHONE (817) 834184

**SOUTHARD**  
sec. 26 T7S, R31E  
Chaves Co., New Mexico  
**TOPO MAP**

Scale: 1" = 4000' 4-3-78

DIRECTIONS TO :

Amoco-Federal Well #3  
Tom Tom San Andres Field  
Chaves County, New Mexico

From Downtown KENNA, New Mexico

1. Go south on caliche road (only south road out of Kenna) for 10 miles to Amoco and Flag-Redfern Oil Company lease signs.
2. Turn left at sign and go 1 mile east to "Y" in road, take the left side of the fork and continue for  $2\frac{1}{2}$  miles.
3. Cross 3 cattleguards, cross the 3rd cattleguard and turn left. (You are now on Flag-Redfern Oil Company's Hahn Federal lease Section 27).
4. Go  $1\frac{1}{2}$  miles on main travelled road to "T" in road.
5. Turn right and head south  $\frac{1}{2}$  mile to the Amoco-Federal Well #3.