

NO. OF COPIES RECEIVED		
DISTRIBUTION		
SANTA FE		
FILE		
U.S.G.S.		
LAND OFFICE		
OPERATOR		

Form C-101
Revised 1-1-65

5A. Indicate Type of Lease

STATE <input type="checkbox"/>	FEE <input checked="" type="checkbox"/>
--------------------------------	---

5. State Oil & Gas Lease No.

1a. Type of Work				7. Unit Agreement Name			
b. Type of Well DRILL <input checked="" type="checkbox"/> DEEPEN <input type="checkbox"/> PLUG BACK <input type="checkbox"/> OIL WELL <input checked="" type="checkbox"/> GAS WELL <input type="checkbox"/> OTHER <input type="checkbox"/> SINGLE ZONE <input checked="" type="checkbox"/> MULTIPLE ZONE <input type="checkbox"/>				8. Farm or Lease Name			
2. Name of Operator				9. Well No.			
3. Address of Operator				10. Field and Pool, or Wildcat			
4. Location of Well				12. County			
UNIT LETTER <u>E</u> LOCATED <u>1980</u> FEET FROM THE <u>North</u> LINE				Chaves			
AND <u>660'</u> FEET FROM THE <u>West</u> LINE OF SEC. <u>26</u> TWP. <u>7-S</u> RGE. <u>31-E</u> NMPM							
21. Elevations (Show whether DF, RT, etc.)				19. Proposed Depth		19A. Formation	
21A. Kind & Status Plug. Bond				20. Rotary or C.T.			
21B. Drilling Contractor				22. Approx. Date Work will start			

SIZE OF HOLE	SIZE OF CASING	WEIGHT PER FOOT	SETTING DEPTH	SACKS OF CEMENT	EST. TOP
11"	8 5/8"	24# J-55	1610'	750 sk	Circulate
7 7/8"	4 1/2"	9.50# J-55	4100'	250 sk	3200'

Drill 11" hole to 1610'. Run 8 5/8" casing and circulate cement with 550 sk of Halliburton Lt. Wt. with 1 1/4#/sk Flosele & 8#/sk of Salt, followed by 200 sk of Class "C" with 2% CaCl. Drill 7 7/8" hole to approximately 4100'. Run openhole logs. Run 4 1/2" casing to 4100' and cement with 250 sk of 50-50 Class "H" - Pozmix "A" with 2% Gel, 0.75% CFR-2 and 8 lb. salt per sack. Run Correlation Logs and perforate the San Andres Formation. Treat with Acid. Swab to test. Potential well.

Estimated Tops

0 - 400' Native Mud
400' - 3800' Native Mud & Oil
3800' - TD Starch, Oil Emulsion

Rustler Anhydrite - 1605'
Salt - 1636'
Yates - 2036'
Seven Rivers - 2126'

Queen - 2536'
San Andres - 3156'
San Andres PI Zone - 3708'
S. A. Porosity - 3937'

Blowout Preventors: Cameron 10" Series 900 installed on Surface Casing.

IN ABOVE SPACE DESCRIBE PROPOSED PROGRAM: IF PROPOSAL IS TO DEEPEN OR PLUG BACK, GIVE DATA ON PRESENT PRODUCTIVE ZONE AND PROPOSED NEW PRODUCTIVE ZONE. GIVE BLOWOUT PREVENTER PROGRAM, IF ANY.

I hereby certify that the information above is true and complete to the best of my knowledge and belief.

Signed *John Ross* Title Petroleum Engineer Date 6-27-78

(This space for State Use)

APPROVED BY: [Signature]
CONDITIONS OF APPROVAL, IF ANY:

SUPERVISOR DISTRICT 1

DATE JUN 29 1978

**NEW MEXICO OIL CONSERVATION COMMISSION
WELL LOCATION AND ACREAGE DEDICATION PLAT**

Form C-102
Supersedes C-128
Effective 1-1-65

All distances must be from the outer boundaries of the Section.

Operator Flag-Redfern Oil Co.			Lease Southard "26"		Well No. 2
Unit Letter E	Section 26	Township 7-S	Range 31-E	County Chaves	
Actual Footage Location of Well: 660 feet from the West line and 1980 feet from the North line					
Ground Level Elev. 4366	Producing Formation San Andres		Pool Tom-Tom (San Andres)	Dedicated Acreage: 40 Acres	

1. Outline the acreage dedicated to the subject well by colored pencil or hachure marks on the plat below.
2. If more than one lease is dedicated to the well, outline each and identify the ownership thereof (both as to working interest and royalty).
3. If more than one lease of different ownership is dedicated to the well, have the interests of all owners been consolidated by communitization, unitization, force-pooling, etc?

☐ Yes ☐ No If answer is "yes," type of consolidation _____

If answer is "no," list the owners and tract descriptions which have actually been consolidated. (Use reverse side of this form if necessary.) _____

No allowable will be assigned to the well until all interests have been consolidated (by communitization, unitization, forced-pooling, or otherwise) or until a non-standard unit, eliminating such interests, has been approved by the Commission.

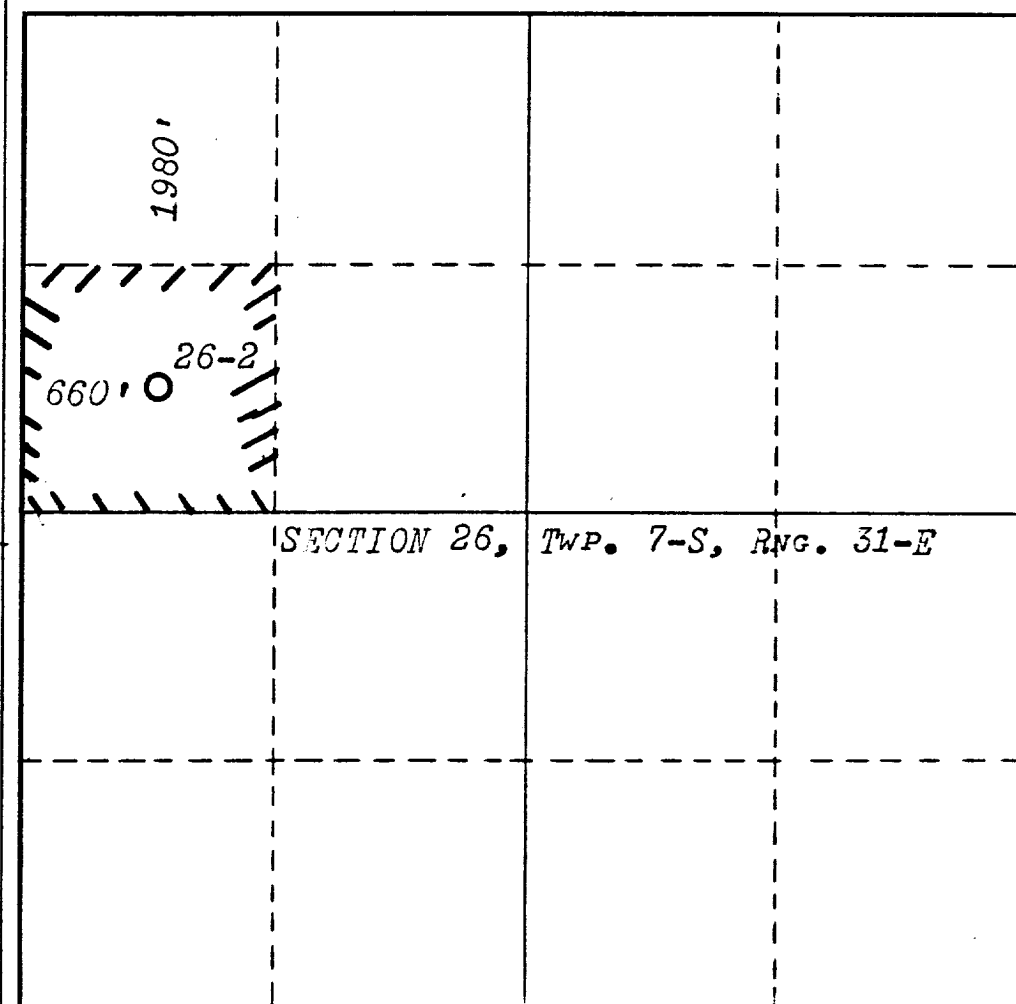

CERTIFICATION

I hereby certify that the information contained herein is true and complete to the best of my knowledge and belief.

Name
Steve Ross
Position
Petroleum Engineer
Company
Flag-Redfern Oil Co.
Date
6-27-78

I hereby certify that the well location shown on this plat was plotted from field notes of actual surveys made by me or under my supervision, and that the same is true and correct to the best of my knowledge and belief.

Date Surveyed
JUNE 26, 1978
Registered Professional Engineer and/or Land Surveyor
[Signature]
Certificate No.
754

0 330 660 990 1320 1650 1980 2310 2640 2970 3300 3630 3960 4290 4620 4950 5280 5610 5940 6270 6600