

NO. OF COPIES RECEIVED	
DISTRIBUTION	
SANTA FE	
FILE	
U.S.G.S.	
LAND OFFICE	
OPERATOR	

NEW MEXICO OIL CONSERVATION COMMISSION

Form C-101
Revised 1-1-69

5A. Indicate Type of Lease	
STATE <input type="checkbox"/>	FEED <input checked="" type="checkbox"/>
5. State Oil & Gas Lease No.	

APPLICATION FOR PERMIT TO DRILL, DEEPEN, OR PLUG BACK

1a. Type of Work		7. Well Approval Name	
b. Type of Well DRILL <input checked="" type="checkbox"/> DEEPEN <input type="checkbox"/> PLUG BACK <input type="checkbox"/> CEN. WELL <input checked="" type="checkbox"/> GAS WELL <input type="checkbox"/> OTHER <input type="checkbox"/> SINGLE ZONE <input checked="" type="checkbox"/> MULTIPLE ZONE <input type="checkbox"/>		8. Name of Lessee Name	
c. Name of Operator El Ran, Inc.		9. Well No. 4	
10. Address of Operator 1603 Broadway, Lubbock, Texas		11. Field and Pool, if known Chaveroo (SA)	
12. Location of Well UNIT LETTER G LOCATED 1650 FEET FROM THE N LINE AND 1980 FEET FROM THE E LINE OF SEC. 3 TWP. 8-S RGT. 32-E		13. County Chaves	
14. Proposed Depth 4350		15A. Formation SA	
16. Kind & Status Fld. Bond Surety Bond 39		17. Drilling Contractor WEK	
18. New Lease (State whether DE, RI, etc.) 4480		19. Approx. Date Work will start 7/15/79	

PROPOSED CASING AND CEMENT PROGRAM

SIZE OF HOLE	SIZE OF CASING	WEIGHT PER FOOT	SETTING DEPTH	SACKS OF CEMENT	EST. TOP
12 3/4	8 5/8	24	1700	600	surface
7 7/8	4 1/2	10.5	4350	200	3500

After surface is set at approximately 1700' a blow out preventor will be installed and tested to 1200# for 30 minutes.

IN ABOVE SPACE DESCRIBE PROPOSED PROGRAM: IF PROPOSAL IS TO DEEPEN OR PLUG BACK, GIVE DATA ON PRESENT PRODUCTIVE ZONE AND PROPOSED NEW PRODUCTIVE ZONE. GIVE BLOWOUT PREVENTER PROGRAM, IF ANY.

I hereby certify that the information above is true and complete to the best of my knowledge and belief.

Signed W. A. Smith Title True Date 6/20/79
(This space for State Use)

APPROVED BY Supervisor SUPERVISOR DISTRICT I DATE JUN 22 1979
CONDITIONS OF APPROVAL, IF ANY:

RECEIVED

JUN 2 1 1979

OIL CONSERVATION COMM.
HOBBES, N. M.

**NEW MEXICO OIL CONSERVATION COMMISSION
WELL LOCATION AND ACREAGE DEDICATION PLAT**

Form C-102
Supersedes C-128
Effective 1-1-65

All distances must be from the outer boundaries of the Section

Operator El Ran Inc.			Lease Roberts			Well No. Roberts No. 4		
Section G	Section 3	Township 8 South	Range 32 East	County Chaves				
Actual Well Location of Well:								
1650 feet from the North line and			1980 feet from the East line					
Ground Elev. 4479.5		Producing Formation SA			Pool Chaveroo (SA)			Dedicated Acreage: 40 Acres

1. Outline the acreage dedicated to the subject well by colored pencil or hatchure marks on the plat below.
2. If more than one lease is dedicated to the well, outline each and identify the ownership thereof (both as to working interest and royalty).
3. If more than one lease of different ownership is dedicated to the well, have the interests of all owners been consolidated by communitization, unitization, force-pooling, etc?

☒ Yes ☐ No If answer is "yes," type of consolidation Communitization

If answer is "no," list the owners and tract descriptions which have actually been consolidated. (Use reverse side of this form if necessary.) _____

No allowable will be assigned to the well until all interests have been consolidated (by communitization, unitization, forced-pooling, or otherwise) or until a non-standard unit, eliminating such interests, has been approved by the Commission.

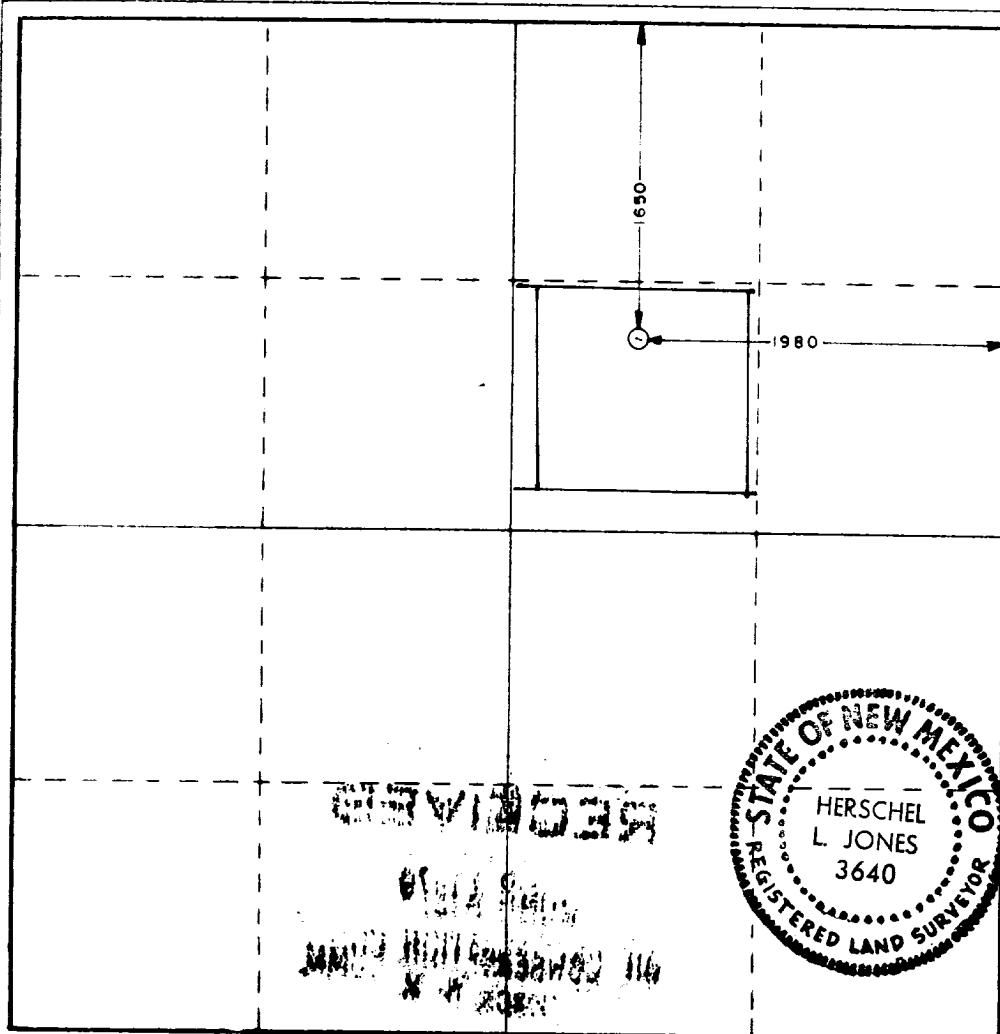

CERTIFICATION

I hereby certify that the information contained herein is true and complete to the best of my knowledge and belief.

[Signature]
Name **President**

Position
El Ran, Inc.

Company
June 20, 1979

Date

I hereby certify that the well location shown on this plat was plotted from field notes of actual surveys made by me or under my supervision, and that the same is true and correct to the best of my knowledge and belief.

6/13/79

Date Surveyed

Registered Professional Engineer and/or Land Surveyor

[Signature]
Certificate No.
3640

0 330 660 990 1320 1650 1980 2310 2640 2970 3300 3630 3960 4290 4620 4950 5280 5610 5940 6270 6600

113

RECEIVED

JUN 21 1979

OIL CONSERVATION COMM.
HONOLULU, H. I.