

STATE OF NEW MEXICO
ENERGY AND MINERALS DEPARTMENT

OIL CONSERVATION DIVISION

P. O. BOX 2088
SANTA FE, NEW MEXICO 87501

Form C-103
Revised 10-1-78

NO. OF COPIES RECEIVED	
DISTRIBUTION	
SANTA FE	
FILE	
U.S.O.S.	
LAND OFFICE	
OPERATOR	

5a. Indicate Type of Lease State <input checked="" type="checkbox"/> Fee <input type="checkbox"/>
5. State Oil & Gas Lease No. LG-1348

SUNDRY NOTICES AND REPORTS ON WELLS

(DO NOT USE THIS FORM FOR PROPOSALS TO DRILL OR TO DEEPLN OR PLUG BACK TO A DIFFERENT RESERVOIR. USE "APPLICATION FOR PERMIT -" (FORM C-101) FOR SUCH PROPOSALS.)

OIL WELL <input checked="" type="checkbox"/> GAS WELL <input type="checkbox"/> OTHER- <input type="checkbox"/>	7. Unit Agreement Name
1. Name of Operator Yates Petroleum Corporation	8. Farm or Lease Name Cola ADO State Com
2. Address of Operator 207 South Fourth Street - Artesia, NM 88210	9. Well No. 1
3. Location of Well UNIT LETTER <u>F</u> <u>1980</u> FEET FROM THE <u>North</u> LINE AND <u>1980</u> FEET FROM THE <u>West</u> LINE, SECTION <u>31</u> TOWNSHIP <u>8S</u> RANGE <u>33E</u> NMPM.	10. Field and Pool, or Wildcat Bar-U Penn
15. Elevation (Show whether DF, RT, GR, etc.) 4390.9' GR	12. County Chaves

Check Appropriate Box To Indicate Nature of Notice, Report or Other Data

NOTICE OF INTENTION TO:

SUBSEQUENT REPORT OF:

PERFORM REMEDIAL WORK <input type="checkbox"/>	PLUG AND ABANDON <input type="checkbox"/>	REMEDIAL WORK <input type="checkbox"/>	ALTERING CASING <input type="checkbox"/>
TEMPORARILY ABANDON <input type="checkbox"/>	CHANGE PLANS <input type="checkbox"/>	COMMENCE DRILLING OPNS. <input type="checkbox"/>	PLUG AND ABANDONMENT <input type="checkbox"/>
PULL OR ALTEN CASING <input type="checkbox"/>	OTHER <u>Yates Petroleum Corp's intentions</u> <input checked="" type="checkbox"/>	CASING TEST AND CEMENT JOBS <input type="checkbox"/>	OTHER <input type="checkbox"/>

17. Describe Proposed or Completed Operations (Clearly state all pertinent details, and give pertinent dates, including estimated date of starting any proposed work) SEE RULE 1103.

Change of ownership will be effective on November 26, 1985.

Yates Petroleum Corporation will put well back into operation and stimulate if needed for production.

This well was originally drilled and completed by Cola Petroleum, Inc. as their Lario State Com #1. Total depth was reached on 11-2-79 and was completed on 12-21-79.

18. I hereby certify that the information above is true and complete to the best of my knowledge and belief.

SIGNED <u>Clifton R. May</u>	TITLE <u>Regulatory Agent</u>	DATE <u>Nov. 20, 1985</u>
APPROVED BY <u>Eddie W. L...</u>	TITLE <u>OIL & GAS INSPECTOR</u>	DATE <u>NOV 22 1985</u>
CONDITIONS OF APPROVAL, IF ANY:		

RECEIVED

NOV 21 1985

O.C.D.
HOBBES OFFICE

IL CONSERVATION DIVISION

STATE OF NEW MEXICO
ENERGY AND MINERALS DEPARTMENT

P. O. BOX 2088
SANTA FE, NEW MEXICO 87501

Form C-102
Revised 10-1-79

All distances must be from the outer boundaries of the Section.

Operator YATES PETROLEUM CORPORATION			Lense COLA "ADO" STATE COM		Well No. 1
Unit Letter F	Section 31	Township 8S	Range 33E	County Chaves	
Actual Footage Location of Well:					
1980 feet from the North line and		1980 feet from the West line			
Ground Level Elev. 4390.9'	Producing Formation BOUGH "C"	Pool BAR-U PENN	Dedicated Acreage: 160 Acres		

1. Outline the acreage dedicated to the subject well by colored pencil or hatchure marks on the plat below.
2. If more than one lease is dedicated to the well, outline each and identify the ownership thereof (both as to working interest and royalty).
3. If more than one lease of different ownership is dedicated to the well, have the interests of all owners been consolidated by communitization, unitization, force-pooling, etc?

☐ Yes ☐ No If answer is "yes," type of consolidation _____

If answer is "no," list the owners and tract descriptions which have actually been consolidated. (Use reverse side of this form if necessary.) _____

No allowable will be assigned to the well until all interests have been consolidated (by communitization, unitization, forced-pooling, or otherwise) or until a non-standard unit, eliminating such interests, has been approved by the Division.

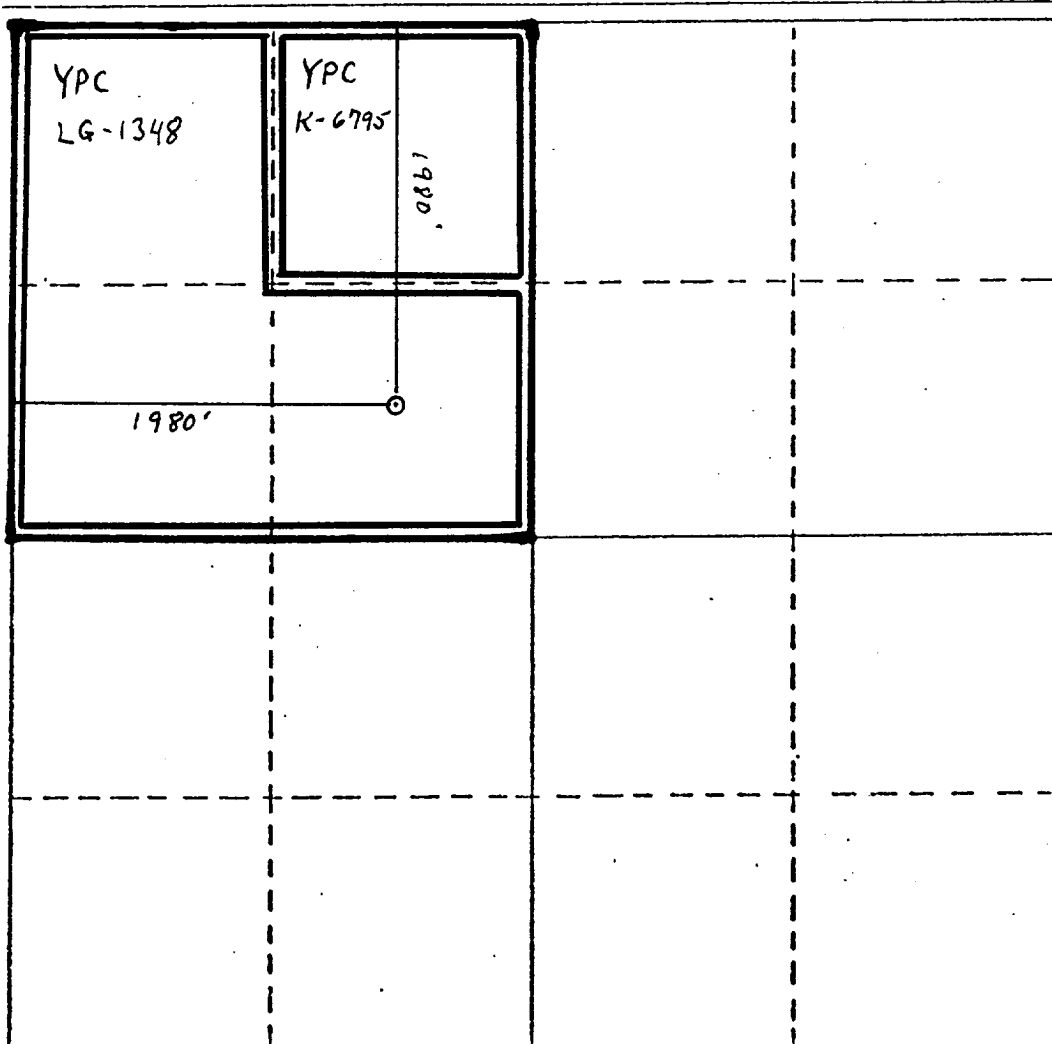

CERTIFICATION

I hereby certify that the information contained herein is true and complete to the best of my knowledge and belief.

Clifton R. May

Name

Clifton R. May

Position

Regulatory Agent

Company

Yates Petroleum Corporation

Date

November 20, 1985

I hereby certify that the well location shown on this plat was plotted from field notes of actual surveys made by me or under my supervision, and that the same is true and correct to the best of my knowledge and belief.

REFER TO ORIGINAL PLAT

Date Surveyed

Registered Professional Engineer
and/or Land Surveyor

Certificate No.

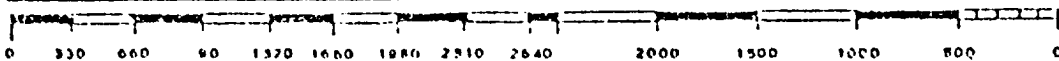

RECEIVED

NOV 21 1985

O.C.D.
HOBBY OFFICE