

Archaeological Clearance Report
for
Anadarko Production Company

Friend Federal Well No. 1

Prepared

By

Charles A. Aylward
Research Associate

Submitted

By

Dr. J. Loring Haskell
Principal Investigator
New Mexico Archaeological Services, Inc.
Carlsbad, New Mexico

9 November 1979

Permit No. 79-NM-166

Introduction

On 8 November 1979, New Mexico Archaeological Services, Inc., (NMAS), Carlsbad, undertook for Anadarko Production Company, Loco Hills, an archaeological reconnaissance of federal lands administered by the Bureau of Land Management in Chaves County, New Mexico. Reconnoitered areas will be impacted by the construction of a drill location and associated access road. This project was advanced by Mr. Jerry Buckles, Area Supervisor, Anadarko Production Company, and administered by Dr. J. Loring Haskell, Principal Investigator, NMAS, Inc. This reconnaissance was undertaken by Mr. Charles A. Aylward, Research Associate, NMAS.

Survey Technique

For this investigation, Anadarko Production Company's proposed location was reconnoitered for evidence of man's past activities by walking it in a series of 20 ft wide, close interval (15° or less), zigzag transects. In addition, an added zone embracing 20 ft on each side of the staked 400 X 400 ft location, and hence lying outside the bounds of the proposed work area, was reconnoitered by a similar means as was the access road. Methodologically, this procedure served to promote optimal conditions for the visual examination of areas to be impacted by construction-related activities.

Friend Federal Well No. 1

Location

The proposed location will measure 400 X 400 ft on federal lands and will be situated 1980 ft from the north line and 660 ft from the west line of:

Section 21, T13S, R31E, NMPM, Chaves County, NM

Thus it will be situated in the:

SW $\frac{1}{4}$ NW $\frac{1}{4}$, Section 21, T13S, R31E, NMPM, Chaves County, NM

The associated access road will measure 20 X 6410 ft and will be situated in the:

SE $\frac{1}{4}$ NE $\frac{1}{4}$, Section 20, T13S, R31E, NMPM, Chaves County, NM
 SW $\frac{1}{4}$ SW $\frac{1}{4}$, Section 20, T13S, R31E, NMPM, Chaves County, NM
 SE $\frac{1}{4}$ SW $\frac{1}{4}$, Section 20, T13S, R31E, NMPM, Chaves County, NM
 SW $\frac{1}{4}$ SE $\frac{1}{4}$, Section 20, T13S, R31E, NMPM, Chaves County, NM
 NE $\frac{1}{4}$ SE $\frac{1}{4}$, Section 20, T13S, R31E, NMPM, Chaves County, NM
 SW $\frac{1}{4}$ NW $\frac{1}{4}$, Section 21, T13S, R31E, NMPM, Chaves County, NM
 NW $\frac{1}{4}$ SW $\frac{1}{4}$, Section 21, T13S, R31E, NMPM, Chaves County, NM

Map Reference: USGS CAUDILL RANCH QUADRANGLE, 7.5 Minute Series, 1973.

Terrain

The proposed location is situated on an undulating plain which is overlain by deep aeolian deposits. Mescalero Ridge ("The Caprock") is a prominent feature along the eastern horizon. The coeval surface is demarcated by coppice dunes to as much as 2 m in height, low hummocky terrain, and occasional small swale-like features. Associated deflated areas range from shallow, elliptical basins to forming interconnecting floors. Localized areas are subject to sheetwash, puddling and gullying. Soils are loose sandy loams and loamy sands and occasionally contain lap deposits of chert, quartz, quartzite, and caliche cobbles and gravels. Peds are intergrades of the Typic Torripsamment subgroup.

Floristics

The local floral overstory is predominantly Prosopis juliflora with associated Quercus havardii, Yucca glauca, and

Artemisia filifolia. Forbs include: Gutierrezia sarothrae, Perezia nana, Eriogonum annuum, Zinnia acerosa, Croton sp., Solanum sp., Euphorbia sp., and Dalea sp. Grasses are represented by Sporobolus spp., Bouteloua hirsuta, Muhlenbergia arenacea, Chloris cucullata, Setaria macrostachya, Cenchrus incertus, Andropogon sp., Aristida sp., and Tridens pulchellus. Several specimens of Opuntia (platyopuntia) sp. are present.

Cultural Resources

During the course of this reconnaissance, burned- and fire-cracked caliche cobbles were noted in the:

SE $\frac{1}{4}$ SW $\frac{1}{4}$ NW $\frac{1}{4}$, Section 21, T13S, R31E, NMPM, Chaves County, NM
 UTM: Zone 13, N3,671,350; E608,820
 Map Reference: USGS CAUDILL RANCH QUADRANGLE, 7.5 Minute Series, 1973.

In addition, a light scatter of burned- and fire-cracked caliche cobbles were observed in the:

SE $\frac{1}{4}$ SW $\frac{1}{4}$ NW $\frac{1}{4}$, Section 21, T13S, R31E, NMPM, Chaves County, NM
 UTM: Zone 13, N3,671,350; E608,880
 Map Reference: USGS CAUDILL RANCH QUADRANGLE, 7.5 Minute Series, 1973.

Recommendations

NMAS recommends clearance for Anadarko Production Company's proposed Friend Federal Well No. 1 and its access road and suggests that work-related activities proceed in accordance with company plans. Final Clearance, of course, is granted by the Bureau of Land Management.

R 31 E

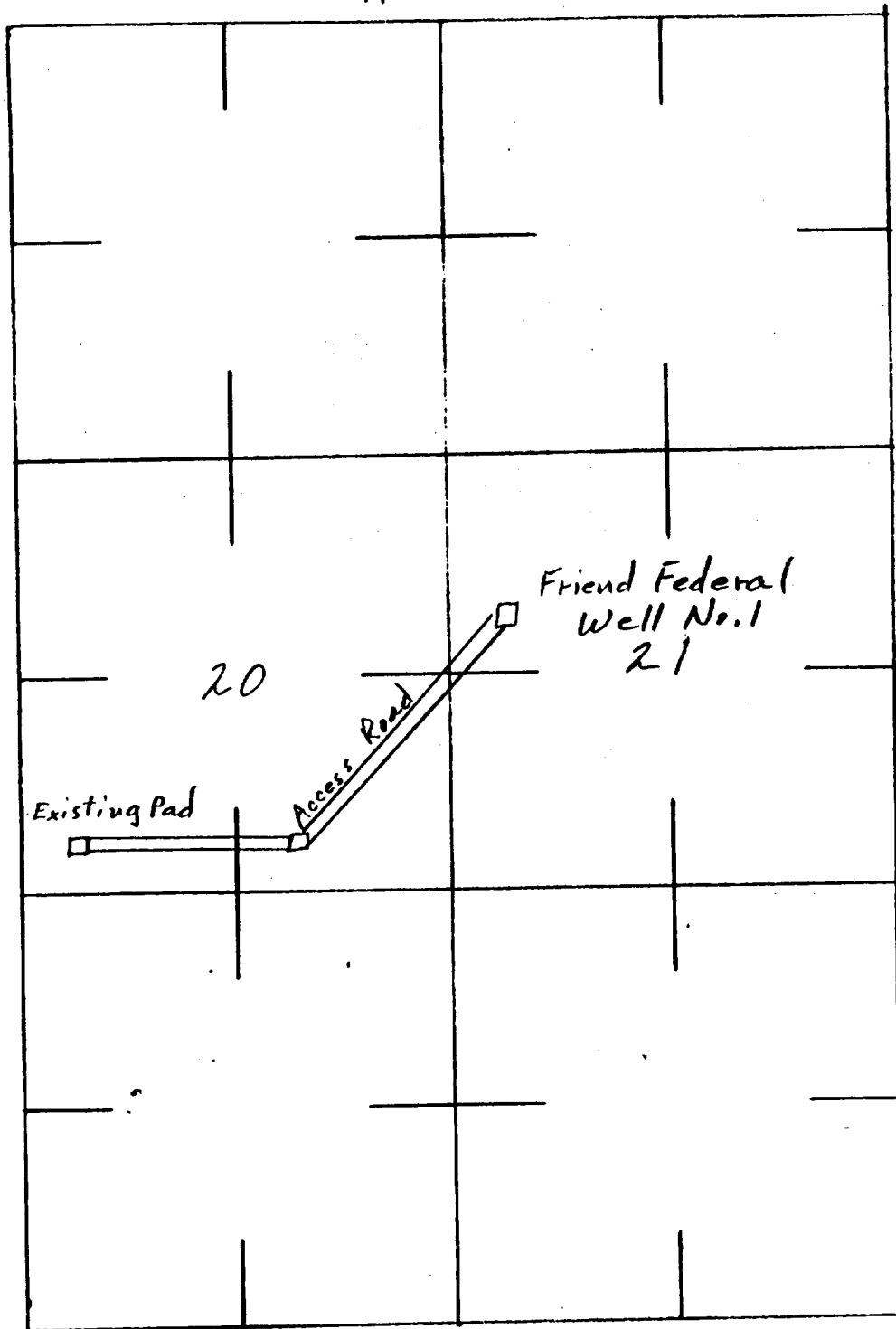

Anadarko Production Co.

