

005  
30-225-20749

NO. OF COPIES RECEIVED		
DISTRIBUTION		
SANTA FE		
FILE		
U.S.G.S.		
LAND OFFICE		
OPERATOR		

NEW MEXICO OIL CONSERVATION COMMISSION

Form C-101  
Revised 1-1-65

5A. Indicate Type of Lease STATE <input checked="" type="checkbox"/> FEE <input type="checkbox"/>
5. State Oil & Gas Lease No. LG 1774
7. Unit Agreement Name
8. Farm or Lease Name Chaveroo State
9. Well No. 6
10. Field and Pool Chaveroo <b>UNDESIGNATED</b>
12. County Chaves
19. Proposed Depth 4400'
19A. Formation San Andres
20. Rotary or C.T. Rotary
21. Elevations (Show whether DF, RT, etc.) 4477.8 Gr.
21A. Kind & Status Plug. Bond Blanket-Current
21B. Drilling Contractor WEK Drlg. Co.
22. Approx. Date Work will start As Soon As Possible

APPLICATION FOR PERMIT TO DRILL, DEEPEN, OR PLUG BACK

1a. Type of Work b. Type of Well OIL WELL <input checked="" type="checkbox"/> GAS WELL <input type="checkbox"/> OTHER <input type="checkbox"/> DRILL <input checked="" type="checkbox"/> DEEPEN <input type="checkbox"/> PLUG BACK <input type="checkbox"/> SINGLE ZONE <input type="checkbox"/> MULTIPLE ZONE <input type="checkbox"/>	2. Name of Operator MWJ Producing Company	3. Address of Operator 1804 First National Bank Building, Midland, Texas 79701	4. Location of Well UNIT LETTER L LOCATED 2310 FEET FROM THE South LINE 330 West 2 8S 32E AND FEET FROM THE LINE OF SEC. TWP. RGE. NMPM		
23. PROPOSED CASING AND CEMENT PROGRAM					
SIZE OF HOLE	SIZE OF CASING	WEIGHT PER FOOT	SETTING DEPTH	SACKS OF CEMENT	EST. TOP
12 1/4"	8 5/8"	24#	1800'	450	Circulate
7 7/8"	4 1/2"	9.5 & 10.5#	4400'	325	3400'

Surface casing will be set at top of the Salt Section with Cement Circulated. Cement for the oil string calculated to reach the base of the Salt Section.

Double Ram BOP to be installed after surface casing is cemented; tested to 3,000 psi. and utilized to TD. Rams to be operated daily. Control valve for drill pipe to be available on floor while drilling below surface casing.

APPROVAL VALID  
FOR 90 DAYS UNLESS  
DRILLING COMMENCED,  
EXPIRES 7/9/80

IN ABOVE SPACE DESCRIBE PROPOSED PROGRAM: IF PROPOSAL IS TO DEEPEN OR PLUG BACK, GIVE DATA ON PRESENT PRODUCTIVE ZONE AND PROPOSED NEW PRODUCTIVE ZONE. GIVE BLOWOUT PREVENTER PROGRAM, IF ANY.

I hereby certify that the information above is true and complete to the best of my knowledge and belief.

Signed H. K. Meek Title Agent Date 7/9/80

(This space for State Use)

APPROVED BY [Signature] TITLE SUPERVISOR DISTRICT I DATE JUL 11 1980  
CONDITIONS OF APPROVAL, IF ANY:

NEW MEXICO OIL CONSERVATION COMMISSION  
WELL LOCATION AND ACREAGE DEDICATION PLAT

Form C-102  
Supersedes C-128  
Effective 1-1-65

All distances must be from the outer boundaries of the Section

Operator <b>MWJ Producing Co.</b>			Lease <b>Chaveroo State</b>		Well No. <b>6</b>
Unit Letter <b>L</b>	Section <b>2</b>	Township <b>8 South</b>	Range <b>32 East</b>	County <b>Chaves</b>	
Actual Footage Location of Well: <b>2310</b> feet from the <b>South</b> line and <b>330</b> feet from the <b>West</b> line					
Ground Level Elev. <b>4477.8</b>	Producing Formation <b>San Andres</b>		Pool <b>Chaveroo</b>	Dedicated Acreage: <b>40</b> Acres	

1. Outline the acreage dedicated to the subject well by colored pencil or hatchure marks on the plat below.
2. If more than one lease is dedicated to the well, outline each and identify the ownership thereof (both as to working interest and royalty).
3. If more than one lease of different ownership is dedicated to the well, have the interests of all owners been consolidated by communitization, unitization, force-pooling, etc?

☐ Yes ☐ No If answer is "yes," type of consolidation \_\_\_\_\_

If answer is "no," list the owners and tract descriptions which have actually been consolidated. (Use reverse side of this form if necessary.) \_\_\_\_\_

No allowable will be assigned to the well until all interests have been consolidated (by communitization, unitization, forced-pooling, or otherwise) or until a non-standard unit, eliminating such interests, has been approved by the Commission.

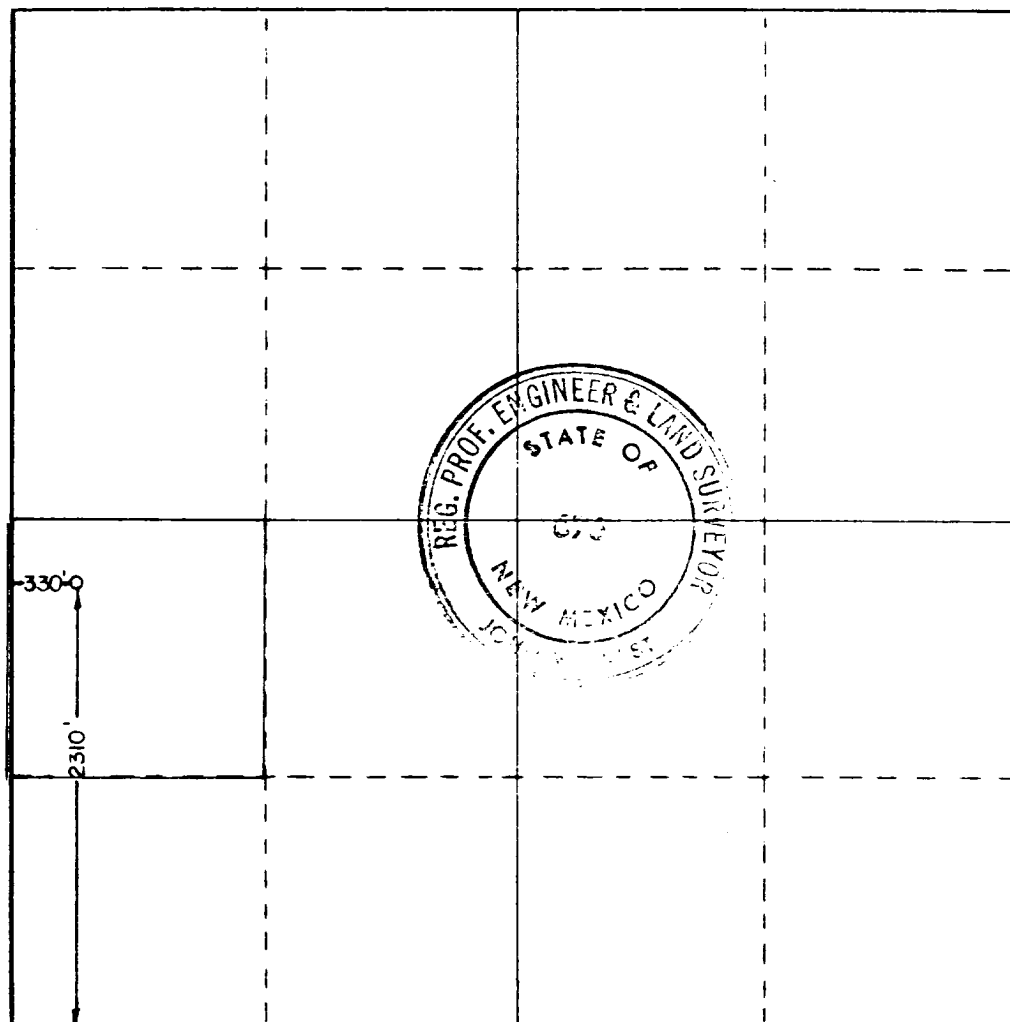

CERTIFICATION

I hereby certify that the information contained herein is true and complete to the best of my knowledge and belief.

*D. R. Meek*

Name  
**D. R. Meek**

Position  
**Agent**

Company  
**MWJ Producing Company**

Date  
**7/9/80**

I hereby certify that the well location shown on this plat was plotted from field notes of actual surveys made by me or under my supervision, and that the same is true and correct to the best of my knowledge and belief.

Date Surveyed  
**June 26, 1980**

Registered Professional Engineer and/or Land Surveyor

*John W. West*

Certificate No. **JOHN W. WEST 676**  
**PATRICK A. ROMERO 6663**