

UNITED STATES  
DEPARTMENT OF THE INTERIOR  
GEOLOGICAL SURVEY

30-005-20766

APPLICATION FOR PERMIT TO DRILL, DEEPEN, OR PLUG BACK

1a. TYPE OF WORK

DRILL ☒

DEEPEN ☐

PLUG BACK ☐

b. TYPE OF WELL

OIL WELL ☒

GAS WELL ☐

OTHER

SINGLE ZONE ☒

MULTIPLE ZONE ☐

2. NAME OF OPERATOR

El Ran, Inc.

3. ADDRESS OF OPERATOR

1603 Broadway, Lubbock, Texas 79401

4. LOCATION OF WELL (Report location clearly and in accordance with any State requirements.)

At surface

990' FWL & 990' FSL

At proposed prod. zone

14. DISTANCE IN MILES AND DIRECTION FROM NEAREST TOWN OR POST OFFICE

20.4 miles south of Elida, New Mexico

U. S. GEOLOGICAL SURVEY  
HOBBS, NEW MEXICO

15. DISTANCE FROM PROPOSED\* LOCATION TO NEAREST PROPERTY OR LEASE LINE, FT.  
(Also to nearest drlg. unit line, if any)

330

16. NO. OF ACRES IN LEASE

160

17. NO. OF ACRES ASSIGNED TO THIS WELL

40

18. DISTANCE FROM PROPOSED LOCATION\* TO NEAREST WELL, DRILLING, COMPLETED, OR APPLIED FOR, ON THIS LEASE, FT.

1750

19. PROPOSED DEPTH

4400

20. ROTARY OR CABLE TOOLS

Rotary

21. ELEVATIONS (Show whether DF, RT, GR, etc.)

4491.4 GR.

22. APPROX. DATE WORK WILL START\*

10-15-80

23. PROPOSED CASING AND CEMENTING PROGRAM

SIZE OF HOLE	SIZE OF CASING	WEIGHT PER FOOT	SETTING DEPTH	QUANTITY OF CEMENT
12 7/8	8 5/8	23#	1700	575 - Circulate to Surface
7 7/8	4 1/2	10.5#	4400	200

Mud Program: Native to 4000'  
10# Mud, 35 Viscosity 4000' to T.D.

BOP Program: See Exhibits C, D, & E

DRILLING OPERATIONS AUTHORIZED ARE  
SUBJECT TO COMPLIANCE WITH ATTACHED  
"GENERAL REQUIREMENTS"

IN ABOVE SPACE DESCRIBE PROPOSED PROGRAM: If proposal is to deepen or plug back, give data on present productive zone and proposed new productive zone. If proposal is to drill or deepen directionally, give pertinent data on subsurface locations and measured and true vertical depths. Give blowout preventer program, if any.

24.

SIGNED

Robert R. Ranch

TITLE

Vice-President

DATE

July 23, 1980

(This space for Federal or State office use)

PERMIT NO.

APPROVAL DATE

APPROVED BY

TITLE

DATE

CONDITIONS OF APPROVAL, IF ANY:

## Instructions

General: This form is designed for submitting proposals to perform certain well operations, as indicated, on all types of lands and leases for appropriate action by either a Federal or a State agency, or both, pursuant to applicable Federal and/or State laws and regulations. Any necessary special instructions concerning the use of this form and the number of copies to be submitted, particularly with regard to local, area, or regional procedures and practices, either are shown below or will be issued by, or may be obtained from, the local Federal and/or State office.

Item 1: If the proposal is to redrill to the same reservoir at a different subsurface location or to a new reservoir, use this form with appropriate notations. Consult applicable State or Federal regulations concerning subsequent work proposals or reports on the well.

Item 2: If there are no applicable State requirements, locations on Federal or Indian land should be described in accordance with Federal requirements. Consult local State or Federal office for specific instructions.

Item 3: Needed only when location of well cannot readily be found by road from the land or lease description. A plat, or plat, separate or on this reverse side, showing the roads to, and the surveyed location of, the well, and any other required information, should be furnished when required by Federal or State agency offices.

Items 15 and 18: If well is to be, or has been directionally drilled, give distances for subsurface location of hole in any present or objective production zone.

Item 22: Consult applicable Federal or State regulations, or appropriate officials, concerning approval of the proposal before operations are started.

☆ U.S. GOVERNMENT PRINTING OFFICE : 1963-O-711-366

RECEIVED

SEP 30 1980

OIL CONSERVATION DIV.

U.S. GEOLOGICAL SURVEY  
HOUSTON, TEXAS 77050

RECEIVED  
OIL CONSERVATION DIV.  
SEP 30 1980

**N MEXICO OIL CONSERVATION COMMISSION**  
**WELL LOCATION AND ACREAGE DEDICATION PLAT**

Form C-102  
 Supersedes C-128  
 Effective 1-1-65

All distances must be from the outer boundaries of the Section.

Operator <b>EL RAN, INC.</b>			Lessee <b>Federal</b>		Well No. <b>7</b>
Unit Letter <b>M</b>	Section <b>3</b>	Township <b>8 South</b>	Range <b>32 East</b>	County <b>Chaves</b>	
Actual Footage Location of Well: <b>990</b> feet from the <b>West</b> line and <b>990</b> feet from the <b>South</b> line					
Ground Level Elev. <b>4491.4</b>	Producing Formation <b>San Andres</b>		Pool <b>Chaveroo</b>	Dedicated Acreage: <b>40</b> Acres	

1. Outline the acreage dedicated to the subject well by colored pencil or hachure marks on the plat below.
2. If more than one lease is dedicated to the well, outline each and identify the ownership thereof (both as to working interest and royalty).
3. If more than one lease of different ownership is dedicated to the well, have the interests of all owners been consolidated by communitization, unitization, force-pooling, etc?

☐ Yes ☐ No If answer is "yes," type of consolidation \_\_\_\_\_

If answer is "no," list the owners and tract descriptions which have actually been consolidated. (Use reverse side of this form if necessary.) \_\_\_\_\_

No allowable will be assigned to the well until all interests have been consolidated (by communitization, unitization, forced-pooling, or otherwise) or until a non-standard unit, eliminating such interests, has been approved by the Commission.

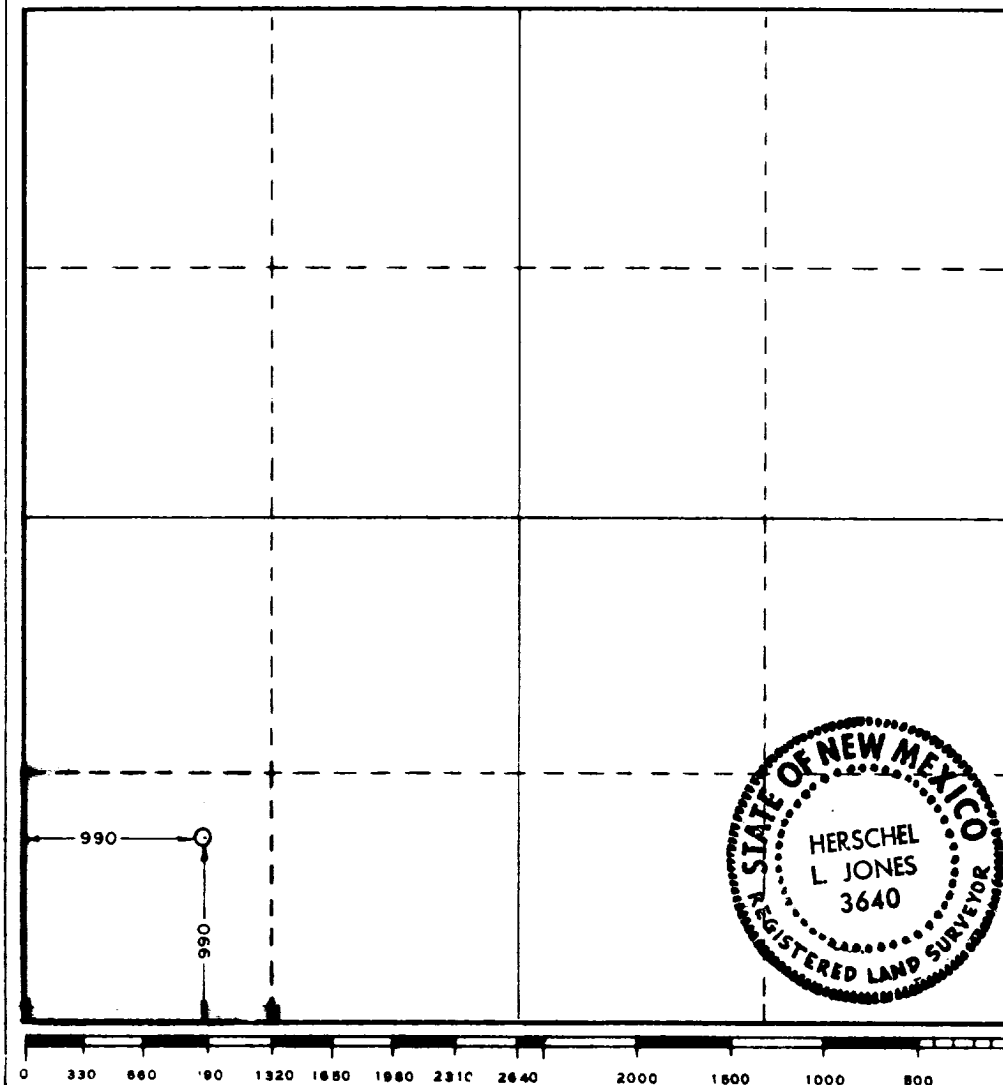

**CERTIFICATION**

I hereby certify that the information contained herein is true and complete to the best of my knowledge and belief.

*Robert R. Ranck*

Name  
**Robert R. Ranck**

Position  
**Vice-President**

Company  
**El Ran, Inc.**

Date  
**July 23, 1980**

I hereby certify that the well location shown on this plat was plotted from field notes of actual surveys made by me or under my supervision, and that the same is true and correct to the best of my knowledge and belief.

Date Surveyed  
**6-19-80**

Registered Professional Engineer and/or Land Surveyor

*Herschel L. Jones*

Certificate No.

**3640**

APPLICATION FOR DRILLING

EL RAN, INC.  
FEDERAL #7  
SECTION 3, T8S, R32E  
Chaves County, New Mexico

In Conjunction with Form 9-331 C, Application for Permit to Drill subject well, El Ran, Inc. submits the following ten items of pertinent information.

1. The geologic surface formation is the Ogallala formation.
2. The estimated tops of geologic markers are as follows:

Yates	2380'
San Andres	3058'
3. The depths at which anticipated water, oil or gas formations are expected to be encountered:

Water:	No data available. Probably from Triassic formation at		
	approximately	to	feet.
Oil or Gas:	San Andres at approximately	feet to	feet.
4. Proposed casing program: See Form 9-331 C.
5. Pressure control equipment: See Exhibits C, D, and E.
6. Mud Program: See Form 9-331 C.
7. Auxiliary equipment: See Exhibit D.
8. Testing, logging and coring programs: None.
9. No abnormal temperatures or pressures are anticipated.
10. Anticipated starting date:  
Anticipated completion of drilling operations: Approximately 7 days after starting date.