

30-005-20770

NO. OF COPIES RECEIVED	
DISTRIBUTION	
SANTA FE	
FILE	
U.S.G.S.	
LAND OFFICE	
OPERATOR	

NEW MEXICO OIL CONSERVATION COMMISSION

Form C-101
Revised 1-1-85

5A. Indicate Type of Lease
 STATE FEE
 5. State Oil & Gas Lease No.

APPLICATION FOR PERMIT TO DRILL, DEEPEN, OR PLUG BACK

1a. Type of Work
 b. Type of Well DRILL DEEPEN PLUG BACK
 OIL WELL GAS WELL OTHER SINGLE ZONE MULTIPLE ZONE
 2. Name of Operator
Armstrong Energy Corporation
 3. Address of Operator
P.O. Box 1642, Roswell, New Mexico 88201
 4. Location of Well UNIT LETTER J LOCATED 1980 FEET FROM THE South LINE
 AND 1980 FEET FROM THE East LINE OF SEC. 3 TWP. 11S RGE. 31E NMPM
 7. Well Agreement Name
 8. Farm or Lease Name
Sara
 9. Well No.
#1
 10. Field and Pool, or Wildcat
Wildcat
San Andres
 17. County
Chaves
 18. Proposed Depth
4,250'
 19A. Formation
San Andres
 20. Rotary or C.T.
Rotary
 21. Elevations (Show whether DT, KI, etc.)
4,506.3 GL
 21A. Kind & Status Plug. Bond
\$5,000-One well
 21B. Drilling Contractor
WEK
 22. Approx. Date Work will start
December 1, 1980

PROPOSED CASING AND CEMENT PROGRAM

SIZE OF HOLE	SIZE OF CASING	WEIGHT PER FOOT	SETTING DEPTH	SACKS OF CEMENT	EST. TOP
12 1/2	8-5/8	24#	1,600	750	Circulate
7-7/8	4-1/2	10.5#	4,250	450	3,650

Mud Program - 0-4000' - Fresh water with mud and LCM as needed.
 4000-4,250 - Mud up with 32-34 Viscosity.
 BOP Program - No BOP Necessary.

APPROVAL VALID
 FOR 90 DAYS UNLESS
 DRILLING COMMENCED,

EXPIRES 2/19/81

IN ABOVE SPACE DESCRIBE PROPOSED PROGRAM: IF PROPOSAL IS TO DEEPEN OR PLUG BACK, GIVE DATA ON PRESENT PRODUCTIVE ZONE AND PROPOSED NEW PRODUCTIVE ZONE. GIVE BLOWOUT PREVENTER PROGRAM, IF ANY.

I hereby certify that the information above is true and complete to the best of my knowledge and belief.

Signed [Signature] Title President Date October 20, 1980

(This space for State Use)

APPROVED BY [Signature] TITLE SUPERVISOR DISTRICT DATE NOV 19 1980

CONDITIONS OF APPROVAL, IF ANY:

NEW MEXICO OIL CONSERVATION COMMISSION
WELL LOCATION AND ACREAGE DEDICATION PLAT

Form C-102
Supersedes C-128
Effective 1-1-65

All distances must be from the outer boundaries of the Section.

Operator Armstrong Energy Corp.			Lease Sara		Well No. 1
Unit Letter J	Section 3	Township 11 South	Range 31 East	County Chaves	
Actual Footage Location of Well: 1980 feet from the South line and 1980 feet from the East line					
Ground Level Elev. 4506.3	Producing Formation San Andres		Pool <i>Wildcat Lower San Andres</i>	Dedicated Acreage: 40 Acres	

1. Outline the acreage dedicated to the subject well by colored pencil or hachure marks on the plat below.
2. If more than one lease is dedicated to the well, outline each and identify the ownership thereof (both as to working interest and royalty).
3. If more than one lease of different ownership is dedicated to the well, have the interests of all owners been consolidated by communitization, unitization, force-pooling, etc?

Yes No If answer is "yes," type of consolidation _____

If answer is "no," list the owners and tract descriptions which have actually been consolidated. (Use reverse side of this form if necessary.) _____

No allowable will be assigned to the well until all interests have been consolidated (by communitization, unitization, forced-pooling, or otherwise) or until a non-standard unit, eliminating such interests, has been approved by the Commission.

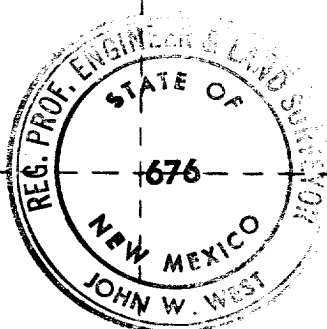
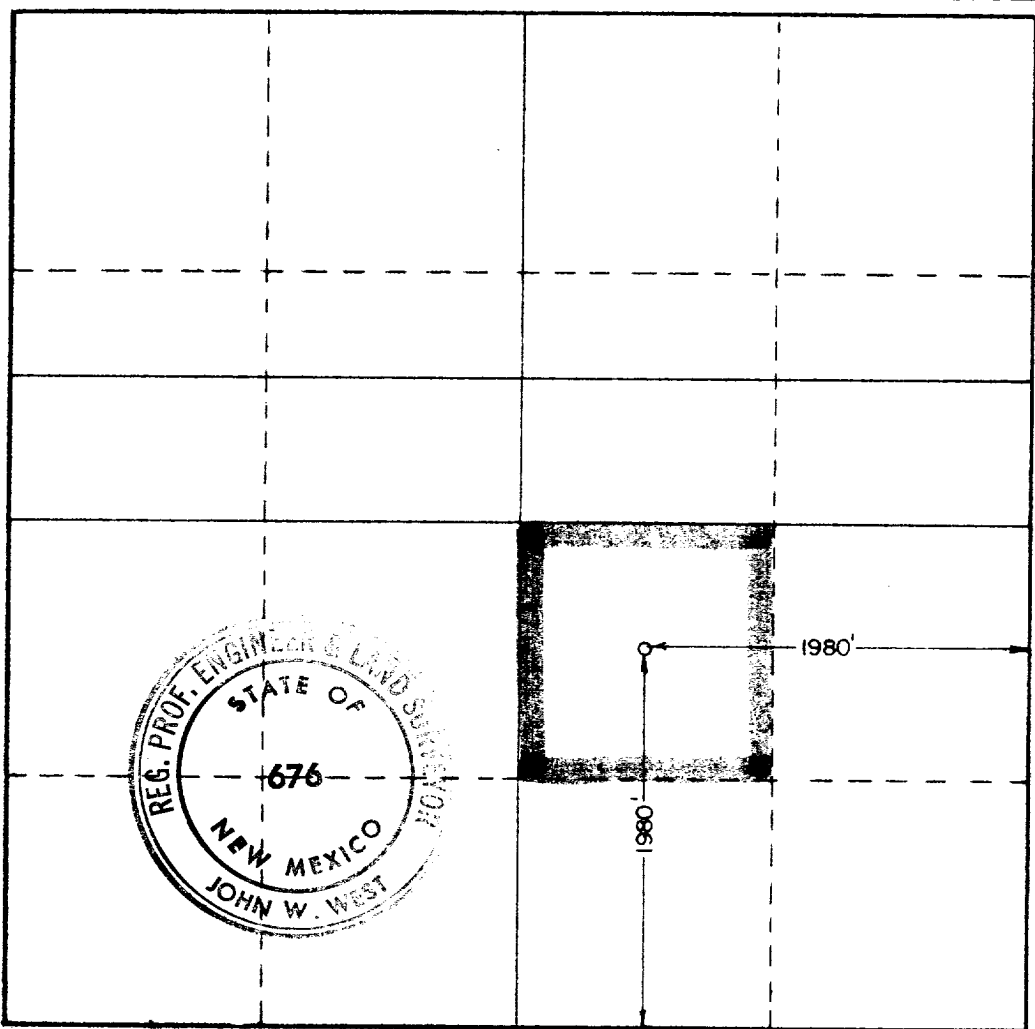

CERTIFICATION

I hereby certify that the information contained herein is true and complete to the best of my knowledge and belief.

Robert G. Armstrong

Name
Robert G. Armstrong

Position
President

Company
Armstrong Energy Corp.

Date
October 20, 1980

I hereby certify that the well location shown on this plat was plotted from field notes of actual surveys made by me or under my supervision, and that the same is true and correct to the best of my knowledge and belief.

Date Surveyed
September 27, 1978

Registered Professional Engineer and/or Land Surveyor

John W. West

Certificate No. **JOHN W. WEST 676**
PATRICK A. ROMERO 668
Ronald J. Eidson 3239

RECEIVED
OCT 29 1980
OIL CONSERVATION DIV

ELF