

UNITED STATES
DEPARTMENT OF THE INTERIOR
GEOLOGICAL SURVEY

APPLICATION FOR PERMIT TO DRILL, DEEPEN, OR PLUG BACK

1a. TYPE OF WORK

DRILL ☒DEEPEN ☐PLUG BACK ☐

b. TYPE OF WELL

OIL
WELL ☒GAS
WELL ☐

OTHER

SINGLE
ZONE ☐MULTIPLE
ZONE ☐

2. NAME OF OPERATOR

SUNDANCE OIL COMPANY

3. ADDRESS OF OPERATOR

Suite 910, 1776 Lincoln St., Denver, CO 80203

4. LOCATION OF WELL (Report location clearly and in accordance with any State requirements.)*

At surface

660' FSL, 1980' FWL, Unit N

At proposed prod. zone

Same

14. DISTANCE IN MILES AND DIRECTION FROM NEAREST TOWN OR POST OFFICE*

15 miles south of Kenna

15. DISTANCE FROM PROPOSED*

LOCATION TO NEAREST
PROPERTY OR LEASE LINE, FT.
(Also to nearest drlg. unit line, if any)

660

16. NO. OF ACRES IN LEASE

1401.68

18. DISTANCE FROM PROPOSED LOCATION*
TO NEAREST WELL, DRILLING, COMPLETED,
OR APPLIED FOR, ON THIS LEASE, FT.

1320

19. PROPOSED DEPTH

4100

17. NO. OF ACRES ASSIGNED
TO THIS WELL

40

20. ROTARY OR CABLE TOOLS

Rotary

21. ELEVATIONS (Show whether DF, RT, GR, etc.)

4226.4' GL

22. APPROX. DATE WORK WILL START*

January 1, 1981

PROPOSED CASING AND CEMENTING PROGRAM

SIZE OF HOLE	SIZE OF CASING	WEIGHT PER FOOT	SETTING DEPTH	QUANTITY OF CEMENT
12 1/4"	8 5/8"	24	1350'	550 sx, circulated
7 7/8"	4 1/2"	10.5	4100'	300 sx

The well will be drilled, logged and evaluated by drill stem tests for full evaluation of the San Andres Formation. If warranted, completion will be made in the same formation.

RECEIVED

DEC 4 1980

U.S. GEOLOGICAL SURVEY
ARTESIA, NEW MEXICO

IN ABOVE SPACE DESCRIBE PROPOSED PROGRAM: If proposal is to deepen or plug back, give data on present productive zone and proposed new productive zone. If proposal is to drill or deepen directionally, give pertinent data on subsurface locations and measured and true vertical depths. Give blowout preventer program if any.

24.

SIGNED

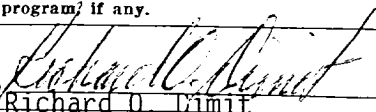

TITLE Vice President, Production DATE Dec. 1, 1980

(This space for Federal or State office use)

PERMIT NO.

APPROVAL DATE

Orig. 831 GEORGE H. STEWART

ACTING DISTRICT ENGINEER

APPROVED BY

TITLE

DATE

JAN 22 1981

CONDITIONS OF APPROVAL, IF ANY:

NEW MEXICO OIL CONSERVATION COMMISSION
WELL LOCATION AND ACREAGE DEDICATION PLAT

Form C-102
Supersedes C-128
Effective 1-1-65

All distances must be from the outer boundaries of the Section

Operator Sundance Oil Co.			Lease Ingram		Well No. 16
Unit Letter N	Section 5	Township 8 South	Range 31 East	County Chaves	
Actual Footage Location of Well: 660 feet from the South line and 1980 feet from the West line					
Ground Level Elev. 4226.4	Producing Formation San Andres		Pool Tom-Tom	Dedicated Acreage: 40 Acres	

1. Outline the acreage dedicated to the subject well by colored pencil or hatchure marks on the plat below.
2. If more than one lease is dedicated to the well, outline each and identify the ownership thereof (both as to working interest and royalty).
3. If more than one lease of different ownership is dedicated to the well, have the interests of all owners been consolidated by communitization, unitization, force-pooling, etc?

☐ Yes ☐ No If answer is "yes," type of consolidation _____

If answer is "no," list the owners and tract descriptions which have actually been consolidated (reverse side of this form if necessary.) _____

No allowable will be assigned to the well until all interests have been consolidated (by communitization, unitization, forced-pooling, or otherwise) or until a non-standard unit, eliminating such interests, has been approved by the Commission.

RECEIVED

DEC 4 1980

U.S. GEOLOGICAL SURVEY
ARTESIA, NEW MEXICO

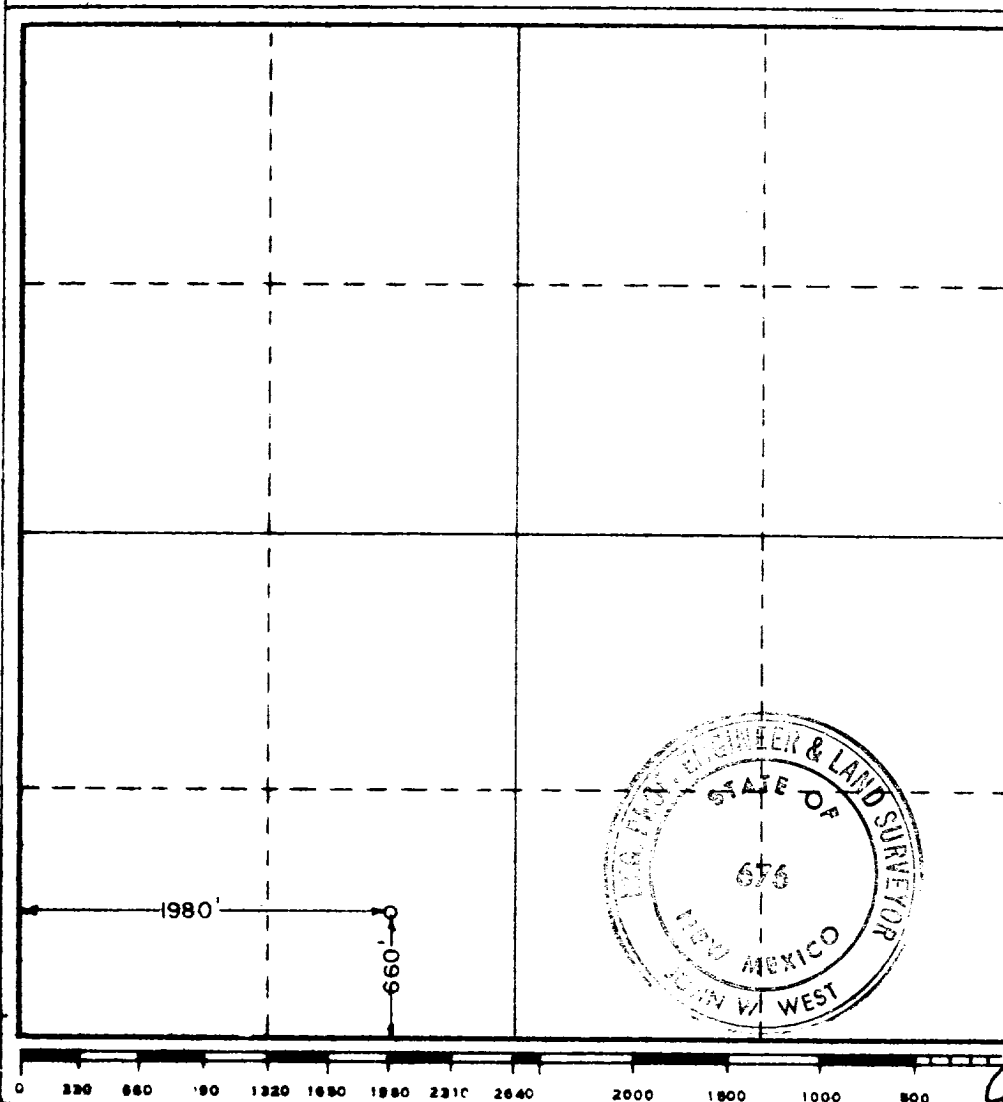

CERTIFICATION

I hereby certify that the information contained herein is true and complete to the best of my knowledge and belief.

Name

Richard O. Dimit

Position

Vice President, Production

Company

Sundance Oil Company

Date

November 26, 1980

I hereby certify that the well location shown on this plat was plotted from field notes of actual surveys made by me or under my supervision, and that the same is true and correct to the best of my knowledge and belief.

Date Surveyed

10-16-80

Registered Professional Engineer and/or Land Surveyor

Certificate No.

JOHN E. WEST 676
PATRICK A. ROMERO 6663
RONALD J. EIDSON 3239

B.O.P. HOOK-UP

Schaeffer Type E 10" Series 900 Hydraulic BOP. (3,000 PSI W.P.)

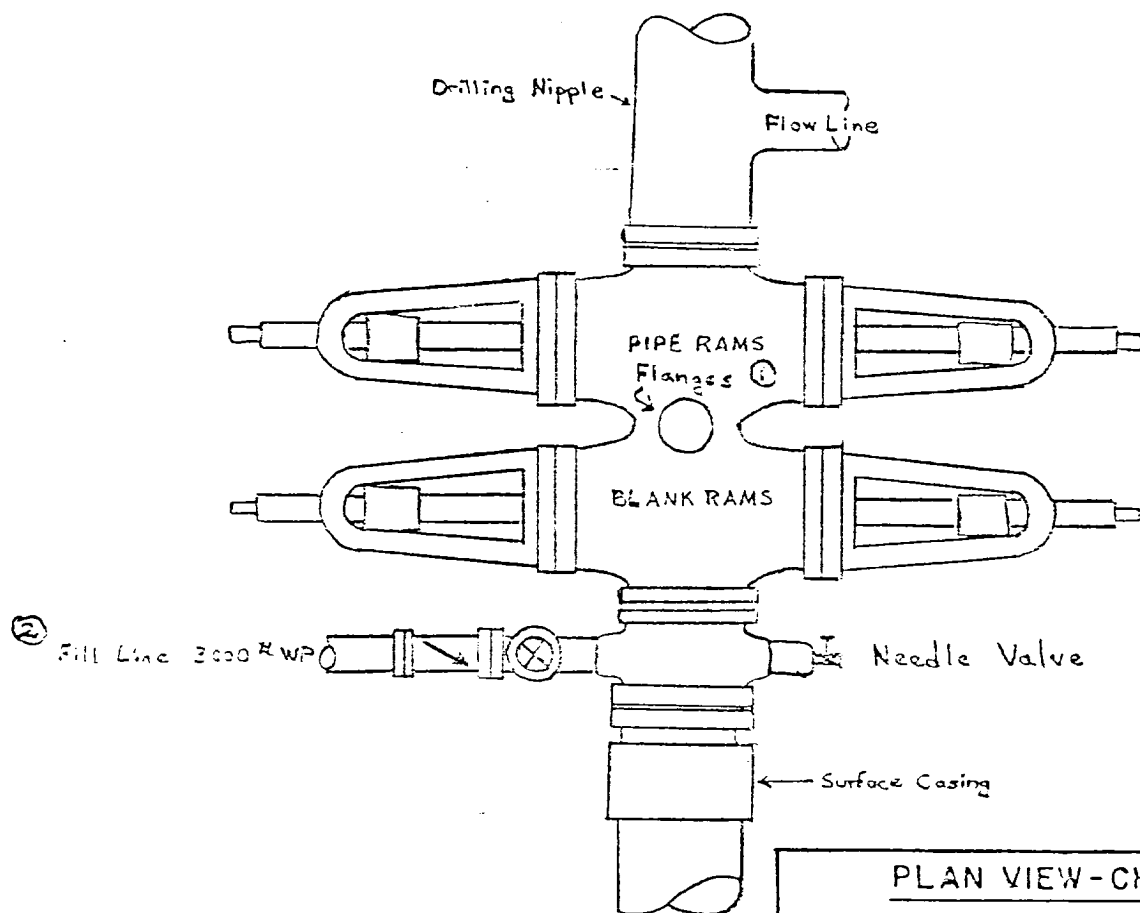

NOTES:

① 1 Flange on each side of BOP Stack. Choke Manifold connects To one side. Other side has full opening pipe and valves connected To it. KILL LINES.

② Fill line also has valve in it at rig floor level.

BOP Stack will be equipped To operate with both hydraulic and manual controls.

All equipment, piping and valves in BOP arrangement is 900 Series, i.e. 3,000 psi working pressure.

PLAN VIEW-CHOKE MANIFOLD

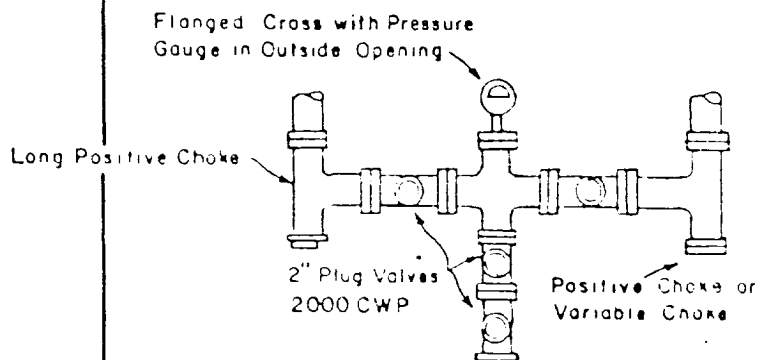

RECEIVED

JAN 28 1931

U. S. DEPARTMENT OF AGRICULTURE

473