

30-005-20788

NEW MEXICO OIL CONSERVATION COMMISSION

Form C-101
Revised 1-1-85

NO. OF COPIES RECEIVED		
DISTRIBUTION		
SANTA FE		
FILE		
U.S.G.S.		
LAND OFFICE		
OPERATOR		

5A. Indicate Type of Lease
 STATE FEE

5. State Oil & Gas Lease No.

APPLICATION FOR PERMIT TO DRILL, DEEPEN, OR PLUG BACK

1a. Type of Work
 b. Type of Well DRILL DEEPEN PLUG BACK
 OIL WELL GAS WELL OTHER SINGLE ZONE MULTIPLE ZONE

7. Unit Agreement Name

8. Farm or Lease Name
Sara

2. Name of Operator
ARMSTRONG ENERGY CORPORATION

9. Well No.
2

3. Address of Operator
P.O. Box 1973, Roswell, New Mexico 88201

10. Field
UNDESIGNATED
Tower-San Andres

4. Location of Well
UNIT LETTER K LOCATED 1980 FEET FROM THE South LINE
AND 1980 FEET FROM THE West LINE OF SEC. 3 TWP. 11S RGE. 31E NMPM

11. Section

12. County
Chaves

11. Section

11. Proposed Depth 4,250' 19A. Formation San Andres 19. Rotary or C.T. Rotary

21. Elevations (Show whether DF, RI, etc.) 4,509.5 GL 21A. Kind & Status Plug. Bond \$5,000-one well 21B. Drilling Contractor unknown 22. Approx. Date Work will start March 15, 1981

PROPOSED CASING AND CEMENT PROGRAM

SIZE OF HOLE	SIZE OF CASING	WEIGHT PER FOOT	SETTING DEPTH	SACKS OF CEMENT	EST. TOP
12 1/4	8-5/8	24#	1,600'	550	circulate
7-7/8	4 1/2"	10.5#	4,250'	450	3,650'

Mud program - 0 to 4,000' - fresh water with mud and LCM as needed
4,000 to 4,250' - mud up with 32-34 vic.

BOP program - no BOP necessary.

APPROVAL VALID FOR 180 DAYS
PERMIT EXPIRES 10/20/81
UNLESS DRILLING UNDERWAY

6. ABOVE SPACE DESCRIBE PROPOSED PROGRAM; IF PROPOSAL IS TO DEEPEN OR PLUG BACK, GIVE DATA ON PRESENT PRODUCTIVE ZONE AND PROPOSED NEW PRODUCTIVE ZONE. GIVE BLOWOUT PREVENTER PROGRAM, IF ANY.

I hereby certify that the information above is true and complete to the best of my knowledge and belief.

Signed Robert Blument Title President Date March 5, 1981

(This space for State Use)

APPROVED BY [Signature] TITLE SUPERVISOR DISTRICT II DATE APR 20 1981

CONDITIONS OF APPROVAL, IF ANY:

NEW MEXICO OIL CONSERVATION COMMISSION
WELL LOCATION AND ACREAGE DEDICATION PLAT

Form C-102
Supersedes C-128
Effective 1-1-65

All distances must be from the outer boundaries of the Section

Operator Armstrong Energy Corp.		Lease Sara			Well No. 2
Unit Letter K	Section 3	Township 11 South	Range 31 East	County Chaves	
Actual Footage Location of Well: 1980 feet from the south line and 1980 feet from the west line					
Ground Level Elev. 4509.5	Producing Formation San Andres		Pool Tower	Dedicated Acreage: 40 Acres	

- Outline the acreage dedicated to the subject well by colored pencil or hachure marks on the plat below.
- If more than one lease is dedicated to the well, outline each and identify the ownership thereof (both as to working interest and royalty).
- If more than one lease of different ownership is dedicated to the well, have the interests of all owners been consolidated by communitization, unitization, force-pooling, etc?

Yes No If answer is "yes," type of consolidation _____

If answer is "no," list the owners and tract descriptions which have actually been consolidated. (Use reverse side of this form if necessary.) _____

No allowable will be assigned to the well until all interests have been consolidated (by communitization, unitization, forced-pooling, or otherwise) or until a non-standard unit, eliminating such interests, has been approved by the Commission.

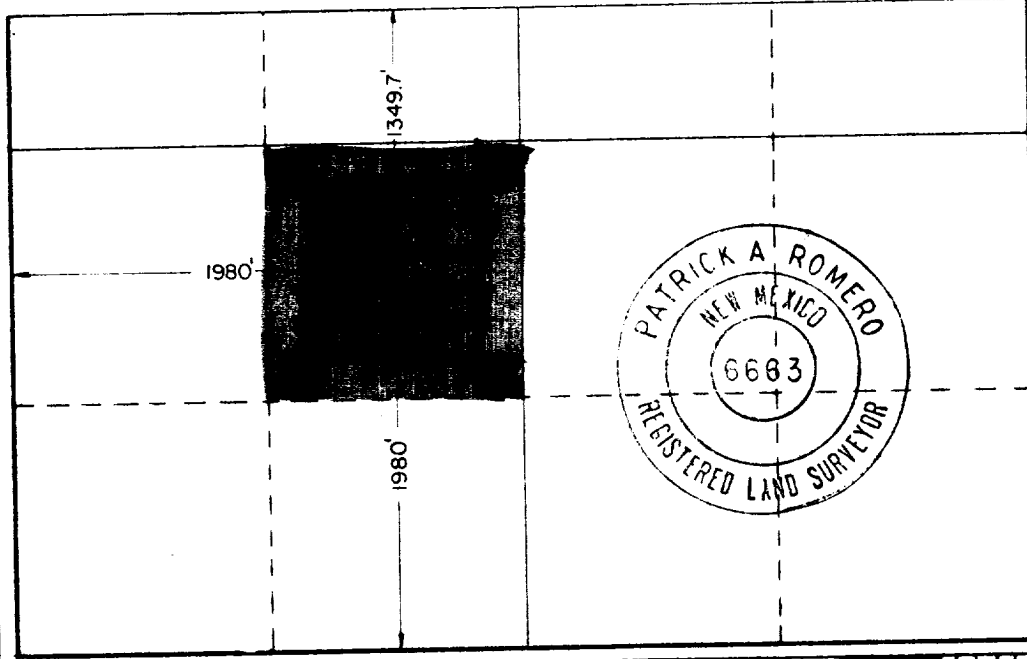

CERTIFICATION

I hereby certify that the information contained herein is true and complete to the best of my knowledge and belief.

Robert G. Armstrong

Name
Robert G. Armstrong

Position
President

Company
Armstrong Energy Corp.

Date
March 5, 1981

I hereby certify that the well location shown on this plat was plotted from field notes of actual surveys made by me or under my supervision, and that the same is true and correct to the best of my knowledge and belief.

Date Surveyed
3-2-81

Registered Professional Engineer and/or Land Surveyor
Patrick A. Romero

Certificate No. **JOHN W. WEST 676**
PATRICK A. ROMERO 6663
Ronald J. Eiden 3239

RECEIVED

MAR 6 1981

U.S. CONSERVATION DIV.

FILE