

30-005-20789

NO. OF COPIES RECEIVED		
DISTRIBUTION		
SANTA FE		
FILE		
U.S.G.S.		
LAND OFFICE		
OPERATOR		

## NEW MEXICO OIL CONSERVATION COMMISSION

Form C-101  
Revised 1-1-65

5A. Indicate Type of Lease	
STATE <input checked="" type="checkbox"/>	FEE <input type="checkbox"/>
5. State Oil & Gas Lease No.	
K 3754	

## APPLICATION FOR PERMIT TO DRILL, DEEPEN, OR PLUG BACK

1a. Type of Work		7. Unit Agreement Name	
b. Type of Well DRILL <input checked="" type="checkbox"/> DEEPEN <input type="checkbox"/> PLUG BACK <input type="checkbox"/> OIL WELL <input checked="" type="checkbox"/> GAS WELL <input type="checkbox"/> OTHER <input type="checkbox"/> SINGLE ZONE <input checked="" type="checkbox"/> MULTIPLE ZONE <input type="checkbox"/>		8. Farm or Lease Name State-32	
2. Name of Operator MWJ Producing Company		9. Well No. 5	
3. Address of Operator 1804 First National Bank Building, Midland, Texas 79701		10. Field and Pool, or Wildcat Undesignated	
4. Location of Well UNIT LETTER C LOCATED 990 FEET FROM THE North LINE AND 2310 FEET FROM THE West LINE OF SEC. 32 TWP. 7S RGE. 31E NMPM		12. County Chaves	
19. Proposed Depth 4000'		19A. Formation San Andres	20. Rotary or C.T. Rotary
21. Elevations (Show whether DF, RT, etc.) 4281.6 Gr.	21A. Kind & Status Plug. Bond Current-Blanket	21B. Drilling Contractor WEK Drlg. Co.	22. Approx. Date Work will start As soon as possible

## PROPOSED CASING AND CEMENT PROGRAM

SIZE OF HOLE	SIZE OF CASING	WEIGHT PER FOOT	SETTING DEPTH	SACKS OF CEMENT	EST. TOP
12 1/4"	8 5/8"	24#	1450'	700	Circulate
7 7/8"	4 1/2"	9.5#	4000'	325	2800'

Surface casing will be set at top of salt section with cement circulated. Cement for oil string calculated to reach base of salt section.

Double ram BOP to be installed after surface casing cemented, tested to 1,000 Psi. and utilized to TD. Rams to be operated daily. Control valve for drill pipe to be available on floor while drilling below surface casing.

APPROVAL VALID FOR 180 DAYS  
PERMIT EXPIRES 9/16/81  
UNLESS DRILLING UNDERWAY

IN ABOVE SPACE DESCRIBE PROPOSED PROGRAM: IF PROPOSAL IS TO DEEPEN OR PLUG BACK, GIVE DATA ON PRESENT PRODUCTIVE ZONE AND PROPOSED NEW PRODUCTIVE ZONE. GIVE BLOWOUT PREVENTER PROGRAM, IF ANY.

I hereby certify that the information above is true and complete to the best of my knowledge and belief.

Signed V. B. Neek Title Agent Date 3/13/81

(This space for State Use)

APPROVED BY [Signature] TITLE Agent DATE 3/13/81

CONDITIONS OF APPROVAL, IF ANY:

NEW MEXICO OIL CONSERVATION COMMISSION  
WELL LOCATION AND ACREAGE DEDICATION PLAT

Form O-17,  
Supersedes O-12B  
Effective 1-1-65

All distances must be from the outer boundaries of the Section

Operator <b>M W J Producing Co.</b>		Lease <b>State 32</b>		Acres <b>5</b>
Section <b>C</b>	Section <b>32</b>	Range <b>7South</b>	Range <b>31East</b>	County <b>Chaves</b>
Distance from the well:				
<b>2310</b> feet from the <b>West</b>		<b>990</b> feet from the <b>North</b>		
Ground Level Elev <b>4281.6'</b>	Producing Formation <b>San Andres</b>	Foot <b>Tom Tom (San Andres)</b>	Producing Acreage <b>40</b> Acres	

1. Outline the acreage dedicated to the subject well by colored pencil or hatchure marks on the plat below.
2. If more than one lease is dedicated to the well, outline each and identify the ownership thereof (both as to working interest and royalty).
3. If more than one lease of different ownership is dedicated to the well, have the interests of all owners been consolidated by communitization, unitization, force-pooling, etc?

☐ Yes ☐ No If answer is "yes," type of consolidation \_\_\_\_\_

If answer is "no," list the owners and tract descriptions which have actually been consolidated (Use reverse side of this form if necessary.) \_\_\_\_\_

No allowable will be assigned to the well until all interests have been consolidated (by communitization, unitization, forced-pooling, or otherwise) or until a non-standard unit, eliminating such interests, has been approved by the Commission.

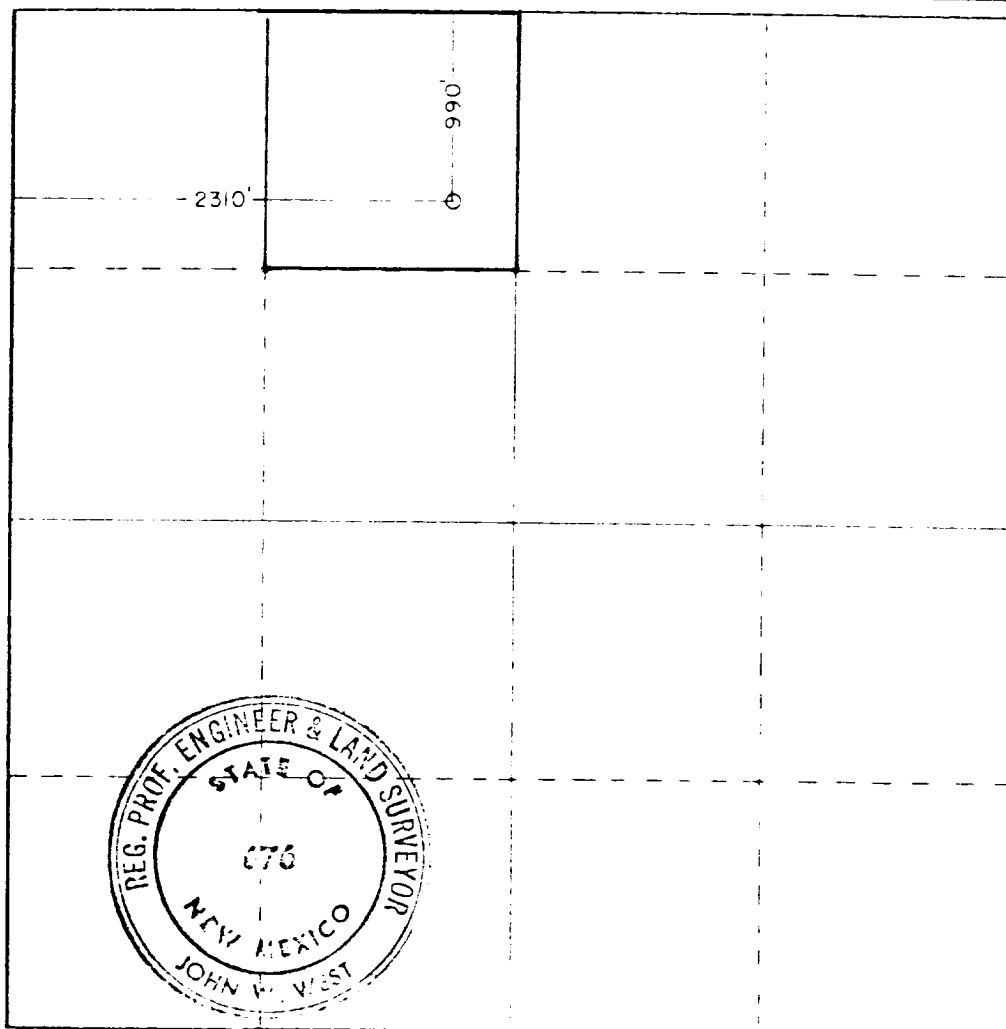

CERTIFICATION

I hereby certify that the information contained herein is true and complete to the best of my knowledge and belief.

*D. R. Meek*

D. R. Meek

Agent

MWJ Producing Company

3/13/81

I hereby certify that the well location shown on this plat was plotted from field notes of actual surveys made by me or under my supervision and that the same is true and correct to the best of my knowledge and belief.

Date surveyed  
Mar..11, 1981

Registered Professional Engineer  
and Land Surveyor

Certificate No. **JOHN W. WEST 676**  
**PATRICK A. ROMERO 6263**

RECEIVED

MAR 16 1981

171