

30-005-20794

NO. OF COPIES RECEIVED	
DISTRIBUTION	
SANTA FE	
FILE	
U.S.G.S.	
LAND OFFICE	
OPERATOR	

NEW MEXICO OIL CONSERVATION COMMISSION

Revised 1-1-65

5A. Indicate Type of Lease
STATE <input type="checkbox"/> FEE <input checked="" type="checkbox"/>

5. State Oil & Gas Lease No.

APPLICATION FOR PERMIT TO DRILL, DEEPEN, OR PLUG BACK

6. Type of Work		7. Unit Agreement Name	
DRILL <input checked="" type="checkbox"/> DEEPEN <input type="checkbox"/> PLUG BACK <input type="checkbox"/>			
8. Type of Well		8. Farm or Lease Name	
OIL WELL <input checked="" type="checkbox"/> GAS WELL <input type="checkbox"/> OTHER <input type="checkbox"/> SINGLE ZONE <input type="checkbox"/> MULTIPLE ZONE <input type="checkbox"/>		Griffin	
9. Name of Operator		9. Well No.	
Adams Exploration Company		2	
10. Address of Operator		10. Field and Pool, or Wildcat	
P. O. Box 10585, Midland, Texas 79702		Undesignated/San Andres	
11. Location of Well		12. County	
UNIT LETTER <u>F</u> LOCATED <u>2030</u> FEET FROM THE <u>North</u> LINE <u>1980</u> FEET FROM THE <u>West</u> LINE OF SEC. <u>10</u> TWP. <u>8-S</u> RGE. <u>32-E</u> NMPM		Chaves	
19. Proposed Depth		19A. Formation	
4400'		San Andres	
20. Rotary or C.T.		Rotary	
21A. Kind & Status Plug. Bond		21B. Drilling Contractor	
Blanket		Big "3" Machine & Supply	
22. Approx. Date Work will start		April 22, 1981	

PROPOSED CASING AND CEMENT PROGRAM

SIZE OF HOLE	SIZE OF CASING	WEIGHT PER FOOT	SETTING DEPTH	SACKS OF CEMENT	EST. TOP
12 1/4"	8 5/8"	24#	+ 1800'	+ 600 sx	circ to surface.
7 7/8"	4 1/2"	10.5#	TD	+ 250 sx	3000'

Drill 12 1/4" hole to 1800'. Set & cmt 8 5/8", 24#, K-55 casing @ 1800' w/600 sx. WOC 18 hrs. NU and test BOP. Test casing to 1000 psi. Drill out w/7 7/8" bit w/water. Mud up at 3900' to 9.5#/gal. 35 sec. viscosity to drill San Andres formation. At TD run log suite. If production is indicated, run 4 1/2", 10.5#, K-55 new casing to TD and cement w/400 sx.

ABOVE SPACE DESCRIBE PROPOSED PROGRAM: IF PROPOSAL IS TO DEEPEN OR PLUG BACK, GIVE DATA ON PRESENT PRODUCTIVE ZONE AND PROPOSED NEW PRODUCTION ZONE. GIVE BLOWOUT PREVENTER PROGRAM, IF ANY.

I hereby certify that the information above is true and complete to the best of my knowledge and belief.

By D.C. Helm Title Operations Manager Date 4-20-81

(This space for State Use)

PROVED BY [Signature] TITLE SUPERVISOR DISTRICT DATE 4-20-81

CONDITIONS OF APPROVAL, IF ANY:

NF MEXICO OIL CONSERVATION COMMISSION
WELL LOCATION AND ACREAGE DEDICATION PLAT

Form 1-1981
Supersedes 1-1-78
Effective 1-1-81

All distances must be from the outer boundaries of the Section.

Operator Adams Exploration Company			Lease Griffin			Well No. 2
Section Letter F	Section 10	Township 8 South	Range 32 East	County Chaves		
Actual Footage Location of Well:						
2030 feet from the North line and		1980 feet from the West line				
Ground Level Elev. 4469.3'	Producing Formation San Andres	Pool Chaveroo (San Andres)	Dedicated Acreage 40			

1. Outline the acreage dedicated to the subject well by colored pencil or hatchure marks on the plat below
2. If more than one lease is dedicated to the well, outline each and identify the ownership thereof (both as to working interest and royalty).
3. If more than one lease of different ownership is dedicated to the well, have the interests of all owners been consolidated by communitization, unitization, force-pooling, etc?

☐ Yes ☐ No If answer is "yes," type of consolidation _____

If answer is "no," list the owners and tract descriptions which have actually been consolidated. (Use reverse side of this form if necessary.) _____

No allowable will be assigned to the well until all interests have been consolidated (by communitization, unitization, forced-pooling, or otherwise) or until a non-standard unit, eliminating such interests, has been approved by the Commission.

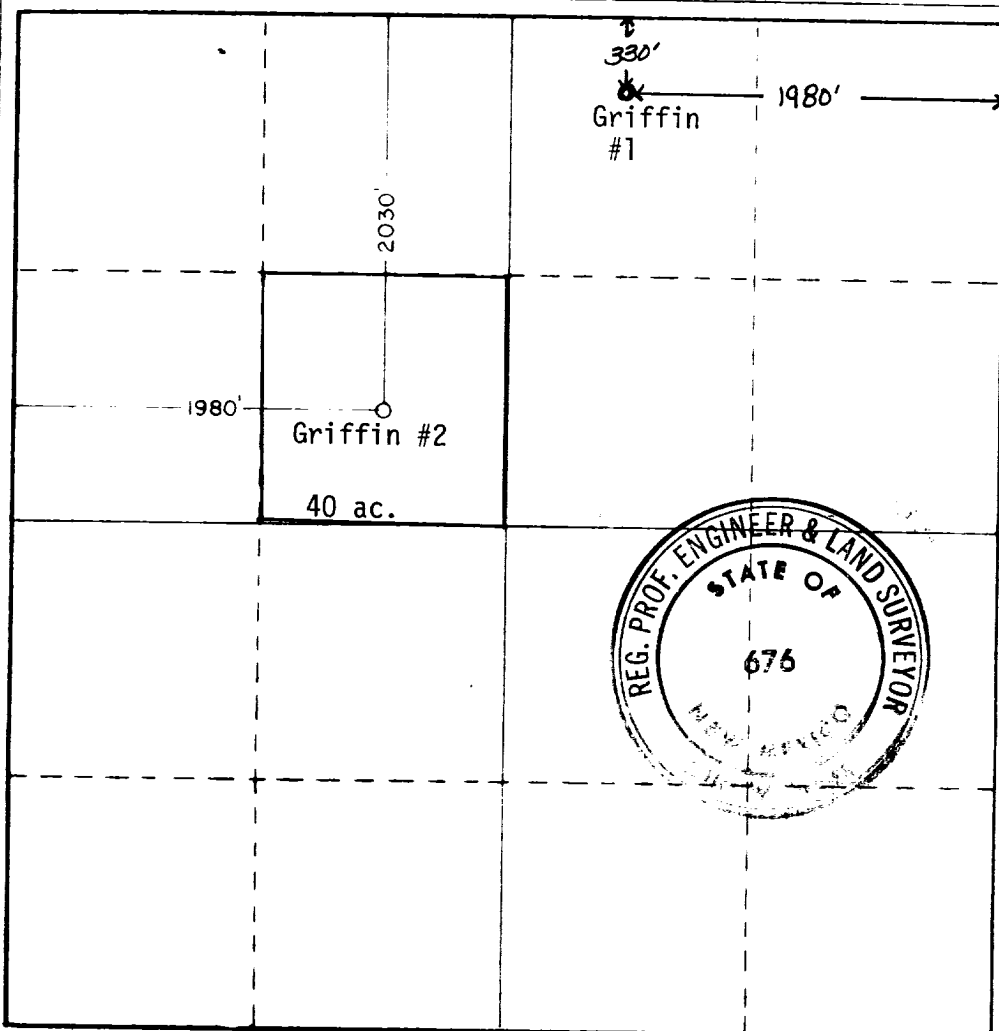

CERTIFICATION

I hereby certify that the information contained herein is true and complete to the best of my knowledge and belief.

D.C. Helm
Name _____

Operations Manager

Position _____

Adams Exploration Company

Company _____

April 20, 1981

Date _____

I hereby certify that the well location shown on this plat was plotted from field notes of actual surveys made by me or under my supervision, and that the same is true and correct to the best of my knowledge and belief.

Date Surveyed _____

April 8, 1981

Registered Professional Engineer and/or Land Surveyor

John W. West

Certificate No. **JOHN W. WEST 676**
PATRICK A. ROMERO 6663
Ronald J. Eidson 3239

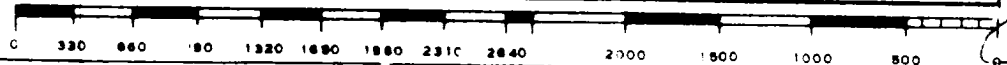

OIL CONSERVATION DIV.

APR 21 '81

RECEIVED

