

UNITED STATES
DEPARTMENT OF THE INTERIOR
GEOLOGICAL SURVEY

30-005-20800

APPLICATION FOR PERMIT TO DRILL, DEEPEN, OR PLUG BACK

1a. TYPE OF WORK

DRILL ☒DEEPEN ☐PLUG BACK ☐

b. TYPE OF WELL

OIL
WELL ☒GAS
WELL ☐

OTHER

SINGLE
ZONE ☒MULTIPLE
ZONE ☐

2. NAME OF OPERATOR

Flag-Redfern Oil Company

3. ADDRESS OF OPERATOR

P.O. Box 2280, Midland, TX 79702

4. LOCATION OF WELL (Report location clearly and in accordance with any State requirements.)

At surface

660' FSL & 660' FEL

At proposed prod. zone

SAME

14. DISTANCE IN MILES AND DIRECTION FROM NEAREST TOWN OR POST OFFICE*

17 miles east of Elkins, New Mexico

10. DISTANCE FROM PROPOSED*

LOCATION TO NEAREST

PROPERTY OR LEASE LINE, FT.

(Also to nearest drlg. unit line, if any)

660'

18. DISTANCE FROM PROPOSED LOCATION*

TO NEAREST WELL, DRILLING COMPLETED,
OR APPLIED FOR, ON THIS LEASE, FT.

16. NO. OF ACRES IN LEASE

1440

19. PROPOSED DEPTH

4150

17. NO. OF ACRES ASSIGNED
TO THIS WELL

40

20. ROTARY OR CABLE TOOLS

Rotary

21. ELEVATIONS (Show whether DF, RT, GR, etc.)

4378 GL

22. APPROX. DATE WORK WILL START*

July 2, 1981

23.

PROPOSED CASING AND CEMENTING PROGRAM

SIZE OF HOLE	SIZE OF CASING	WEIGHT PER FOOT	SETTING DEPTH	QUANTITY OF CEMENT
11	8 5/8"	24# K-55	1650	750 sx CIRCULATE
7 7/8"	4 1/2"	10.5# K-55	4150	250 sx

Drill 11" hole to 1650' or into the top of the Rustler Anhydrite formation. Run 8 5/8" csg and circ cmt with 750 sx. Wait on cmt 18 hrs. and test csg to 600 psig. Drill 7 7/8" hole to approximately 4150'. Run open hole log. Run 4 1/2" casing to 4150'. Cmt with 250 sx 50/50 Cl "H"/Poz, 8# salt, .75% CFR-2, 2% gel. Test csg to 1500 psig. Run correlation log and perforate the San Andres formation. Treat with acid. Swab to test. Potential well.

IN ABOVE SPACE DESCRIBE PROPOSED PROGRAM: If proposal is to deepen or plug back, give data on present productive zone. If proposal is to drill or deepen directionally, give pertinent data on subsurface locations and measured and true vertical depths. Give blowout preventer program, if any.

24.

SIGNED

TITLE Engineer

DATE 5-12-81

(This space for Federal or State official use)

PERMIT NO.

APPROVAL DATE

APPROVED BY

TITLE

DATE

CONDITIONS OF APPROVAL, IF ANY:

JAMES A. GILLHAM
DISTRICT SUPERVISOR

*See Instructions On Reverse Side

NEW MEXICO OIL CONSERVATION COMMISSION
WELL LOCATION AND ACREAGE DEDICATION PLAT

Form C-107
Supersedes C-128
Effective 1-1-65

All distances must be from the outer boundaries of the Section

Operator FLAG-REDFERN OIL COMPANY			Lease Hahn-Federal "B"			Well No. 1
Init. Letter P	Section 23	Township 7-S	Range 31-E	County CHAVES		
Actual Footage Location of Well: 660 feet from the SOUTH line and 660 feet from the EAST line. Ground Level Elev. 4378 Forming Formation SAN ANDRES Foot TOW-TOW (SAN ANDRES) Dedicated Acreage 40 Acres						

- Outline the acreage dedicated to the subject well by colored pencil or hatchure marks on the plat below.
- If more than one lease is dedicated to the well, outline each and identify the ownership thereof (both as to working interest and royalty).
- If more than one lease of different ownership is dedicated to the well, have the interests of all owners been consolidated by communitization, unitization, force-pooling, etc?

☐ Yes ☐ No If answer is "yes," type of consolidation _____

If answer is "no," list the owners and tract descriptions which have actually been consolidated. (Use reverse side of this form if necessary.) _____

No allowable will be assigned to the well until all interests have been consolidated (by communitization, unitization, forced-pooling, or otherwise) or until a non-standard unit, eliminating such interests, has been approved by the Commission.

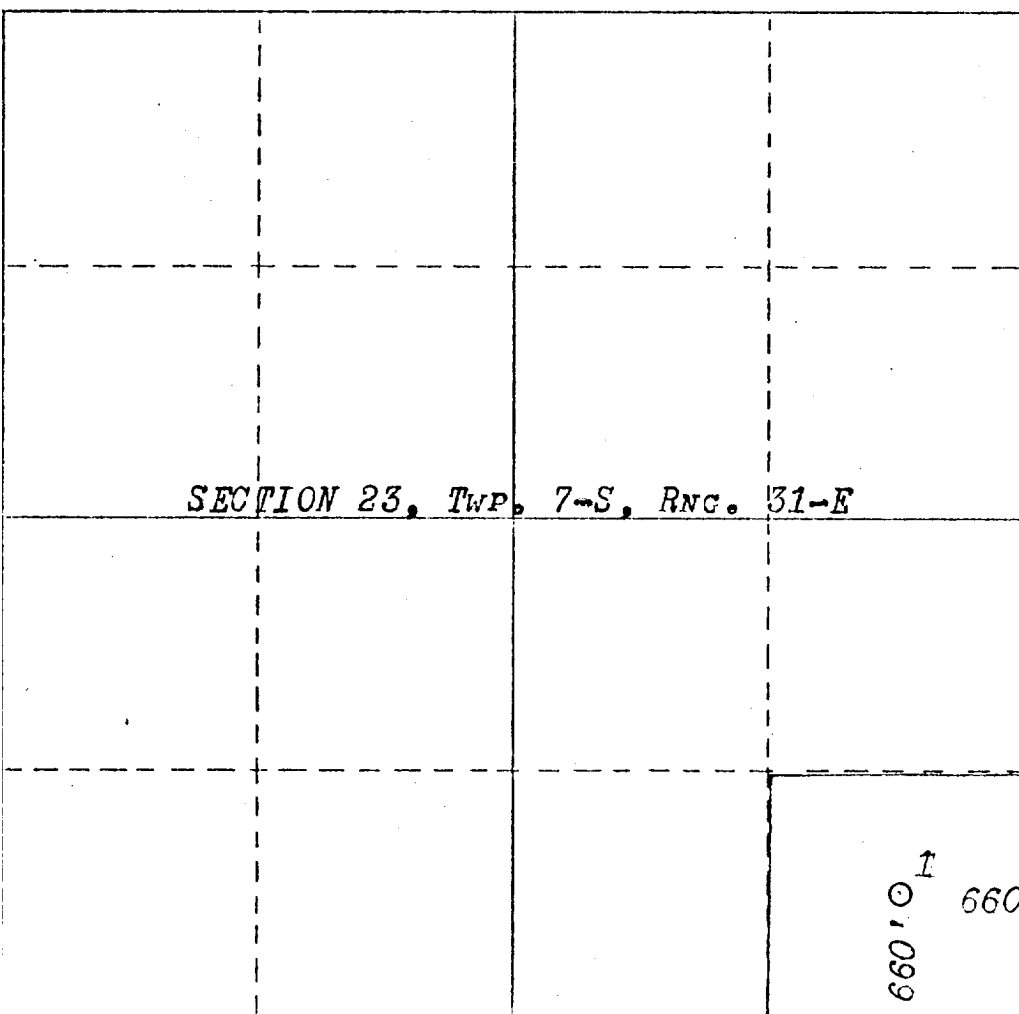

CERTIFICATION

I hereby certify that the information contained herein is true and complete to the best of my knowledge and belief.

Name _____
Production Engineer

Position _____
Flag-Redfern Oil Co.

Company _____
May 12, 1981

Date _____

I hereby certify that the well location shown on this plat was checked from field notes of _____ made by me or under my supervision and that the same is true and correct to the best of my knowledge and belief.

Date Surveyed _____

APR. 23, 1981

Registered Professional Engineer
and/or Land Surveyor

Signature _____