

30-005-20804

NO. OF COPIES RECEIVED	
DISTRIBUTION	
ANTA FE	
ILE	
U.S.G.S.	
AND OFFICE	
PERATOR	

NEW MEXICO OIL CONSERVATION COMMISSION

Form C-101
Revised 1-1-65

5A. Indicate Type of Lease

STATE ☐FEE ☒

5. State Oil & Gas Lease No.

APPLICATION FOR PERMIT TO DRILL, DEEPEN, OR PLUG BACK

Type of Work

DRILL ☒DEEPEN ☐PLUG BACK ☐

Type of Well

OIL WELL ☒GAS WELL ☐

OTHER

SINGLE ZONE ☐MULTIPLE ZONE ☐

Name of Operator

Adams Exploration Company

Address of Operator

P. O. Box 10585, Midland, Texas 79702

Location of Well

UNIT LETTER E LOCATED 1650 FEET FROM THE North LINE330 FEET FROM THE West LINE OF SEC. 11 TWP. 8-S RCE. 32-E NMPM

7. Unit Agreement Name

8. Farm or Lease Name

Griffin

9. Well No.

3

10. Field and Pool, or Wildcat

Undesignated/San Andres

12. County

Chaves

19. Proposed Depth

4400'

19A. Formation

San Andres

20. Rotary or C.T.

Rotary

Elevations (Show whether DF, RT, etc.)

4464.5' GR

21A. Kind & Status Plug. Bond

Blanket

21B. Drilling Contractor

Layton Exploration

22. Approx. Date Work will start

June 14, 1981

PROPOSED CASING AND CEMENT PROGRAM

SIZE OF HOLE	SIZE OF CASING	WEIGHT PER FOOT	SETTING DEPTH	SACKS OF CEMENT	EST. TOP
12 1/4"	8 5/8"	24#	+ 1800'	+ 600 sx	circ to surface
7 7/8"	4 1/2"	10.5#	TD	+ 250 sx	3000'

Drill 12 1/4" hole to 1800'. Set and cmt 8 5/8", 24#, K-55 casing @ 1800' w/600 sx. WOC 18 hrs. NU and test BOP. Test casing to 1000 psi. Drill out w/7 7/8" bit w/water. Mud up @ 3900' to 9.5#/gal. 35 sec viscosity to drill San Andres formation. At TD run log suite. If production is indicated, run 4 1/2", 10.5#, K-55 new casing to TD and cmt w/400 sx.

APPROVAL VALID FOR 180 DAYS
PERMIT EXPIRES 12/1/81
UNLESS DRILLING UNDERWAY

OVER SPACE DESCRIBE PROPOSED PROGRAM: IF PROPOSAL IS TO DEEPEN OR PLUG BACK, GIVE DATA ON PRESENT PRODUCTIVE ZONE AND PROPOSED NEW PRODUCTION. GIVE BLOWOUT PREVENTER PROGRAM, IF ANY.

I certify that the information above is true and complete to the best of my knowledge and belief.

D.C. Helm Title Operations Manager

Date 6-11-81

(This space for State Use)

APPROVED BY [Signature] TITLE

DATE

REASONS OF APPROVAL, IF ANY:

NEW MEXICO OIL CONSERVATION COMMISSION
WELL LOCATION AND ACREAGE DEDICATION PLAT

Form C-102
Supersedes C-128
Effective 1-1-65

All distances must be from the outer boundaries of the Section.

Operator Adams Exploration Co.		Lease Griffin		Well No. 3
Unit Letter E	Section 11	Township 8South	Range 32East	County Chaves
Actual Footage Location of Well: 1650 feet from the North line and 330 feet from the West line				
Ground Level Elev. 4464.5'	Producing Formation San Andres	Pool Undesignated/San Andres	Dedicated Acreage: 40 Acres	

1. Outline the acreage dedicated to the subject well by colored pencil or hachure marks on the plat below.
2. If more than one lease is dedicated to the well, outline each and identify the ownership thereof (both as to working interest and royalty).
3. If more than one lease of different ownership is dedicated to the well, have the interests of all owners been consolidated by communitization, unitization, force-pooling, etc?

☐ Yes ☐ No If answer is "yes," type of consolidation _____

If answer is "no," list the owners and tract descriptions which have actually been consolidated. (Use reverse side of this form if necessary.) _____

No allowable will be assigned to the well until all interests have been consolidated (by communitization, unitization, forced-pooling, or otherwise) or until a non-standard unit, eliminating such interests, has been approved by the Commission.

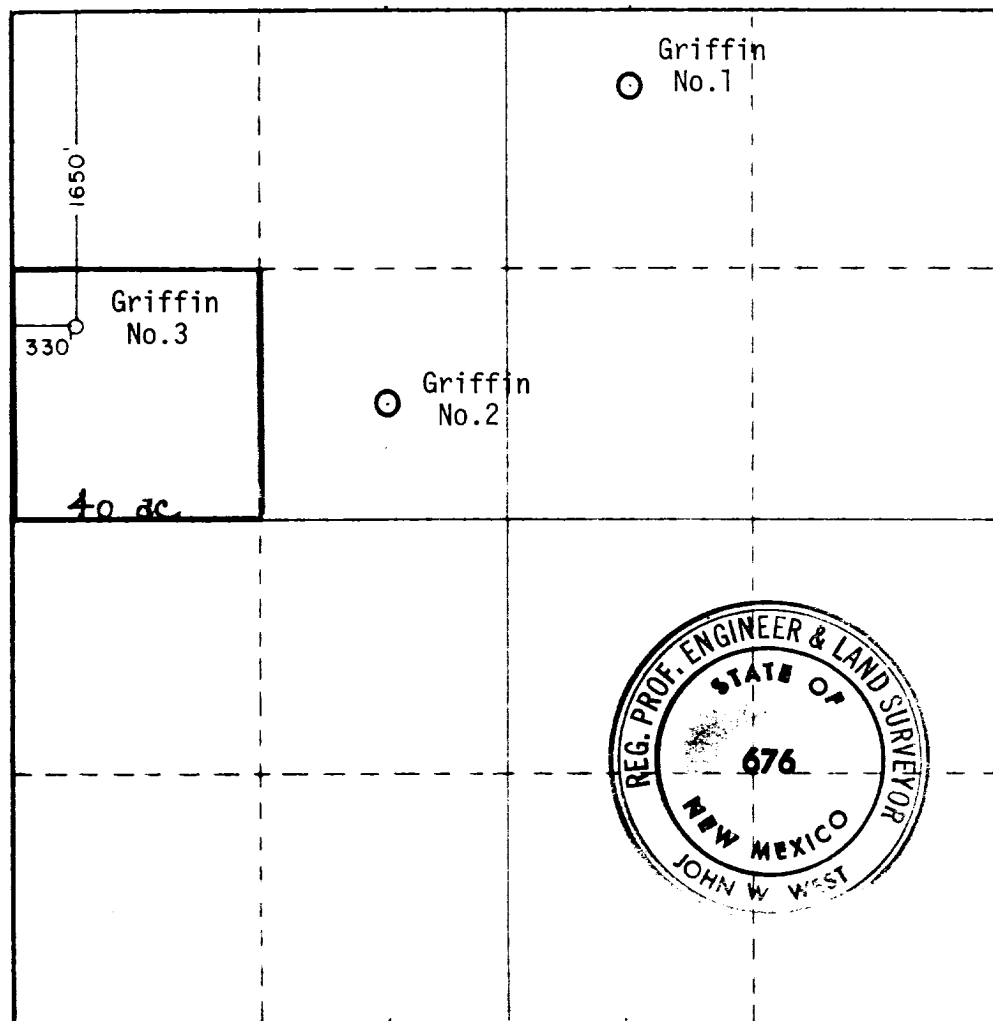

CERTIFICATION

I hereby certify that the information contained herein is true and complete to the best of my knowledge and belief.

Name D. C. Helm
Position Operations Manager
Company Adams Exploration Company

Date June 11, 1981

I hereby certify that the well location shown on this plat was plotted from field notes of actual surveys made by me or under my supervision, and that the same is true and correct to the best of my knowledge and belief.

Date Surveyed June 9, 1981

Registered Professional Engineer and Land Surveyor

John W. West
Certificate No. JOHN W. WEST 676
PATRICK A. ROMERO 6463
Ronald J. Eidson 3239