

NO. OF COPIES RECEIVED	
DISTRIBUTION	
SANTA FE	
FILE	
U.S.G.S.	
LAND OFFICE	
OPERATOR	

NEW MEXICO OIL CONSERVATION COMMISSION

Form C-101
Revised 1-1-65

5A. Indicate Type of Lease
STATE <input type="checkbox"/> FEE <input checked="" type="checkbox"/>
5. State Oil & Gas Lease No.

APPLICATION FOR PERMIT TO DRILL, DEEPEN, OR PLUG BACK

1a. Type of Work		7. Unit Agreement Name	
b. Type of Well OIL WELL <input checked="" type="checkbox"/> GAS WELL <input type="checkbox"/> OTHER <input type="checkbox"/>		8. Farm or Lease Name C.L. O'Brien	
2. Name of Operator Mobil Producing TX. & N.M. Inc.		9. Well No. 2	
3. Address of Operator Nine Greenway Plaza, Suite 2700, Houston, TX 77046		10. Field and Pool, or Wildcat Undesignated	
4. Location of Well UNIT LETTER H LOCATED 1980 FEET FROM THE North LINE 660 East 7 8S 30E AND FEET FROM THE LINE OF SEC. TWP. RGE. NMPM		12. County Chaves	
19. Proposed Depth 8100'		19A. Formation Montoya	
21. Elevations (Show whether DF, RT, etc.) G.L. 4060'		22. Approx. Date Work will start	
21A. Kind & Status Plug. Bond On File		21B. Drilling Contractor Verna Drilling Company	

23.

PROPOSED CASING AND CEMENT PROGRAM

SIZE OF HOLE	SIZE OF CASING	WEIGHT PER FOOT	SETTING DEPTH	SACKS OF CEMENT	EST. TOP
17 1/2"	13-3/8"	48#	1005'	Circulated	Surface
12 1/4"	8-5/8"	28#	4460'	Circulated	Surface
7-7/8"	5 1/2" Liner	17#	4191'-8060'	Circulated	4191' - Tie in with 8-5/8"

BLOWOUT PREVENTER PROGRAM:

Casing String	Equipment & API Series	No. & Type	Test Pressure PSI
Surface	11 x 5000#	1 Master Gate 1 Pipe Ram 1 Annular 1 Rotating Head	5000#

Permit dated Jan. 28, 1983, granted authority to complete this well in the Lightcap (Devonian) Pool. The well was non-productive in this zone. Permission is now requested to complete this well in an undesignated Montoya zone.

IN ABOVE SPACE DESCRIBE PROPOSED PROGRAM: IF PROPOSAL IS TO DEEPEN OR PLUG BACK, GIVE DATA ON PRESENT PRODUCTIVE ZONE AND PROPOSED NEW PRODUCTIVE ZONE. GIVE BLOWOUT PREVENTER PROGRAM, IF ANY.

I hereby certify that the information above is true and complete to the best of my knowledge and belief.

Signed A.D. Bond A.D. Bond Title Regulatory Technician Supervisor Date July 1, 1983

(This space for State Use)

ORIGINAL SIGNED BY EDDIE SEAY

APPROVED BY OIL & GAS INSPECTOR TITLE _____ DATE _____

CONDITIONS OF APPROVAL, IF ANY:

JUL 5 1983

RECEIVED

JUL 5 1983

**O.C.D.
HOSAS OFFICE**

**NEW MEXICO OIL CONSERVATION COMMISSION
WELL LOCATION AND ACREAGE DEDICATION PLAT**

Form C-102
Supersedes C-128
Effective 1-1-85

All distances must be from the outer boundaries of the Section.

Operator Mobil Producing TX. & N.M. Inc.			Lease C.L. O'Brien		Well No. 2
Unit Letter H	Section 7	Township 8S	Range 30E	County Chaves	
Actual Footage Location of Well: <div style="display: flex; justify-content: space-between;"> 1980 feet from the North line and 660 feet from the East line </div>					
Ground Level Elev. 4060'	Producing Formation Montoya	Pool Undesignated		Dedicated Acreage: 40 Acres	

1. Outline the acreage dedicated to the subject well by colored pencil or hachure marks on the plat below.
2. If more than one lease is dedicated to the well, outline each and identify the ownership thereof (both as to working interest and royalty).
3. If more than one lease of different ownership is dedicated to the well, have the interests of all owners been consolidated by communitization, unitization, force-pooling, etc?

☐ Yes ☐ No If answer is "yes," type of consolidation _____

If answer is "no," list the owners and tract descriptions which have actually been consolidated. (Use reverse side of this form if necessary.) _____

No allowable will be assigned to the well until all interests have been consolidated (by communitization, unitization, forced-pooling, or otherwise) or until a non-standard unit, eliminating such interests, has been approved by the Commission.

S89° 54'E 2650.34'

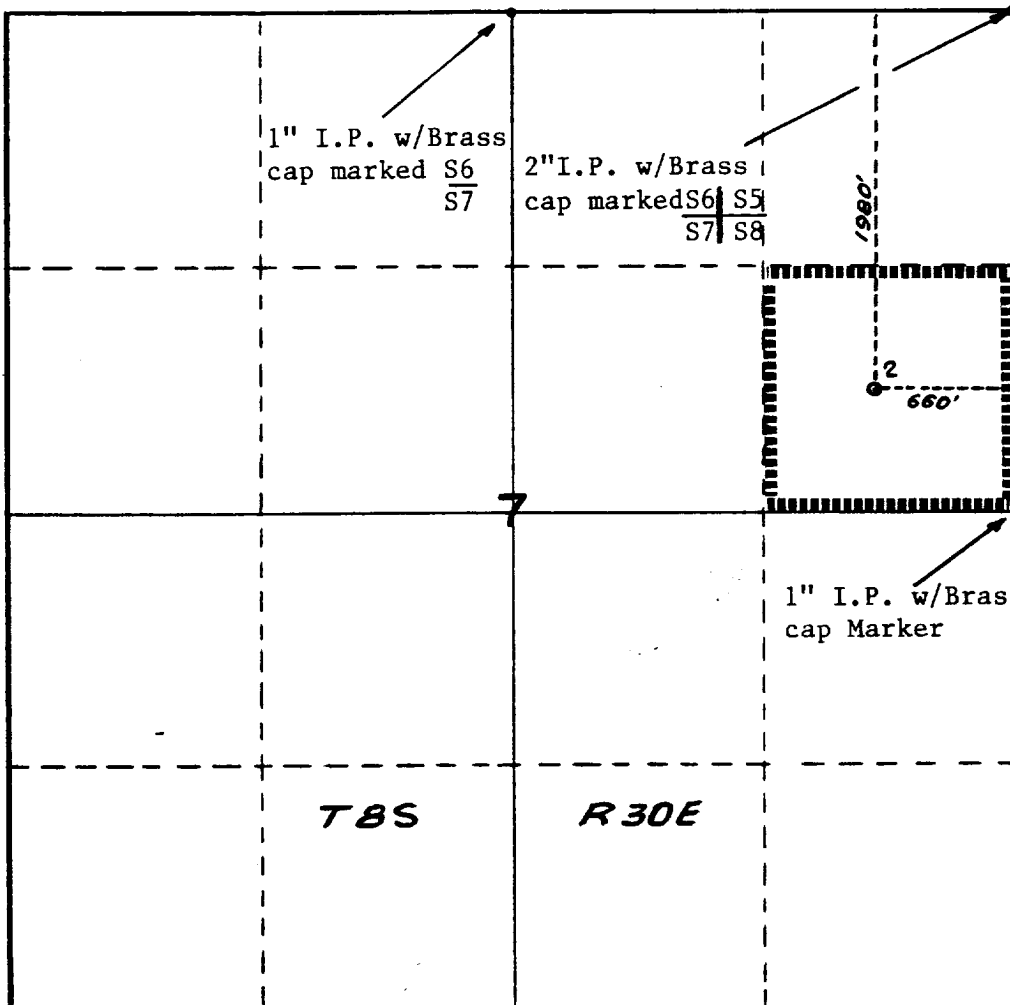

CERTIFICATION

I hereby certify that the information contained herein is true and complete to the best of my knowledge and belief.

A.D. Bond
Name **A.D. Bond**

Position **Regulatory
Technician Supervisor**

Company **Mobil Producing
TX. & N.M. Inc.**

Date
July 1, 1983

I hereby certify that the well location shown on this plat was plotted from field notes of actual surveys made by me or under my supervision, and that the same is true and correct to the best of my knowledge and belief.

Date Surveyed _____

Registered Professional Engineer
and/or Land Surveyor

Certificate No. _____

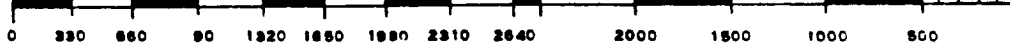

RECEIVED

JUL 5 1983

U.S. HOUSE OF REPRESENTATIVES