

NO. OF COPIES RECEIVED	
DISTRIBUTION	
SANTA FE	
FILE	
U.S.G.S.	
LAND OFFICE	
OPERATOR	

NEW MEXICO OIL CONSERVATION COMMISSION

Form C-101
Revised 1-1-65

5A. Indicate Type of Lease
STATE ☐ FEE ☒
5. State Oil & Gas Lease No.

APPLICATION FOR PERMIT TO DRILL, DEEPEN, OR PLUG BACK

1a. Type of Work

b. Type of Well

DRILL ☒

DEEPEN ☐

PLUG BACK ☐

OIL WELL ☒

GAS WELL ☐

OTHER

SINGLE ZONE ☐

MULTIPLE ZONE ☐

2. Name of Operator

EL RAN, INC.

3. Address of Operator

P. O. BOX 911, LUBBOCK, TEXAS 79408

4. Location of Well

UNIT LETTER C

LOCATED 1980

FEET FROM THE West

LINE

AND 660

FEET FROM THE

NORTH

LINE OF SEC. 10

TWP. 8S

RGE. 32E

NADEN

7. Lease Agreement Date

8. Name of Lease Name

GRIFFIN

9. Well No.

#1

10. Field and Pool, or Sub-lease

CHAVEROO (SA)

12. County

Chaves

11. Elevations (Show whether D.F., K.I., etc.)

4487.1 GL

21A. Kind & Status Plug. Bond

On File

18. Proposed Depth

4350

19A. Formation

San Andres

20. Rotary or C.T.

Rotary

21B. Drilling Contractor

WEK

22. Approx. Date Work will start

June 16, 1983

PROPOSED CASING AND CEMENT PROGRAM

SIZE OF HOLE	SIZE OF CASING	WEIGHT PER FOOT	SETTING DEPTH	SACKS OF CEMENT	EST. TOP
11"	8 5/8	24	1700	575	Surface
7 7/8	4 1/2	10.5	4350	200	3,560 KB

8 5/8" casing will be set at approximately 1700' and cemented to surface. Blow out preventor will be installed after surface casing is run and will be tested to 1500# before drilling out from under surface.

APPROVAL VALID FOR 180 DAYS
PERMIT EXPIRES 11/24/83
UNLESS DRILLING UNDERWAY

1. ABOVE SPACE DESCRIBE PROPOSED PROGRAM: IF PROPOSAL IS TO DEEPEN OR PLUG BACK, GIVE DATA ON PRESENT PRODUCTIVE ZONE AND PROPOSED NEW PRODUCTIVE ZONE. GIVE BLOWOUT PREVENTER PROGRAM, IF ANY.

I hereby certify that the information above is true and complete to the best of my knowledge and belief.

Signed [Signature] Title Vice-President

Date May 24, 1983

(This space for State Use)

ORIGINAL SIGNED BY JERRY SEXTON

APPROVED BY DISTRICT I SUPERVISOR TITLE

DATE MAY 26 1983

CONDITIONS OF APPROVAL, IF ANY:

**NEW MEXICO OIL CONSERVATION COMMISSION
WELL LOCATION AND ACREAGE DEDICATION PLAT**

Form C-102
Supersedes C-128
Effective 1-1-85

All distances must be from the outer boundaries of the Section.

Operator EL RAN INC.			Lease GRIFFIN		Well No. 1
Unit Letter C	Section 10	Township 8 South	Range 32 East	County Chaves	
Actual Footage Location of Well: 1980 feet from the West line and 660 feet from the North line					
Ground Level Elev. 4487.1	Producing Formation San Andres		Pool Chaveroo	Dedicated Acreage: 40 Acres	

1. Outline the acreage dedicated to the subject well by colored pencil or hachure marks on the plat below.
2. If more than one lease is dedicated to the well, outline each and identify the ownership thereof (both as to working interest and royalty).
3. If more than one lease of different ownership is dedicated to the well, have the interests of all owners been consolidated by communitization, unitization, force-pooling, etc?

☒ Yes ☐ No If answer is "yes," type of consolidation COMMUNITIZATION

If answer is "no," list the owners and tract descriptions which have actually been consolidated. (Use reverse side of this form if necessary.) _____

No allowable will be assigned to the well until all interests have been consolidated (by communitization, unitization, forced-pooling, or otherwise) or until a non-standard unit, eliminating such interests, has been approved by the Commission.

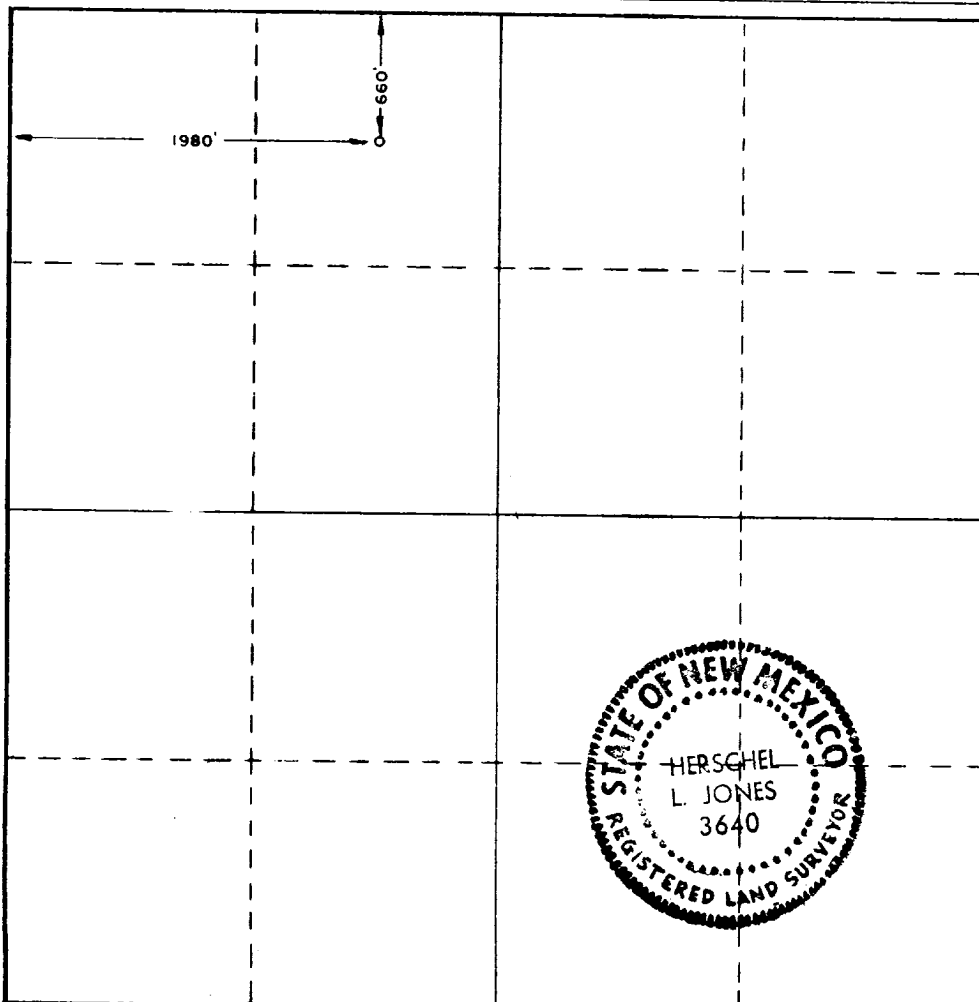

CERTIFICATION

I hereby certify that the information contained herein is true and complete to the best of my knowledge and belief.

Name
William W. Ranck, Jr.

Position
Vice-President

Company
EL RAN, INC.

Date
May 25, 1983

I hereby certify that the well location shown on this plat was plotted from field notes of actual surveys made by me or under my supervision, and that the same is true and correct to the best of my knowledge and belief.

Date Surveyed
5/17/83

Registered Professional Engineer and/or Land Surveyor

Herschel L. Jones
Certificate No. **3640**

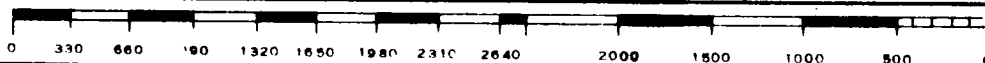

RECEIVED

MAY 25 1983

O.C.D.
HOBBS OFFICE

