

UNITED STATES
DEPARTMENT OF THE INTERIOR
GEOLOGICAL SURVEY

30-005-20905

APPLICATION FOR PERMIT TO DRILL, DEEPEN, OR PLUG BACK

1a. TYPE OF WORK

DRILL ☒DEEPEN ☐PLUG BACK ☐

b. TYPE OF WELL

OIL WELL ☒GAS WELL ☐OTHER ☐SINGLE ZONE ☐MULTIPLE ZONE ☐

2. NAME OF OPERATOR

Hilliard Oil & Gas, Inc. ✓

3. ADDRESS OF OPERATOR

3000 N. Garfield, Suite 120 Midland, TX 79705

4. LOCATION OF WELL (Report location clearly and in accordance with any State requirements)

At surface

1900' ENL & 990' FEL

At proposed prod. zone

Same

14. DISTANCE IN MILES AND DIRECTION FROM NEAREST TOWN OR POST OFFICE*

25 miles east of Hagerman, NM

OIL & GAS

15. DISTANCE FROM PROPOSED*

LOCATION TO NEAREST

PROPERTY OR LEASE LINE, FT.

(Also to nearest drlg. unit line, if any)

800'

18. DISTANCE FROM PROPOSED LOCATION*

TO NEAREST WELL, DRILLING, COMPLETED,
OR APPLIED FOR, ON THIS LEASE, FT.

1300'

16. NO. OF ACRES IN LEASE

400

19. PROPOSED DEPTH

11,200'

17. NO. OF ACRES ASSIGNED
TO THIS WELL

40

20. ROTARY OR CABLE TOOLS

Rotary

21. ELEVATIONS (Show whether DF, RT, GR, etc.)

4059 GR

22. APPROX. DATE WORK WILL START*

August 1, 1983

23. PROPOSED CASING AND CEMENTING PROGRAM

SIZE OF HOLE	SIZE OF CASING	WEIGHT PER FOOT	SETTING DEPTH	QUANTITY OF CEMENT
17 1/2"	13 3/8"	48#	500'	550 Sx Class "C" Circulated
11"	8 5/8"	24 & 32#	3,000'	1400 Sx "HL" & 300 Sx "C" Circ.
7 7/8"	5 1/2"	17#	11,200'	500 Sx Class "C"

Mud Program:

0' - 500' Spud mud, FW, Gel.
500' - 3,000' Brine and native mud, mud wt. 9.2-10.2 ppg, Vis 30-34, No WL.
3,000' - 9,000' Cut brine, native mud, gel, mud wt. 9.4-9.6#, Vis. 30-34,
No WL control.
9,000' - 11,200' Salt water based mud system, mud wt. 9.6-9.8#, Vis. 36-44,
Water loss control 20cc or less.

BOP Program:

Blowout Preventers will consist of:

1 - Shaffer LWS Hydraulic double 10" x 1500 series.

1 - Shaffer Spherical 10" x 1500 series.

The blowout preventers will be tested daily. See Exhibit "D".

IN ABOVE SPACE DESCRIBE PROPOSED PROGRAM: If proposal is to deepen or plug back, give data on present productive zone and proposed new productive zone. If proposal is to drill or deepen directionally, give pertinent data on subsurface locations and measured and true vertical depths. Give blowout preventer program, if any.

24.

SIGNED

Georgel Smith

TITLE

Agent for:

Hilliard Oil & Gas, Inc.

DATE

July 6, 1983

(This space for Federal or State office use)

PERMIT NO.

APPROVAL DATE

APPROVED BY

A.D. Lopez

TITLE

DATE

7/25/83

CONDITIONS OF APPROVAL, IF ANY:

All distances must be from the outer boundaries of the Section.

Operator Hilliard Oil & Gas		Lease Harris Federal		Well No. #1
Well Letter H	Section 17	Township 15 South	Range 30 East	County Chaves
Actual Postage Location of Well: 1900 feet from the North line and 990 feet from the East line				
Ground Level Elev. 4059	Producing Formation Siluro-Devonian	Pool UNDESIGNATED	Dedicated Acreage 40 Acres	

1. Outline the acreage dedicated to the subject well by colored pencil or hatchure marks on the plat below.
2. If more than one lease is dedicated to the well, outline each and identify the ownership thereof (both as to working interest and royalty).
3. If more than one lease of different ownership is dedicated to the well, have the interests of all owners been consolidated by communitization, unitization, force-pooling, etc?

☐ Yes ☐ No If answer is "yes," type of consolidation _____

If answer is "no," list the owners and tract descriptions which have actually been consolidated. (Use reverse side of this form if necessary.) _____

No allowable will be assigned to the well until all interests have been consolidated (by communitization, unitization, forced-pooling, or otherwise) or until a non-standard unit, eliminating such interests, has been approved by the Division.

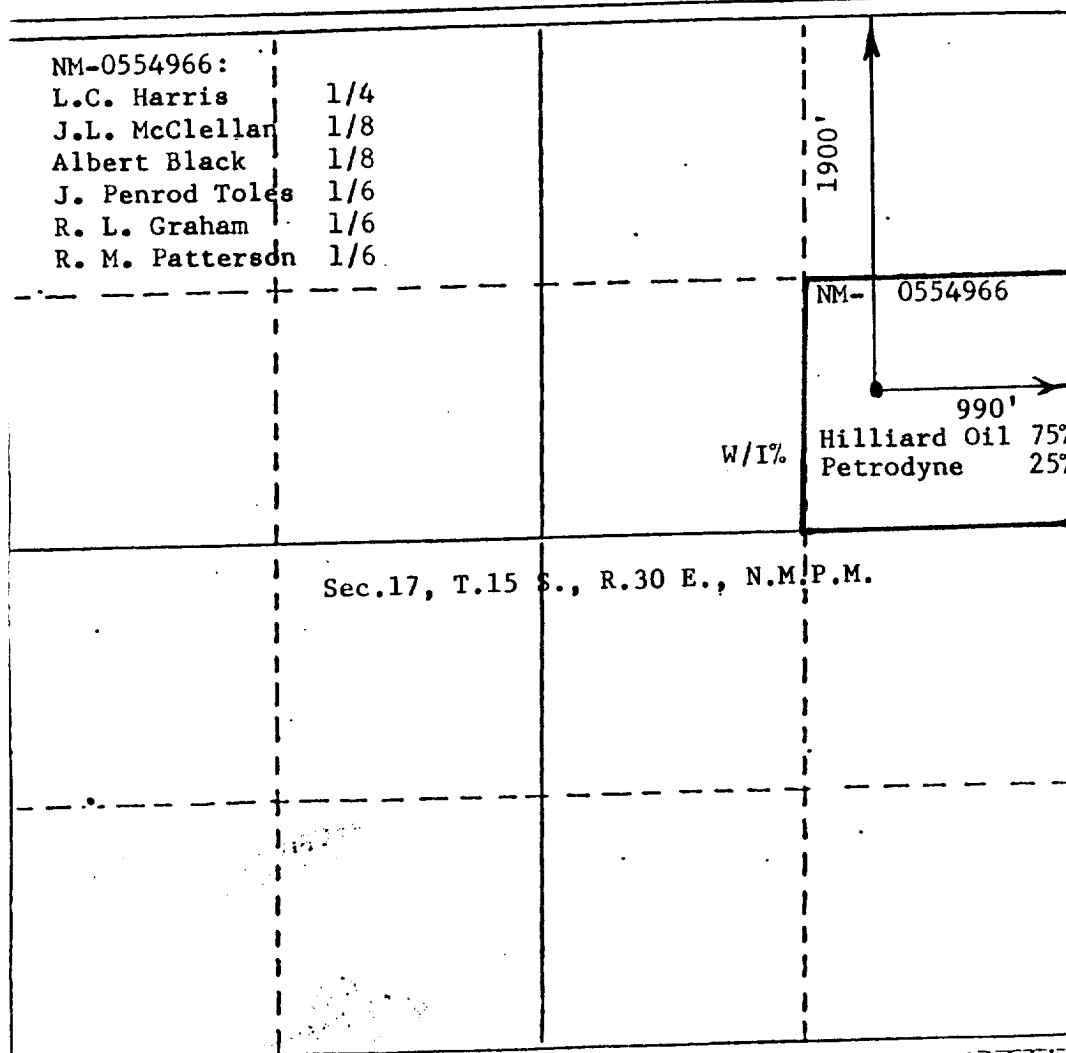

CERTIFICATION

I hereby certify that the information contained herein is true and complete to the best of my knowledge and belief.

George R. Smith

Name
George R. Smith

Position
Agent for:

Company
Hilliard Oil & Gas, Inc.

Date
July 5, 1983

I hereby certify that the well location shown on this plat was plotted from field notes of actual surveys made by me or under my supervision, and that the same is true and correct to the best of my knowledge and belief.

JOHN D. JAQUESS
NEW MEXICO
Professional Engineer
and/or Surveyor
June 24, 1983
John D. Jaquess, P.E. & L.S.
Certificate No. 6290

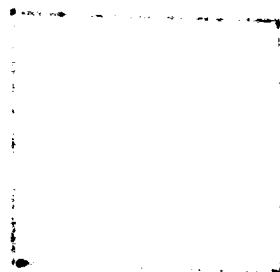

RECEIVED
AUG 1 1983
O.C.D.
HOBBS OFFICE

DRAWWORKS

Emsco GB-800

Drum: 1¼" Lebus grooved

Compound: 2-engine oil bath chain drive

Brake: Hydromatic Parkersburg 46" Double

ENGINES

Two 610-H.P. D379TA Caterpillar Diesel

DERRICK

Lee C. Moore, 131', 550,000 lb. nominal capacity

SUBSTRUCTURE

Lee C. Moore, 15' high, 550,000 lb. nominal capacity

MUD PUMPS

Pump No. 1: Emsco DB700. 700 H.P. with steel fluid end. 4¾" - 7¾" liners, 16" stroke. Compound-driven.

Pump No. 2: Emsco DA500, 500 H.P. powered by 400 H.P. D353 Caterpillar Diesel.

DRILL STRING

3000' 4-1/1" Grade E, 20 lb.

Tool Joints: 4½" H-90, 6¼" OD,

12000' 4½" Grade E, 16.60 lb.

Tool Joints: 4" H-90, 6" OD

Thirty Drilco spiral-grooved 6½" OD, 2¼" ID.

With 4" H-90 Joints.

Other sized drillpipe & drillcollars available.

BLOWOUT PREVENTERS

One Shaffer LWS Hydraulic double 10" x 1500 series. One Shaffer Spherical 10" x 1500 series. Choke manifold 4" x 1500 series flanged connections. Payne 4 valve accumulator closing unit.

MUD SYSTEM

3 - 30 x 7½ x 6 steel pits, with 700 Bbl. capacity. Complete low pressure circulating system, consisting of four submerged mud guns and two counter sunk jets in each pit. System utilizes a 6x8 centrifugal pump, powered by diesel.

EXHIBIT

HILLIARD OIL & GAS, INC.
Harris Federal, Well No. 1
BOP Spec. and Rig Layout
for Moranco Rig No. 2

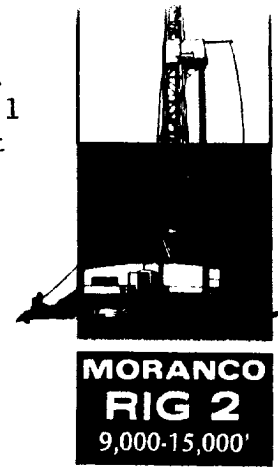

MUD HOUSE

1 - 8' x 30' Steel Storage House

COMMUNICATIONS

24-Hour direct telephone interconnection through Hobbs (A.C. 505-397-3291) or Midland - Odessa (A.C. 915-563-0562).

OTHER EQUIPMENT

BLOCKS - McKissick 350 Ton

HOOK - BJ4300 350 Ton

SWIVEL - Oilwell PC 425 Ton

LIGHT PLANTS - One 40 KW and one 20 KW AC generators, powered by diesel engines.

LIGHTS - AC fluorescent or mercury - All vapor proof.

SHALE SHAKER - Link belt, single screen.

FRESH WATER STORAGE - two 500 Bbl., horizontal tanks.

HOUSING - 1 - 8' x 36' airconditioned trailer house, with sleeping and cooking facilities.

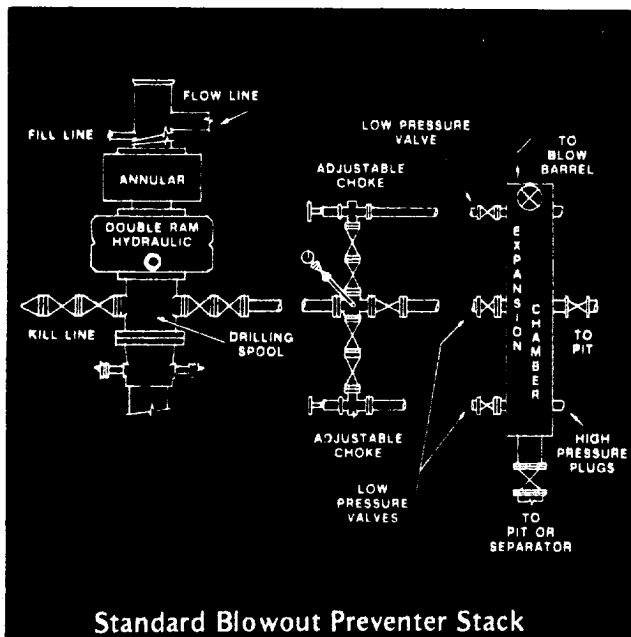

Standard Blowout Preventer Stack

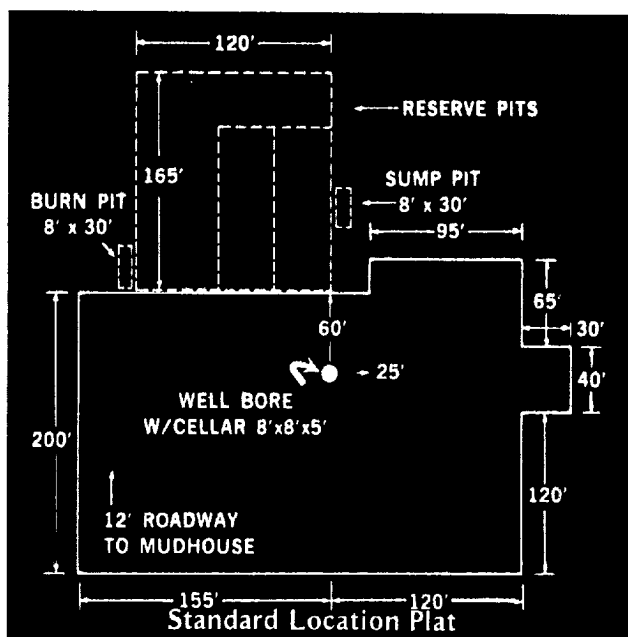

Standard Location Plat

RECEIVED
AUG 1 1983
O.C.D.
HOBBS OFFICE