

30-005-20908

Form C-101
Revised 10-1-78

NO. OF COPIES RECEIVED	
DISTRIBUTION	
SANTA FE	
FILE	
U.S.G.S.	
LAND OFFICE	
OPERATOR	

5A. Indicate Type of Lease
STATE ☐ FEE ☒
5. State Oil & Gas Lease No.

APPLICATION FOR PERMIT TO DRILL, DEEPEN, OR PLUG BACK

1a. Type of Work DRILL <input checked="" type="checkbox"/> DEEPEN <input type="checkbox"/> PLUG BACK <input type="checkbox"/>		7. Unit Agreement Name
b. Type of Well OIL WELL <input checked="" type="checkbox"/> GAS WELL <input type="checkbox"/> OTHER <input type="checkbox"/> SINGLE ZONE <input checked="" type="checkbox"/> MULTIPLE ZONE <input type="checkbox"/>		8. Farm or Lease Name YOAKUM
2. Name of Operator CONOCO INC.		9. Well No. 1
3. Address of Operator P. O. Box 460, Hobbs, N.M. 88240		10. Field and Pool, or Wildcat CHAVEROO
4. Location of Well UNIT LETTER <u>K</u> LOCATED <u>1980</u> FEET FROM THE <u>SOUTH</u> LINE AND <u>1980</u> FEET FROM THE <u>WEST</u> LINE OF SEC. <u>15</u> TWP. <u>8-S</u> RCE. <u>33-E</u> NMPM		12. County CHAVES
19. Proposed Depth 4580'		19A. Formation SAN ANDRES
20. Rotary or C.T. ROTARY		
21. Elevations (Show whether DF, RT, etc.) 4383.6 GR	21A. Kind & Status Plug. Bond BLANKET	21B. Drilling Contractor UNKNOWN
22. Approx. Date Work will start 9/15/83		

23. PROPOSED CASING AND CEMENT PROGRAM

SIZE OF HOLE	SIZE OF CASING	WEIGHT PER FOOT	SETTING DEPTH	SACKS OF CEMENT	EST. TOP
12 1/4"	8 5/8"	24 #	1875'	850	CIRC.
7 7/8"	5 1/2"	15.5 #	4580'	1725	CIRC.

IT IS PROPOSED TO DRILL A STRAIGHT HOLE TO
A TD OF 4580' AND COMPLETE AS A
SINGLE SAN ANDRES OIL WELL. SEE ATTACHMENTS
FOR A LOCATION PLAT AND BOP SPECS.

APPROVAL VALID FOR 180 DAYS
PERMIT EXPIRES 2/25/84
UNLESS DRILLING UNDERWAY

IN ABOVE SPACE DESCRIBE PROPOSED PROGRAM; IF PROPOSAL IS TO DEEPEN OR PLUG BACK, GIVE DATA ON PRESENT PRODUCTIVE ZONE AND PROPOSED NEW PRODUCTIVE ZONE. GIVE BLOWOUT PREVENTER PROGRAM, IF ANY.

I hereby certify that the information above is true and complete to the best of my knowledge and belief.
Signed Jerry Sexton Title Administrative Supervisor Date 8/22/83

(This space for State Use)
ORIGINAL SIGNED BY JERRY SEXTON
DISTRICT 1 SUPERVISOR

AUG 25 1983

APPROVED BY _____ TITLE _____ DATE _____
CONDITIONS OF APPROVAL, IF ANY:

**NEW MEXICO OIL CONSERVATION COMMISSION
WELL LOCATION AND ACREAGE DEDICATION PLAT**

Form C-102
Supersedes C-128
Effective 1-1-65

All distances must be from the outer boundaries of the Section.

Operator Conoco Inc.		Lease Yoakum		Well No. 1
Tract Letter K	Section 15	Township 8 South	Range 33 East	County Chaves County
Actual Footage Location of Well: <div style="display: flex; justify-content: space-between;"> 1980 feet from the South line and 1980 feet from the West line </div>				
Ground Level Elev. 4383.6	Producing Formation SAN ANDRES	Pool CHAUEROO	Dedicated Acreage: 40 Acres	

1. Outline the acreage dedicated to the subject well by colored pencil or hachure marks on the plat below.
2. If more than one lease is dedicated to the well, outline each and identify the ownership thereof (both as to working interest and royalty).
3. If more than one lease of different ownership is dedicated to the well, have the interests of all owners been consolidated by communitization, unitization, force-pooling, etc?

☐ Yes ☐ No If answer is "yes," type of consolidation _____

If answer is "no," list the owners and tract descriptions which have actually been consolidated. (Use reverse side of this form if necessary.) _____

No allowable will be assigned to the well until all interests have been consolidated (by communitization, unitization, forced-pooling, or otherwise) or until a non-standard unit, eliminating such interests, has been approved by the Commission.

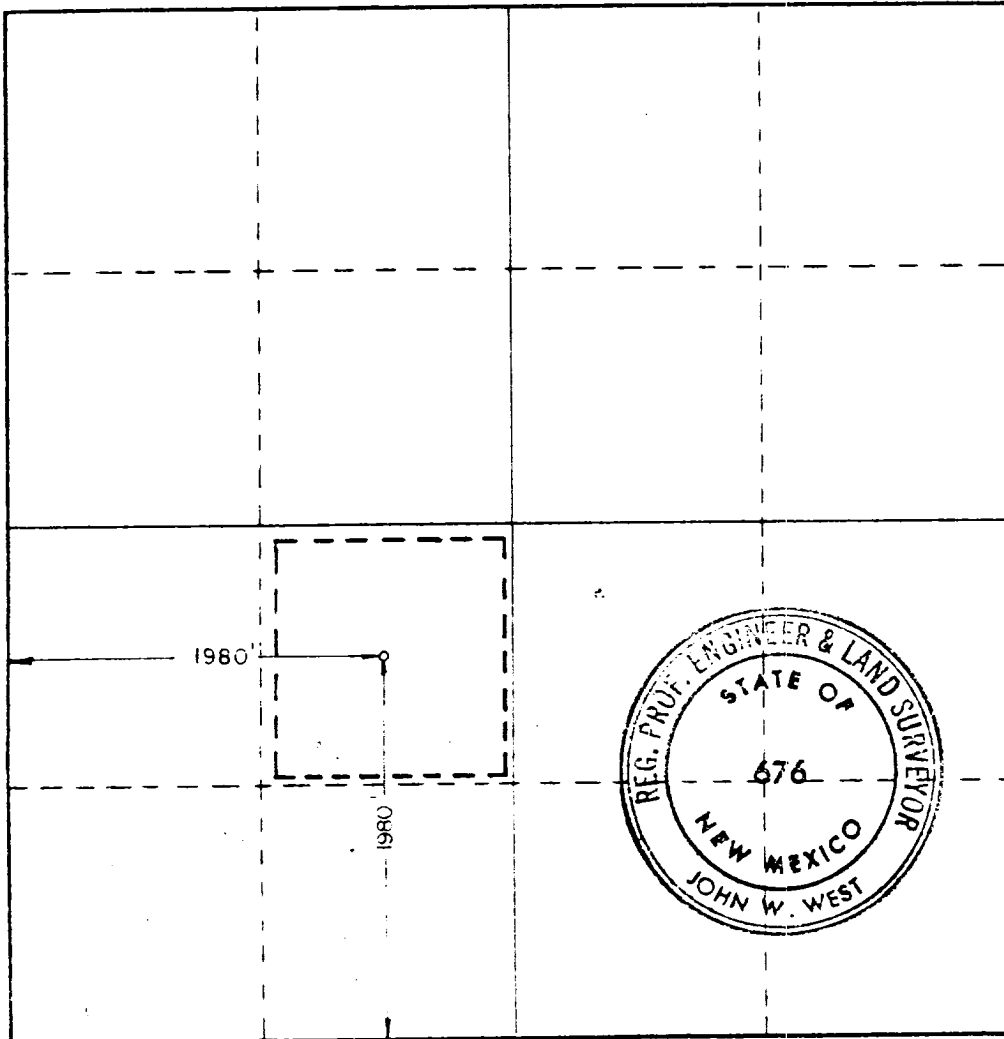

CERTIFICATION

I hereby certify that the information contained herein is true and complete to the best of my knowledge and belief.

Name: *John A. Butterfield*
 Position: **Administrative Supervisor**

Company: **CONOCO INC.**

Date: **8/22/83**

I hereby certify that the well location shown on this plat was plotted from field notes of actual surveys made by me or under my supervision, and that the same is true and correct to the best of my knowledge and belief.

Date Surveyed: **August 8, 1983**
 Registered Professional Engineer and/or Land Surveyor

[Signature]

RECEIVED

AUG 24 1938

O.C.D.
MOBBS OFFICE

CONOCO INC.

Blow-out Preventer Specifications

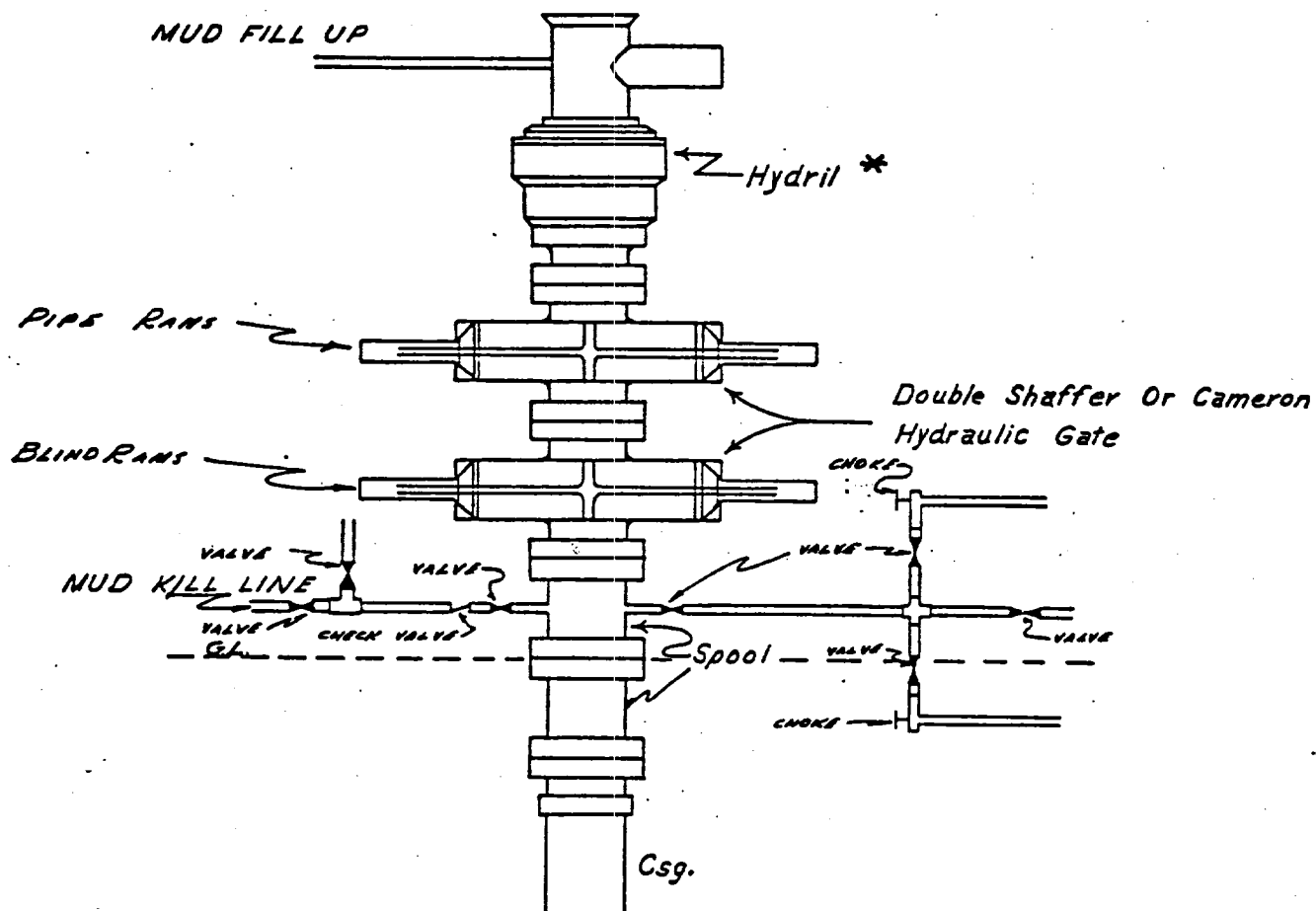

NOTE:

Manual and Hydraulic controls with closing unit no less than 75' from well head.
Remote controls on rig floor.

*

DUE TO SUBSTRUCTURE CLEARANCE, HYDRIL
MAY OR MAY NOT BE USED.

RECEIVED

AUG 24 1983

O.C.D.
HOBBS OFFICE

111