

UNITED STATES  
DEPARTMENT OF THE INTERIOR  
GEOLOGICAL SURVEY

## APPLICATION FOR PERMIT TO DRILL, DEEPEN, OR PLUG BACK

## 1a. TYPE OF WORK

DRILL ☒DEEPEN ☐PLUG BACK ☐

## b. TYPE OF WELL

OIL  
WELL ☒GAS  
WELL ☐

OTHER

SINGLE  
ZONE ☐MULTIPLE  
ZONE ☐

## 2. NAME OF OPERATOR

Yates Petroleum Corporation

## 3. ADDRESS OF OPERATOR

207 S. 4th, Artesia, New Mexico 88210

## 4. LOCATION OF WELL (Report location clearly and in accordance with any State requirements.)\*

At surface

1650' FSL and 1650' FWL

At proposed prod. zone

same

## 14. DISTANCE IN MILES AND DIRECTION FROM NEAREST TOWN OR POST OFFICE\*

15 miles south of Kenna, New Mexico.

## 15. DISTANCE FROM PROPOSED\*

LOCATION TO NEAREST  
PROPERTY OR LEASE LINE, FT.

(Also to nearest drlg. unit line, if any)

1650'

18. DISTANCE FROM PROPOSED LOCATION\*  
TO NEAREST WELL, DRILLING COMPLETED,  
OR APPLIED FOR, ON THIS LEASE, FT.

## 16. NO. OF ACRES IN LEASE

320

## 19. PROPOSED DEPTH

4300'

17. NO. OF ACRES ASSIGNED  
TO THIS WELL

40

## 20. ROTARY OR CABLE TOOLS

Rotary

## 21. ELEVATIONS (Show whether DF, RT, GR, etc.)

4390.3' GL

## 22. APPROX. DATE WORK WILL START\*

ASAP

## 23.

## PROPOSED CASING AND CEMENTING PROGRAM

SIZE OF HOLE	SIZE OF CASING	WEIGHT PER FOOT	SETTING DEPTH	QUANTITY OF CEMENT
12 1/4"	8 5/8"	24# J-55	appr. 1700'	500 sx circulated
7 7/8"	4 1/2"	9.5#	TD	300 sx

We propose to drill and test the San Andres formations. If commercial, 4 1/2" production casing will be run and cemented with an adequate cover, perforate and stimulate as needed for production.

MUD PROGRAM: Native mud to 1700'. FW to TD.

BOP PROGRAM: BOP's will be installed at 1700' and tested daily.

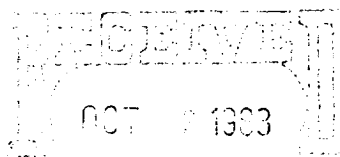

IN ABOVE SPACE DESCRIBE PROPOSED PROGRAM: If proposal is to deepen or plug back, give data on present productive zone and proposed new productive zone. If proposal is to drill or deepen directionally, give pertinent data on subsurface locations and measured and true vertical depths. Give blowout preventer program, if any.

## 24.

SIGNED

TITLE Regulatory AgentDATE 10/3/83

(This space for Federal or State office use)

PERMIT NO.

APPROVAL DATE

APPROVED BY

TITLE

DATE

10/6/83

CONDITIONS OF APPROVAL, IF ANY

APPROVAL SUBJECT TO  
GENERAL REQUIREMENTS AND  
SPECIAL STIPULATIONS  
ATTACHED

RECEIVED  
OCT 11 1993  
O.C.D.  
HOBBS OFFICE

NEW MEXICO OIL CONSERVATION COMMISSION  
WELL LOCATION AND ACREAGE DEDICATION PLAT

Form C-102  
Supersedes C-128  
Effective 1-1-65

All distances must be from the outer boundaries of the Section.

Operator <b>YATES PETROLEUM CORPORATION</b>			Lease <b>CENTER "XI" FEDERAL</b>		Well No. <b>2</b>
Unit Letter <b>K</b>	Section <b>1</b>	Township <b>8 South</b>	Range <b>31 East</b>	County <b>Chaves</b>	
Actual Footage Location of Well: <b>1650</b> feet from the <b>West</b> line and <b>1650</b> feet from the <b>South</b> line					
Ground Level Elev. <b>4390.3</b>	Producing Formation <b>San Andres</b>		Pool <b>Undes. Tomahawk SA</b>	Dedicated Acreage: <b>40</b> Acres	

- Outline the acreage dedicated to the subject well by colored pencil or hachure marks on the plat below.
- If more than one lease is dedicated to the well, outline each and identify the ownership thereof (both as to working interest and royalty).
- If more than one lease of different ownership is dedicated to the well, have the interests of all owners been consolidated by communitization, unitization, force-pooling, etc?

☐ Yes ☐ No If answer is "yes," type of consolidation \_\_\_\_\_

If answer is "no," list the owners and tract descriptions which have actually been consolidated. (Use reverse side of this form if necessary.) \_\_\_\_\_

No allowable will be assigned to the well until all interests have been consolidated (by communitization, unitization, forced-pooling, or otherwise) or until a non-standard unit, eliminating such interests, has been approved by the Commission.

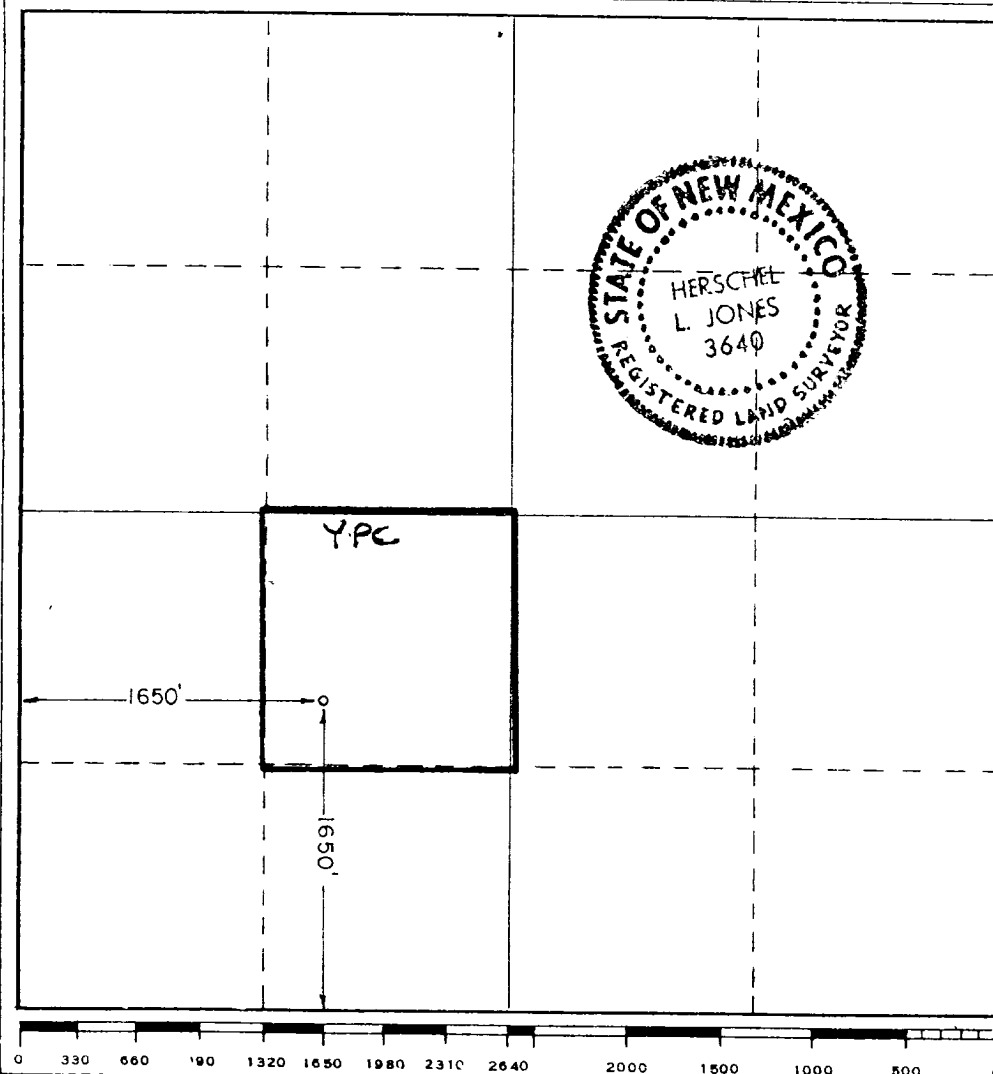

CERTIFICATION

I hereby certify that the information contained herein is true and complete to the best of my knowledge and belief.

*Gliserio Rodriguez*  
Name

**Gliserio Rodriguez**  
Position

**Regulatory Agent**  
Company

**Yates Petroleum Corp.**

Date  
**10/3/83**

**10/3/83**

I hereby certify that the well location shown on this plat was plotted from field notes of actual surveys made by me or under my supervision, and that the same is true and correct to the best of my knowledge and belief.

Date Surveyed

**9/29/83**

Registered Professional Engineer and/or Land Surveyor

*Herschel L. Jones*  
Certificate No.

**3640**

RECEIVED  
OCT 11 1983  
O.C.D.  
HOBBS OFFICE

YATES PETROLEUM CORPORATION  
Center "XI" Federal #2  
1650' FSL and 1650' FWL  
Section 1-T8S-R31E  
Chaves County, New Mexico

In conjunction with Form 9-331C, Application for Permit to Drill subject well, Yates Petroleum Corporation submits the following ten items of pertinent information in accordance with USGS requirements.

1. The geologic surface formation is sandy alluvium.
2. The estimated tops of geologic markers are as follows:

Salt	1680'
Yates	2060'
Queen	2580'
San Andres	3225'
TD	4300'
3. The estimated depths at which anticipated water, oil or gas formations are expected to be encountered:

Water:	150' - 180'
Oil or Gas:	3250'
4. Proposed Casing Program: See Form 9-331C.
5. Pressure Control Equipment: See Form 9-331C.
6. Mud Program: See Form 9-331C.
7. Auxiliary Equipment: Kelly Cock; pit level indicators and flow sensor equipment; sub with full-opening valve on floor, drill pipe connection.
8. Testing, Logging and Coring Program:

Samples:	Surface casing to TD.
DST's:	As warranted.
Coring:	None.
Logging:	CNL-FDC TD to csg w/GR-CNL to surface & DLL from TD to csg.
9. No abnormal pressures or temperatures are anticipated.
10. Anticipated starting date: As soon as possible after approval.

RECEIVED  
OCT 11 1983  
O.C.D.  
HOBBS OFFICE

MULTI-POINT SURFACE USE AND OPERATIONS PLAN  
YATES PETROLEUM CORPORATION  
Center "XI" Federal #2  
Section 1-T8S-R31E  
Developmental Well

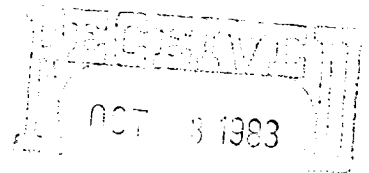

This plan is submitted with Form 9-331C, Application for Permit to Drill, covering the above described well. The purpose of this plan is to describe the location of the proposed well, the proposed construction activities and operations plan, the magnitude of surface disturbance involved and the procedures to be followed in rehabilitating the surface after completion of the operations, so that a complete appraisal can be made of the environmental effect associated with the operations.

1. EXISTING ROADS.

Exhibit A is a portion of a county map showing the well and roads in the vicinity of the proposed location. The proposed wellsite is located approximately 15 miles south of Kenna, New Mexico and the access route to the location is indicated in red and green.

DIRECTIONS:

1. Travel northeast of Roswell on Highway 70 approximately 54 miles to Kenna, New Mexico.
2. Turn south on main caliche road for approximately 13 miles to the Yates Loveless lease. Go through the east cattleguard and continue on the main lease road for approximately 1.5 miles.
3. Follow the main road turning west for .2 of a mile, then south for approximately 1/2 miles.
4. At the cattleguard, turn west for approximately 1 mile to the Union "SI" #1 gas well and then SE for .5 of a mile and turn west. The location will be on the north side of road.

2. PLANNED ACCESS ROAD.

- A. No new road will be built.
- D. The route of the road is visible.

3. LOCATION OF EXISTING WELL.

- A. There is drilling activity within a one-mile radius of the wellsite.

4. LOCATION OF EXISTING AND/OR PROPOSED FACILITIES.

- A. There are production facilities on this lease at the present time.
- B. In the event that the well is productive, the necessary production facilities will be installed on the drilling pad. If the well is productive oil, a gas or diesel self-contained unit will be used to provide the necessary power. No power will be required if the well is productive gas.

RECEIVED  
OCT 11 1983  
O.C.D.  
HOBBS OFFICE



5. LOCATION AND TYPE OF WATER SUPPLY.

- A. It is planned to drill the proposed well with a fresh water system. The water will be obtained from commercial sources and will be hauled to the location by truck over the existing and proposed roads shown in Exhibit A.

6. SOURCE OF CONSTRUCTION MATERIALS.

- A. Caliche may be needed for the road and location. If so, it will come from a private pit. (Mays Jenkins and Jake Howard)

7. METHODS OF HANDLING WASTE DISPOSAL.

- A. Drill cuttings will be disposed of in the reserve pits.
- B. Drilling fluids will be allowed to evaporate in the reserve pits until the pits are dry.
- C. Water produced during operations will be collected in tanks until hauled to an approved disposal system, or separate disposal application will be submitted.
- D. Oil produced during operations will be stored in tanks until sold.
- E. Current laws and regulations pertaining to the disposal of human waste will be complied with.
- F. Trash, waste paper, garbage and junk will be buried in a separate trash pit and covered with a minimum of 24 inches dirt. All waste material will be contained to prevent scattering by the wind.
- G. All trash and debris will be buried or removed from the wellsite within 30 days after finishing drilling and/or completion operations.

8. ANCILLARY FACILITIES.

- A. None required.

9. WELLSITE LAYOUT.

- A. Exhibit C shows the relative location and dimensions of the well pad, the reserve pits, etc.
- B. The location surface is fairly flat. Some minor leveling will be needed.
- C. The reserve pits will be plastic lined.
- D. A 400' x 400' area has been staked and flagged.

10. PLANS FOR RESTORATION OF THE SURFACE.

- A. After finishing drilling and/or completion operations, all equipment and other material not needed for further operations will be removed. The location will be cleaned of all trash and junk to leave the wellsite in as aesthetically pleasing a condition as possible.

- B. Unguarded pits, if any, containing fluids will be fenced until they have dried and leveled.
- C. If the proposed well is non-productive, all rehabilitation and/or vegetation requirements of the Operator-Landowner Agreement will be complied with and will be accomplished as expeditiously as possible. All pits will be filled level within 90 days after abandonment.

11. OTHER INFORMATION.

- A. Topography: The land surface in the vicinity of the wellsite is near level. The immediate area of the wellsite is discussed above in paragraph 9B.
- B. Flora and Fauna: The vegetation cover on wellsite consists of tobosa, terpen-tine, pepper weed, mesquite and miscellaneous desert growth. No wildlife was observed but the wildlife in the area probably includes those typical of semi-arid desert land. The area is used for cattle grazing.
- C. Waterways: None.
- D. There are no inhabited dwellings in the vicinity of the proposed wellsite.
- E. Surface Ownership: The well is on private surface and federal minerals. In a conversation with Mr. Mays Jenkins, it was agreed that we would compen-sate him monetarily for surface damaged in entering and drilling this well.

12. OPERATOR'S REPRESENTATIVE.

- A. The field representatives responsible for assuring compliance with the approved surface use plan are:

Gliserio "Rod" Rodriguez, Cy Cowan or Ken Beardemphl  
Yates Petroleum Corporation  
207 S. 4th Street  
Artesia, New Mexico 88210  
(505) 746-3558

10/3/83

DATE

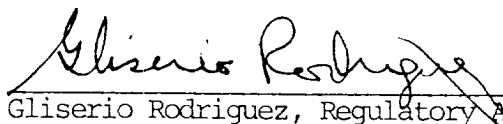
  
Gliserio Rodriguez, Regulatory Agent

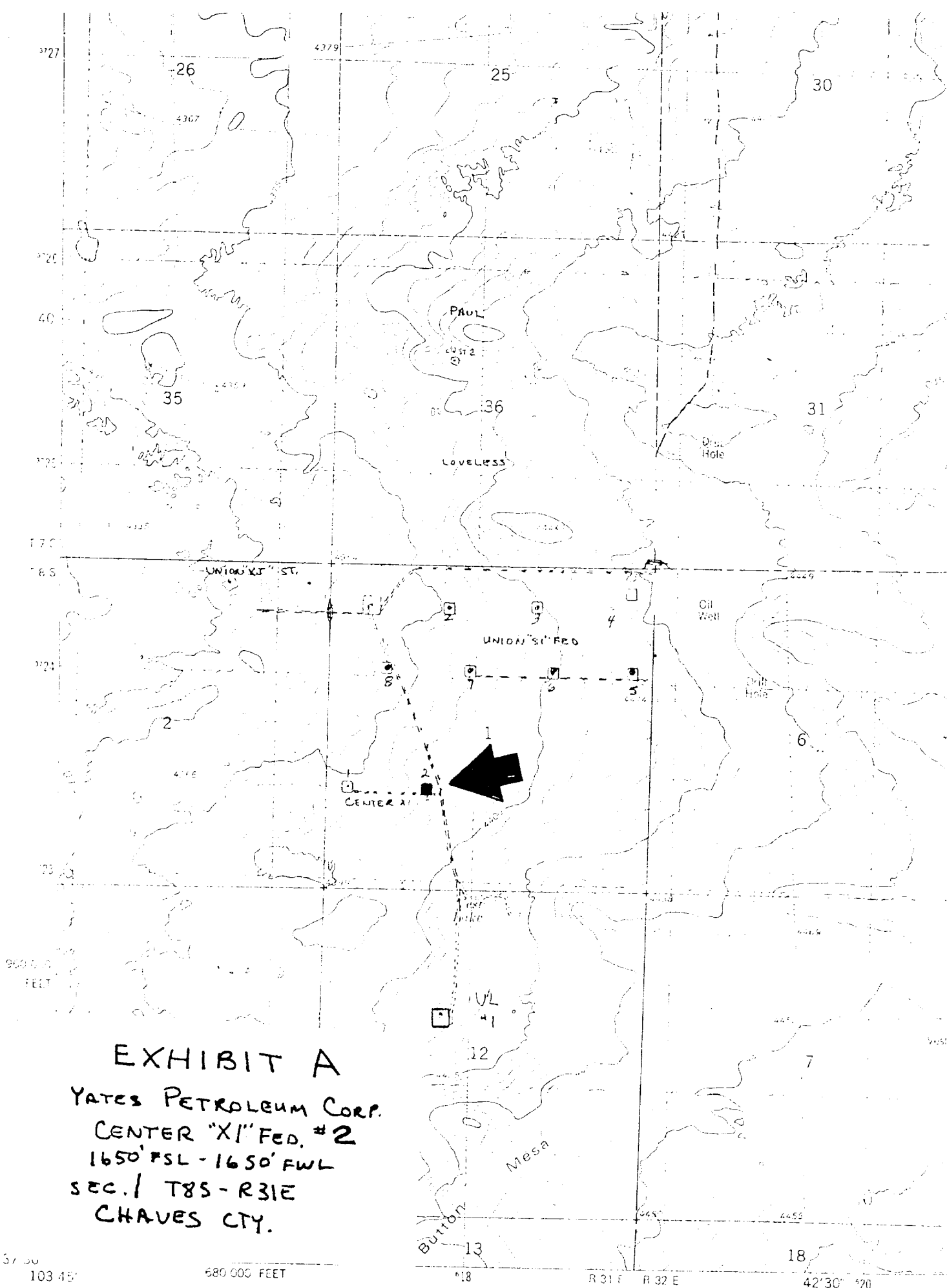

EXHIBIT A  
 YATES PETROLEUM CORP.  
 CENTER "XI" FED. #2  
 1650' FSL - 1650' FWL  
 SEC. 1 T8S-R31E  
 CHAVES CTY.

103 45'

680 000 FEET

VESEL

Mapped, edited, and published by the Geological Survey  
 Control by USGS and ROS/NOAA



# EXHIBIT B

## BDP DIAGRAM

RATED 3000<sup>#</sup>

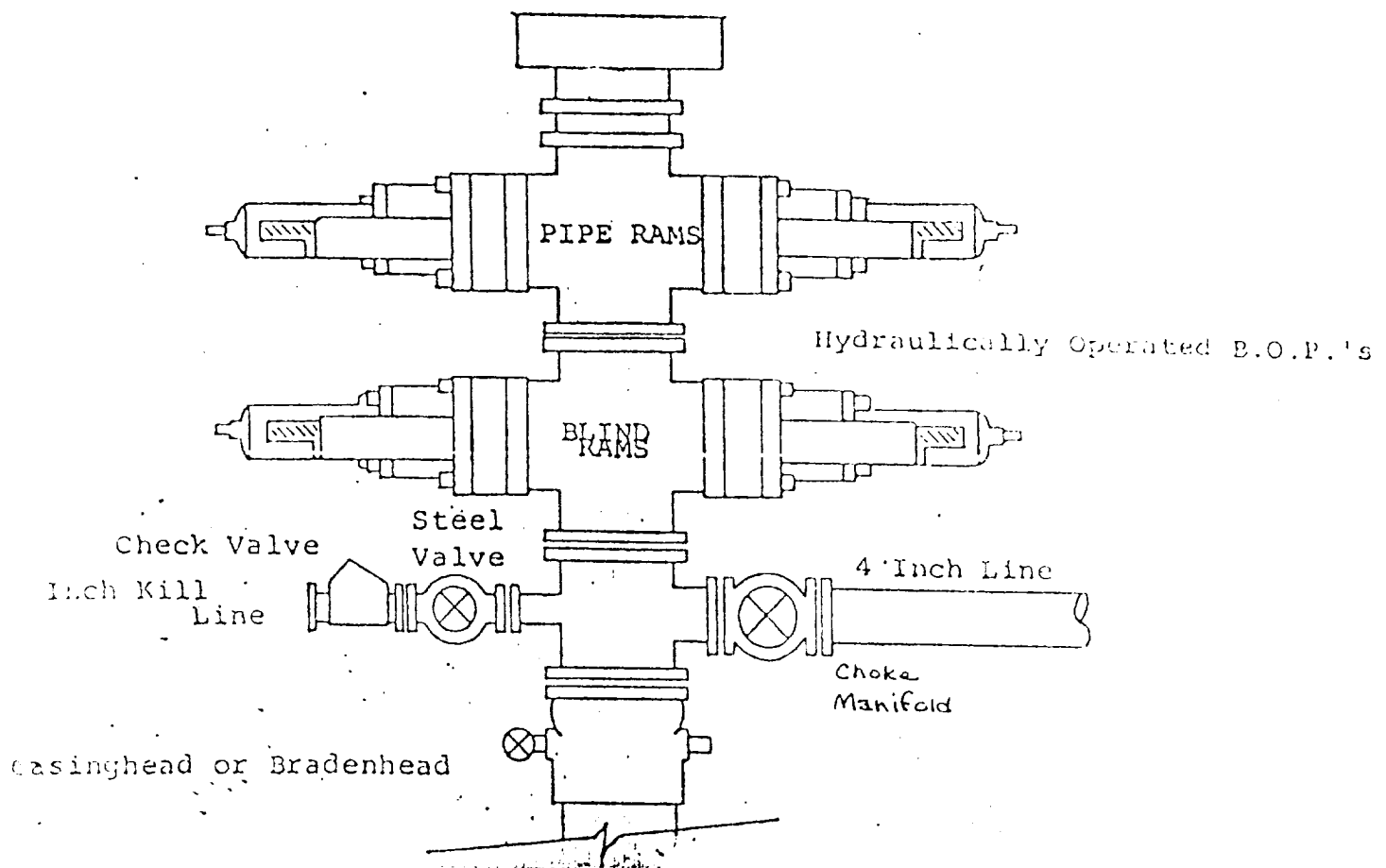

YATES PETROLEUM CORPORATION

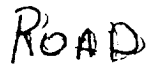

RECEIVED  
OCT 11 1983  
C.C.D.  
HOLDS OFFICE

ELF