

NO. OF COPIES RECEIVED	
DISTRIBUTION	
SANTA FE	
FILE	
U.S.G.S.	
LAND OFFICE	
OPERATOR	

5A. Indicate Type of Lease

STATE ☐ FEE ☒

5. State Oil & Gas Lease No.

NA

APPLICATION FOR PERMIT TO DRILL, DEEPEN, OR PLUG BACK

1a. Type of Work

DRILL ☒DEEPEN ☐PLUG BACK ☐

b. Type of Well

OIL
WELL ☐GAS
WELL ☐

OTHER

SINGLE
ZONE ☒MULTIPLE
ZONE ☐

2. Name of Operator

BRIGHT & COMPANY

3. Address of Operator

2355 Stemmons Bldg., Dallas, Texas 75207

4. Location of Well

UNIT LETTER E LOCATED 1980 FEET FROM THE north LINEAND 660 FEET FROM THE west LINE OF SEC. 31 TWP. 9S RGE. 30E NMPM

7. Unit Agreement Name

--

8. Farm or Lease Name

Hannifin

9. Well No.

1

10. Field and Pool, or Wildcat

Wildcat

12. County

Chaves

19. Proposed Depth

3500'

19A. Formation

San Andres

20. Rotary or C.T.

Rotary

21. Elevations (Show whether DF, RT, etc.)

3983.62 GL

21A. Plug. Bond

50,000.00 State

21B. Drilling Contractor

Not determined

22. Approx. Date Work will start

11-15-83

23.

PROPOSED CASING AND CEMENT PROGRAM

SIZE OF HOLE	SIZE OF CASING	WEIGHT PER FOOT	SETTING DEPTH	SACKS OF CEMENT	EST. TOP
11"	8-5/8"	24#	1000'	600	Surface
7-7/8"	4-1/2"	10.50#	3500'	600	1000±

BOP: Shaffer 10" Series 900, 3000 psi
Type E Double RamAPPROVAL VALID FOR 180 DAYS
PERMIT EXPIRES 5/10/84
UNLESS DRILLING UNDERWAY

N ABOVE SPACE DESCRIBE PROPOSED PROGRAM: IF PROPOSAL IS TO DEEPEN OR PLUG BACK, GIVE DATA ON PRESENT PRODUCTIVE ZONE AND PROPOSED NEW PRODUCTIVE ZONE. GIVE BLOWOUT PREVENTER PROGRAM, IF ANY.

hereby certify that the information above is true and complete to the best of my knowledge and belief.

Signed W. J. Morris Title W. J. Morris, AgentDate 11-2-83

(This space for State Use)

ORIGINAL SIGNED BY JERRY SEXTON
DISTRICT I SUPERVISOR

NOV 10 1983

APPROVED BY _____ TITLE _____

DATE _____

CONDITIONS OF APPROVAL, IF ANY:

All distances must be from the outer boundaries of the Section.

Operator BRIGHT & COMPANY		Lease Hannifin		Well No. 1
Unit Letter E	Section 31	Township 9 South	Range 30 East	County Chaves
Actual Footage Location of Well:				
1980.00 feet from the North line and		660.00 feet from the West line		
Ground Level Elev. 3983.62	Producing Formation San Andres	Pool Wildcat	Dedicated Acreage: 40 Acres	

- Outline the acreage dedicated to the subject well by colored pencil or hatchure marks on the plat below.
- If more than one lease is dedicated to the well, outline each and identify the ownership thereof (both as to working interest and royalty).
- If more than one lease of different ownership is dedicated to the well, have the interests of all owners been consolidated by communitization, unitization, force-pooling, etc?

☐ Yes ☐ No If answer is "yes," type of consolidation NA

If answer is "no," list the owners and tract descriptions which have actually been consolidated. (Use reverse side of this form if necessary.)

No allowable will be assigned to the well until all interests have been consolidated (by communitization, unitization, forced-pooling, or otherwise) or until a non-standard unit, eliminating such interests, has been approved by the Division.

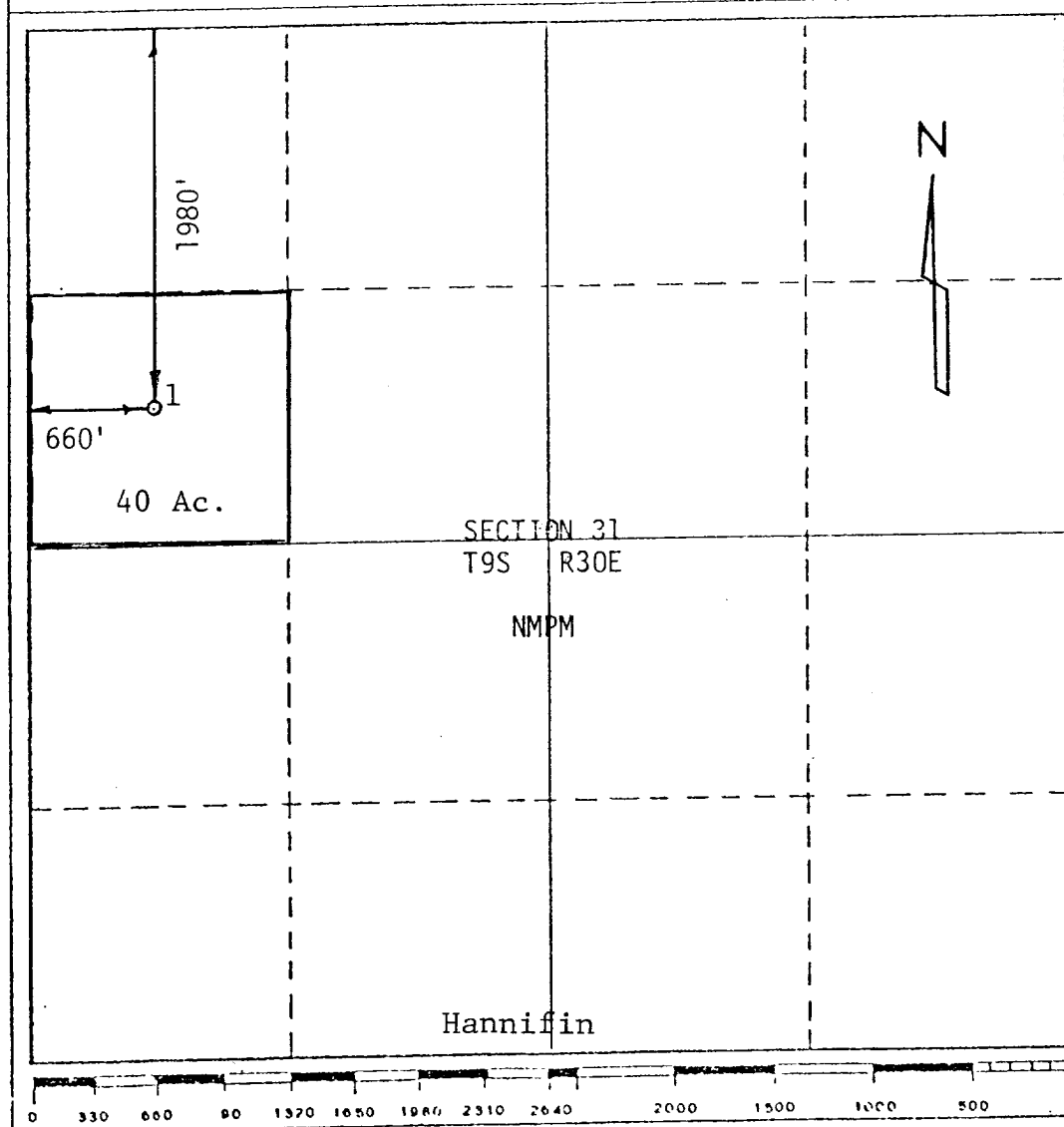

CERTIFICATION

I hereby certify that the information contained herein is true and complete to the best of my knowledge and belief.

W. J. Morris

Name
W. J. Morris
Position
Agent
Company
BRIGHT & COMPANY
Date
11-2-83

I hereby certify that the well location shown on this plat was plotted from field notes of actual surveys made by me or under my supervision, and that the same is true and correct to the best of my knowledge and belief.

10/28/83

Date Surveyed
10/28/83
Registered Professional Engineer and Professional Surveyor
Name **F. Godwin**
Certificate No. **ME 96200WIN**
PE & LS

BRIGHT COMPANY

GULF INSURANCE COMPANY

PRINCIPAL

SURETY

2355 STEMMONS FREEWAY, DALLAS, TX. 75207

3015 CEDAR SPRINGS, DALLAS, TX. 75219

Address

Address

By

Signature

By

JEAN HERRINGTON Attorney-in-Fact

Title

(Note: Principal, if corporation, affix corporate seal here.)

(Note: Corporate surety affix corporate seal here.)

ACKNOWLEDGEMENT FORM FOR NATURAL PERSONS

STATE OF _____)
COUNTY OF _____) ss.

On this 18th day of OCTOBER, 19 83, before me personally appeared _____, to me known to be the person (persons) described in and who executed the foregoing instrument and acknowledged that he (they) executed the same as his (their) free act and deed.

IN WITNESS WHEREOF, I have hereunto set my hand and seal on the day and year in this certificate first above written.

Notary Public

My Commission expires _____

ACKNOWLEDGEMENT FORM FOR CORPORATION

STATE OF _____)
COUNTY OF _____) ss.

On this _____ day of _____, 19____, before me personally appeared _____, to me personally known who, being by me duly sworn, did say that he is _____ of _____ and that the foregoing instrument was signed and sealed on behalf of said corporation by authority of its board of directors, and acknowledged said instrument to be the free act and deed of said corporation.

IN WITNESS WHEREOF, I have hereunto set my hand and seal on the day and year in this certificate first above written.

Notary Public

My Commission expires _____

ACKNOWLEDGEMENT FORM FOR CORPORATE SURETY

STATE OF TEXAS)
COUNTY OF DALLAS) ss.

On this 18th day of OCTOBER, 19 83, before me appeared JEAN HERRINGTON, to me personally known, who, being by me duly sworn, did say that he is ATTORNEY IN FACT of GULF INSURANCE COMPANY and that the foregoing instrument was signed and sealed on behalf of said corporation by authority of its board of directors, and acknowledged said instrument to be the free act and deed of said corporation.

IN WITNESS WHEREOF, I have hereunto set my hand and seal on the day and year in this certificate first above written.

MAY 10, 1985

DELORIS E. BACON Notary Public

My Commission expires _____

(Note: Corporate surety attach power of attorney.)

APPROVED BY:

OIL CONSERVATION DIVISION OF NEW MEXICO

By _____

Date _____

RECEIVED

NOV 7 1983

U.S. DEPT. OF JUSTICE
FEDERAL BUREAU OF INVESTIGATION