

SANTA FE		
FILE		
U.S.G.S.		
LAND OFFICE		
OPERATOR		

3A. Indicate Type of Lease	
STATE <input checked="" type="checkbox"/>	FEL <input type="checkbox"/>
5. State Oil & Gas Lease No.	
LG-2835	

API 30-005-20954

# APPLICATION FOR PERMIT TO DRILL, DEEPEN, OR PLUG BACK

6. Type of Work		
DRILL <input checked="" type="checkbox"/>	DEEPEN <input type="checkbox"/>	PLUG BACK <input type="checkbox"/>
7. Type of Well		
OIL WELL <input type="checkbox"/>	GAS WELL <input type="checkbox"/>	OTHER <input type="checkbox"/>
SINGLE ZONE <input type="checkbox"/>		
MULTIPLE ZONE <input type="checkbox"/>		

7. Unit Agreement Name
8. Farm or Lease Name
J&J State

9. Name of Operator
Ronadero Company, Inc.

9. Well No.
1

10. Address of Operator
Post Office Box 430, Roswell, New Mexico 88201

10. Field and Pool, or Wildcat
Cato No. - San Andres

11. Location of Well
UNIT LETTER 0 LOCATED 1980 FEET FROM THE East LINE
660' FEET FROM THE South LINE OF SEC. 16 TWP. 7-S RGE. 30-E NMPM

12. County
Chaves

13. Proposed Depth		
3650'		
14A. Formation		
San Andres		
20. Rotary or C.T.		
Rotary		

1. Elevations (Show whether D.F., R.T., etc.)
4179'
21A. Kind & Status Plug. Bond
21B. Drilling Contractor
Unassigned
22. Approx. Date Work will start
April 1, 1984

19. Proposed Depth		
3650'		
14A. Formation		
San Andres		
20. Rotary or C.T.		
Rotary		

## 3. PROPOSED CASING AND CEMENT PROGRAM

SIZE OF HOLE	SIZE OF CASING	WEIGHT PER FOOT	SETTING DEPTH	SACKS OF CEMENT	EST. TOP
12 1/4"	8 5/8"	24#	350'	300 sxs.	Circulate
7 7/8"	4 1/2"	9.5#	T.D.	350 sxs.	2400'

Selectively perforate and treat pay zone

Attachments:

Survey Plat (C-102)  
Supplemental Drilling Data

APPROVAL VALID FOR 180 DAYS  
PERMIT EXPIRES 9/27/84  
UNLESS DRILLING UNDERWAY

ABOVE SPACE DESCRIBE PROPOSED PROGRAM: IF PROPOSAL IS TO DEEPEN OR PLUG BACK, GIVE DATA ON PRESENT PRODUCTIVE ZONE AND PROPOSED NEW PRODUCTIVE ZONE. GIVE BLOWOUT PREVENTER PROGRAM, IF ANY.

I hereby certify that the information above is true and complete to the best of my knowledge and belief.

By Robert W. Hanagan Title Drilling Engineer Date March 9, 1984

(This space for State Use)

Eddie W. Seay

MAR 27 1984

APPROVED BY Oil & Gas Inspector TITLE DATE

CONDITIONS OF APPROVAL, IF ANY:

# OIL CONSERVATION DIVISION

STATE OF NEW MEXICO  
ENERGY AND MINERALS DEPARTMENT

P. O. BOX 2088  
SANTA FE, NEW MEXICO 87501

Form C-102  
Revised 10-1-78

All distances must be from the outer boundaries of the Section.

Operator <b>Ronadero Co., Inc.</b>		Lease <b>J.&amp;J. State</b>		Well No. <b>1</b>
Lot Letter <b>0</b>	Section <b>16</b>	Township <b>7 South</b>	Range <b>30 East</b>	County <b>Chaves</b>

Actual Footage Location of Well: <b>660</b> feet from the <b>South</b> line and <b>1980</b> feet from the <b>East</b> line				
Ground Level Elev. <b>4179 MSL</b>	Producing Formation <b>San Andres</b>	Pool <b>Undesignated</b>	Dedicated Acreage: <b>40</b> Acres	

1. Outline the acreage dedicated to the subject well by colored pencil or hachure marks on the plat below. ✓
2. If more than one lease is dedicated to the well, outline each and identify the ownership thereof (both as to working interest and royalty).
3. If more than one lease of different ownership is dedicated to the well, have the interests of all owners been consolidated by communitization, unitization, force-pooling, etc?

☐ Yes ☐ No If answer is "yes," type of consolidation \_\_\_\_\_

If answer is "no," list the owners and tract descriptions which have actually been consolidated. (Use reverse side of this form if necessary.) \_\_\_\_\_

No allowable will be assigned to the well until all interests have been consolidated (by communitization, unitization, forced-pooling, or otherwise) or until a non-standard unit, eliminating such interests, has been approved by the Division.

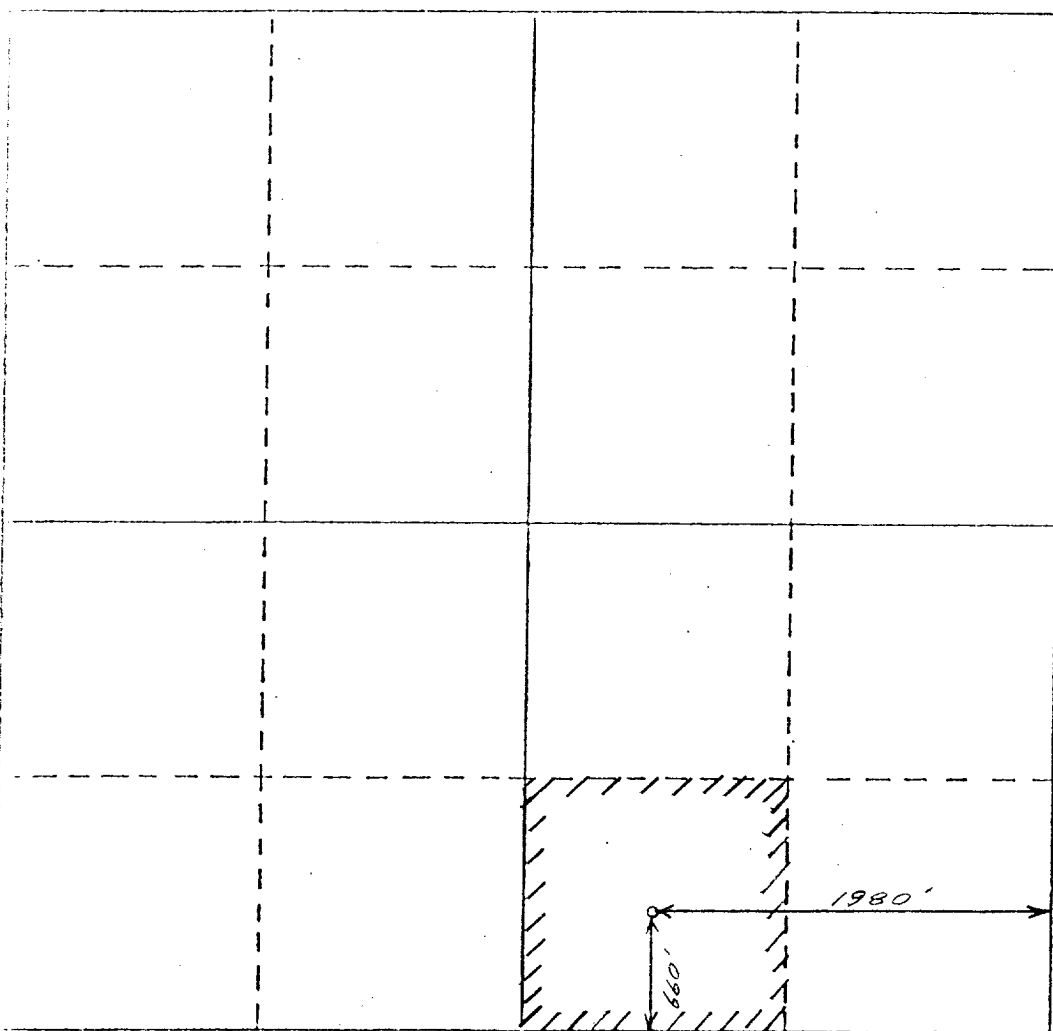

## CERTIFICATION

I hereby certify that the information contained herein is true and complete to the best of my knowledge and belief.

**Robert W. Hanagan**

Name  
**Drilling Engineer**  
Position  
**Ronadero Company, Inc.**  
Company  
**March 9, 1984**  
Date

*Robert W. Hanagan*

I hereby certify that the well location shown on this plat was plotted from field notes of actual surveys made by me or under my supervision, and that the same is true and correct to the best of my knowledge and belief.

**March 9, 1984**

Date Surveyed  
**P.R. Patton**

Registered Professional Engineer and/or Land Surveyor  
**8112**

**8112**

Certificate No.

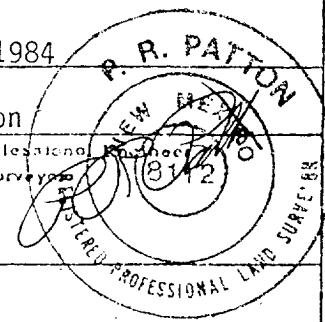

330 660 990 1320 1650 1980 2310 2640 2970 3300 3630 3960 4290 4620 4950 5280 5610 5940 6270 6600

RECEIVED  
MAR 27 1984  
O.C.D.  
HOBBS OFFICE

BLOWOUT PREVENTER

REGAN  
HYDRIL TYPE  
SERIES 900  
6000# TEST

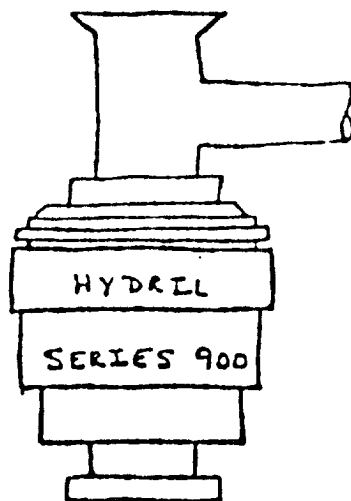

RECEIVED  
MAR 27 1984  
O.C.D.  
HOBBS OFFICE