

## OIL CONSERVATION DIVISION

STATE OF NEW MEXICO  
ENERGY AND MINERALS DEPARTMENTP. O. BOX 2088  
SANTA FE, NEW MEXICO 87501Form C-102  
Revised 10-1-78

All distances must be from the outer boundaries of the Section.

|   |                                   |                        |                                |                  |
|---|-----------------------------------|------------------------|--------------------------------|------------------|
| Operator<br>Ronadero Co., Inc.  |                                   | Lease<br>J. & J. State |                                | Well No.<br>1y   |
| Unit Letter<br>0  | Section<br>16                     | Township<br>7 South    | Range<br>30 East               | County<br>Chaves |
| Actual Footage Location of Well:<br>660 feet from the South line and 2280 feet from the East line |                                   |                        |                                |                  |
| Ground Level Elev.<br>4177  | Producing Formation<br>San Andres | Pool<br>Undesignated   | Dedicated Acreage:<br>40 Acres |                  |

1. Outline the acreage dedicated to the subject well by colored pencil or hatchure marks on the plat below.
2. If more than one lease is dedicated to the well, outline each and identify the ownership thereof (both as to working interest and royalty).
3. If more than one lease of different ownership is dedicated to the well, have the interests of all owners been consolidated by communitization, unitization, force-pooling, etc?

☐ Yes ☐ No If answer is "yes," type of consolidation \_\_\_\_\_

If answer is "no," list the owners and tract descriptions which have actually been consolidated. (Use reverse side of this form if necessary.) \_\_\_\_\_

No allowable will be assigned to the well until all interests have been consolidated (by communitization, unitization, forced-pooling, or otherwise) or until a non-standard unit, eliminating such interests, has been approved by the Division.

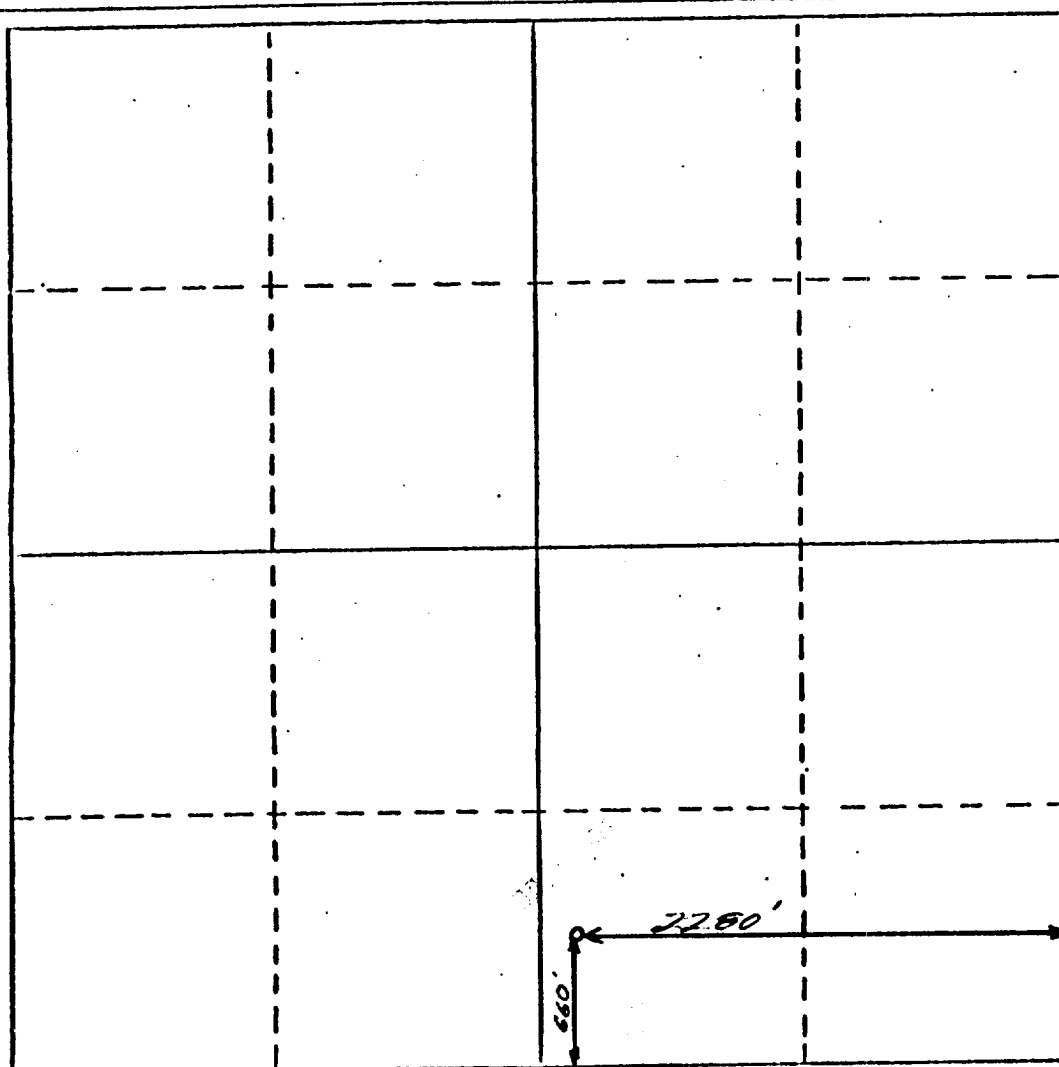

## CERTIFICATION

I hereby certify that the information contained herein is true and complete to the best of my knowledge and belief.

*Robert W. Hanagan*

Name

Robert W. Hanagan

Position

Vice President

Company

Ronadero Company, Inc.

Date

4-9-84

I hereby certify that the well location shown on this plat was plotted from field notes of actual surveys made by me or under my supervision, and that the same is true and correct to the best of my knowledge and belief.

April 9, 1984

Date Surveyed

P.R. Patton

Registered Professional Engineer  
and/or Land Surveyor

8112

Certificate No.

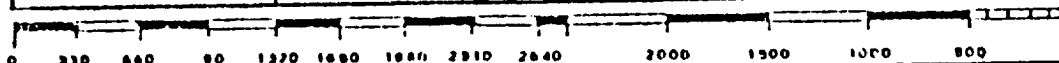
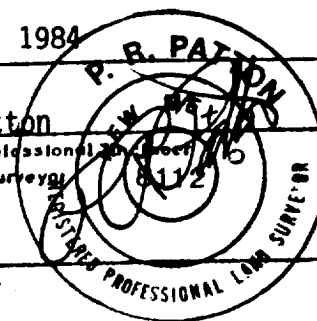

RECEIVED  
APR 11 1984  
C.C.D.  
HOBBS OFFICE