

UNITED STATES
DEPARTMENT OF THE INTERIOR
GEOLOGICAL SURVEYN. M. OIL & GAS COMMISSION
P. O. BOX 150
ROSWELL, NEW MEXICO 88240Form approved.
Budget Bureau No. 42-B1425.

30 005-20939

APPLICATION FOR PERMIT TO DRILL, DEEPEN, OR PLUG BACK

1a. TYPE OF WORK

DRILL ☒DEEPEN ☐PLUG BACK ☐

b. TYPE OF WELL

OIL
WELL ☒GAS
WELL ☐OTHER ☐SINGLE
ZONE ☐MULTIPLE
ZONE ☐

2. NAME OF OPERATOR

Yates Petroleum Corporation

3. ADDRESS OF OPERATOR

207 S. 4th, Artesia, New Mexico 88210

4. LOCATION OF WELL (Report location clearly and in accordance with any State requirements.)*

At surface

2310' FSL and 1650' FEL

At proposed prod. zone

same

14. DISTANCE IN MILES AND DIRECTION FROM NEAREST TOWN OR POST OFFICE*

15 miles south of Kenna, New Mexico

15. DISTANCE FROM PROPOSED*

LOCATION TO NEAREST

PROPERTY OR LEASE LINE, FT.

(Also to nearest drlg. unit line, if any) 1650'

18. DISTANCE FROM PROPOSED LOCATION*

TO NEAREST WELL, DRILLING, COMPLETED,
OR APPLIED FOR, ON THIS LEASE, FT.

16. NO. OF ACRES IN LEASE

320

19. PROPOSED DEPTH

4300'

17. NO. OF ACRES ASSIGNED
TO THIS WELL

40

20. ROTARY OR CABLE TOOLS

Rotary

21. ELEVATIONS (Show whether DF, RT, GR, etc.)

4400' GL

22. APPROX. DATE WORK WILL START*

ASAP

23. 11/17/83

PROPOSED CASING AND CEMENTING PROGRAM

| SIZE OF HOLE | SIZE OF CASING | WEIGHT PER FOOT | SETTING DEPTH | QUANTITY OF CEMENT |
|--------------|----------------|-----------------|---------------|--------------------|
| 12 1/4" | 8 5/8" | 24# J-55 | appr. 1350' | 500 sx circ |
| 7 7/8" | 4 1/2" | 9.5# | TD | 300 sx |

We propose to drill and test the San Andres formations. If commercial, 4 1/2" production casing will be run and cemented with an adequate cover, perforate and stimulate as needed for production.

MUD PROGRAM: Native mud to 1550'. FW to TD.

BOP PROGRAM: BOP's will be installed at 1700' and tested daily.

RECEIVED

NOV 17 1983

IN ABOVE SPACE DESCRIBE PROPOSED PROGRAM: If proposal is to deepen or plug back, give data on present production and proposed new productive zone. If proposal is to drill or deepen directionally, give pertinent data on subsurface locations and measured and true vertical depths. Give blowout preventer program, if any.

24.

SIGNED

TITLE Regulatory Agent

DATE 11/16/83

(This space for Federal or State office use)

PERMIT NO.

APPROVAL DATE

APPROVED BY

TITLE

ACTING District Manager

DATE

11-25-83

CONDITIONS OF APPROVAL, IF ANY:

APPROVAL SUBJECT TO
GENERAL REQUIREMENTS AND
SPECIAL STIPULATIONS
ATTACHED

POSTED: 11/17/83

EXHIBIT B
BOP DIAGRAM
RATED 3000[#]

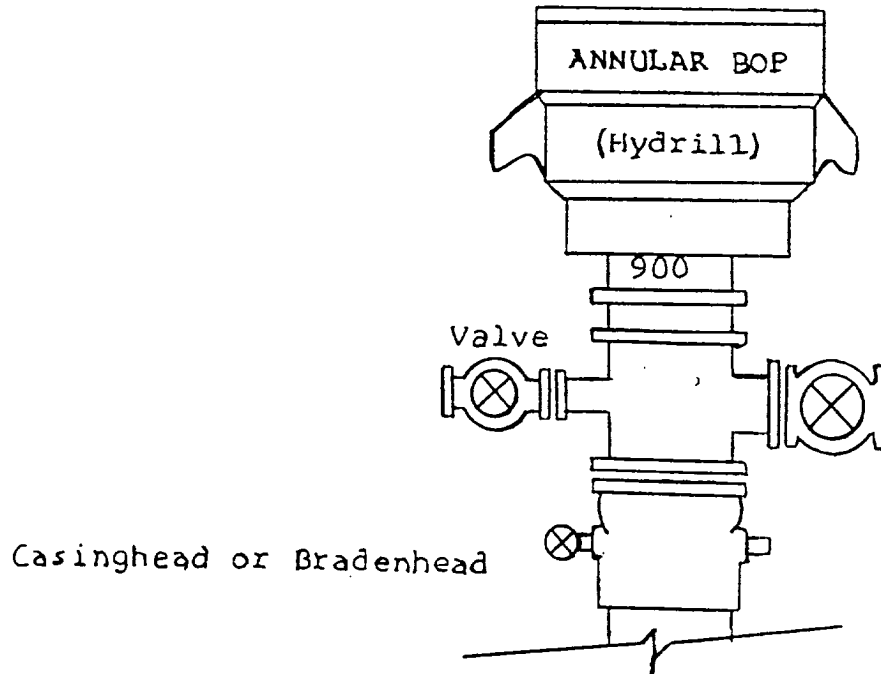

1

RECEIVED

JAN 10 1984

O.C.O.
HOBBS OFFICE

OIL CONSERVATION DIVISION

STATE OF NEW MEXICO
ENERGY AND MINERALS DEPARTMENTP. O. BOX 2048
SANTA FE, NEW MEXICO 87501Form C-102
Revised 10-1-78

All distances must be from the outer boundaries of the Section.

| | | | | | |
|--|--|----------------------------|-----------------------------------|-------------------------|---------------------------------------|
| Operator Yates Petroleum Corporation | | | Lease Centex "X I" | | Well No. Federal #5 |
| Unit Letter J | Section 1 | Township 8 South | Range 31 East | County Chaves | |
| Actual Footage Location of Well: 2310 feet from the South line and 1650 feet from the East line | | | | | |
| Ground Level Elev. 4400.00 | Producing Formation San Andres | | Pool Undes. Tomahawk SA | | Dedicated Acreage: 40 Acres |

1. Outline the acreage dedicated to the subject well by colored pencil or hatchure marks on the plat below.
2. If more than one lease is dedicated to the well, outline each and identify the ownership thereof (both as to working interest and royalty).
3. If more than one lease of different ownership is dedicated to the well, have the interests of all owners been consolidated by communitization, unitization, force-pooling, etc?

☐ Yes ☐ No If answer is "yes," type of consolidation _____

If answer is "no," list the owners and tract descriptions which have actually been consolidated. (Use reverse side of this form if necessary.) _____

No allowable will be assigned to the well until all interests have been consolidated (by communitization, unitization, forced-pooling, or otherwise) or until a non-standard unit, eliminating such interests, has been approved by the Division.

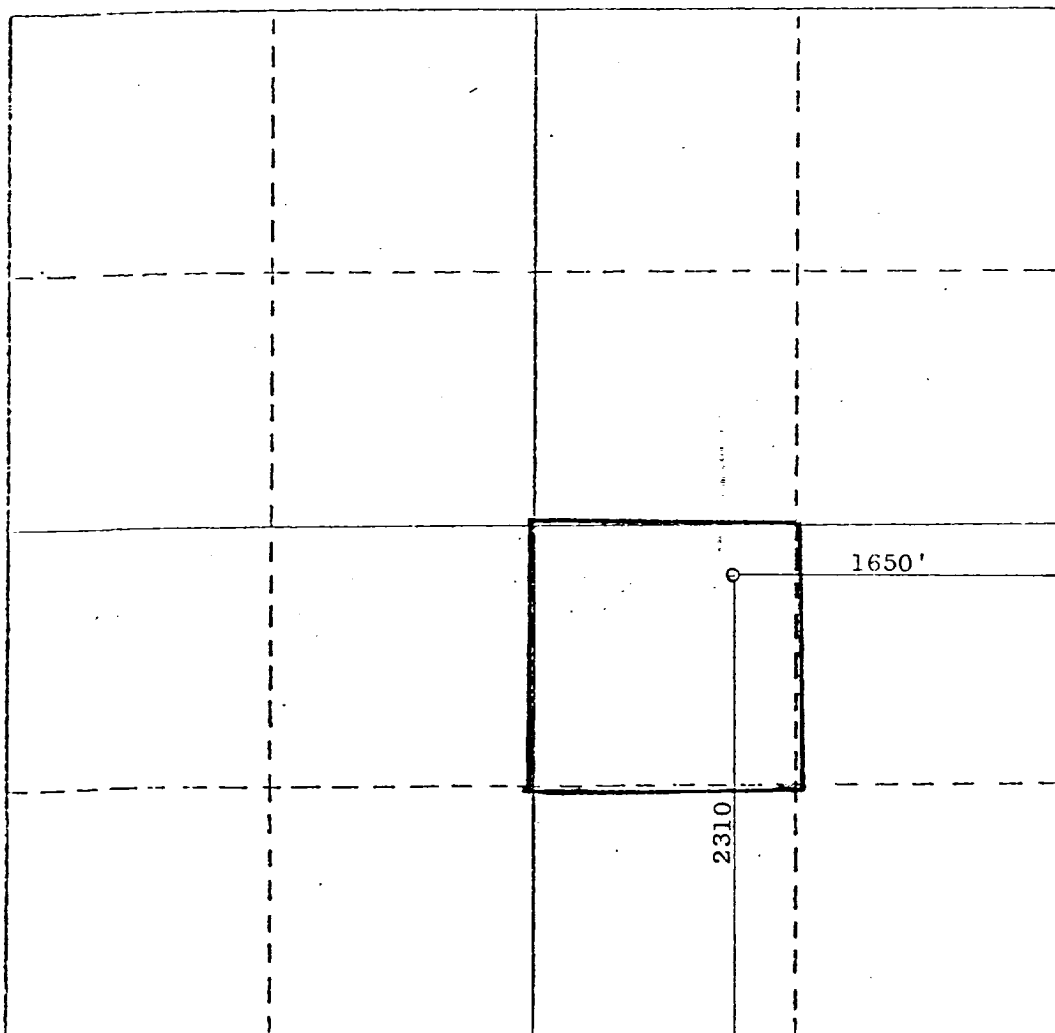

CERTIFICATION

I hereby certify that the information contained herein is true and complete to the best of my knowledge and belief.

 Name
Gliserio Rodriguez

 Position
Regulatory Agent

 Company
Yates Petroleum Corp.

 Date
11/16/83

I hereby certify that the information shown on this plat was obtained from field notes of actual surveys made by me or under my supervision and that the same is true and correct to the best of my knowledge and belief.

November 16, 1983

 Date Surveyed
Jackie D. Atkins
Registered Professional Engineer
and/or Land Surveyor

PE 6403 LS 8504

Certificate No.