

All distances must be from the outer boundaries of the Section.

Operator Petroleum Exploration Company, Inc.		Lease Siete Federal		Well No. 5
Unit Letter	Section 17	Township 8 South	Range 31 East	County Chaves
Actual Footage Location of Well:				
2310 feet from the South		line and 990 feet from the East		line
Ground Level Elev. 4202	Producing Formation Siete - San Andres	Pool Siete - San Andres		Dedicated Acreage: 40 Acres

1. Outline the acreage dedicated to the subject well by colored pencil or hachure marks on the plat below.
2. If more than one lease is dedicated to the well, outline each and identify the ownership thereof (both as to working interest and royalty).
3. If more than one lease of different ownership is dedicated to the well, have the interests of all owners been consolidated by communitization, unitization, force-pooling, etc?

☐ Yes ☐ No If answer is "yes," type of consolidation _____

If answer is "no," list the owners and tract descriptions which have actually been consolidated. (Use reverse side of this form if necessary.) _____

No allowable will be assigned to the well until all interests have been consolidated (by communitization, unitization, forced-pooling, or otherwise) or until a non-standard unit, eliminating such interests, has been approved by the Division.

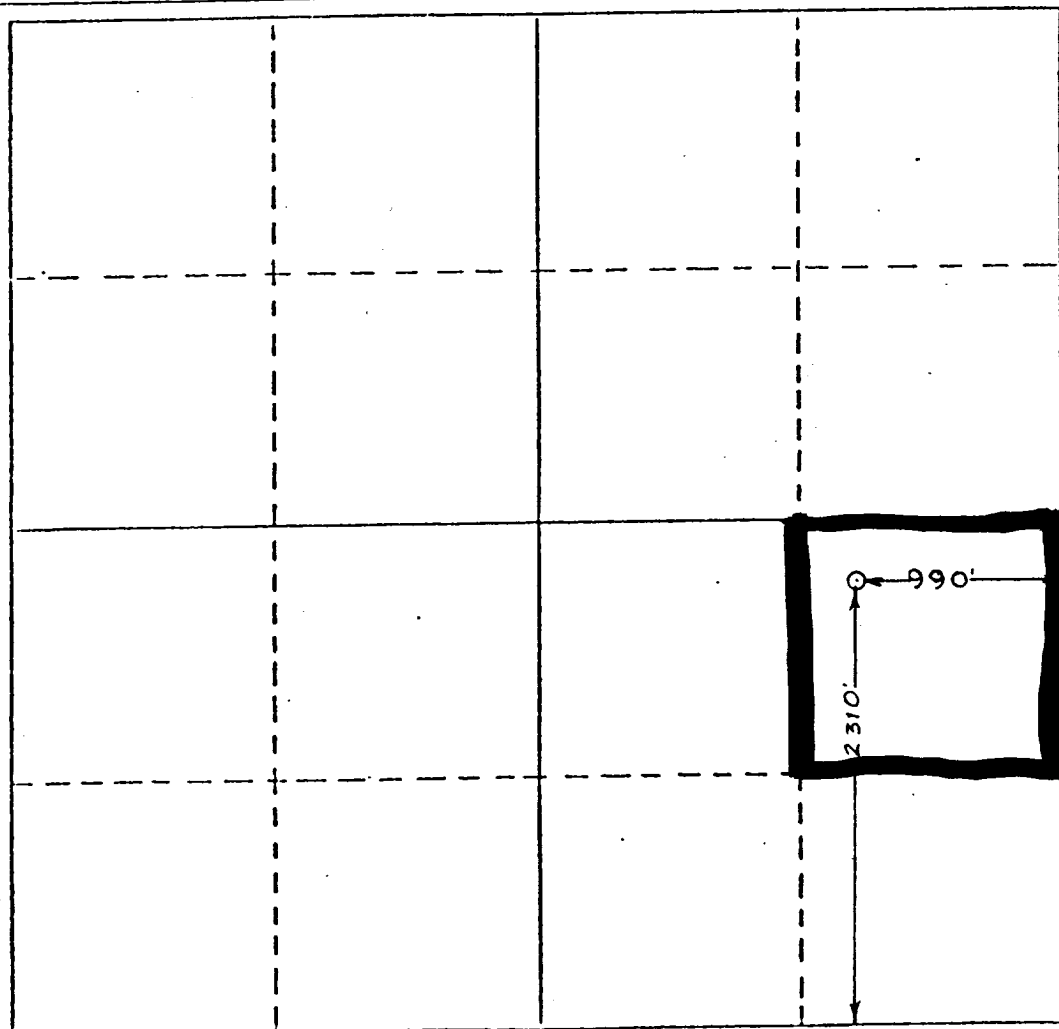

CERTIFICATION

I hereby certify that the information contained herein is true and complete to the best of my knowledge and belief.

Wesley Bogdan
Name **Wesley Bogdan**

Position
Secretary/Treasurer

Company **PETROLEUM EXPLORATION COMPANY, INC.**

Date
July 3, 1984

I hereby certify that the well location shown on this plat was plotted from field notes of actual surveys made by me or under my supervision, and that the same is true and correct to the best of my knowledge and belief.

June 27, 1984

Date Surveyed
P. R. Patton

Registered Professional Land Surveyor and/or Land Curver

8112

Certificate No.

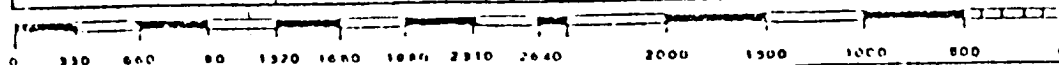
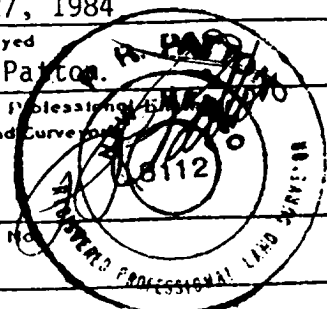

RECEIVED

JUL 16 1984

O.C.S.
NORRIS OFFICE