

(SUBMIT IN TRIPLICATE)

UNITED STATES
DEPARTMENT OF THE INTERIOR
GEOLOGICAL SURVEY

Land Office

Lease No. **LC-061390-A**

Unit

RECEIVED

NOV 4 1959

SUNDRY NOTICES AND REPORTS ON WELLS

NOTICE OF INTENTION TO DRILL	<input checked="" type="checkbox"/>	SUBSEQUENT REPORT OF WATER SHUT-OFF	
NOTICE OF INTENTION TO CHANGE PLANS		SUBSEQUENT REPORT OF SHOOTING OR ACIDIZING	
NOTICE OF INTENTION TO TEST WATER SHUT-OFF		SUBSEQUENT REPORT OF ALTERING CASING	
NOTICE OF INTENTION TO RE-DRILL OR REPAIR WELL		SUBSEQUENT REPORT OF RE-DRILLING OR REPAIR	
NOTICE OF INTENTION TO SHOOT OR ACIDIZE		SUBSEQUENT REPORT OF ABANDONMENT	
NOTICE OF INTENTION TO PULL OR ALTER CASING		SUPPLEMENTARY WELL HISTORY	
NOTICE OF INTENTION TO ABANDON WELL			

(INDICATE ABOVE BY CHECK MARK NATURE OF REPORT, NOTICE, OR OTHER DATA)

Lease No. **163727**
C. E. Key - Federal**November 2**, 19**59**Well No. **1** is located **1980** ft. from **S** line and **1980** ft. from **W** line of sec. **17****NE/4 SW/4 Sec. 17**

(1/4 Sec. and 1/4 Sec. No.)

T-15-S

(Twp.)

R-30-E

(Range)

NMPM

(Meridian)

Wildcat

(Field)

Chaves

(County or Subdivision)

New Mexico

(State or Territory)

The elevation of the derrick floor above sea level is **4037** ft.

DETAILS OF WORK

(State names of and expected depths to objective sands; show sizes, weights, and lengths of proposed casings; indicate mudding jobs, cementing points, and all other important proposed work)

EXPECTED FORMATIONS		SIZE CASING		CASING PROGRAM (Approx.)	
				Set at	Cement
Top Yates	1,390'				
Premier Sand	2,725'	13-3/8"	48#	470'	500 sk.
San Andres	3,875'	9-5/8"	32.3 & 36#	2875'	1700 sk.
Glorieta	4,275'	7"	26, 29 & 32#	12,300'	800 sk.
Tubb	5,575'				
Abo	6,340'				
Welfcamp	7,675'				
Atoka	9,700'				
Lower Miss.	10,450'				
Devonian	11,000'				
Simpson	11,900'				
Killenburger	12,000'				
Total Depth	22,300'				

I understand that this plan of work must receive approval in writing by the Geological Survey before operations may be commenced.

Company **TEKACO Inc.**
P. O. Box 3109
Address **Midland, Texas****TEKACO Inc.**By **J. J. Velten**
J. J. Velten
Title **Division Civil Engineer**

NEW MEXICO OIL CONSERVATION COMMISSION
Well Location and Acreage Dedication Plat

Section A.

Date 10-31-59

Operator TEXACO Inc. Lease C. E. Key-Federal
Well No. 1 Unit Letter K Section 17 Township 15-South Range 30-East NMPM
Located 1980 Feet From South Line, 1980 Feet From West Line
County Chaves G. L. Elevation _____ Dedicated Acreage 40 Acres
Name of Producing Formation Ellenburger Pool Wildcat (on structure) Undesignated

1. Is the Operator the only owner* in the dedicated acreage outlined on the plat below?
Yes _____ No _____.
2. If the answer to question one is "no," have the interests of all the owners been consolidated by communitization agreement or otherwise? Yes _____ No _____. If answer is "yes," Type of Consolidation _____
3. If the answer to question two is "no," list all the owners and their respective interests below:

Owner

Land Description

Section B

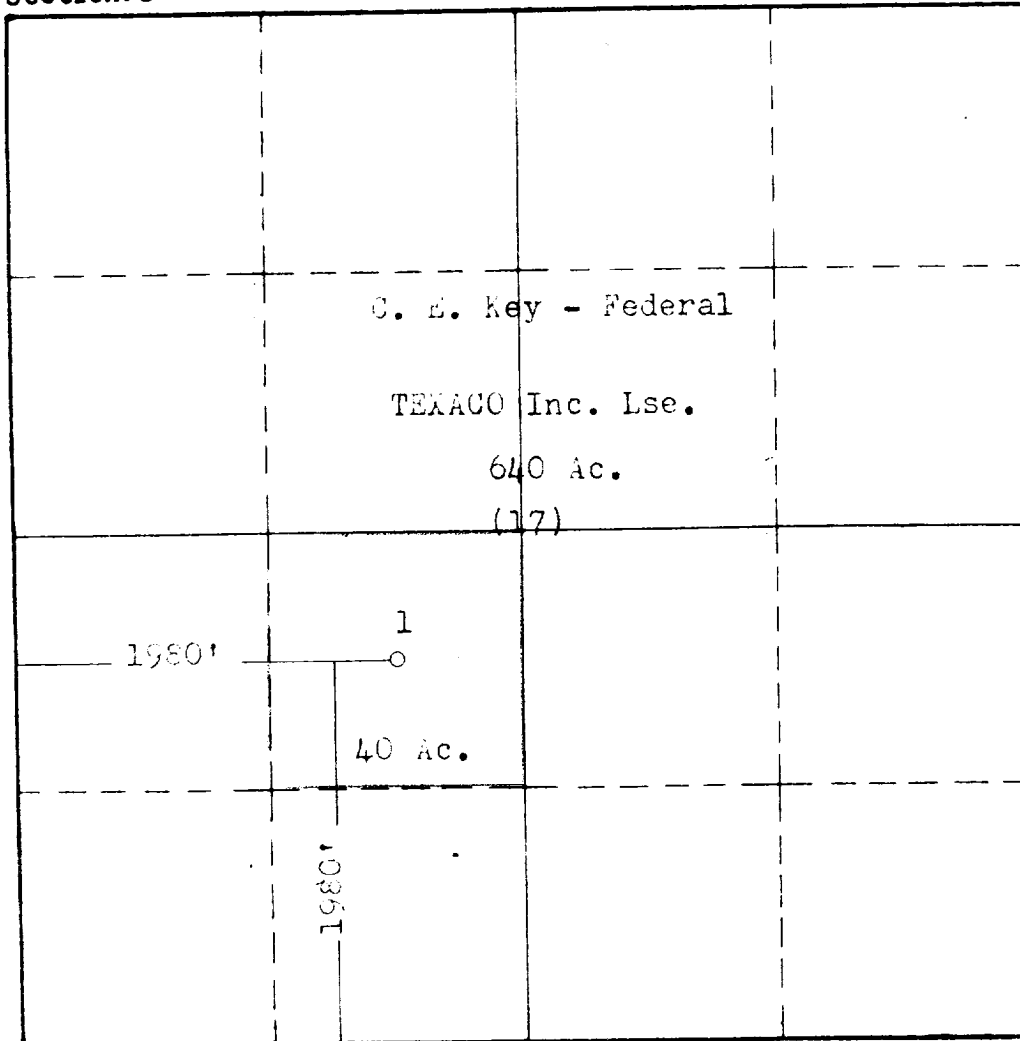

This is to certify that the information in Section A above is true and complete to the best of my knowledge and belief.

TEXACO Inc.

(Operator)

(Representative)

Division Civil Engineer
P.O. Box 3109, Midland, Texas
Address

This is to certify that the well location shown on the plat in Section B was plotted from field notes of actual surveys made by me or under my supervision and that the same is true and correct to the best of my knowledge and belief.

Date Surveyed 10-31-59

Registered Professional
Engineer and/or Land Surveyor.

Certificate No. 811X