

OIL CONSERVATION DIVISION

DISTRICT I
P.O. Box 1980, Hobbs, NM 88240

P.O. Box 2088

Santa Fe, New Mexico 87504-2088

DISTRICT II
P.O. Drawer DD, Artesia, NM 88210

DISTRICT III
1000 Rio Brazos Rd., Aztec, NM 87410

WELL LOCATION AND ACREAGE DEDICATION PLAT

All Distances must be from the outer boundaries of the section

Operator Anadarko Petroleum Corporation			Lease Dalport-Arco Federal Com		Well No. 1
Unit Letter G	Section 7	Township 14S	Range 31E	County Chaves	
Actual Footage Location of Well: 1980 feet from the North line and 1980 feet from the East line					
Ground level Elev. 4029.8'		Producing Formation Queen		Pool Chaves Queen Gas Area, Asso.	Dedicated Acreage: 316.6 (±) Acres

1. Outline the acreage dedicated to the subject well by colored pencil or hachure marks on the plat below.
2. If more than one lease is dedicated to the well, outline each and identify the ownership thereof (both as to working interest and royalty).
3. If more than one lease of different ownership is dedicated to the well, have the interest of all owners been consolidated by communitization, unitization, force-pooling, etc?
☒ Yes ☐ No If answer is "yes" type of consolidation Communitization
If answer is "no" list the owners and tract descriptions which have actually been consolidated. (Use reverse side of this form if necessary).
No allowable will be assigned to the well until all interests have been consolidated (by communitization, unitization, forced-pooling, or otherwise) or until a non-standard unit, eliminating such interest, has been approved by the Division.

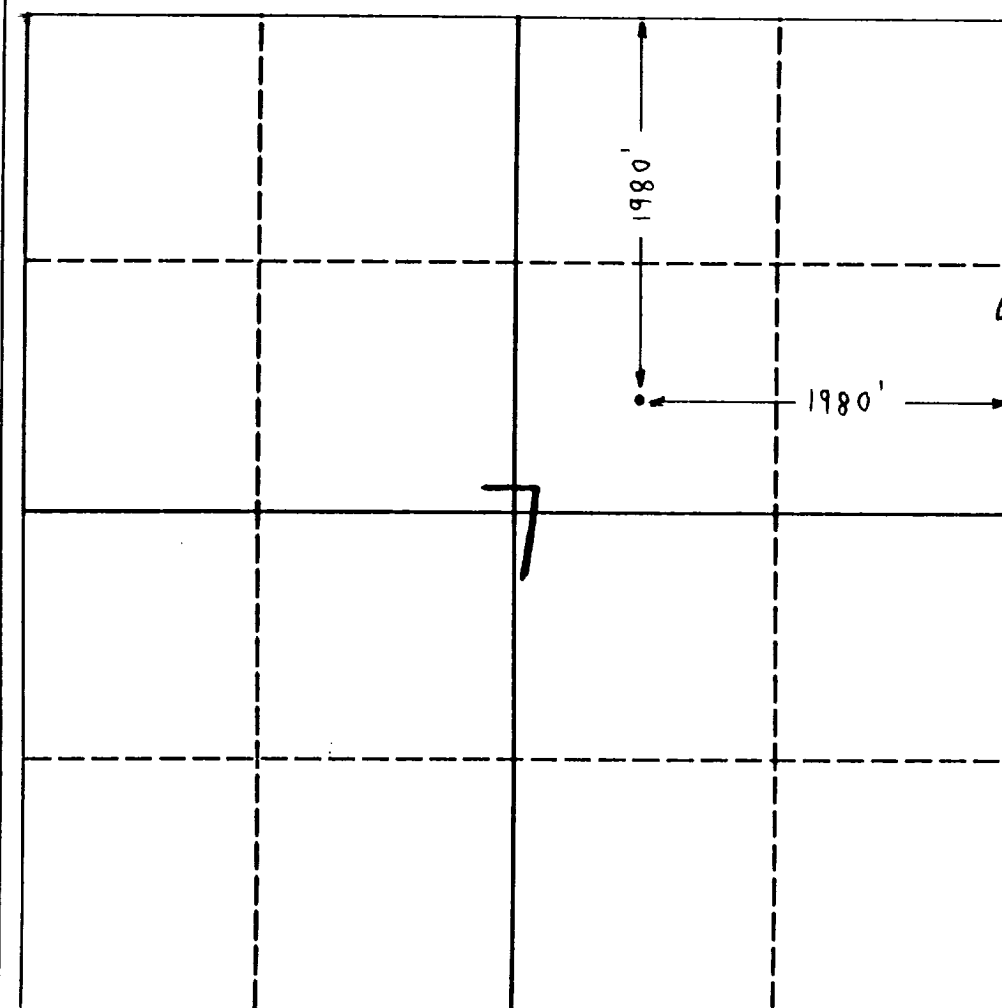

OPERATOR CERTIFICATION

I hereby certify that the information contained herein is true and complete to the best of my knowledge and belief.

Signature *Jerry E. Buckles*
Printed Name **Jerry E. Buckles**
Position **Area Supervisor**
Company **Anadarko Petroleum Corp.**
Date **April 20, 1992**

SURVEYOR CERTIFICATION

I hereby certify that the well location shown on this plat was plotted from field notes of actual surveys made by me or under my supervision, and that the same is true and correct to the best of my knowledge and belief.

Date Surveyed
Signature & Seal of Professional Surveyor

Certificate No.

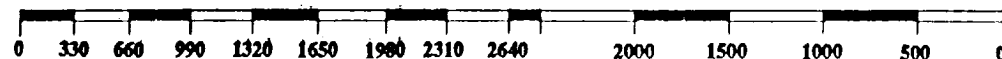

UNITED STATES
DEPARTMENT OF THE INTERIOR
GEOLOGICAL SURVEY

SUNDRY NOTICES AND REPORTS ON WELLS

(Do not use this form for proposals to drill or to deepen or plug back to a different reservoir. Use Form 9-331-C for such proposals.)

1. oil ☐ well gas ☒ well other ☐
2. NAME OF OPERATOR
Dalport Oil Corp.
3. ADDRESS OF OPERATOR
3471 InterFirst One, Dallas, Tx. 75202
4. LOCATION OF WELL (REPORT LOCATION CLEARLY. See space 17 below.)
AT SURFACE: 1980' FW&EL
AT TOP PROD. INTERVAL: Same
AT TOTAL DEPTH: Same

16. CHECK APPROPRIATE BOX TO INDICATE NATURE OF NOTICE, REPORT, OR OTHER DATA

REQUEST FOR APPROVAL TO: SUBSEQUENT REPORT OF:
TEST WATER SHUT-OFF ☐ ☐
FRACTURE TREAT ☐ ☐
SHOOT OR ACIDIZE ☐ ☐
REPAIR WELL ☐ ☐
PULL OR ALTER CASING ☐ ☐
MULTIPLE COMPLETE ☐ ☐
CHANGE ZONES ☐ ☐
ABANDON* ☐ ☐

(other) Subsequent change from 40 ac. to 160 ac. spacing.

17. DESCRIBE PROPOSED OR COMPLETED OPERATIONS (Clearly state all pertinent details, and give pertinent dates, including estimated date of starting any proposed work. If well is directionally drilled, give subsurface locations and measured and true vertical depths for all markers and zones pertinent to this work.)*

Well was completed 1-27-85 as a shut-in Queen gas well. As we are 4 miles from a pipeline, well will remain shut-in for a long duration.

We are requesting from the Oil Conservation Commission permission to use 160 acre gas spacing, rather than 320 acre spacing.

5. LEASE NM 0349837	
6. IF INDIAN, ALLOTTEE OR TRIBE NAME	
7. UNIT AGREEMENT NAME	
8. FARM OR LEASE NAME Arco-Federal	
9. WELL NO. 1	
10. FIELD OR WILDCAT NAME W. Heat	
11. SEC., T., R., M., OR BLK. AND SURVEY OR AREA 7-14 X-31E	
12. COUNTY OR PARISH Chaves	13. STATE NM
14. API NO.	
15. ELEVATIONS (SHOW DF, KDB, AND WD)	

(NOTE: Report results of multiple completion or zone change on Form 9-330.)

Subsurface Safety Valve: Manu. and Type _____ Set @ _____ Ft.

18. I hereby certify that the foregoing is true and correct

SIGNED Peter W. Chester TITLE Geologist DATE 6-18-85

(This space for Federal or State office use)

APPROVED BY _____ TITLE _____ DATE _____
CONDITIONS OF APPROVAL, IF ANY:

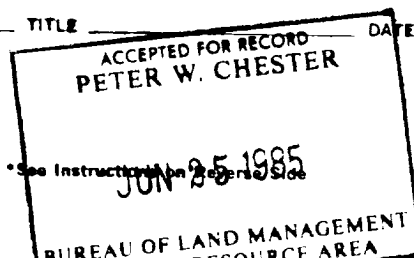

**NEW MEXICO OIL CONSERVATION COMMISSION
WELL LOCATION AND ACREAGE DEDICATION PLAT**

Form C-102
Supersedes C-128
Effective 1-1-65

All distances must be from the outer boundaries of the Section

Operator Dalport Oil Corp.			Lease Arco Federal		Well No. 1
Unit Letter G	Section 7	Township 14S	Range 31E	County Chaves	
Actual Footage Location of Well: 1980 feet from the East line and 1980 feet from the North line					
Ground Level Elev. 4045.0 4019.8	Producing Formation Queen	Pool Wildcat		Dedicated Acreage: 40 Acres	

1. Outline the acreage dedicated to the subject well by colored pencil or hachure marks on the plat below.
2. If more than one lease is dedicated to the well, outline each and identify the ownership thereof (both as to working interest and royalty).
3. If more than one lease of different ownership is dedicated to the well, have the interests of all owners been consolidated by communitization, unitization, force-pooling, etc?

☐ Yes ☐ No If answer is "yes," type of consolidation _____

If answer is "no," list the owners and tract descriptions which have actually been consolidated. (Use reverse side of this form if necessary.) _____

No allowable will be assigned to the well until all interests have been consolidated (by communitization, unitization, forced-pooling, or otherwise) or until a non-standard unit, eliminating such interests, has been approved by the Commission.

Anadarko Produc. Co.	(A R C O)
NM 35611	NM 0349837
Dalport NM 36619	(A R C O)



CERTIFICATION	
I hereby certify that the information contained herein is true and complete to the best of my knowledge and belief.	
<i>Leon M. Lampert</i>	
Name	Leon M. Lampert
Position	Geologist
Company	Dalport Oil Corp.
Date	10-29-84
I hereby certify that the well location shown on this plat was plotted from field notes of actual surveys made by me or under my supervision, and that the same is true and correct to the best of my knowledge and belief.	
Date Surveyed	Oct. 20, 1984
Registered Professional Engineer and/or Land Surveyor	
<i>John W. West</i>	

RECEIVED

JUN 26 1985

CLC
HOBBS OFFICE