

NO. OF COPIES RECEIVED	
DISTRIBUTION	
SANTA FE	
FILE	
U.S.G.S.	
LAND OFFICE	
OPERATOR	

NEW MEXICO OIL CONSERVATION COMMISSION

Form C-103
Supersedes Old
C-102 and C-103
Effective 1-1-65

5a. Indicate Type of Lease State <input checked="" type="checkbox"/> Fee <input type="checkbox"/>
5. State Oil & Gas Lease No. LG 2405

SUNDRY NOTICES AND REPORTS ON WELLS

(DO NOT USE THIS FORM FOR PROPOSALS TO DRILL OR TO DEEPEN OR PLUG BACK TO A DIFFERENT RESERVOIR.
USE "APPLICATION FOR PERMIT -" (FORM C-101) FOR SUCH PROPOSALS.)

1. OIL WELL <input checked="" type="checkbox"/> GAS WELL <input type="checkbox"/> OTHER <input type="checkbox"/>	7. Unit Agreement Name
2. Name of Operator Tom L. Ingram	8. Farm or Lease Name Harris-State
3. Address of Operator P.O. Box 1757, Roswell, New Mexico 88201	9. Well No. 1-Y
4. Location of Well UNIT LETTER P 560 FEET FROM THE South LINE AND 660 FEET FROM East LINE, SECTION 26 TOWNSHIP 8-S RANGE 32-E NMPM.	10. Field and Pool, or Wildcat W. Tobac-San Andres
15. Elevation (Show whether DF, RT, GR, etc.) 4444 GR	12. County Chaves

16.

Check Appropriate Box To Indicate Nature of Notice, Report or Other Data

NOTICE OF INTENTION TO:

PERFORM REMEDIAL WORK ☐
TEMPORARILY ABANDON ☐
PULL OR ALTER CASING ☐

PLUG AND ABANDON ☐
CHANGE PLANS ☐

OTHER ☐

SUBSEQUENT REPORT OF:

REMEDIAL WORK ☐
COMMENCE DRILLING OPNS. ☐
CASING TEST AND CEMENT JOB ☒
OTHER ☐

ALTERING CASING ☐
PLUG AND ABANDONMENT ☐

17. Describe Proposed or Completed Operations (Clearly state all pertinent details, and give pertinent dates, including estimated date of starting any proposed work) SEE RULE 1703.

1-4-85 TD 4330 - Ran 123 jts, 4345', 5 1/2", 14#, J-55, csg.
Cemented @ 4330' w/200 sxs Class C, 50-50 poz, 2% gel, 6# salt.

1-7-85 WOC 48 hrs. Plug back TD 4284'. Tested csg w/1000# for 30 min.
No pressure loss.

18. I hereby certify that the information above is true and complete to the best of my knowledge and belief.

SIGNED Eleanor M. Glass

TITLE Clerk

DATE 1-8-85

ORIGINAL SIGNED BY JERRY SEXTON
DISTRICT I SUPERVISOR

APPROVED BY

TITLE

DATE

CONDITIONS OF APPROVAL, IF ANY:

JAN 14 1985

NO. OF COPIES RECEIVED	
DISTRIBUTION	
SANTA FE	
FILE	
U.S.G.S.	
LAND OFFICE	
OPERATOR	

NEW MEXICO OIL CONSERVATION COMMISSION

Form C-103
Supersedes Old
C-102 and C-103
Effective 1-1-65

5a. Indicate Type of Lease	
State <input checked="" type="checkbox"/>	Fee <input type="checkbox"/>
5. State Oil & Gas Lease No.	
LG 2405	
7. Unit Agreement Name	
8. Farm or Lease Name	
Harris-State	
9. Well No.	
1-Y	
10. Field and Pool, or Wildcat	
W. Tobac-San Andres	
12. County	
Chaves	

SUNDRY NOTICES AND REPORTS ON WELLS (DO NOT USE THIS FORM FOR PROPOSALS TO DRILL OR TO DEEPEN OR PLUG BACK TO A DIFFERENT RESERVOIR. USE "APPLICATION FOR PERMIT" (FORM C-101) FOR SUCH PROPOSALS.)

1. OIL WELL <input checked="" type="checkbox"/> GAS WELL <input type="checkbox"/> OTHER <input type="checkbox"/>	2. Name of Operator	3. Address of Operator	4. Location of Well	15. Elevation (Show whether DF, RT, GR, etc.)
	Tom L. Ingram	P. O. Box 1757, Roswell, New Mexico 88201	UNIT LETTER P 560 FEET FROM THE South LINE AND 660 FEET FROM THE East LINE, SECTION 26 TOWNSHIP 8-S RANGE 32-E NMPM.	4444 GR
16. Check Appropriate Box To Indicate Nature of Notice, Report or Other Data				12. County
NOTICE OF INTENTION TO:				Chaves
PERFORM REMEDIAL WORK <input type="checkbox"/> TEMPORARILY ABANDON <input type="checkbox"/> PULL OR ALTER CASING <input type="checkbox"/> OTHER <input type="checkbox"/>				
PLUG AND ABANDON <input type="checkbox"/> CHANGE PLANS <input type="checkbox"/> OTHER <input type="checkbox"/>				
SUBSEQUENT REPORT OF: REMEDIAL WORK <input type="checkbox"/> COMMENCE DRILLING OPNS. <input checked="" type="checkbox"/> CASING TEST AND CEMENT JOBS <input checked="" type="checkbox"/> OTHER <input type="checkbox"/>				
17. Describe Proposed or Completed Operations (Clearly state all pertinent details, and give pertinent dates, including estimated date of starting any proposed work) SEE RULE 1103.				

12-26-84 WEK Drilling commenced drilling @ 40' at 6:45 pm. MST

12-27-84 Drilling at 964' in red beds.

12-28-84 Drilled to depth of 1793' in anhydrite. Ran 47 jts, 1815.43', 8-5/8", 24-23#, K-55, 8rd ST&C new casing. Set at 1788' from K.B. Halliburton Services cemented with 650 sx "Lite" w/ 2% CACL & 1/4# Flocele and 200 sx class "C" w/ 2% CACL. Circulated 210 sx.

12-29-84 WOC 12 hrs, drilled out cement to 1793 feet, tested casing with 1000# for 30 minutes. No loss in pressure.

18. I hereby certify that the information above is true and complete to the best of my knowledge and belief.

SIGNED Joseph L. Ingram TITLE Engineer DATE 12-29-84

ORIGINAL SIGNED BY JERRY SEXTON
APPROVED BY DISTRICT 1 SUPERVISOR TITLE _____ DATE JAN - 2 1985

CONDITIONS OF APPROVAL, IF ANY:

RECEIVED

SEP 21 1984

A.C.D.
HHS OFFICE

NO. OF COPIES RECEIVED	
DISTRIBUTION	
SANTA FE	
FILE	
U.S.G.S.	
LAND OFFICE	
OPERATOR	

NEW MEXICO OIL CONSERVATION COMMISSION

Form C-103
Supersedes Old
C-102 and C-103
Effective 1-1-65

5a. Indicate Type of Lease State <input checked="" type="checkbox"/> Fee <input type="checkbox"/>
5. State Oil & Gas Lease No. LG 2405
7. Unit Agreement Name
8. Farm or Lease Name Harris-State
9. Well No. 1-Y
10. Field and Pool, or Wildcat West Tobac San Andres
12. County Chaves

SUNDRY NOTICES AND REPORTS ON WELLS
(DO NOT USE THIS FORM FOR PROPOSALS TO DRILL OR TO DEEPEN OR PLUG BACK TO A DIFFERENT RESERVOIR. USE "APPLICATION FOR PERMIT -" (FORM C-101) FOR SUCH PROPOSALS.)

1. OIL WELL ☒ GAS WELL ☐ OTHER- ☐

2. Name of Operator
Tom L. Ingram

3. Address of Operator
P. O. Box 1757, Roswell, NM 88201

4. Location of Well
UNIT LETTER P 560 FEET FROM THE South LINE AND 660 FEET FROM
THE East LINE, SECTION 26 TOWNSHIP 8-S RANGE 32-E N.M.P.M.

15. Elevation (Show whether DF, RT, GR, etc.)
4444 GR

16. Check Appropriate Box To Indicate Nature of Notice, Report or Other Data

NOTICE OF INTENTION TO:	SUBSEQUENT REPORT OF:
PERFORM REMEDIAL WORK <input type="checkbox"/>	REMEDIAL WORK <input type="checkbox"/>
TEMPORARILY ABANDON <input type="checkbox"/>	COMMENCE DRILLING OPNS. <input type="checkbox"/>
PULL OR ALTER CASING <input type="checkbox"/>	CASING TEST AND CEMENT JOBS <input type="checkbox"/>
OTHER <input type="checkbox"/>	OTHER <input checked="" type="checkbox"/>
PLUG AND ABANDON <input type="checkbox"/>	ALTERING CASING <input type="checkbox"/>
CHANGE PLANS <input type="checkbox"/>	PLUG AND ABANDONMENT <input type="checkbox"/>

17. Describe Proposed or Completed Operations (Clearly state all pertinent details, and give pertinent dates, including estimated date of starting any proposed work) SEE RULE 1103.

12-8-84 Finished plugging No. 1
12-10 to 12-84 Building new pad and cellar 100' south of No. 1
12-11-84 Desert Drilling, Inc. (contractor on junked hole) verbally refused to honor contract and commence drilling new hole.
12-12-84 New location and cellar completed
12-12 to 21-84 Attempting to find available rig.
12-18-84 Received release from Desert.
12-18 to 22-84 Unable to move rig off because of snow and rain
12-23-84 Moving in B&A to commence drilling 12½" hole

18. I hereby certify that the information above is true and complete to the best of my knowledge and belief.

SIGNED Tom L. Ingram TITLE Operator DATE 12-23-84

ORIGINAL SIGNED BY JERRY SEXTON TITLE DISTRICT I SUPERVISOR DATE DEC 31 1984

APPROVED BY TITLE DATE

CONDITIONS OF APPROVAL, IF ANY:

RECEIVED

DEC 28 1984

**U.S.D.
HCCBS OFFICE**

NO. OF COPIES RECEIVED

DISTRIBUTION

SANTA FE

FILE

U.S.G.S.

LAND OFFICE

OPERATOR

NEW MEXICO OIL CONSERVATION COMMISSION

Form C-103
Supersedes Old
C-102 and C-103
Effective 1-1-85

5a. Indicate Type of Lease

State ☒

Fee ☐

5. State Oil & Gas Lease No.

LG-2405

SUNDRY NOTICES AND REPORTS ON WELLS

(DO NOT USE THIS FORM FOR PROPOSALS TO DRILL OR TO DEEPEN OR PLUG BACK TO A DIFFERENT RESERVOIR. USE "APPLICATION FOR PERMIT -" (FORM C-101) FOR SUCH PROPOSALS.)

1.

OIL WELL ☒

GAS WELL ☐

OTHER-

2. Name of Operator

Tom L. Ingram

3. Address of Operator

P. O. Box 1757, Roswell, NM 88201

4. Location of Well

UNIT LETTER P, 560 FEET FROM THE South LINE AND 660 FEET FROM

THE East LINE, SECTION 26 TOWNSHIP 8-S RANGE 32-E NMPM.

7. Unit Agreement Name

8. Farm or Lease Name

Harris-State

9. Well No.

1-Y

10. Field and Pool, or Wildcat

West Tobac-San Andres

16.

Check Appropriate Box To Indicate Nature of Notice, Report or Other Data

NOTICE OF INTENTION TO:

SUBSEQUENT REPORT OF:

PERFORM REMEDIAL WORK ☐

PLUG AND ABANDON ☐

REMEDIAL WORK ☐

ALTERING CASING ☐

TEMPORARILY ABANDON ☐

COMMENCE DRILLING OPNS. ☒

PLUG AND ABANDONMENT ☐

PULL OR ALTER CASING ☐

CHANGE PLANS ☐

CASING TEST AND CEMENT JOB ☐

OTHER ☐

17. Describe Proposed or Completed Operations (Clearly state all pertinent details, and give pertinent dates, including estimated date of starting any proposed work) SEE RULE 1103.

12-23-84 Commenced drill 12 1/4" hole. Drilled to 7'
12-24-84 Drilled to 25' in sand and caliche
12-25-84 Drilled to 40' in red beds
12-26-84 Moved-off B&A. Drilled rat hole and mouse hole. Moved-in WEK Drilling Co. rig #3.

18. I hereby certify that the information above is true and complete to the best of my knowledge and belief.

SIGNED Tom L. Ingram

TITLE Operator

DATE 12-26-84

ORIGINAL SIGNED BY JERRY SEXTON
DISTRICT 1 SUPERVISOR

APPROVED BY _____

TITLE _____

DATE DEC 28 1984

CONDITIONS OF APPROVAL, IF ANY:

-30-005-21005

NO. OF COPIES RECEIVED	
DISTRIBUTION	
SANTA FE	
FILE	
U.S.G.S.	
LAND OFFICE	
OPERATOR	

NEW MEXICO OIL CONSERVATION COMMISSION

Form C-101
Revised 1-1-65

5A. Indicate Type of Lease	
STATE <input checked="" type="checkbox"/>	FEE <input type="checkbox"/>
5. State Oil & Gas Lease No.	
LG 2405	

APPLICATION FOR PERMIT TO DRILL, DEEPEN, OR PLUG BACK

1a. Type of Work	
b. Type of Well OIL WELL <input checked="" type="checkbox"/> GAS WELL <input type="checkbox"/> OTHER <input type="checkbox"/>	
DRILL <input checked="" type="checkbox"/> DEEPEN <input type="checkbox"/> PLUG BACK <input type="checkbox"/>	
2. Name of Operator	
Tom L. Ingram	
3. Address of Operator	
P. O. Box 1757, Roswell, New Mexico 88201	
4. Location of Well	
UNIT LETTER P LOCATED 560 FEET FROM THE South LINE	
AND 660 FEET FROM THE East LINE OF SEC. 26 TWP. 8-S RGE. 32-E NMPM	
19. Proposed Depth	
4400	
19A. Formation	
San Andres	
20. Rotary or C.T.	
Rotary	
21. Elevations (Show whether DF, RT, etc.)	
4444 GR	
21A. Kind & Status Plug. Bond	
Statewide	
21B. Drilling Contractor	
Desert Drilling	
22. Approx. Date Work will start	
12-11-84	

7. Unit Agreement Name
8. Farm or Lease Name
Harris-State
9. Well No.
1-Y
10. Field and Pool, or Wildcat
West Tobac San Andres
12. County
Chaves

23.

PROPOSED CASING AND CEMENT PROGRAM

SIZE OF HOLE	SIZE OF CASING	WEIGHT PER FOOT	SETTING DEPTH	SACKS OF CEMENT	EST. TOP
12 1/4	8-5/8	23# & 24#	1780	1100	circ
7-7/8	5-1/2	14	4400	300	

Propose to move 100' south of No. 1 because of junked hole (1939' of drill pipe, drill collars, bit sub, and 7-7/8" bit in hole).

Drill to TD, log, run csg, cmt, perforate, stimulate and complete.
BOP will be used.

Permit Expires 6 Months From Approval
Date Unless Drilling Underway.

IN ABOVE SPACE DESCRIBE PROPOSED PROGRAM; IF PROPOSAL IS TO DEEPEN OR PLUG BACK, GIVE DATA ON PRESENT PRODUCTIVE ZONE AND PROPOSED NEW PRODUCTIVE ZONE. GIVE BLOWOUT PREVENTER PROGRAM, IF ANY.

I hereby certify that the information above is true and complete to the best of my knowledge and belief.

Signed Wayne L. Ingram Title Engineer Date 12-10-84

(This space for State Use)
ORIGINAL SIGNED BY JERRY SEXTON
DISTRICT 1 SUPERVISOR

APPROVED BY _____ TITLE _____ DATE _____

CONDITIONS OF APPROVAL, IF ANY:

DEC 11 1984

All distances must be from the outer boundaries of the Section

Name Tom L. Ingram		Lease Harris-State		Well No. 1-Y
Section 26	Township 8 South	Range 32 East	County Chaves	
Distance from the location of well: 560.0 feet from the south line and 660.0 feet from the east line Dedicated Acres: 40 Pool: Wildcat Producing Formation: San Andres Well Depth (feet): 4444				

1. Outline the acreage dedicated to the subject well by colored pencil or hatchure marks on the plat below.

2. If more than one lease is dedicated to the well, outline each and identify the ownership thereof (both as to working interest and royalty).

3. If more than one lease of different ownership is dedicated to the well, have the interests of all owners been consolidated by communitization, unitization, force-pooling, etc?

☐ Yes ☐ No If answer is "yes," type of consolidation _____

If answer is "no," list the owners and tract descriptions which have actually been consolidated. (Use reverse side of this form if necessary.) _____

No allowable will be assigned to the well until all interests have been consolidated (by communitization, unitization, forced-pooling, or otherwise) or until a non-standard unit, eliminating such interests, has been approved by the Division.

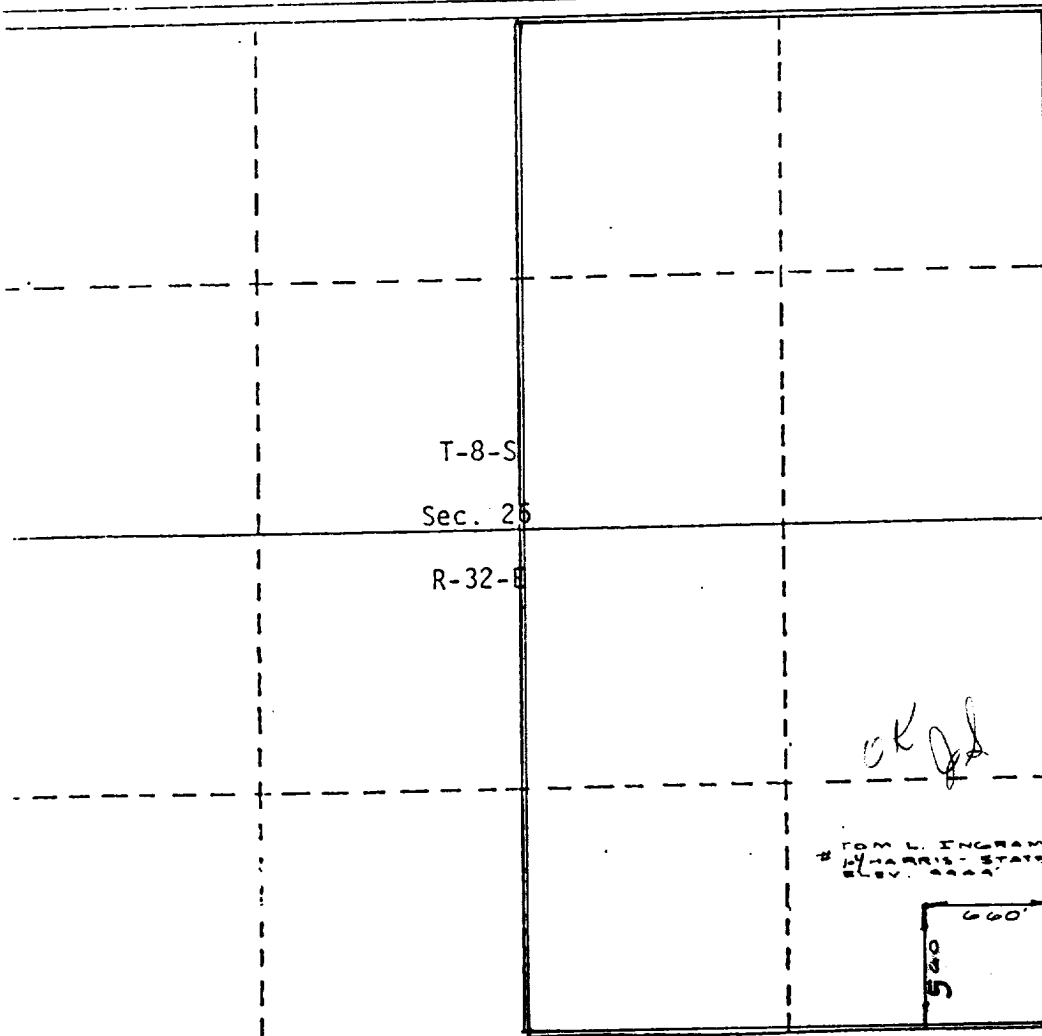

CERTIFICATION

I hereby certify that the information contained herein is true and complete to the best of my knowledge and belief.

Joseph T. Ingram

Name
Joseph T. Ingram

Position
Engineer

Company
Tom L. Ingram

Date
12-10-84

I hereby certify that the well location shown on this plat was plotted from field notes of actual surveys made by me or under my supervision, and that the same is true and correct to the best of my knowledge and belief.

ROBERT B. WRIGHT
12/9/84
Professional Engineer
No. 7929

Professional Engineer
N. Mex. 7929

113
MAY 7-31-87