

All distances must be from the outer boundaries of the Sect.

Operator BELNORTH PETROLEUM CORP.			Location APACHE 27 STATE		Well No. 4
Well Letter L	Section 27	Township 12-S	Range 31-E	County CHAVES	
Actual Footage Location of Well: 1650 feet from the South line and 990 feet from the West line					
Ground Level Elev. 4443'	Producing Formation Queen		Well Chaves, S.E. (Queen Gas Area Associated)		Dedicated Acreage: 40 Acres

1. Outline the acreage dedicated to the subject well by colored pencil or hachure marks on the plat below.
2. If more than one lease is dedicated to the well, outline each and identify the ownership thereof (both as to working interest and royalty).
3. If more than one lease of different ownership is dedicated to the well, have the interests of all owners been consolidated by communitization, unitization, force-pooling, etc?

☐ Yes ☐ No If answer is "yes," type of consolidation _____

If answer is "no," list the owners and tract descriptions which have actually been consolidated. (Use reverse side of this form if necessary.) _____

No allowable will be assigned to the well until all interests have been consolidated (by communitization, unitization, forced-pooling, or otherwise) or until a non-standard unit, eliminating such interests, has been approved by the Commission.

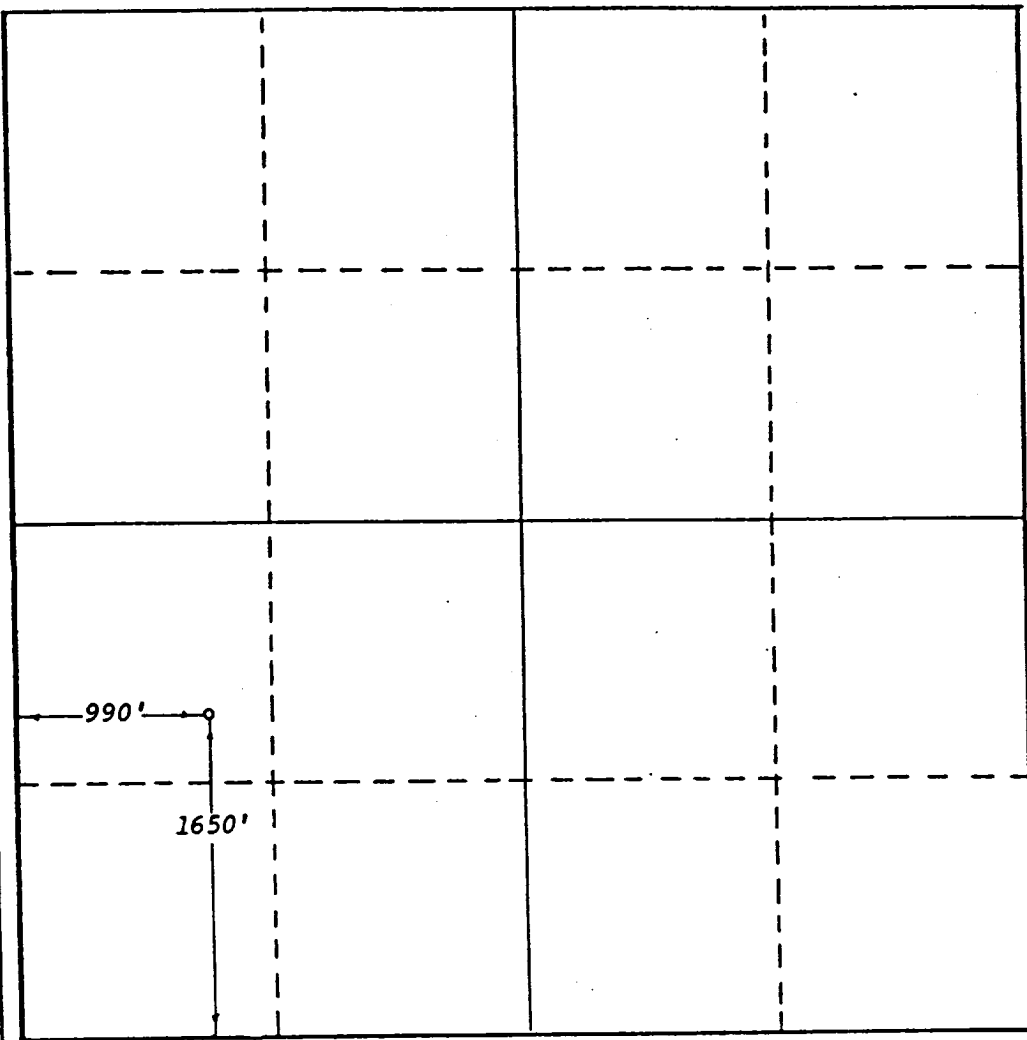

CERTIFICATION

I hereby certify that the information contained herein is true and complete to the best of my knowledge and belief.

L. W. Helms, Jr.

Name
L. W. Helms, Jr.

Position
Sr. Drilling Engineer

Company
BelNorth Petroleum

Date
August 27, 1985

I hereby certify that the well location shown on this plat was plotted from field notes of actual surveys made by me or under my supervision, and that the same is true and correct to the best of my knowledge and belief.

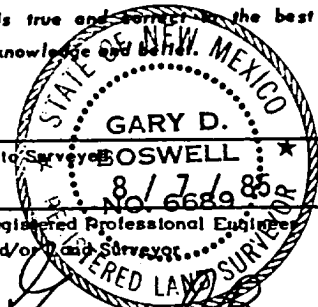

Date Surveyed
BOSWELL 8/17/85

Registered Professional Engineer and/or Land Surveyor

Gary D. Boswell
Certificate No.

6689



RECEIVED

SEP - 9 1985

U.S. DEPT. OF JUSTICE
HOBBS OFFICE