



**To** . Joe] F. Martin .....  
Nadel & Gussman Permian LLC .....  
601 N Marienfeld, Suite 508  
Midland, TX 79701

**From**

Donna Pitzer

7/9/99

---

**Energy & Minerals Department**

OIL CONSERVATION DIVISION

1625 N French Drive

Hobbs NM 88240

**Telephone Number** \_\_\_\_\_ (505) 393-6161 \_\_\_\_\_

- |   |  |
|---|--|
| <input type="checkbox"/> <b>For Your Files</b>                        | <input type="checkbox"/> <b>Prepare a Reply for My Signature</b> |
| <input checked="" type="checkbox"/> <b>For Your Review and Return</b> | <input type="checkbox"/> <b>For Your Information</b>             |
| <input checked="" type="checkbox"/> <b>For Your Handling</b>          | <input type="checkbox"/> <b>For Your Approval</b>                |
| <input type="checkbox"/> <b>As Per Your Request</b>                   | <input type="checkbox"/> <b>For Your Signature</b>               |
| <input checked="" type="checkbox"/> <b>Please Advise</b>              | <input type="checkbox"/> <b>For Your Attention</b>               |

Joel, The acreage dedicated to these two wells CANNOT be entered on the computer system. They overlap and this is incorrect. Please let me know how the acreage is to be so that I can correct it on the computer system. If you have questions on this matter, please call (505) 393-6161 Ext 115. Thank you, Donna

OIL CONSERVATION DIVISION

STATE OF NEW MEXICO  
ENERGY AND MINERALS DEPARTMENT

P. O. BOX 2088

SANTA FE, NEW MEXICO 87501

Form C-102  
Revised 10-

All distances must be from the outer boundaries of the Section. **30-025-21063**

Operator <b>McClellan Oil Corp.</b>		Lease <b>Big Lucky Lake Comm</b>			Well No. <b>1</b>
Unit Letter <b>0</b>	Section <b>30</b>	Township <b>15 South</b>	Range <b>30 East</b>	County <b>Chaves</b>	
Actual Postage Location of Well: <b>660</b> feet from the <b>South</b> line and <b>1980</b> feet from the <b>East</b> line					
Ground Level Elev. <b>3919</b>	Producing Formation <b>Morrow</b>		Pool <b>Little Lucky Lake</b>	Dedicated Acreages <b>320</b> A.	

1. Outline the acreage dedicated to the subject well by colored pencil or hachure marks on the plat below.
2. If more than one lease is dedicated to the well, outline each and identify the ownership thereof (both as to work interest and royalty).
3. If more than one lease of different ownership is dedicated to the well, have the interests of all owners been consolidated by communitization, unitization, force-pooling, etc?

Yes  No If answer is "yes," type of consolidation Communitization

If answer is "no," list the owners and tract descriptions which have actually been consolidated (use reverse of this form if necessary.) \_\_\_\_\_

No allowable will be assigned to the well until all interests have been consolidated (by communitization, unitization, forced-pooling, or otherwise) or until a non-standard unit, eliminating such interests, has been approved by the Division.

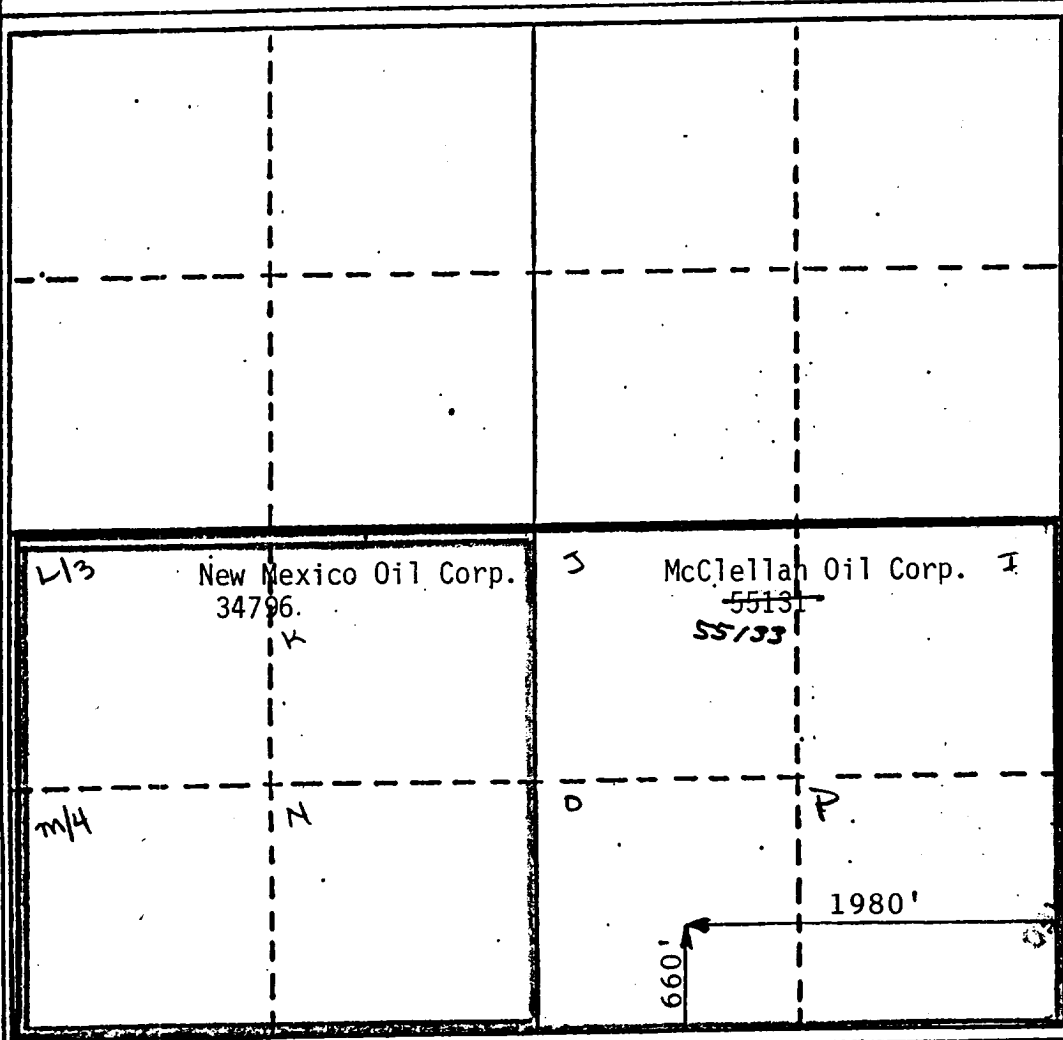
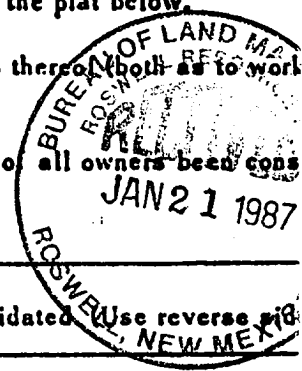

CERTIFICATION

I hereby certify that the information obtained herein is true and complete to the best of my knowledge and belief.

*Paul Ragsdale*

Name: **Paul Ragsdale**  
 Position: **Operations Manager**  
 Company: **McClellan Oil Corp.**  
 Date: **Jan. 14, 1987**

I hereby certify that the well location shown on this plat was plotted from notes of actual surveys made by me under my supervision, and that the information is true and correct to the best of my knowledge and belief.

Date Surveyed: **January 9, 1987**  
 Registered Professional Engineer and/or Land Surveyor:  
*John D. Jaquess*  
 Certificate No. **6230**

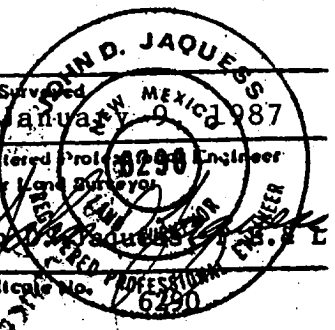

30-005-00517

Submit to Appropriate District Office  
State Lease - 4 copies  
Fee Lease - 3 copies

State of New Mexico  
Energy, Minerals and Natural Resources Department

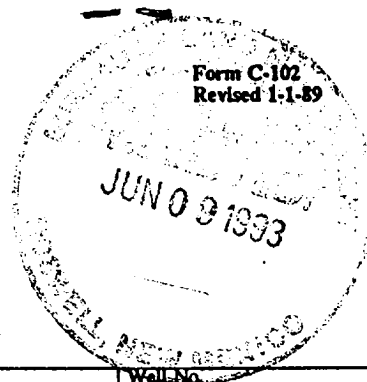

**OIL CONSERVATION DIVISION**  
P.O. Box 2088  
Santa Fe, New Mexico 87504-2088

**DISTRICT I**  
P.O. Box 1980, Hobbs, NM 88240

**DISTRICT II**  
P.O. Drawer DD, Artesia, NM 88210

**DISTRICT III**  
1000 Rio Brazos Rd., Aztec, NM 87410

**WELL LOCATION AND ACREAGE DEDICATION PLAT**  
All Distances must be from the outer boundaries of the section

Operator <b>McCLELLAN OIL CORPORATION</b>			Lease <b>BIG LUCKY LAKE FED. COM.</b>			Well No. <b>2</b>		
Unit Letter <b>I</b>	Section <b>30</b>	Township <b>15 S</b>	Range <b>30 E</b>	County <b>NMPM</b>		Chaves		
Actual Footage Location of Well:								
1980 feet from the <b>South</b> line and			660 feet from the <b>East</b> line					
Ground level Elev. <b>3932</b>		Producing Formation <del>Atoka</del> <b>Morrow</b>			Pool <b>Little Lucky Lake Morrow</b>		Dedicated Acreage: <b>320</b> Acres	

- Outline the acreage dedicated to the subject well by colored pencil or hachure marks on the plat below.
- If more than one lease is dedicated to the well, outline each and identify the ownership thereof (both as to working interest and royalty).
- If more than one lease of different ownership is dedicated to the well, have the interest of all owners been consolidated by communitization, unitization, force-pooling, etc.?
 

Yes     No    If answer is "yes" type of consolidation Communitization

If answer is "no" list the owners and tract descriptions which have actually been consolidated. (Use reverse side of this form if necessary.)

No allowable will be assigned to the well until all interests have been consolidated (by communitization, unitization, forced-pooling, or otherwise) or until a non-standard unit, eliminating such interest, has been approved by the Division.

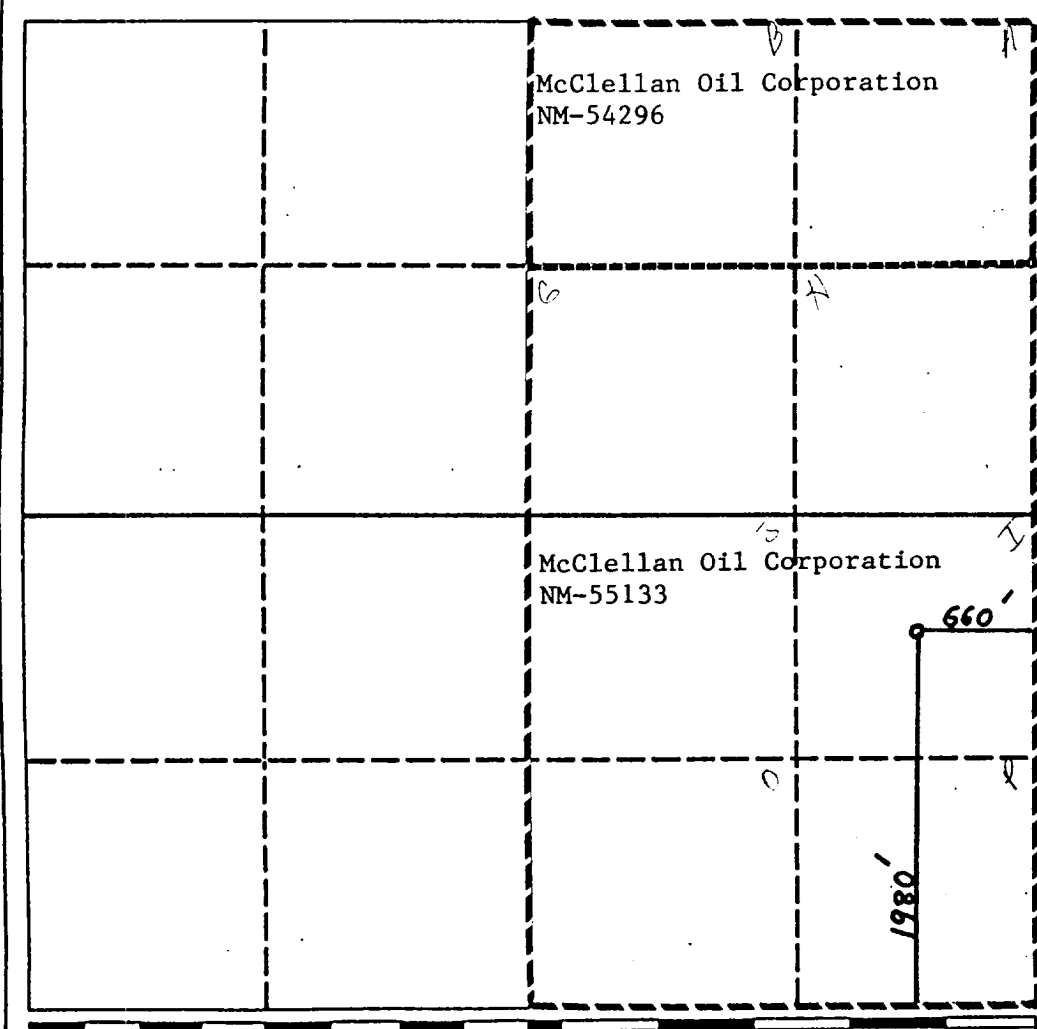

**OPERATOR CERTIFICATION**  
I hereby certify that the information contained herein is true and complete to the best of my knowledge and belief.

Signature: Mark McClellan  
Printed Name: **Mark McClellan**  
Position: **President**  
Company: **McClellan Oil Corporation**  
Date: **5-28-93**

**SURVEYOR CERTIFICATION**  
I hereby certify that the well location shown on this plat was plotted from field notes actual surveys made by me or under my supervision, and that the same is true and correct to the best of my knowledge and belief.  
See attached original  
Date Surveyed: **1/27/59**  
Signature & Seal of Professional Surveyor:  
  
See attached original  
Certificate No.: