

UNITED STATES  
DEPARTMENT OF THE INTERIOR  
GEOLOGICAL SURVEY

30-005-21081

## APPLICATION FOR PERMIT TO DRILL, DEEPEN, OR PLUG BACK

5. LEASE DESIGNATION AND SERIAL NO.

NM 54873

6. IF INDIAN, ALLOTTEE OR TRIBE NAME

7. UNIT AGREEMENT NAME

8. FARM OR LEASE NAME

Witter-Federal

9. WELL NO.

1

10. FIELD AND POOL, OR WILDCAT

Wildcat

Unfeasible West  
Ranch Queen11. SEC., T., R., M., OR BLK.  
AND SURVEY OR AREA

34-14S-30E

12. COUNTY OR PARISH

Chaves

13. STATE

NM

18. TYPE OF WORK

DRILL ☒DEEPEN ☐PLUG BACK ☐

b. TYPE OF WELL

OIL  
WELL ☒GAS  
WELL ☐

OTHER

SINGLE  
ZONE ☒MULTIPLE  
ZONE ☐

2. NAME OF OPERATOR

Dalport Oil Corporation

3. ADDRESS OF OPERATOR

1401 Elm Street #3471, Dallas, Texas 75202

4. LOCATION OF WELL (Report location clearly and in accordance with any State requirements.)\*

At surface

1980' FSL &amp; 660' FEL

At proposed prod. zone

Same

14. DISTANCE IN MILES AND DIRECTION FROM NEAREST TOWN OR POST OFFICE\*

18 mi NE of Loco Hills

15. DISTANCE FROM PROPOSED\*

LOCATION TO NEAREST  
PROPERTY OR LEASE LINE, FT.  
(Also to nearest drig. unit line, if any)

660

16. NO. OF ACRES IN LEASE

160

17. NO. OF ACRES ASSIGNED  
TO THIS WELL

40

18. DISTANCE FROM PROPOSED LOCATION\*  
TO NEAREST WELL, DRILLING, COMPLETED,  
OR APPLIED FOR, ON THIS LEASE, FT.

None

19. PROPOSED DEPTH

2650

20. ROTARY OR CABLE TOOLS

Rotary

21. ELEVATIONS (Show whether DF, RT, GR, etc.)

22. APPROX. DATE WORK WILL START\*

Sept. 25, 1988

23.

## PROPOSED CASING AND CEMENTING PROGRAM

SIZE OF HOLE	SIZE OF CASING	WEIGHT PER FOOT	SETTING DEPTH	QUANTITY OF CEMENT
12-1/4	8-5/8-New	24	760 850'	175 sx 'C' + 2% CC; 175 sx 'C' + 4% gel
7-7/8	4-1/2-Used	9.5	2605	125 sx Lite + 150 sx 'C' 50% Poz

Will cement 8-5/8" surface casing at approximately 760' in the Rustler anhydrite, circulate cement and WOC 18 hours. Test casing at 600# for 30", drill out w/fresh water. Will mud up at approximately 2440'. If productive, will run Schlumberger logs, run 4-1/2" to 2650' and will perforate as per gamma-neutron log. If sand frac is necessary, will use 20,000 gal. gelled water + 30,000# sand. BOP program: Shaeffer hydraulic BOP's will be installed and will be used while rig is on location. If well is dry, it will be plugged as per Federal Regulations and location will be cleared and leveled.

IN ABOVE SPACE DESCRIBE PROPOSED PROGRAM: If proposal is to deepen or plug back, give data on present productive zone and proposed new productive zone. If proposal is to drill or deepen directionally, give pertinent data on subsurface locations and measured and true vertical depths. Give blowout preventer program, if any.

24.

SIGNED

*Sam M. Langford*

TITLE

Geologist

DATE

8-23-88

(This space for Federal or State office use)

PERMIT NO.

APPROVAL DATE

APPROVED BY

S/Homer Meyer, Acting

TITLE

Area Manager

DATE

JAN 26 1989

CONDITIONS OF APPROVAL, IF ANY:

APPROVAL OF THIS APPLICATION DOES NOT WARRANT OR CERTIFY THAT THE APPLICANT HOLDS LEGAL OR EQUITABLE TITLE TO THOSE RIGHTS IN THE SUBJECT LEASE WHICH WOULD ENTITLE THE APPLICANT TO CONDUCT OPERATIONS THEREON.

PLEASE BE ADVISED THAT THERE WILL BE NO EXCAVATION OF FEDERALLY OWNED MINERAL MATERIAL FOR CONSTRUCTION OF THE ACCESS ROAD OR PAD WITHOUT PAYMENT IN ADVANCE.

\*See Instructions On Reverse Side

**RECEIVED**

**JAN 30 1989**

**OCD  
HOBBS OFFICE**

WEK DRILLING CO., INC. - Rig 1 & 3.  
**BLOWOUT PREVENTER SPECIFICATION**  
 3000 PSC W. 12

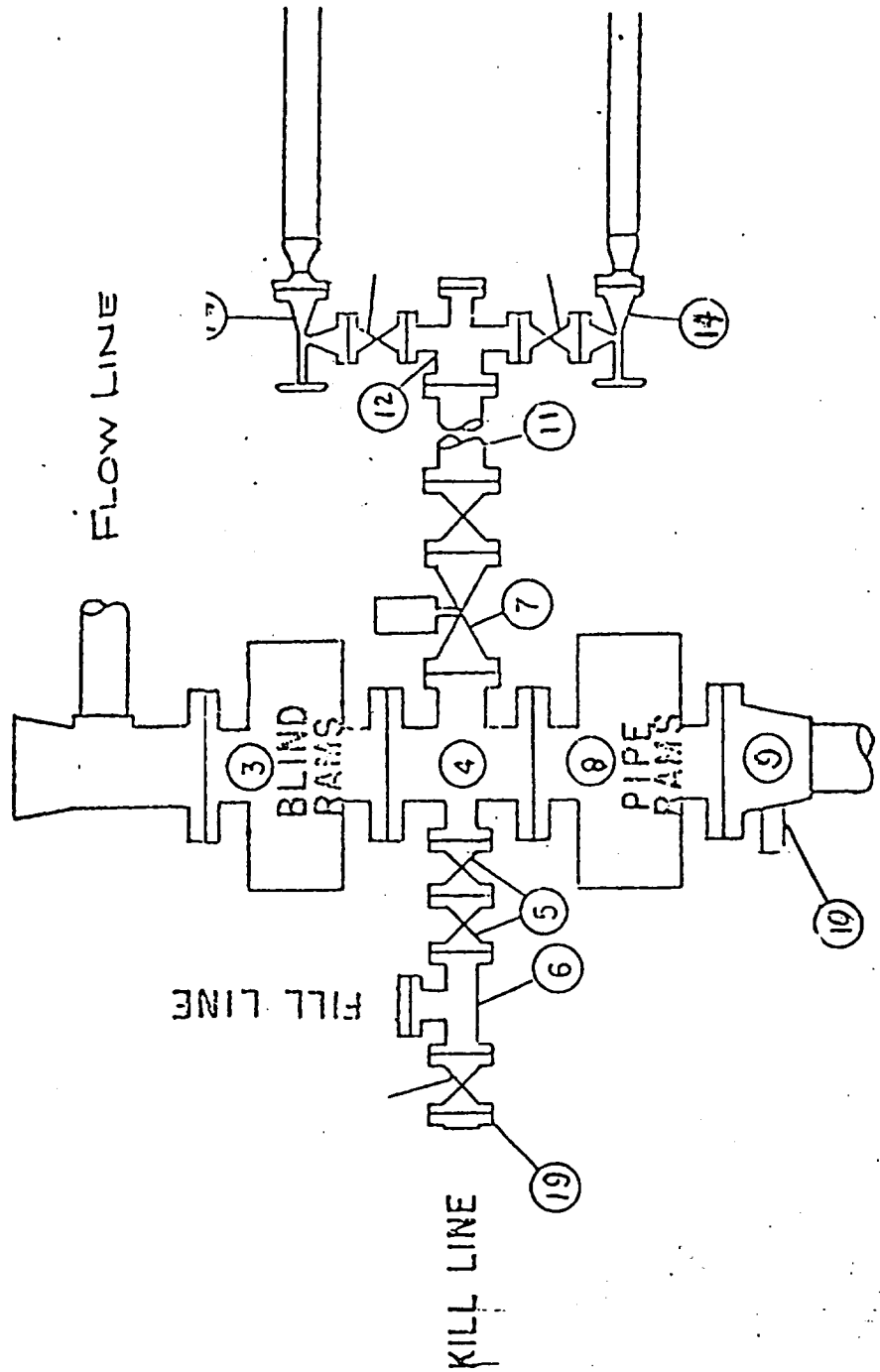

**Exhibit 'E'**  
 Surface Use Plan

RECEIVED

JAN 30 1989

OK  
MOBBS

NEW MEXICO OIL CONSERVATION COMMISSION  
WELL LOCATION AND ACREAGE DEDICATION PLAT

Form C-102  
Supersedes C-128  
Effective 1-1-65

All distances must be from the outer boundaries of the Section

Operator Dalport Oil Corp.			Lease Witter-Federal			Well No. 1		
Section 1	Section 34	Township 14 South	Range 30 East	County Chaves				
Actual Portage Location of Well: 1980 feet from the South line and 660 feet from the East line								
Ground Level Elev. 3979.8	Producing Formation Queen		Pool Wildcat			Dedicated Acreage 40 Acres		

1. Outline the acreage dedicated to the subject well by colored pencil or hachure marks on the plat below.
2. If more than one lease is dedicated to the well, outline each and identify the ownership thereof (both as to working interest and royalty).
3. If more than one lease of different ownership is dedicated to the well, have the interests of all owners been consolidated by communitization, unitization, force-pooling, etc?

☐ Yes ☐ No If answer is "yes," type of consolidation \_\_\_\_\_

If answer is "no," list the owners and tract descriptions which have actually been consolidated. (Use reverse side of this form if necessary.) \_\_\_\_\_

No allowable will be assigned to the well until all interests have been consolidated (by communitization, unitization, forced-pooling, or otherwise) or until a non-standard unit, eliminating such interests, has been approved by the Commission.

Yates Petroleum Corp.



NM 311 12

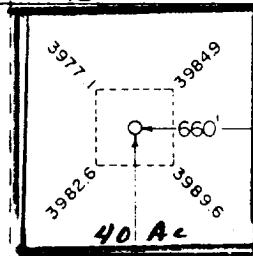

NM 54873

CERTIFICATION

I hereby certify that the information contained herein is true and complete to the best of my knowledge and belief.

*Leon M. Lampert*

Name  
Leon M. Lampert

Position  
Geologist

Company  
Dalport Oil Corp.

Date  
8-29-88

I hereby certify that the well location shown on this plat was plotted from field notes of actual surveys made by me or under my supervision, and that the same is true and correct to the best of my knowledge and belief.

Date Surveyed  
August 24, 1988

Registered Professional Engineer and/or Land Surveyor

*Ronald J. Eidson*

Certificate No. JOHN W. WEST, 676  
RONALD J. EIDSON, 3239

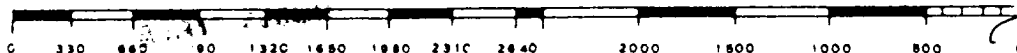

68-02-2 221  
173

RECEIVED  
JAN 30 1989  
OCD  
HOBBS OFFICE