

All distances must be from the outer boundaries of the Section.

Operator Chi Operating, Inc.		Lease N.M. Cap		Well No. 1	
Unit Letter F	Section 19	Township 15 South	Range 31 East	County Chaves	
Actual Footage Location of Well: 1980 feet from the North line and 1980 feet from the West line					
Ground Level Elev. 4452	Producing Formation Caprock Queen		Pool CapRock Queen		Dedicated Acreage: 40 Acres

1. Outline the acreage dedicated to the subject well by colored pencil or hatchure marks on the plat below.
2. If more than one lease is dedicated to the well, outline each and identify the ownership thereof (both as to working interest and royalty).
3. If more than one lease of different ownership is dedicated to the well, have the interests of all owners been consolidated by communitization, unitization, force-pooling, etc?

☐ Yes ☐ No If answer is "yes," type of consolidation _____

If answer is "no," list the owners and tract descriptions which have actually been consolidated. (Use reverse side of this form if necessary.) _____

No allowable will be assigned to the well until all interests have been consolidated (by communitization, unitization, forced-pooling, or otherwise) or until a non-standard unit, eliminating such interests, has been approved by the Division.

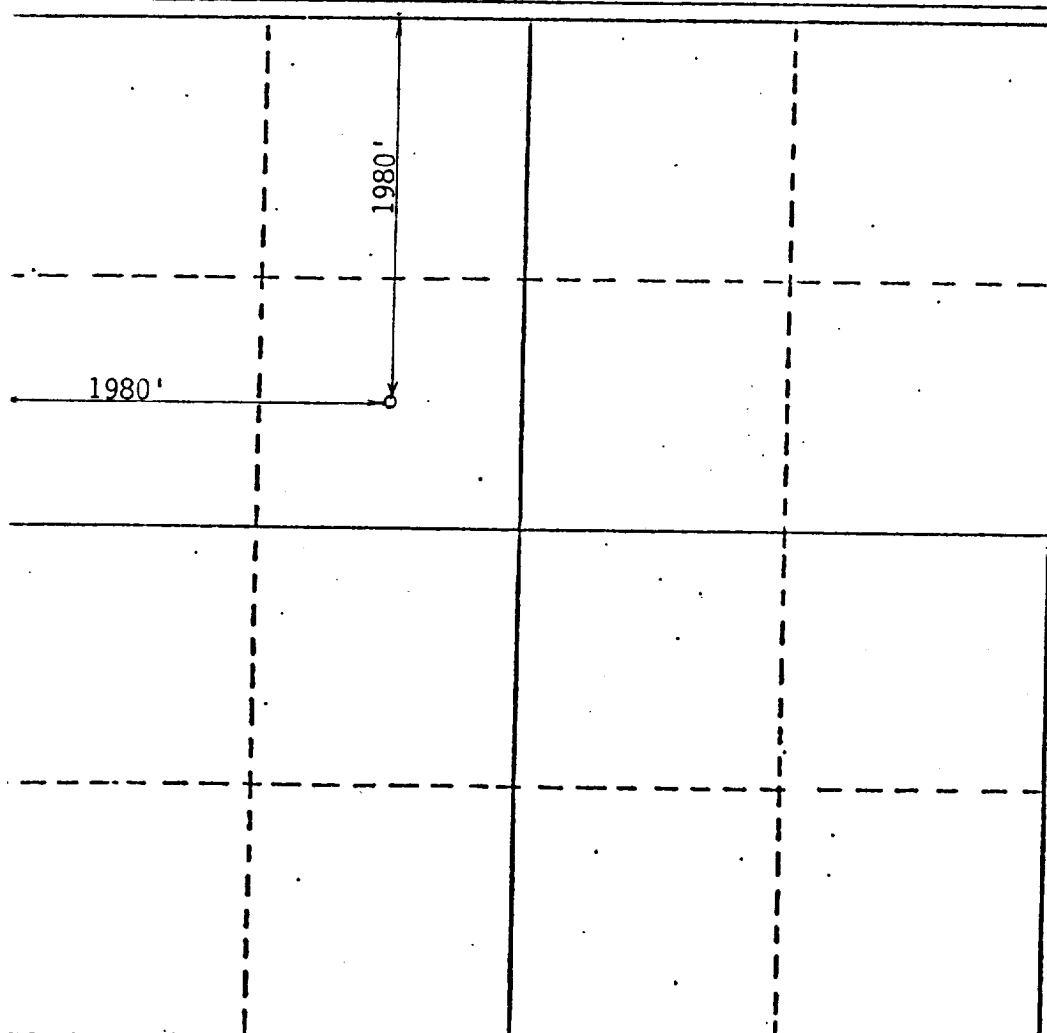

CERTIFICATION

I hereby certify that the information contained herein is true and complete to the best of my knowledge and belief.

Name _____

David H. Harriaon

Position _____

President

Company _____

Chi Operating, Inc.

Date _____

09/19/89

I hereby certify that the well location shown on this plat was plotted from field notes of actual surveys made by me or under my supervision, and that the same is true and correct to the best of my knowledge and belief.

Date Surveyed _____

September 17, 1989

Registered Professional Engineer and/or Land Surveyor

P. R. Patton

Certificate No. _____

8112

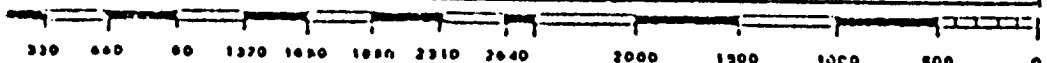
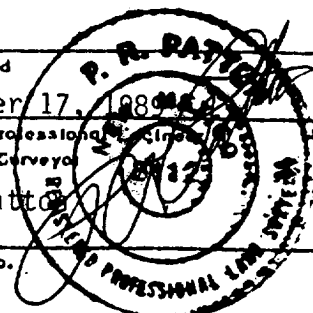

Make Undersig Sheet
Caprock Qd
Iac is standard

ELF

Recd

6/6/91

RECEIVED

SEP 20 1989

OCD
HOBBS OFFICE