

UNITED STATES
DEPARTMENT OF THE INTERIOR
BUREAU OF LAND MANAGEMENT

APPLICATION FOR PERMIT TO DRILL, DEEPEN, OR PLUG BACK

1a. TYPE OF WORK DRILL <input checked="" type="checkbox"/> DEEPEN <input type="checkbox"/> PLUG BACK <input type="checkbox"/>		5. LEASE DESIGNATION AND SERIAL NO. NM-63755	
b. TYPE OF WELL OIL WELL <input checked="" type="checkbox"/> GAS WELL <input type="checkbox"/> OTHER <input type="checkbox"/>		6. IF INDIAN, ALLOTTEE OR TRIBE NAME	
2. NAME OF OPERATOR McClellan Oil Corporation		7. UNIT AGREEMENT NAME	
3a. Area Code & Phone No. 505/622-3200		8. FARM OR LEASE NAME Branex Federal	
3. ADDRESS OF OPERATOR P. O. Drawer 730 Roswell, NM 88202		9. WELL NO. 1	
4. LOCATION OF WELL (Report location clearly and in accordance with any State requirements.) At surface 990' FSL & 467' FWL Unit m		10. FIELD AND POOL, OR WILDCAT Wildcat-Devonian	
At proposed prod. zone Same		11. SEC., T., R., M., OR BLE. AND SURVEY OR AREA Sec. 6-T11S-R31E	
14. DISTANCE IN MILES AND DIRECTION FROM NEAREST TOWN OR POST OFFICE 46 miles east of Roswell, NM		12. COUNTY OR PARISH Chaves	
15. DISTANCE FROM PROPOSED LOCATION TO NEAREST PROPERTY OR LEASE LINE, FT. (Also to nearest drig. unit line, if any) 467'		13. STATE New Mexico	
16. NO. OF ACRES IN LEASE 1223.87		17. NO. OF ACRES ASSIGNED TO THIS WELL 40	
18. DISTANCE FROM PROPOSED LOCATION TO NEAREST WELL, DRILLING, COMPLETED, OR APPLIED FOR, ON THIS LEASE, FT. N/A		20. ROTARY OR CABLE TOOLS Rotary	
21. ELEVATIONS (Show whether DF, RT, GR, etc.) 4082' GL		22. APPROX. DATE WORK WILL START June 1, 1993	

PROPOSED CASING AND CEMENTING PROGRAM

HOLE SIZE	CASING SIZE	WEIGHT/FOOT	GRADE	THREAD TYPE	SETTING DEPTH	QUANTITY OF CEMENT
17 1/2"	13 3/8"	54#	J-55	STC	350'	Circ 400 sx C
12 1/4"	8 5/8"	24 or 28#	J-55	LTC	2300'	Circ 1050 sx*
7 7/8"	5 1/2"	17#	N-80	LTC	10550'	600 sx "H"

Mud Program:

	Mud Wt.	Vis.	W/L Control
0' - 350': Fresh water native mud:	9.5 ppg	30	No W/L control
350' - 2300': Fresh water native mud:	9.5 ppg	30	No W/L control
2300' - 6450': Cut brine mud:	9.5 ppg	30	No W/L control
6450' - 10,550': Salt wtr gel w/diesel & starch:	9.5-9.8 ppg	35-38	W/L control 10-12cc

BOP Program:

A 10" 3000 psi wp Shaffer Series 900 BOP will installed on the 13 3/8" casing. Casing and BOP will be tested before drilling out with 12 1/4". BOP will be tested daily.

* HL & C

IN ABOVE SPACE DESCRIBE PROPOSED PROGRAM: If proposal is to deepen or plug back, give data on present productive zone and proposed new productive zone. If proposal is to drill or deepen directionally, give pertinent data on subsurface locations and measured and true vertical depths. Give blowout preventer program, if any.

24. SIGNED George R. Smith TITLE Agent for: McClellan Oil Corp. DATE Feb. 12, 1993

(This space for Federal or State office use)

PERMIT NO. David Stout APPROVAL DATE 4/27/93
APPROVED BY Asst Area Mgr. DATE 4/27/93

CONDITIONS OF APPROVAL, IF ANY:

EASE BE ADVISED THAT THERE WILL BE NO EXCAVATION
FEDERALLY OWNED MINERAL MATERIAL FOR CONSTRU-
ON OF THE ACCESS ROAD OR PAD WITHOUT PASSENT
ADVANCE.

APPROVAL OF THIS APPLICATION DOES NOT WARRANT OR
CERTIFY THAT THE APPLICANT HOLDS LEGAL OR EQUITABLE
TITLE TO THOSE RIGHTS IN THE SUBJECT LEASE WHICH WOULD
ENTITLE THE APPLICANT TO CONDUCT OPERATIONS THEREON.

Title 18 U.S.C. Section 1001, makes it a crime for any person knowingly and willfully to make any false statement or to conceal or destroy any document or record.

Submit to Appropriate
District Office
State Lease - 4 copies
Federal Lease - 3 copies

State of New Mexico
Energy, Minerals and Natural Resources Department

OIL CONSERVATION DIVISION

P.O. Box 2088
Santa Fe, New Mexico 87504-2088

Form C-102
Revised 1-1-89

STRICTLY
O. Box 1980, Hobbs, NM 88240

STRICTLY
O. Drawer DD, Artesia, NM 88210

STRICTLY
O. Rio Brazos Rd., Aztec, NM 87410

WELL LOCATION AND ACREAGE DEDICATION PLAT

All Distances must be from the outer boundaries of the section

Operator McClellan Oil Corporation			Lease Branex Federal		Well No. #1
Unit Letter M	Section 6	Township 11S.	Range 31E.	County NMPM	Chaves
Actual Footage Location of Well: 990 feet from the South line and 467 feet from the West line					
Ground level Elev. 4082'	Producing Formation Devonian		Pool Wildcat		Dedicated Acreage: 35.58 Acres

1. Outline the acreage dedicated to the subject well by colored pencil or hatchure marks on the plat below.

2. If more than one lease is dedicated to the well, outline each and identify the ownership thereof (both as to working interest and royalty).

3. If more than one lease of different ownership is dedicated to the well, have the interest of all owners been consolidated by communitization, unitization, force-pooling, etc.?

☐ Yes ☐ No

If answer is "yes" type of consolidation

If answer is "no" list the owners and tract descriptions which have actually been consolidated. (Use reverse side of this form if necessary.)

No allowable will be assigned to the well until all interests have been consolidated (by communitization, unitization, forced-pooling, or otherwise) or until a non-standard unit, eliminating such interest, has been approved by the Division.

OPERATOR CERTIFICATION

I hereby certify that the information contained herein is true and complete to the best of my knowledge and belief.

Signature

Mark McClellan

Printed Name Mark McClellan
President

Position

McCLELLAN OIL CORPORATION

Company

Feb. 9, 1993

Date

SURVEYOR CERTIFICATION

I hereby certify that the well location shown on this plat was plotted from field notes of actual surveys made by me or under my supervision, and that the same is true and correct to the best of my knowledge and belief.

Date Surveyed

2/3/93

Signature & Seal of
Professional Surveyor

Certificate No.

6290

BK. 67, PG. 25

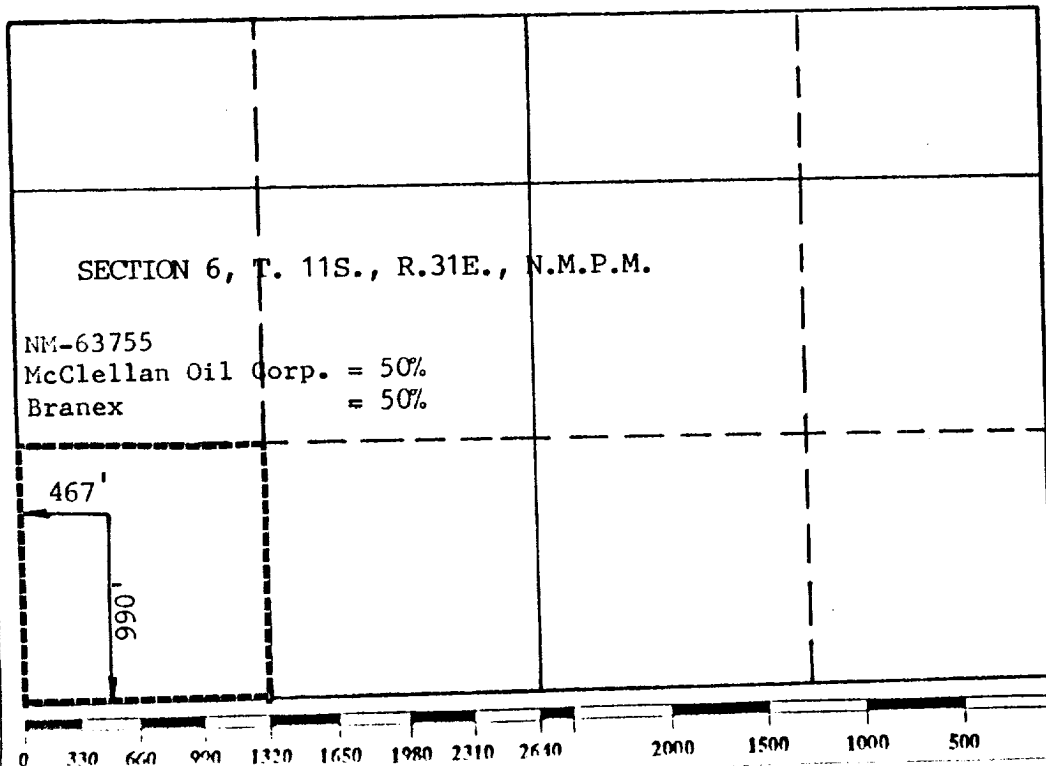

APPLICATION FOR DRILLING

McCLELLAN OIL CORPORATION
Branex Federal. Well No. 1
990' FSL & 467' FWL, Sec. 6-T11S-R31E
Chaves County, New Mexico
Lease No.: NM-63755
(Exploratory Well)

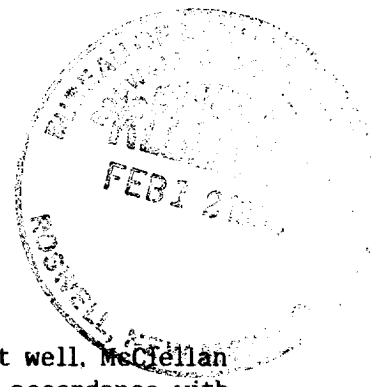

In conjunction with Form 3160-3, Application for Permit to Drill subject well, McClellan Oil Corporation submits the following items of pertinent information in accordance with BLM requirements:

1. The geologic surface formation is recent Permian with quaternary alluvium and other surficial deposits.
2. The estimated tops of geologic markers are as follows:

Rustler	990'	Glorieta	4290'
Yates	1670'	Abo	6610'
Seven Rivers	2190'	Wolfcamp	7740'
Queen	2360'	Atoka	9300'
Penrose	2470'	Mississippian	9850'
San Andres	2940'	Devonian	10475'
		T.D.	10550'

3. The estimated depths at which water, oil or gas formations are anticipated to be encountered:

Water: Random fresh water sands from surface to - 200'+/-.

Oil: Possible in the San Andres below 2940', Abo below 6610', Wolfcamp below 7740', Bough "C" below 8000', and the Devonian below 10,475'.

Gas: Possible in the Atoka between 9300' - 9850'.

4. Proposed Casing Program: See Form 3160-3.
5. Proposed Control Equipment: See Form 3160-3 and Exhibit "E".
6. Mud Program: See Form 3160-3.
7. Auxiliary Equipment: Blowout Preventer, gas detector, Kelly cock.
8. Testing, Logging, and Coring Program:

Drill Stem Tests: Possible in the Abo @ 7500', Wolfcamp @ 7700', Bough "C" @ 8200', and the Devonian @ 10,475'.

Logging: T.D. to surface: GR-CNL-LDT, .

T.D. to intermediate casing: DLL-MSFL, Sonic log.
10,250'-10550': Dip meter.

Coring: None planned.

9. No abnormal pressures or temperatures are anticipated. In the event abnormal pressures are encountered the proposed mud program will be modified to increase the mud weight. Estimated BHP = 4200 psi (evac.) with temperature = 170°.
10. H₂S: None expected.
11. Anticipated starting date: June 1, 1993.
Anticipated completion of drilling operations: Approximately 45 days.

RIG # 1

BLOWOUT PREVENTOR ARRANGEMENT

10" SHAFFER TYPE "E", 3000 psi WP

80 GALLON, 4 STATION KOOMEY ACCUMULATOR

3000 psi WP CHOKE MANIFOLD

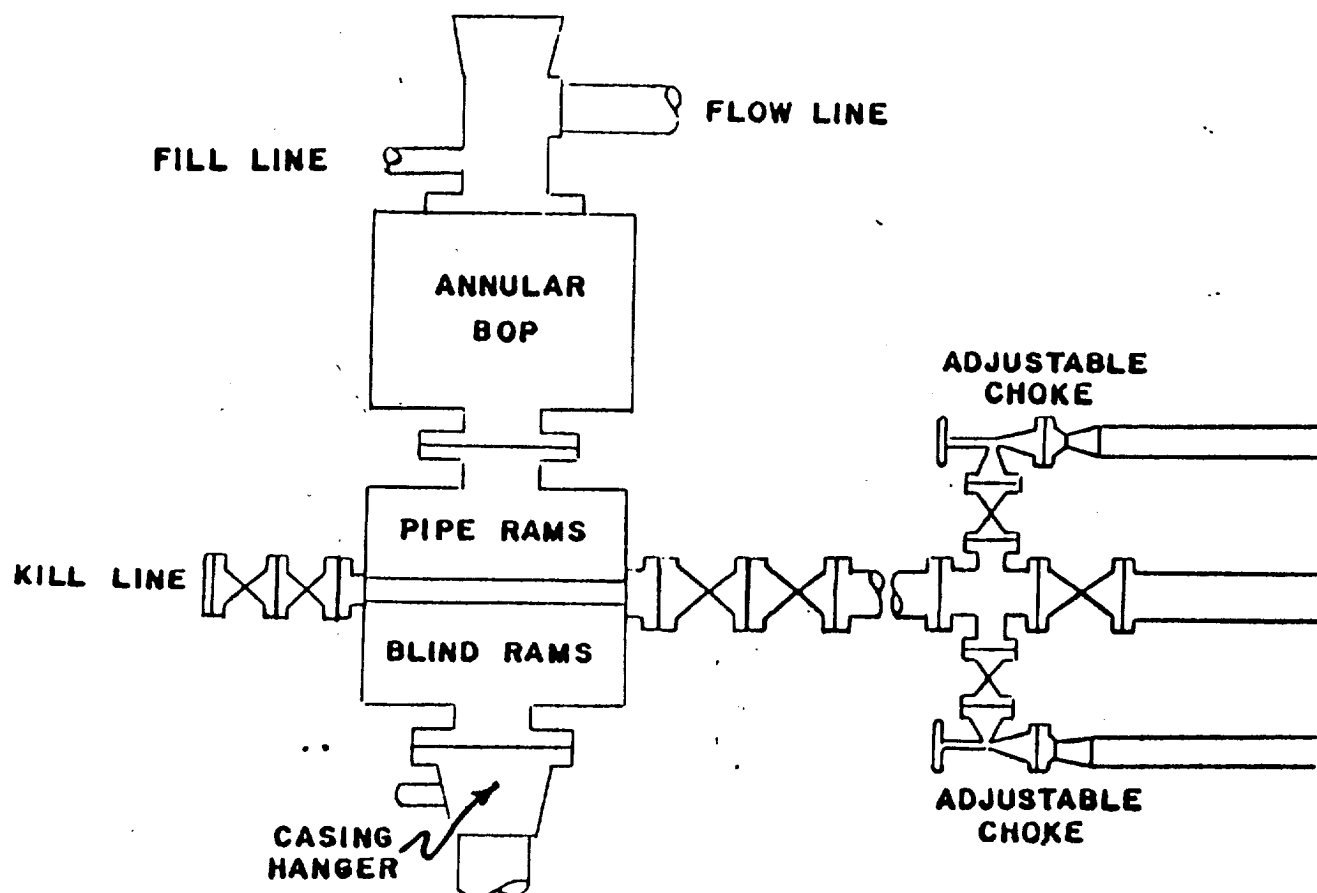

EXHIBIT "E"
McCLELLAN OIL CORPORATION
Branex Federal, Well No. 1
BOP Specifications

