

NEW MEXICO OIL CONSERVATION COMMISSION
Santa Fe, New Mexico

Form G-101
Revised (12/1/55)

NOTICE OF INTENTION TO DRILL

Notice must be given to the District Office of the Oil Conservation Commission and approval obtained before drilling or recompletion begins. If changes in the proposed plan are considered advisable, a copy of this notice showing such changes will be returned to the sender. Submit this notice in QUINTUPLICATE. One copy will be returned following approval. See additional instructions in Rules and Regulations of the Commission. If State Land submit 6 Copies Attach Form G-128 in triplicate to first 3 copies of form G-101

Breckenridge, Texas
(Place)

May 27, 1960
(Date)

OIL CONSERVATION COMMISSION
SANTA FE, NEW MEXICO

Gentlemen:

You are hereby notified that it is our intention to commence the Drilling of a well to be known as
Graridge Corporation

(Company or Operator)

Vickers Five
(Lease)

Well No. **1**, in **J** (Unit) The well is

located **1980** feet from the **East** line and **1980** feet from the

South line of Section **5**, T. **13S**, R. **32E**, NMPM.

(GIVE LOCATION FROM SECTION LINE) **Caprock Queen** Pool, **Lea** County

If State Land the Oil and Gas Lease is No. **B-10907**

If patented land the owner is

Address

We propose to drill well with drilling equipment as follows: **3100' with rotary equipment**

The status of plugging bond is **\$10,000. Fidelity & Casualty Co. of New York bond #S-1053517 covering drilling & plugging in State of New Mexico**

Drilling Contractor **Great Western Drilling Company, Midland, Texas**

We intend to complete this well in the **Queen Sand** formation at an approximate depth of **3050 - 3100** feet.

CASING PROGRAM

We propose to use the following strings of Casing and to cement them as indicated:

Size of Hole	Size of Casing	Weight per Foot	New or Second Hand	Depth	Sacks Cement
8 - 3/4"	7"	20#	New	300	200
6 - 1/4"	4 - 1/2"	9.5#	New	3100	150

If changes in the above plans become advisable we will notify you immediately.

ADDITIONAL INFORMATION (If recompletion give full details of proposed plan of work.)

Approved _____, 19____
Except as follows:

CEMENT MUST BE CIRCULATED BEHIND

CASING.

OIL CONSERVATION COMMISSION

By *[Signature]*
Engineer District 1

Sincerely yours,

Graridge Corporation

(Company or Operator)

By *[Signature]* **A.C. Andrews, Jr.**

Position **Production Clerk**
Send Communications regarding well to

Name **Graridge Corporation**

Address **P.O. Box 752, Breckenridge, Texas**

NEW MEXICO OIL CONSERVATION COMMISSION
WELL LOCATION AND ACREAGE DEDICATION PLAT

FORM C-128
Revised 5/1/57

SEE INSTRUCTIONS FOR COMPLETING THIS FORM ON THE REVERSE SIDE

SECTION A

Operator Graridge Corporation			Lease Vickers-Five		Well No. 1
Unit Letter J	Section 5	Township 13 South	Range 32 East	County Lea	
Actual Footage Location of Well: 1980 feet from the South line and 1980 feet from the East line					
Ground Level Elev. 4372	Producing Formation Queen Sand		Pool Caprock Queen		Dedicated Acreage: 40 Acres

1. Is the Operator the only owner in the dedicated acreage outlined on the plat below? YES ☒ NO ____ . ("Owner" means the person who has the right to drill into and to produce from any pool and to appropriate the production either for himself or for himself and another. (65-3-29 (e) NMSA 1935 Comp.)
2. If the answer to question one is "no," have the interests of all the owners been consolidated by communitization agreement or otherwise? YES ____ NO ____ . If answer is "yes," Type of Consolidation _____
3. If the answer to question two is "no," list all the owners and their respective interests below:

Owner	Land Description

SECTION B

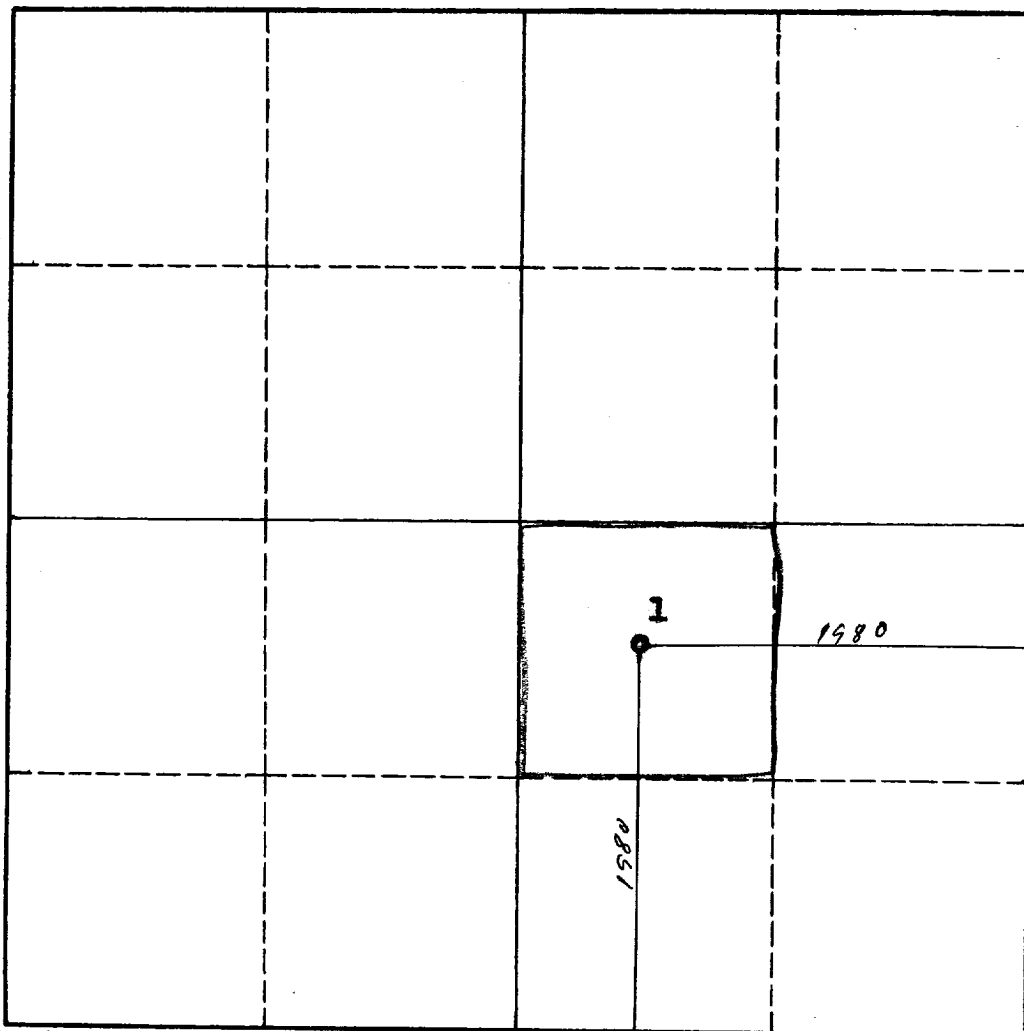

CERTIFICATION

I hereby certify that the information in SECTION A above is true and complete to the best of my knowledge and belief.

Name <i>A. C. Anderson Jr.</i>
Position Production Clerk
Company Graridge Corporation
Date May 28, 1960

I hereby certify that the well location shown on the plat in SECTION B was plotted from field notes of actual surveys made by me or under my supervision, and that the same is true and correct to the best of my knowledge and belief.

Date Surveyed May 26, 1960
Registered Professional Engineer and/or Land Surveyor <i>John A. Mathis Jr.</i>
Certificate No. 1502

0 330 660 990 1320 1650 1980 2310 2640 2000 1500 1000 500 0

INSTRUCTIONS FOR COMPLETION OF FORM C-128

1. Operator shall furnish and certify to the information called for in Section A.
2. Operator shall outline the dedicated acreage for *both* oil and gas wells on the plat in Section B.
3. A registered professional engineer or land surveyor registered in the State of New Mexico or approved by the Commission shall show on the plat the location of the well and certify this information in the space provided.
4. All distances shown on the plat must be from the outer boundaries of the Section.
5. If additional space is needed for listing owners and their respective interests as required in question 3 of Section A, please use space below.