

NEW MEXICO OIL CONSERVATION COMMISSION
Santa Fe, New Mexico

Form C-101
Revised (12/1/55)

HOBBS OFFICE OCC

NOTICE OF INTENTION TO DRILL

Notice must be given to the District Office of the Oil Conservation Commission and approval obtained before drilling or re-completion begins. If changes in the proposed plan are considered advisable, a copy of this notice showing such changes will be returned to the sender. Submit this notice in **QUINTUPLICATE**. One copy will be returned following approval. See additional instructions in Rules and Regulations of the Commission. If State Land submit 6 Copies Attach Form C- 128 in triplicate to first 3 copies of form C-101

Midland, Texas
(Place)

5-23-61
(Date)

OIL CONSERVATION COMMISSION
SANTA FE, NEW MEXICO

Gentlemen:

You are hereby notified that it is our intention to commence the Drilling of a well to be known as

Humble Oil & Refining Co. #175764
(Company or Operator)

New Mexico State BL, Well No. 1, in C (Unit) The well is located 330 feet from the North line and 1980 feet from the West line of Section 16, T. 13-S, R. 32-E, NMPM. (GIVE LOCATION FROM SECTION LINE) Wildcat Pool, Lea County

If State Land the Oil and Gas Lease is No. E-6190

If patented land the owner is

Address

We propose to drill well with drilling equipment as follows: rotary

The status of plugging bond is on file

Drilling Contractor unknown

We intend to complete this well in the Devonian formation at an approximate depth of 12,600 feet.

CASING PROGRAM

We propose to use the following strings of Casing and to cement them as indicated:

Size of Hole	Size of Casing	Weight per Foot	New or Second Hand	Depth	Sacks Cement
17 1/2	13-3/8	48#	New	350	400*
11	8-5/8	24	New	4000	1500**
7-7/8	4 1/2	9.5 & 11	New	12600	300***

If changes in the above plans become advisable we will notify you immediately.

ADDITIONAL INFORMATION (If recompletion give full details of proposed plan of work.)

*Circl to surface.

**Circl to 13-3/8 csg.

***Circl to at least 600' above top of uppermost pay zone.

Min. mud for samples.

HOWCO method of cmtd to be used.

1 - in Queen -3100'

2 - in Wolfcamp 8500 & 10700

3 - in Devonian 12000' to 12500'.

Sincerely yours,

Approved MAY 25 1961, 19
Except as follows:

Humble Oil & Refining Co.
(Company or Operator)

By

Adm. Supervisor

Send Communications regarding well to

Name R. R. McCarty

Address Box 1600 Midland Texas

OIL CONSERVATION COMMISSION

HUMBLE LEASE NO. 175764 NEW MEXICO OIL CONSERVATION COMMISSION
STATE LEASE NO. E-6190 Well Location and Acreage Dedication Plat
FEDERAL LEASE NO.

Form C-128
Revised 5/1/57

Date 5-22-61
1961 MAY 24 PM 2 51

Section A.

Operator Humble Oil & Refining Co Lease New Mexico State "BL"
Well No. 1 Unit Letter "C" Section 16 Township 13-South Range 32-E NMPM
Located 330 Feet From North Line, 1980 Feet From West Line
County Lea G. L. Elevation Later Dedicated Acreage 40 Acres
Name of Producing Formation Devonian - Wildcat Pool _____

1. Is the Operator the only owner* in the dedicated acreage outlined on the plat below?
Yes ☒ No _____
2. If the answer to question one is "no", have the interests of all the owners been consolidated by communitization agreement or otherwise? Yes _____ No _____ If answer is "yes," Type of Consolidation _____
3. If the answer to question two is "no," list all the owners and thier respective interests below:

Owner

Land Description

Section B

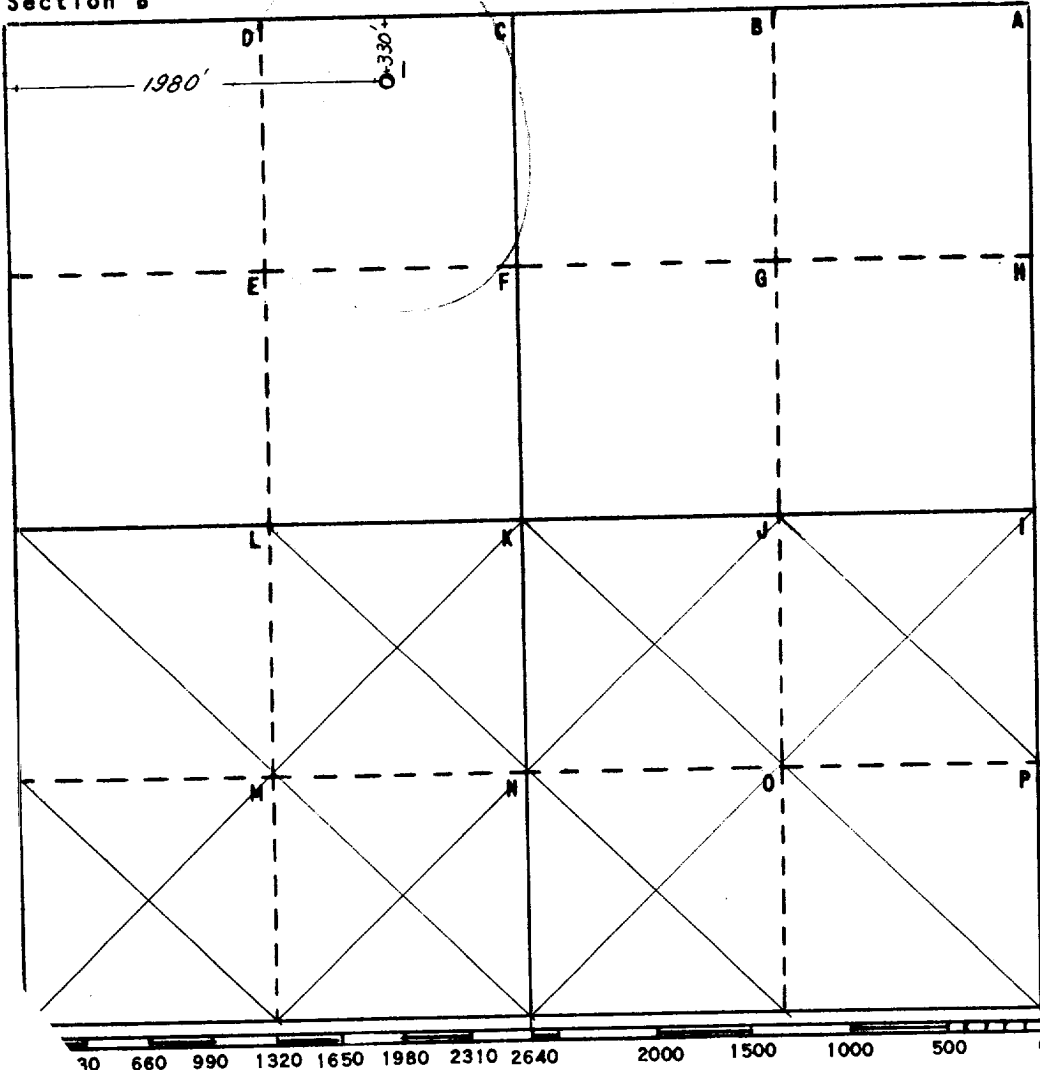

This is to certify that the information in Section A above is true and complete to the best of my knowledge and belief

HUMBLE OIL & REFG. CO.

(Operator)

Henry E. Meador
(Representative)

Box 1600 Midland, Texas
Address

This is to certify that the well location shown on the plat in Section B was plotted from field notes of actual surveys made by me or under my supervision and that the same is true and correct to the best of my knowledge and belief.

Date Surveyed 5-19-61

W.S. Westerfeld
Registered Professional
Engineer and/or Land Surveyor

Certificate No. 1382

FILE NO. W-A- 3099

1961 MAY 24 PM 2 51

Amerada

10 *State*

16	15 Superior
----	-------------

"B1"

320 Ac. Lse.

1980'

330

State
Humble

State

State

State

LEASE DESIGNATION PLAT

1382
Registration
Number

Registered Professional Engineer
or Registered Land Surveyor

NEW MEXICO STATE "BL" LSE.175764
N/2 SEC.16, T-13-S , R-32-E
LEA CO.,NEW MEXICO

HUMBLE OIL & REFINING COMPANY
CIVIL ENGINEERING DIVISION
MIDLAND AREA

DRAWN **W. M. Brice**

CHECKED *D. L. McKibbin*

APPR.

SCALE 1" = 1000'

DATE 5-22-61

REVISÉ

FILE NO.

WA 3099

50 Miles NW of Lovington

Re- 7-15-75	Re- 7-25-75	WELL CLASS: INT.		DX	FIN	DO
SFO	CMP	FORMATION		DATUM	FORMATION	DATUM
CSE						

WELL CLASS: INT		DX		FIN		DO	
FORMATION		DATUM		FORMATION		DATUM	
TD 12,497' (DVNN)		PBD		11,104'			

CONTR OPR'S ELEV 4357' DF PD 11,120' WO

12-3-18 NM

LEA
WOOD & LOCKER, INC.

Williams, N.
1 State "BL"
Sec 16, T13S, R32E

NM
Page #2

10-14-75 TD 12,497'; PBD 11,104'; Tstg
Flwd 110 MCFGPD + 4 BW in 24 hrs thru 16/64"
chk, TP 300# (10,999-11,071')
10-22-75 TD 12,497'; PBD 11,104'; Tstg
Flwd 4 BO + 150 MCFGPD in 24 hrs, TP 100#
(10,999-11,071')
10-27-75 TD 12,497'; PBD 11,104'; Tstg
Flwd 95 MCFGPD + 7 BO in 24 hrs thru 15/64"
chk, TP 200# (10,999-11,071')
11-4-75 TD 12,497'; PBD 11,104'; Tstg
Flwd 75 MCFGPD + 5 BO in 24 hrs, TP 150#
(10,999-11,071')

12-3-18 NM

11-11-75 TD 12,497'; PBD 11,104'; WO Gas Conn
Flwd 80 MCFGPD + 5 BO in 24 hrs, TP 200#
(10,999-11,071')
12-15-75 TD 12,497'; PBD 11,104'; Complete
12-20-75 COMPLETION ISSUED

12-3-18 NM