

NEW MEXICO OIL CONSERVATION COMMISSION
Santa Fe, New Mexico

Form C-101
Revised (12/1/55)

NOTICE OF INTENTION TO DRILL

Notice must be given to the District Office of the Oil Conservation Commission and approval obtained before drilling or recompletion begins. If changes in the proposed plan are considered advisable, a copy of this notice showing such changes will be returned to the sender. Submit this notice in QUINTUPPLICATE. One copy will be returned following approval. See additional instructions in Rules and Regulations of the Commission. If State Land submit 6 Copies Attach Form C-128 in triplicate to first 3 copies of form C-101

Midland, Texas

March 1, 1960

(Place)

(Date)

OIL CONSERVATION COMMISSION
SANTA FE, NEW MEXICO

Gentlemen:

You are hereby notified that it is our intention to commence the Drilling of a well to be known as

McGrath & Smith

(Company or Operator)

Tidewater-State

Well No. 1, in J (Unit) The well is

located 2310 feet from the South line and 2310 feet from the

East

line of Section 18, T. 13-S, R. 32-E, NMPM.

(GIVE LOCATION FROM SECTION LINE) McClurg-Caprock Queen, Lea County

E-7555

If State Land the Oil and Gas Lease is No.

If patented land the owner is.

Address.

We propose to drill well with drilling equipment as follows: Rotary

O-TD

The status of plugging bond is \$10,000.00 Blanket Bond #2107441
W/Continental Casualty Company, April 13, 1959

Drilling Contractor Cactus Drilling Company
Hobbs, New Mexico

We intend to complete this well in the Queen
formation at an approximate depth of 3150 feet.

CASING PROGRAM

We propose to use the following strings of Casing and to cement them as indicated:

Size of Hole	Size of Casing	Weight per Foot	New or Second Hand	Depth	Sacks Cement
11"	8-5/8	28#	used	300	200
6-3/4"	4-1/2	9.50#	new	3150	300

If changes in the above plans become advisable we will notify you immediately.

ADDITIONAL INFORMATION (If recompletion give full details of proposed plan of work.)

Approved....., 19.....
Except as follows:

CEMENT MUST BE CIRCULATED BEHIND

OIL CONSERVATION COMMISSION

By.....

Sincerely yours,

McGrath & Smith

(Company or Operator)

By Larry R. Mitchell

Position Engineer

Send Communications regarding well to

Name McGrath & Smith

Address 209 Petroleum Life Bldg., Midland, Tex.

NEW MEXICO OIL CONSERVATION COMMISSION
WELL LOCATION AND ACREAGE DEDICATION PLAT

FORM C-128
 Revised 5/1/57

SEE INSTRUCTIONS FOR COMPLETING THIS FORM ON THE REVERSE SIDE

SECTION A

Operator McGrath & Smith			Lease Tidewater State			Well No. 3:13
Unit Letter J	Section 18	Township 13 South	Range 32 East	County Lea		

Actual Footage Location of Well:
2310 feet from the **South** line and **2310** feet from the **East** line

Ground Level Elev. 4277.6	Producing Formation Queen	Pool Northwestern Caprock Queen	Dedicated Acreage: 40 Acres
-------------------------------------	-------------------------------------	---	---------------------------------------

1. Is the Operator the only owner in the dedicated acreage outlined on the plat below? YES XX NO ____ . ("Owner" means the person who has the right to drill into and to produce from any pool and to appropriate the production either for himself or for himself and another. (65-3-29 (e) NMSA 1935 Comp.)
2. If the answer to question one is "no," have the interests of all the owners been consolidated by communitization agreement or otherwise? YES ____ NO ____ . If answer is "yes," Type of Consolidation _____
3. If the answer to question two is "no," list all the owners and their respective interests below:

Owner	Land Description

SECTION B

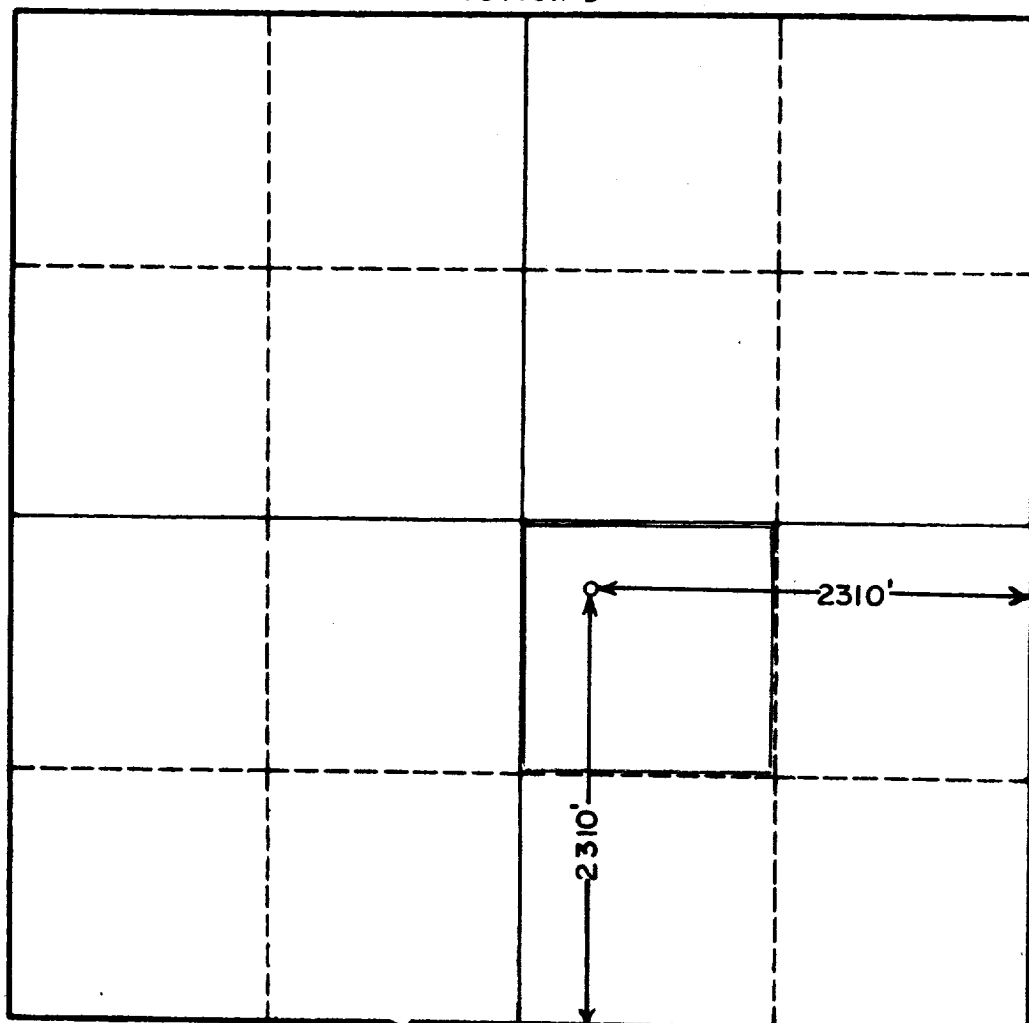

CERTIFICATION

I hereby certify that the information in SECTION A above is true and complete to the best of my knowledge and belief.

James Smith
 Name

Position

Owner

Company

McGrath & Smith

Date

March 1, 1960

I hereby certify that the well location shown on the plat in SECTION B was plotted from field notes of actual surveys made by me or under my supervision, and that the same is true and correct to the best of my knowledge and belief.

Date Surveyed

2-25-60

Registered Professional Engineer and/or Land Surveyor, **JOHN W. WEST**

John W. West
 Certificate No.

N.M. - P.E. & L.S. NO. 676